

**AREA STATEMENT**

1. AREA OF LAND - 443.00 DECIMAL	= 17927.4247 SQM
2. WIDTH OF ROAD	= 12.0 M.
3. PERMISSIBLE F.A.R.	= 2.5
4. TOTAL PERMISSIBLE FLOOR AREA (17927.4247 X 2.5)	= 44,818,561.175 SQM
5. PROPOSED COVERED AREA AT GROUND FLOOR (BLOCK A-1 TO 14)	= 7357.770 SQM
BLOCK 'A' 1 = 525,555 SQM	BLOCK 'A' 8 = 525,555 SQM
BLOCK 'A' 2 = 525,555 SQM	BLOCK 'A' 9 = 525,555 SQM
BLOCK 'A' 3 = 525,555 SQM	BLOCK 'A' 10 = 525,555 SQM
BLOCK 'A' 4 = 525,555 SQM	BLOCK 'A' 11 = 525,555 SQM
BLOCK 'A' 5 = 525,555 SQM	BLOCK 'A' 12 = 525,555 SQM
BLOCK 'A' 6 = 525,555 SQM	BLOCK 'A' 13 = 525,555 SQM
BLOCK 'A' 7 = 525,555 SQM	BLOCK 'A' 14 = 525,555 SQM
6. PROPOSED COVERED AREA AT GROUND FLOOR (BLOCK B+C+D+E+F)	= 1740.410 SQM
BLOCK 'B' 15 = 342,281 SQM	BLOCK 'D' 18 = 304,910 SQM (COMMERCIAL USE)
BLOCK 'C' 16 = 289,250 SQM	BLOCK 'E' 19 = 377,775 SQM (COMMERCIAL USE)
BLOCK 'C' 17 = 289,250 SQM	BLOCK 'F' 20 = 138,950 SQM
7. TOTAL PROP. COVERED AREA AT GROUND FLOOR (BLOCK A+B+C+D+E+F)	= 9100.186 SQM
8. PROPOSED COVERED AREA AT FIRST FLOOR (BLOCK A+B+C+D+E+F)	= 9100.186 SQM
9. PROPOSED COVERED AREA AT SECOND FLOOR (BLOCK A+B+C+D+E+F)	= 9100.186 SQM
10. PROPOSED COVERED AREA AT THIRD FLOOR (BLOCK A+B+C+D+E+F)	= 9100.186 SQM
11. PROPOSED COVERED AREA AT FOURTH FLOOR (BLOCK A+B+C+D+E+F)	= 8417.501 SQM
BLOCK 'A' 1 TO 14 = 7357.770 SQM	BLOCK 'D' 18 = NIL
BLOCK 'B' 15 = 342,281 SQM	BLOCK 'E' 19 = NIL
BLOCK 'C' 16 = 289,250 SQM	BLOCK 'F' 20 = 138,950 SQM
BLOCK 'C' 17 = 289,250 SQM	
12. TOTAL PROPOSED FLOOR AREA (BLOCK A+B+C+D+E+F)	= 44818.245 SQM
13. SERVICE AREA	
STAIR HEAD ROOM & LIFT MACHINE ROOM AREA	
BLOCK 'A' 1 TO 14 = 34,865 X 14 = 487,270 SQM	BLOCK 'D' 18 = 75,413 SQM
BLOCK 'B' 15 = 37,323 SQM	BLOCK 'E' 19 = 50,860 SQM
BLOCK 'C' 16 & 17 = 37,323 X 2 = 74,646 SQM	BLOCK 'F' 20 = 32,763 SQM
14. TOTAL SERVICE AREA	= 760,972 SQM
15. ALL TOTAL FLOOR AREA (INCLUDING SERVICE AREA)	= 45576.515 SQM
16. PROPOSED F.A.R. (EXCLUDING SERVICE AREA)	= 2.5

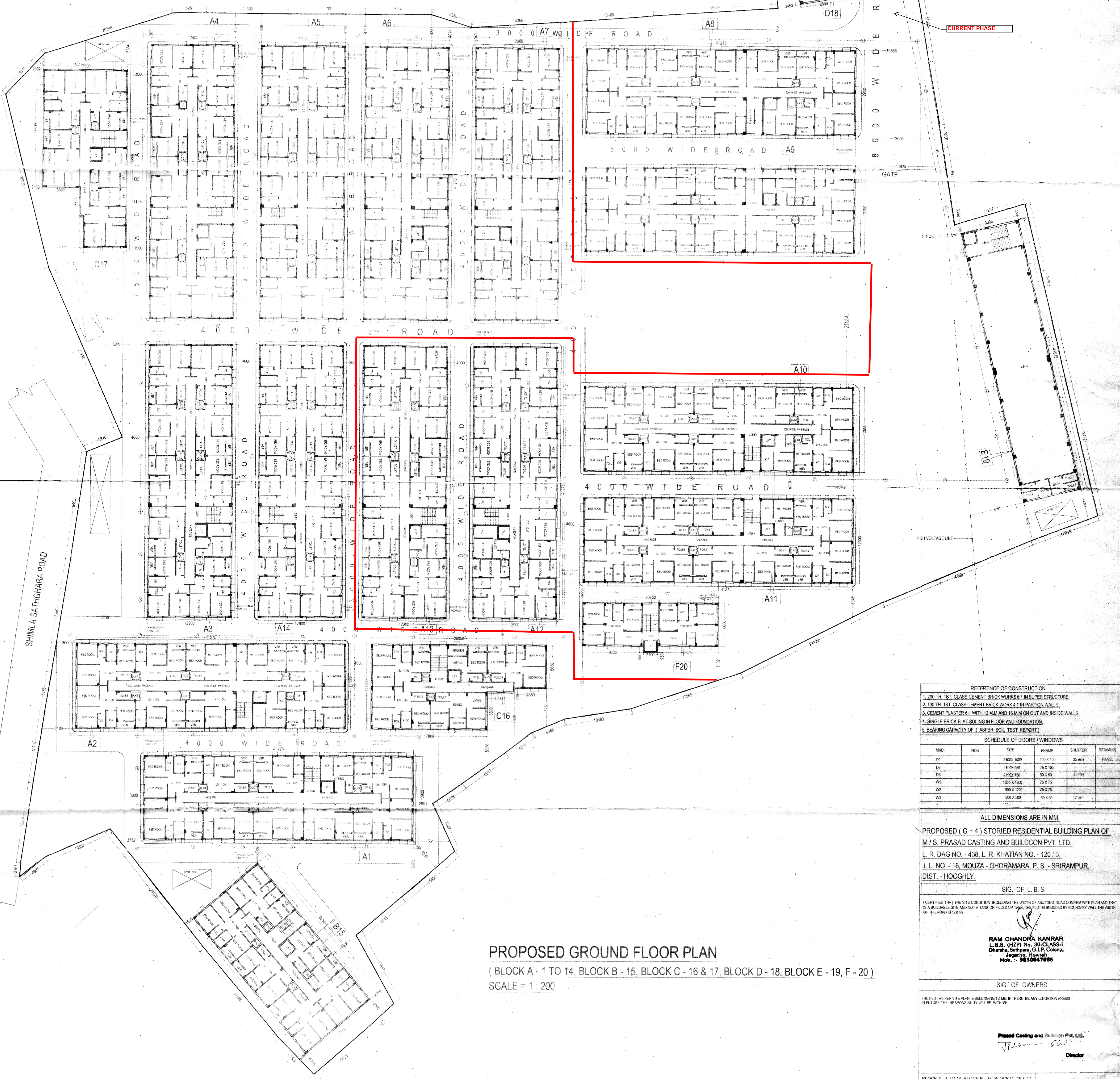
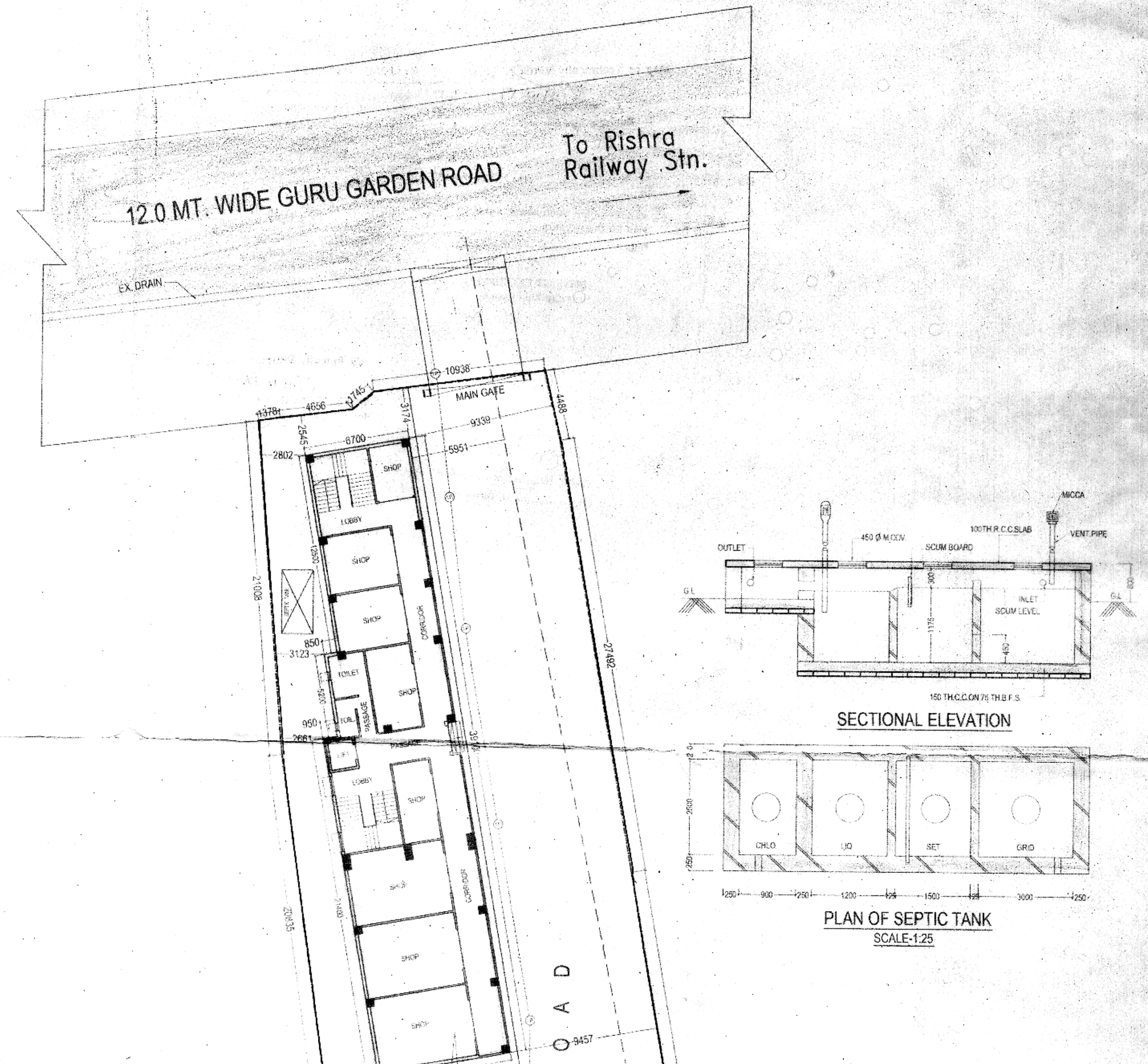
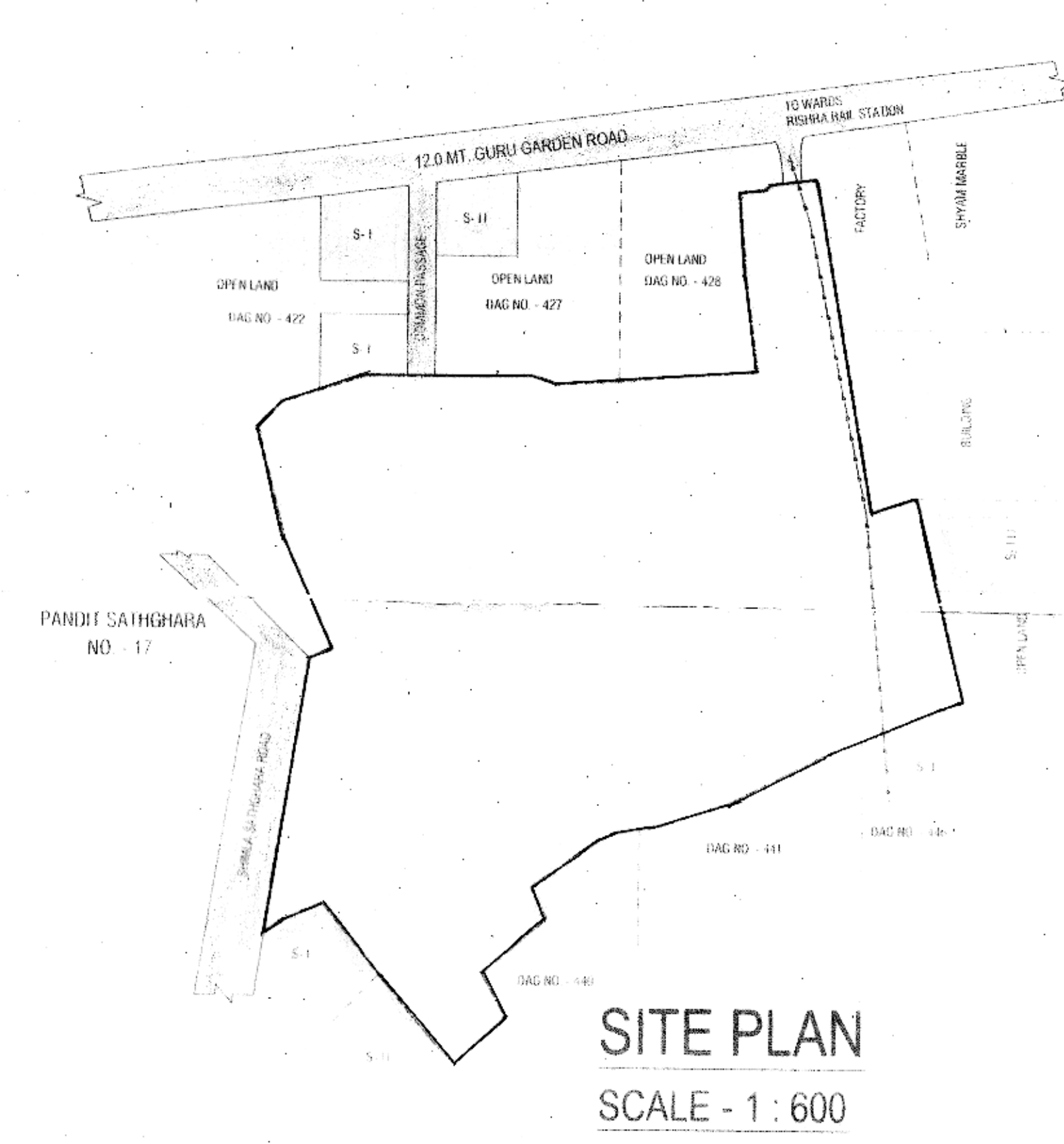
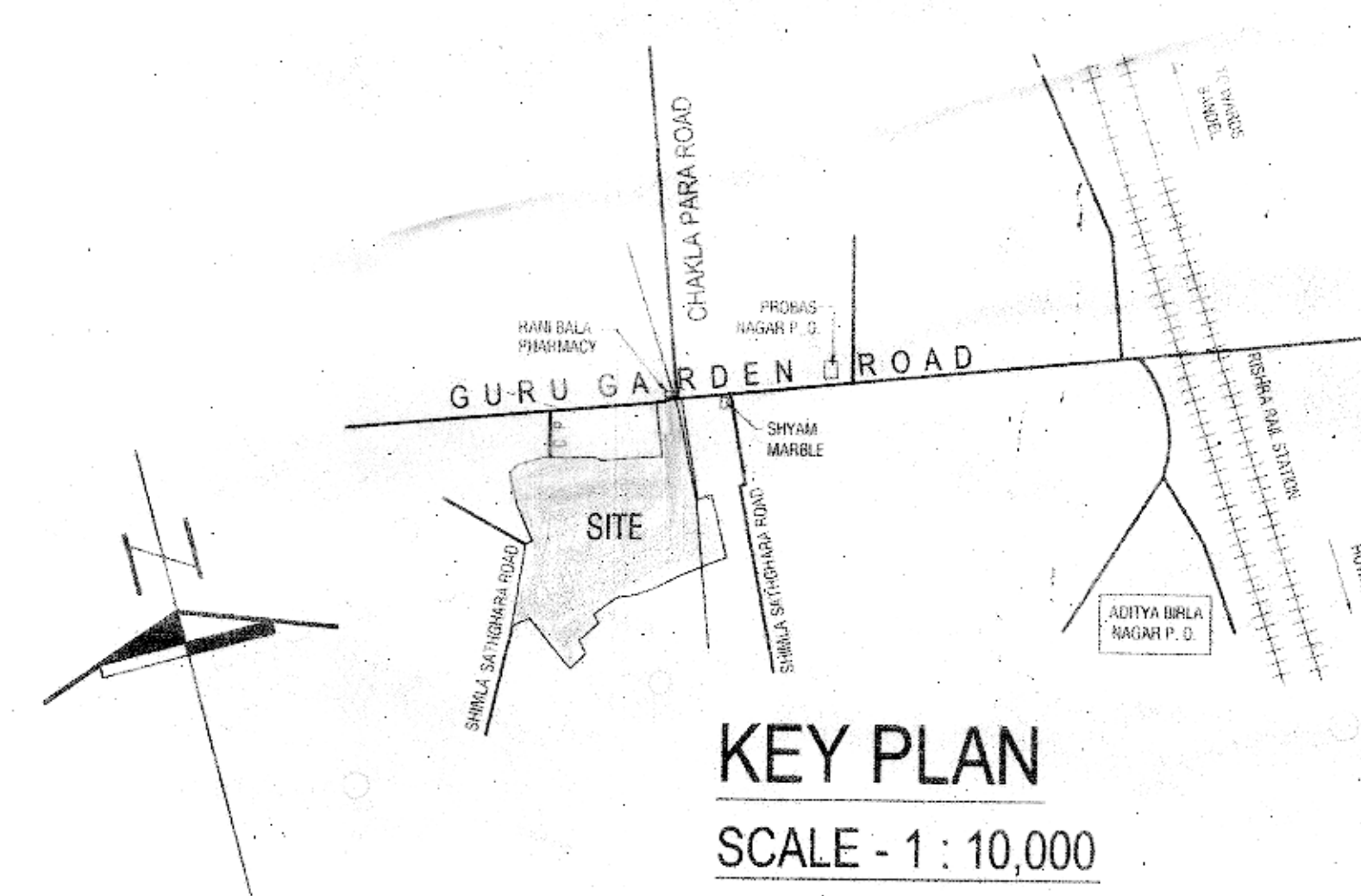

**REFERENCE OF CONSTRUCTION**

- 200 TH. 1ST. CLASS CEMENT BRICK WORKS & 1 IN SUPER STRUCTURE.
- 100 TH. 1ST. CLASS CEMENT BRICK WORK 4:1 IN PARTITION WALLS.
- CEMENT PLASTER 6:1 WITH 12 MM AND 16 MM ON OUT AND INSIDE WALLS.
- SINGLE BRICK FLAT SOLING IN FLOOR AND FOUNDATION.
- BEARING CAPACITY OF (ASPER SOIL TEST REPORT)

**SCHEDULE OF DOORS / WINDOWS**

NO.	SIZE	FRAME	SHUTTER	REMARKS
D1	2100 X 1500	150 X 100	30 mm	PANEL
D2	2100 X 900	75 X 100	30 mm	
D3	2100 X 750	50 X 100	25 mm	
W1	1200 X 1000	75 X 75	25 mm	
W2	900 X 1200	75 X 75	25 mm	
W3	500 X 500	50 X 50	12 mm	

**ALL DIMENSIONS ARE IN MM.**

**PROPOSED (G + 4) STORED RESIDENTIAL BUILDING PLAN OF**  
M/S. PRASAD CASTING AND BUILDCON PVT. LTD.  
L. R. DAG NO. - 438, L. R. KHATIAN NO. - 120 / 3,  
J. L. NO. - 16, MOUZA - GHORAMARA, P. S. - SRIRAMPUR,  
DIST. - HOOGHLY.

SIG. OF L. B. S.

I CERTIFY THAT THE SITE CONDITION INCLUDING THE WIDTH OF ABUTTING ROAD CONFORM WITH PLAN AND THAT IS A RELIABLE SITE AND NOT A TANK OR FILLED UP TANK. THE PLOT IS BOUNDARY WALL THE WIDTH OF THE ROAD IS 12.0 M.

**RAM CHANDRA KANRAR**  
L.B.S. (H2P) No. 30-CLASS-1  
Dhansha, Sathghara, G.I.P. Colony,  
Jogesh, Howrah  
Mob. :- 9830947885

SIG. OF OWNERS

The plot as per site plan is belonging to me. If there be any litigation arises in future the responsibility will be with me.

**Prasad Casting and Buildcon Pvt. Ltd.**  
Director

BLOCK A - 1 TO 14, BLOCK B - 15, BLOCK C - 16 & 17,  
BLOCK D - 18, BLOCK E - 19, BLOCK F - 20

SHEET NO. - 1/19

May be Technically Vetted

11/10/17  
Assistant Engineer  
Moohiy Zilla Paritish

Validity of the Technically Vetted  
plan for three years  
11/10/17  
DISTRICT ENGINEER  
Moohiy Zilla Paritish

RECOMMENDATIONS

- 1. The foundation of all the columns as per bearing capacity of soil
- 2. The safety of structure should be checked as per IS 456
- 3. The Construction should be carried out as per I. S. Code and be supervised by the qualified Engineer.

11/10/17  
DISTRICT ENGINEER  
Moohiy Zilla Paritish

Technically Vetted  
11/10/17  
DISTRICT ENGINEER  
Moohiy Zilla Paritish

Memo No. 233/11/10/17-18  
Dt. 11/10/17