

**TYPICAL PLAN OF MANHOLE CHAMBER (SEWER)**  
 SIZE - (900MM X 150MM) CLEAR  
 DEPTH FROM 1501MM TO 2000MM FROM F.G.L.

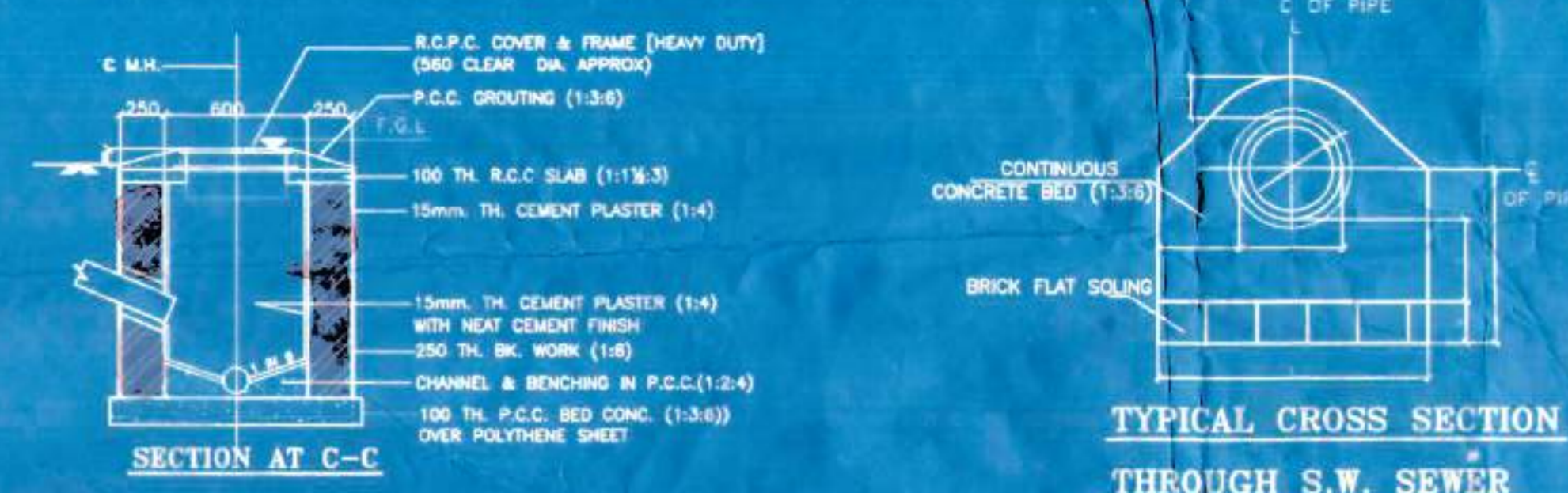

**TYPICAL CROSS SECTION THROUGH S.W. SEWER**



**TYPICAL PLAN OF INSPECTION CHAMBER (SEWER)**  
 SIZE - 600X600 (CLEAR)  
 DEPTH UP TO 1500 MM FROM F.G.L.

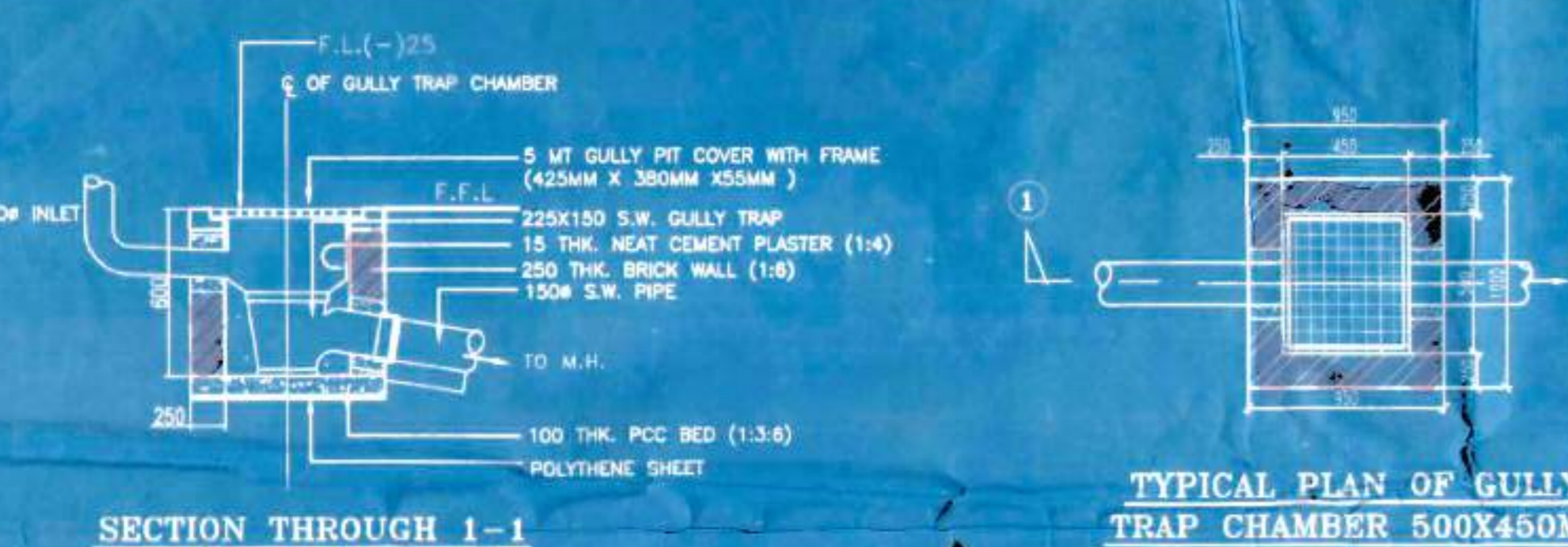

**TYPICAL PLAN OF GULLY TRAP CHAMBER 500X450MM**



**TYPICAL PLAN OF CATCH PIT EXCEPT SCUPPER, SIZE - 800X600**

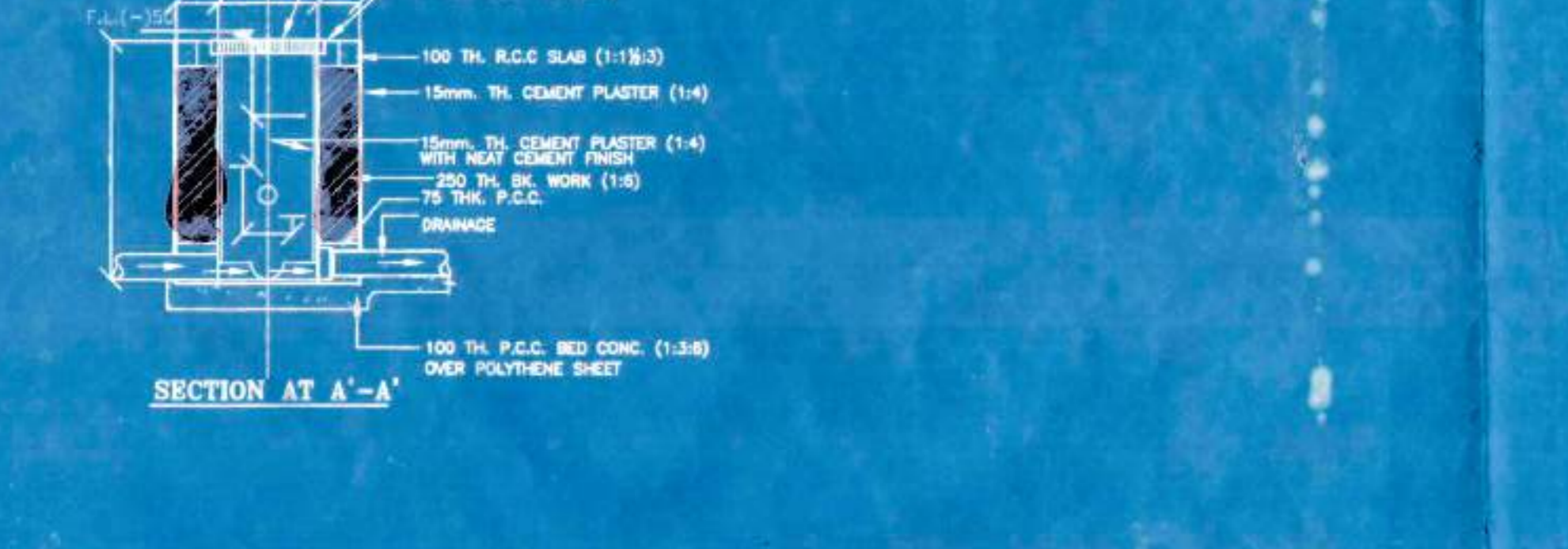

**SECTION AT A'-A'**

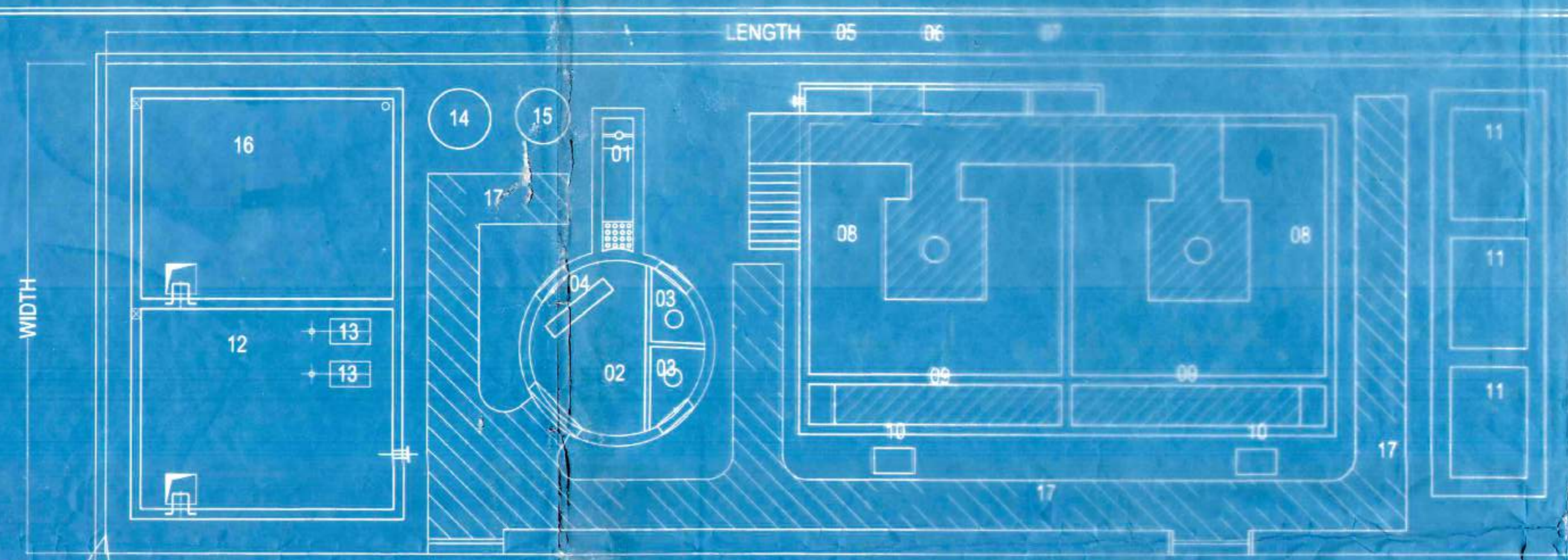

**STP DETAIL**

- STP LEGEND**
- 01 - COARSE BAR SCREEN CHAMBER
  - 02 - COLLECTION SUMP
  - 03 - TRANSFER PUMP
  - 04 - STARTER PANEL
  - 05 - FINE BAR SCREEN CHAMBER
  - 06 - GRIT CHAMBER
  - 07 - DISTRIBUTION CHAMBER
  - 08 - AERATION TANK
  - 09 - SECONDARY SETTLING TANK
  - 10 - SLUDGE PUMP
  - 11 - SLUDGE DRYING BED
  - 12 - FILTER FEED TANK
  - 13 - FILTER FEED PUMP
  - 14 - MULTIGRADE FILTER (MF)
  - 15 - ACTIVATED CARBON FILTER (ACF)
  - 16 - TREATED WATER TANK
  - 17 - PATHWAY

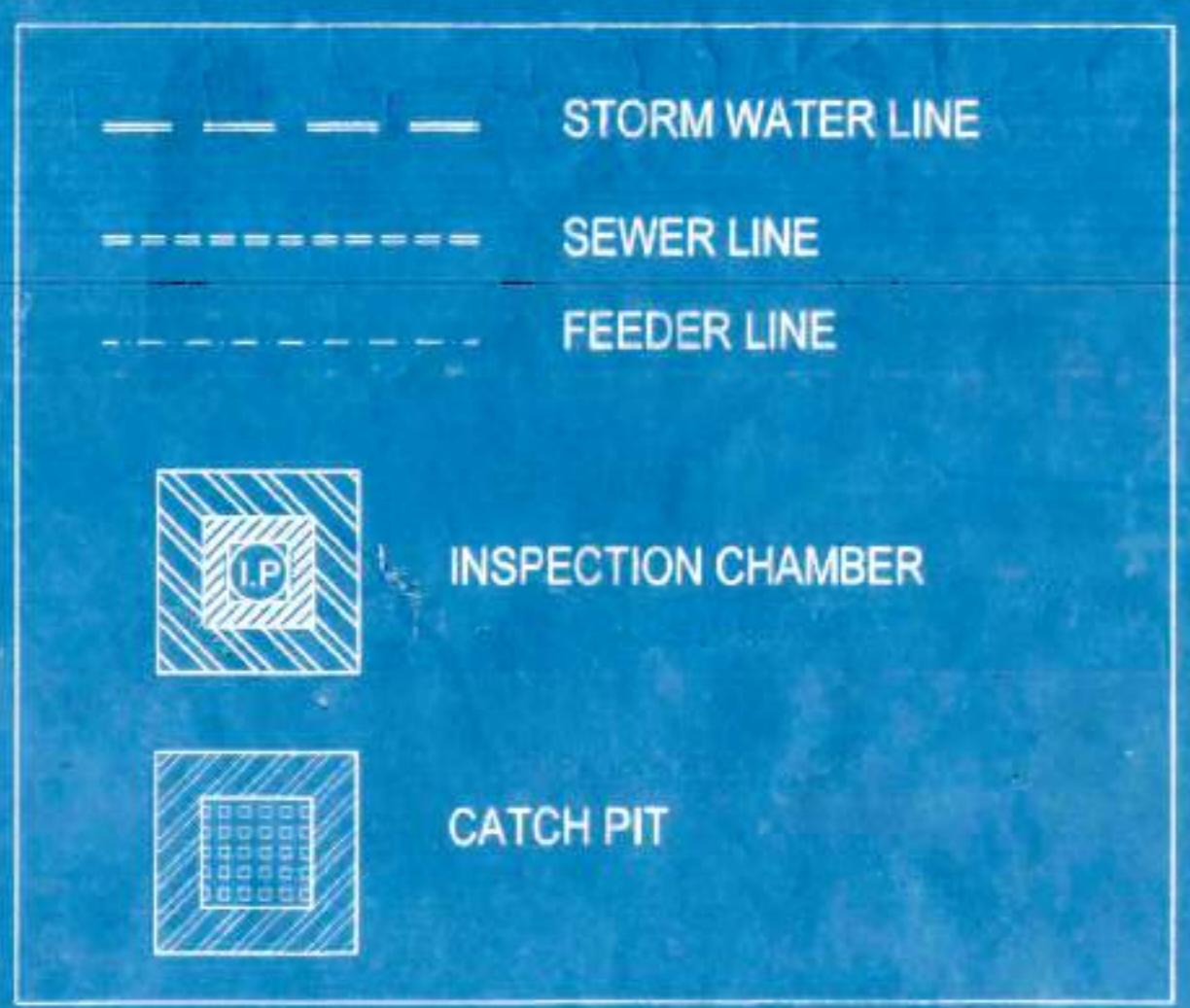
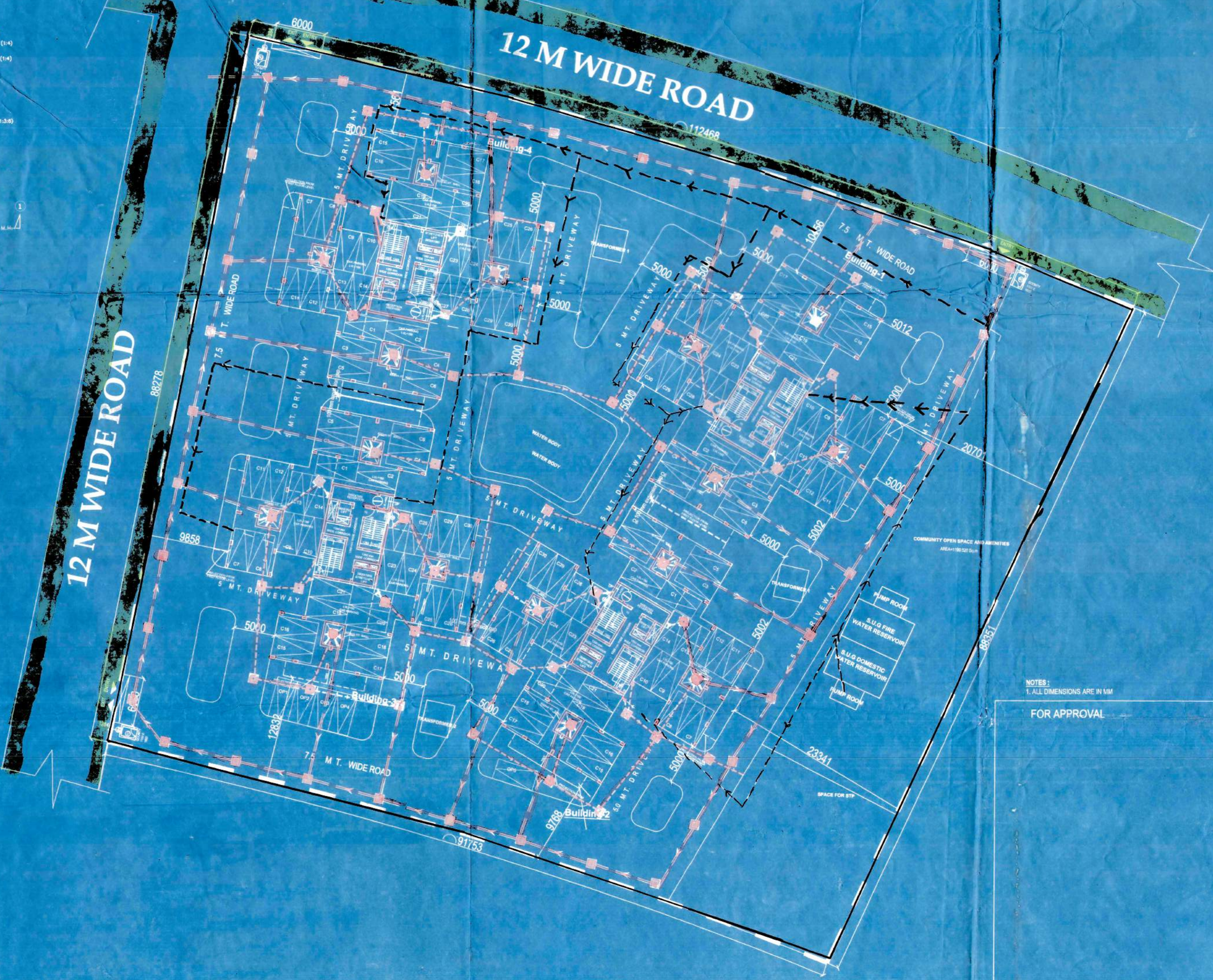

DESIGNED BY AN ARCHITECTURAL FIRM REGISTERED UNDER THE ARCHITECTS ACT, 1947 AND THE ARCHITECTS (REGULATION) ACT, 1962. THE ARCHITECT'S FIRM IS NOT RESPONSIBLE FOR THE ACCURACY OF THE INFORMATION PROVIDED BY THE CLIENT OR THE CONSULTANTS. THE ARCHITECT'S FIRM IS NOT RESPONSIBLE FOR THE ACCURACY OF THE INFORMATION PROVIDED BY THE CLIENT OR THE CONSULTANTS.

DESIGNED BY AN ARCHITECTURAL FIRM REGISTERED UNDER THE ARCHITECTS ACT, 1947 AND THE ARCHITECTS (REGULATION) ACT, 1962. THE ARCHITECT'S FIRM IS NOT RESPONSIBLE FOR THE ACCURACY OF THE INFORMATION PROVIDED BY THE CLIENT OR THE CONSULTANTS. THE ARCHITECT'S FIRM IS NOT RESPONSIBLE FOR THE ACCURACY OF THE INFORMATION PROVIDED BY THE CLIENT OR THE CONSULTANTS.

**AMITAKANISWAS**  
 Chartered Architect  
 CA/2010/47702

**PRAKALPA**  
 Chartered Architect  
 CA/2010/47702

DESIGNED BY AN ARCHITECTURAL FIRM REGISTERED UNDER THE ARCHITECTS ACT, 1947 AND THE ARCHITECTS (REGULATION) ACT, 1962. THE ARCHITECT'S FIRM IS NOT RESPONSIBLE FOR THE ACCURACY OF THE INFORMATION PROVIDED BY THE CLIENT OR THE CONSULTANTS. THE ARCHITECT'S FIRM IS NOT RESPONSIBLE FOR THE ACCURACY OF THE INFORMATION PROVIDED BY THE CLIENT OR THE CONSULTANTS.

**MS. MITA SAHA**  
 M.E. (Struct), C.E.  
 S.E. 52 (I)  
 A.O. 52, S.E. 52 (I)  
 Mob: 9831884117

**SIGNATURE OF THE STRUCTURAL ENGINEER**  
 MARK ENGINTECH

IT IS CERTIFIED THAT THE COMPREHENSIVE GEO-TECHNICAL REPORT ON SOIL INVESTIGATION HAS BEEN PREPARED BY ME FOR DESIGN AND CALCULATION OF THE FOUNDATION BY ANALYZING THE SOIL SAMPLES FOR ESTIMATING THE BEARING CAPACITY OF THE SOIL ON WHICH FOUNDATION OF THE STRUCTURE WILL BE CONSTRUCTED.

**DR. SUMIT HEMAR BOSE**  
 Ph.D., B.E., S.E. (I), C.E. (I), M.E. (I), L.I.G.S.  
 License No. - EM/1180/2017

**G.S. ELECTROCOM PRIVATE LIMITED**  
 Sanku Gossain  
 Authorized Signatory

NOTES:  
 1. ALL DIMENSIONS ARE IN MM

FOR APPROVAL

AUTHORISED SIGNATORY

**TITLE:**  
 OVER ALL SITE PLAN SHOWING GROUND FLOOR PLAN, SEWER LINE CONNECTION LAYOUT, DETAIL OF STP

<b>PROJECT ARCHITECT</b> AMITAKANISWAS Chartered Architect CA/2010/47702	<b>DATE:</b> 20/11/2024
<b>DRIVING ENGINEER</b> SUMAN	<b>CHECKED BY:</b> ATANK C
<b>APPROVED BY:</b>	<b>SCALE:</b> 1:200
<b>DRAWING NO:</b> SUBMISSION DRAWING	<b>DATE:</b> 21.11
<b>100-AN-PWA-SBK-GIA</b>	<b>REVISION NO:</b>



- Valid and recommended for sanction the building plan No. 182/6/B/2019 (196) up to 6.1 x 11.1 m (20' x 35' 6") etc. subject to the condition.
- Before starting any construction, the site must conform with the plan submitted and all the conditions as proposed in the plan should be fulfilled.
- All building materials necessary for construction should conform to the standards as per the Indian Standards Code of India.
- Necessary steps should be taken for safety of trees of the adjoining plots and premises during construction.
- Construction site should be maintained to prevent mosquito breeding.
- Edge of all structural members including that of the foundation should conform to the standard specified in the I.S.C. of India.

- The sanction is valid for 3 years from date of sanctioning.
- Information required by the applicant for this and onwards: Commencement of work, Completion of structural work up to plinth, Completion of work.
- No rain water pipe should be fixed or discharged on Road or Footpath.
- The construction should be carried out as per specification of I.S. Code and sanctioned plan under the supervision of qualified experienced engineers.
- Construction of garbage vat, soak pit & waste water should be done by the owner.
- Any deviation of the sanctioned plan shall mean demolition.

1. There should not be any court case or any complaints from any corner in respect of the said property as per plan.  
 2. 'South 24 Parganas Zilla Parishad' will not be liable if any dispute arises at the site.

  
 ASSISTANT ENGINEER  
 South 24 Pgs. Z.P.

  
 District Engineer  
 South 24 Pgs. Z.P.