

SITE PLAN FOR THE PROPOSED G+IV STORIED RESIDENTIAL FLAT BUILDING OF SRI BIBHAS ROY S/O LATE DHARMADAS ROY, ON MOUZA -BURDWAN, J.L.NO.-30, R.S.PLOT NO.- 962, L.R.PLOT NO:- 2520, R.S.KH.NO - 148, L.R.KH.NO- 18152, AT MAHALLA:-D.D.TEWARI ROAD, HOLDING NO- 122, WARD NO:- 21, P.S.- BURDWAN, DIST.- PURBA BARDDHAMAN, UNDER BURDWAN MUNICIPALITY.

AREA OF LAND - 2776.30 SFT

NATURE OF LAND - VIII

OWNER LAND SHOWN IN COLOUR - 

EXT CONST SHOWN IN COLOUR 

ROAD SHOWN IN COLOUR 

DRAIN SHOWN IN COLOUR 

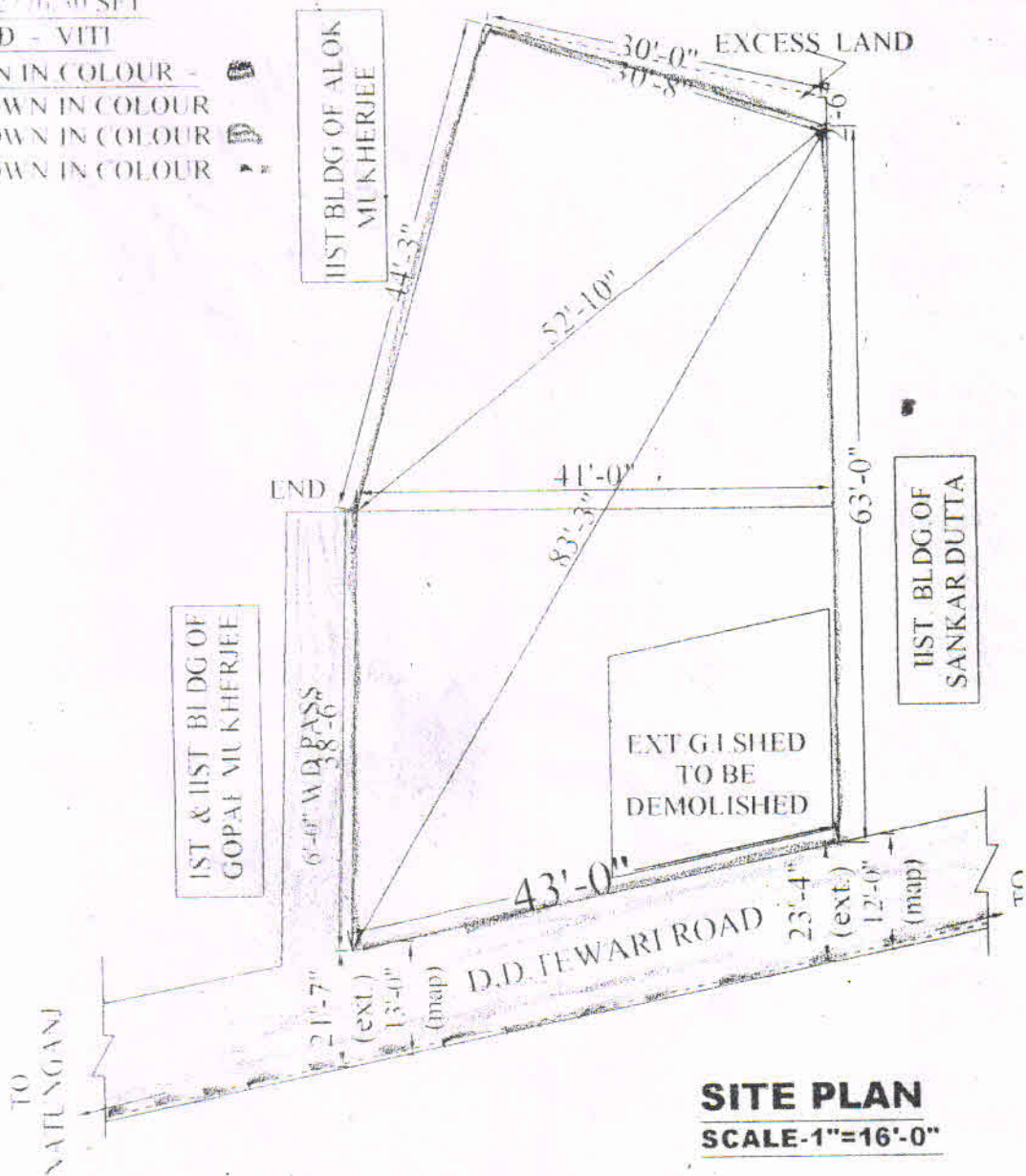

SITE PLAN
SCALE-1"=16'-0"

<p>Vice-Chairman Burdwan Municipality</p> <p><i>[Signature]</i> 21/7/18</p>	<p><i>[Signature]</i> 20/7/18</p>	<p><i>[Signature]</i></p>
<p>VICE - CHAIRMAN</p>	<p>ENGINEER</p>	<p>HEALTH OFFICER</p>
<p><i>[Signature]</i></p>		<p><i>[Signature]</i></p>
<p>DRAWN BY</p>	<p>Bibhas Roy SIGN. OF OWNER</p>	