



HIGHWAY CONSTRUCTION

Contractors, Engineers & Developers

32/1/B-18, B. T. Road, Khardah, 24 Parganas (N).
Narmada Apartment (Block - B), Room - 9, Kol - 700117

Ref No.

Date.....

AREA STATEMENTS :-
TOTAL LAND AREA =
420.35 SQ.M. i.e.
6KA.-4CH.-23 SQ.FT.
(MORE/LESS)

SCALE:- 1:300

LATITUDE OF THE SITE = 22.7196313
LONGITUDE OF THE SITE = 88.3884886

HOUSE OF SARASWATI APARTMENT

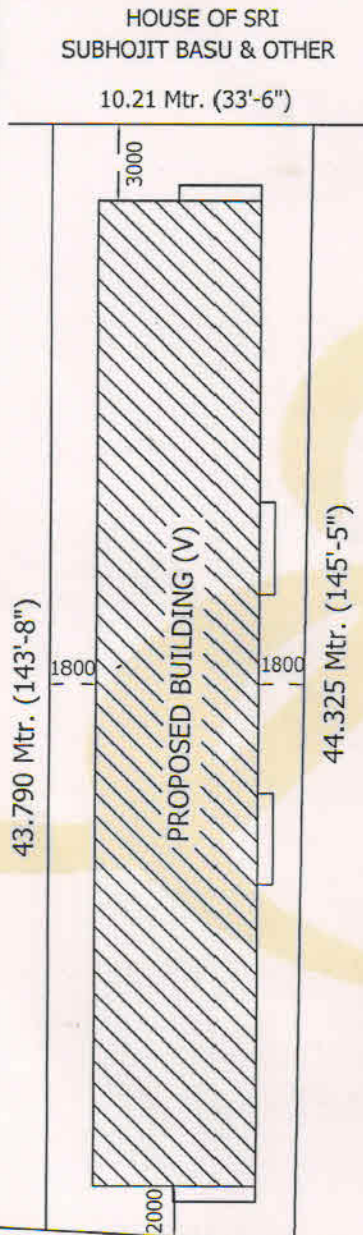

LAND OF SMT. PUTUL RANI DAS

LOCATION MAP SHOWING THE LAND AT
HOLDING NO.- 40/420, OLD CALCUTTA
ROAD, RAHARA OF R.S. DAG NO.- 228/410
& 229/409; R.S. KHATIAN NO.- 65; L.R.
DAG NO.- 487; L.R. KHATIAN NO.- 5; R.S.
NO.- 11; TOUJI NO.- 200; MOUJA- KERULIA;
WARD NO.- 7; MUNICIPALITY & P.S.-
KHARDAHA; DISTRICT- NORTH 24
PARGANAS.

For Highway Construction

Archana Prasad Nandi
Proprietor

SIGNATURE OF DEVELOPER

SKETCHED BY:-

Susanta De
5.9.2019
SUSANTA DE
Plan Maker & Estimator
L.B.S. Licence No-11723480
Under Khardaha Municipality

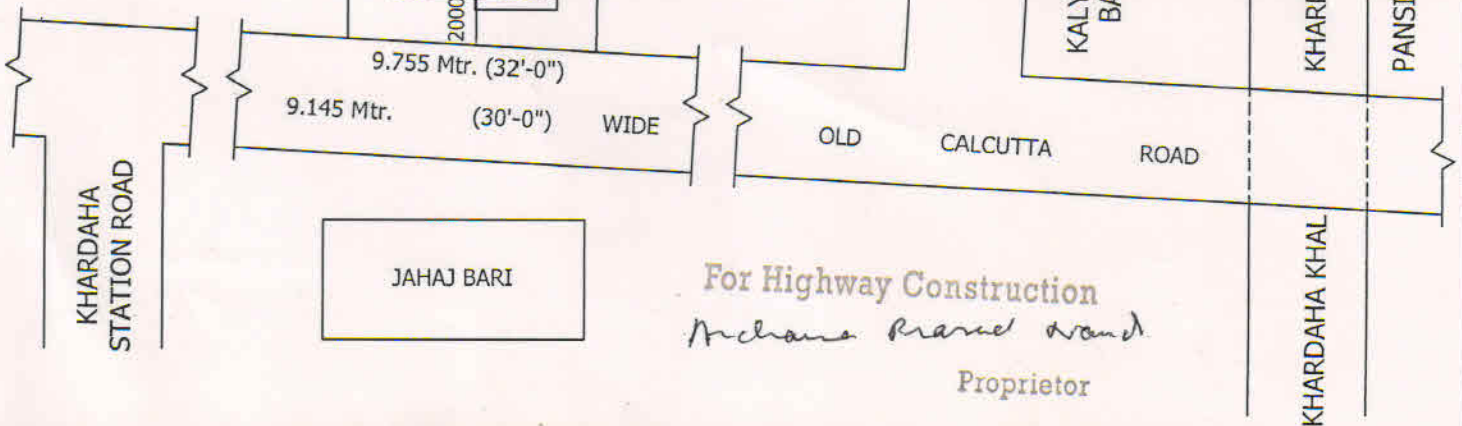
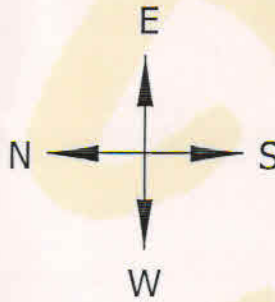

For Highway Construction
Archana Prasad Nandi
Proprietor