

Sanctioned By: Br. No.

Assistant Engineer (C-B) Br. No.

DOORS AND WINDOWS SCHEDULE			
DOORS	WINDOWS		
MCD	WIDTH	HEIGHT	WIND
D	2000	2400	W1
D1	1200	2400	W2
D2	1000	2400	W3
D3	900	2400	W4
D4	800	2400	W5
D5	750	2400	W6
S01	4395	2400	W7
S02	1500	2400	W8
S03	2500	2400	W9
S04	3850	2400	W10
S05	2925	2400	W11
F01	1200	2400	W12
			W13
			W14
			450
			1500

TITLE :- BLOCK-1
17TH & 18TH FLOOR PLAN

PROPOSED B+G+22 STOREIED (76.7 m HIGH) RESIDENTIAL BUILDING FOR BLOCK 1 AND SINGLE STOREIED MERCANTILE BUILDING OF HT. 6.7 m FOR BLOCK 2 (CONSIDERING U/R 69A (1)(C) OF KMC BUILDING RULE 2009 READ WITH U/S - 393 A OF K.M.C ACT 1980) AT PRE.NO.11, DESHPRAN SHASMAL ROAD, P.S-CHARU MARKET, WARD NO-89, BOROUGH-X, KOLKATA-700033.

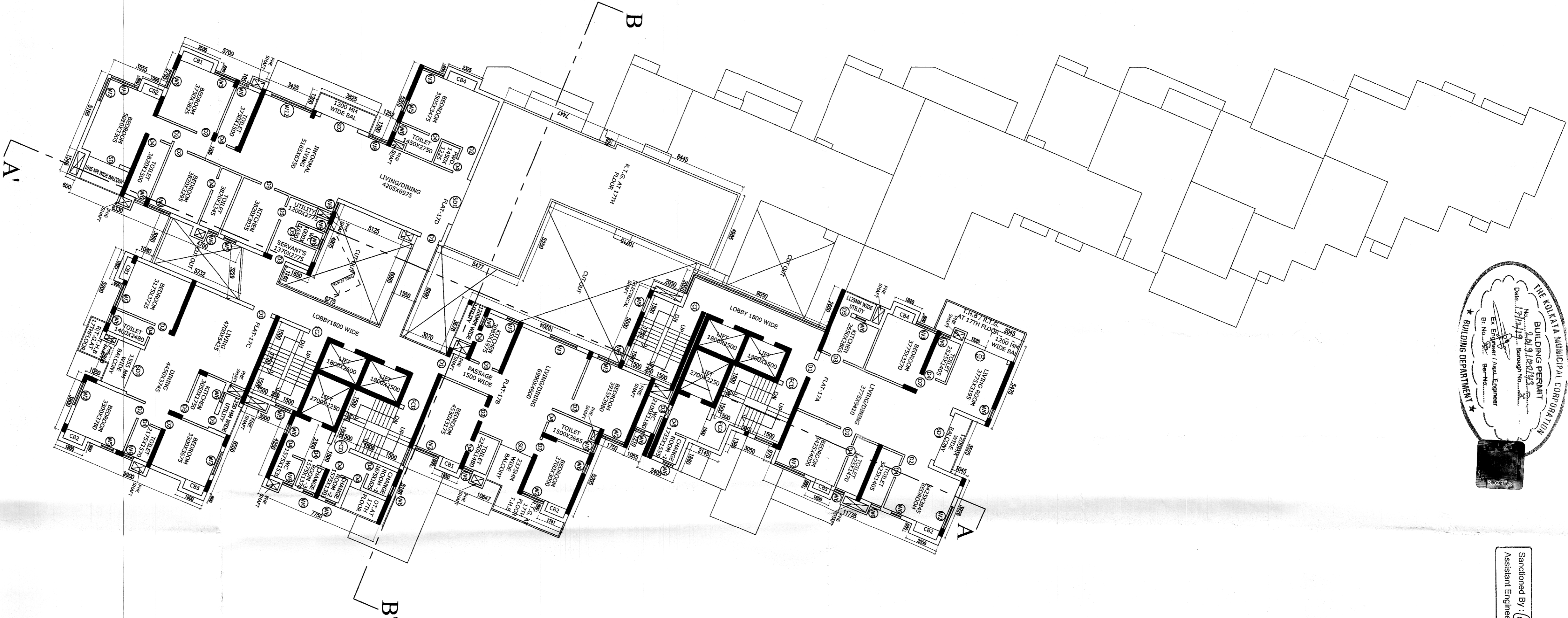

17TH FLOOR PLAN

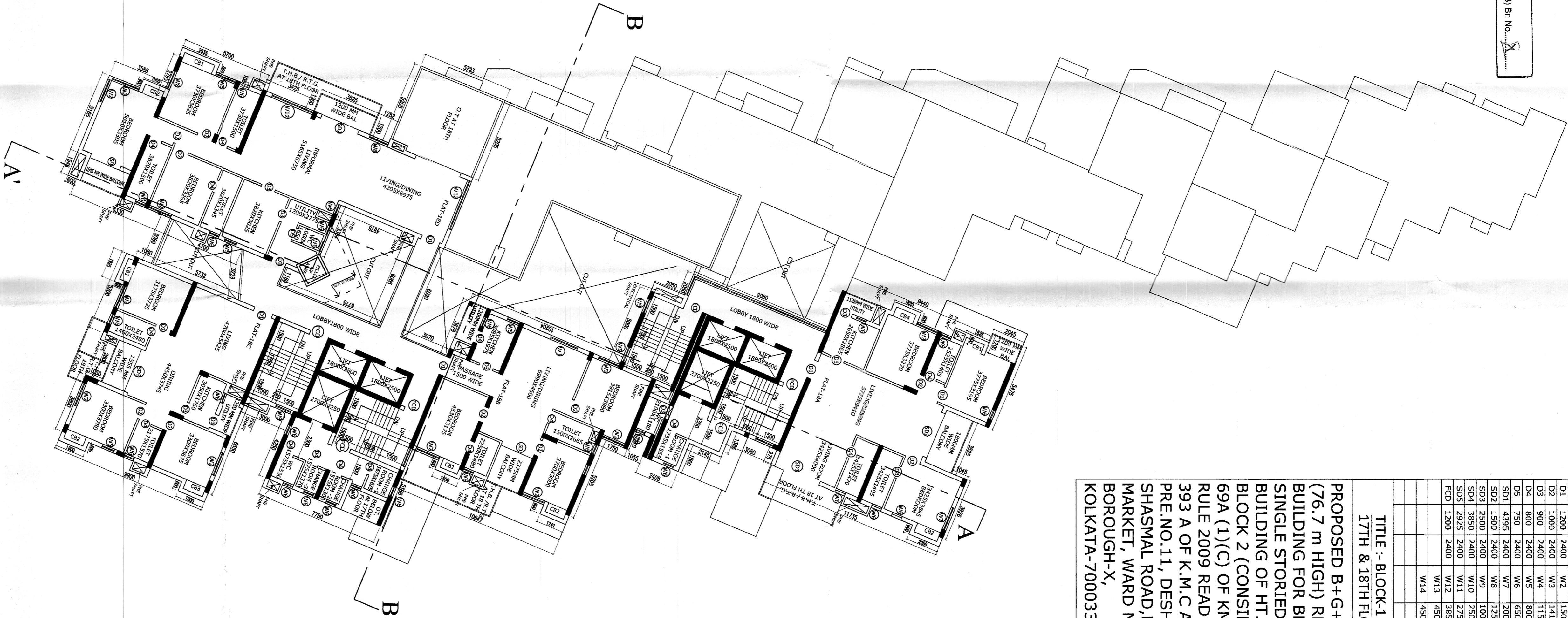

18TH FLOOR PLAN

DECLARATION OF OWNERS

I/WE HEREBY DECLARE WITH FULL RESPONSIBILITY THAT I/WE ENGAGE ARCHITECT & E.S.E DURING CONSTRUCTION SHALL FOLLOW THE INSTRUCTIONS OF ARCHITECT & E.S.E DURING CONSTRUCTION OF THE BUILDING AS PER B.S.P.D.N.

K.M.C AUTHORITY WILL NOT BE RESPONSIBLE FOR STRUCTURAL STABILITY OF THE BUILDING AND ADDITIONAL STRUCTURE IF ANY SUBMITTED DOCUMENTS ARE FOUND TO BE FALSE. THE K.M.C AND SEPTATANK WILL BE UNDERSTAND UNDER THE GUIDANCE OF E.S.E ARCHITECT BEFORE STARTING OF BUILDING FOUNDATION WORK. PLANT ROOM, WATER TANK, ELEVATOR, STAIRCASE, ETC.

Signature of Owner:
Signature of Owner

DECLARATION OF GEOTECH ENGINEER

UNDERSIGNEE HAS INSPECTED THE SITE AND CARRIED OUT SOIL INVESTIGATION AND HEREON THIS IS CERTIFIED THAT THE PROPOSED CONSTRUCTION AND THE FOUNDATION SYSTEM PROPOSED HEREIN IS SAFE & STABLE IN ALL RESPECT FROM GEOTECHNICAL POINT OF VIEW.

Signature of Geotech Engineer:
Signature of Geotech Engineer (1/11)

DECLARATION OF STR. ENGINEER

THE STRUCTURAL DESIGN AND DRAWING OF BOTH FOUNDATION AND SUPER STRUCTURE OF THE BUILDING HAS BEEN DONE BY MR. ALOK ROY (MS GEOTECH ENGINEER PVT. LTD. & M.L.ANARK, KOLKATA-700094). THE RECOMMENDATION OF SOIL TEST REPORT HAS BEEN CONSIDERED DURING STRUCTURAL CALCULATIONS.

Signature of Str. Engineer:
Signature of Structural Engineer

DECLARATION OF ARCHITECT

CERTIFIED WITH FULL RESPONSIBILITY THAT THE BUILDING AS PLANS BEING DRAWN AND CONSTRUCTION THEREON SHALL BE IN ACCORDANCE WITH THE BUILDING CODE OF INDIA AND CERTIFIED THAT IT IS SAFE AND STABLE IN ALL RESPECTS. SOIL TESTING HAS BEEN DONE BY MR. ALOK ROY (MS GEOTECH ENGINEER PVT. LTD. & M.L.ANARK, KOLKATA-700094). THE RECOMMENDATION OF SOIL TEST REPORT HAS BEEN CONSIDERED DURING STRUCTURAL CALCULATIONS.

Signature of Architect:
Signature of Architect

ARCHITECTS :- THE DESIGN CELL
2A COOPER STREET, KOLKATA
700 026

Scale :- 1:150

Sri Anandapada Banerjee being the authorized representative of the owners, has authorized me to act as the authorized representative of the owners in all matters relating to the construction of the building as per the plans and specifications submitted to the K.M.C. and to sign the necessary documents for the construction of the building as per the plans and specifications submitted to the K.M.C. and to sign the necessary documents for the construction of the building as per the plans and specifications submitted to the K.M.C.

Signature of Geotech Engineer:
Signature of Geotech Engineer (1/11)

Signature of Str. Engineer:
Signature of Structural Engineer

Signature of Architect:
Signature of Architect