

Sanctioned By: *[Signature]*
 Assistant Engineer (C-3) B. No. *[Handwritten]*

DOORS AND WINDOWS SCHEDULE					
DOORS	WINDOWS				
MCD.	WIDTH	HIGHT	NO.	AREA	PERCENT
D1	2000	2400	W1	1800	1500
D2	1200	2400	W2	1500	1500
D3	1000	2400	W3	1415	1500
D4	800	2400	W4	1150	1500
D5	750	2400	W5	800	1500
D6	4395	2400	W6	650	1200
D7	1500	2400	W7	2000	1500
D8	3850	2400	W8	1000	1500
D9	2925	2400	W9	2500	1500
D10	1200	2400	W10	3850	1500
			W11	450	1500
			W12	450	1500
			W13	450	1500
			W14	450	1500

TITLE :- BLOCK-1
5TH TO 7TH & 8TH FLOOR PLAN
PROPOSED B+G+22 STORIED (76.7 m HIGH) RESIDENTIAL BUILDING FOR BLOCK 1 AND SINGLE STORED MERCANTILE BUILDING OF HT. 6.7 m FOR BLOCK 2 (CONSIDERING U/R 69A (1)(C) OF KMC BUILDING RULE 2009 READ WITH U/S - 393 A OF K.M.C ACT 1980) AT PRE. NO.11, DESHPAN SHASMAL ROAD, P.S-CHARU MARKET, WARD NO-89, BOROUGH-X, KOLKATA-700033.

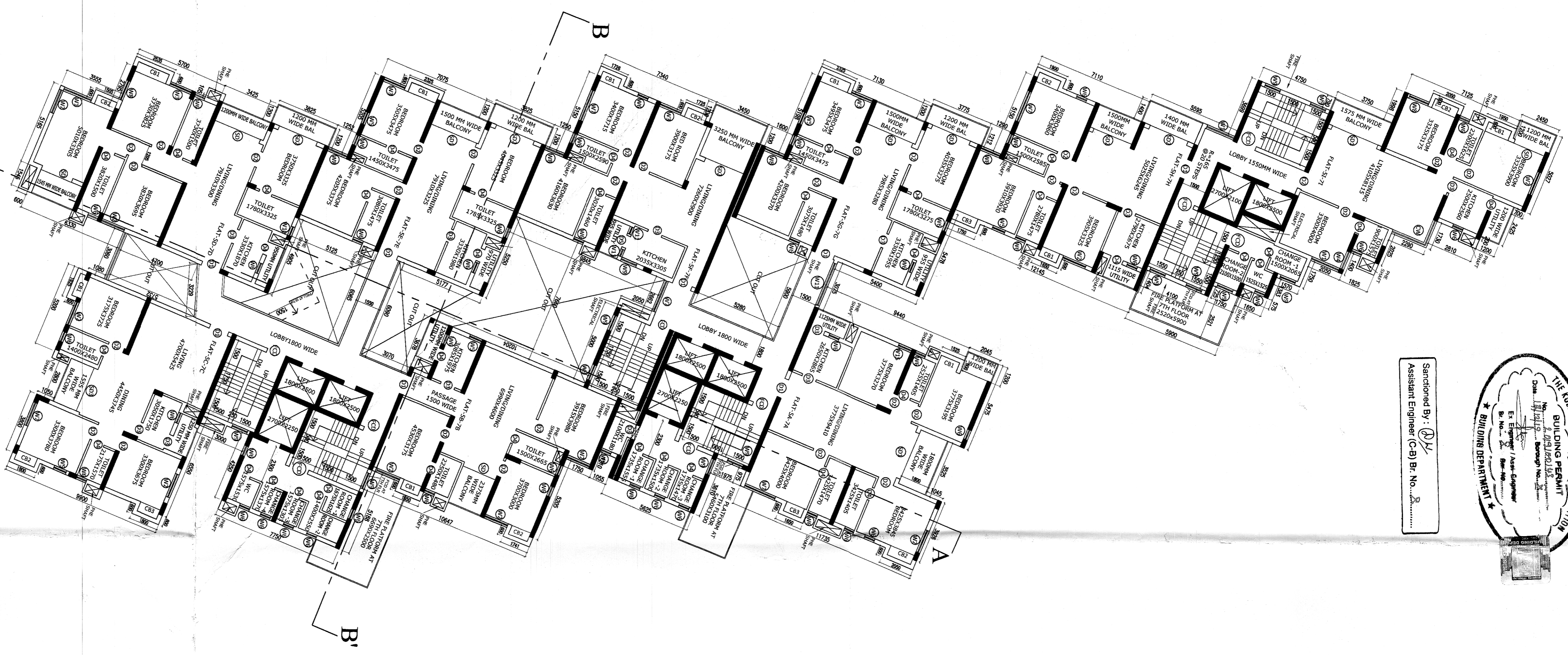

5TH TO 7TH FLOOR PLAN

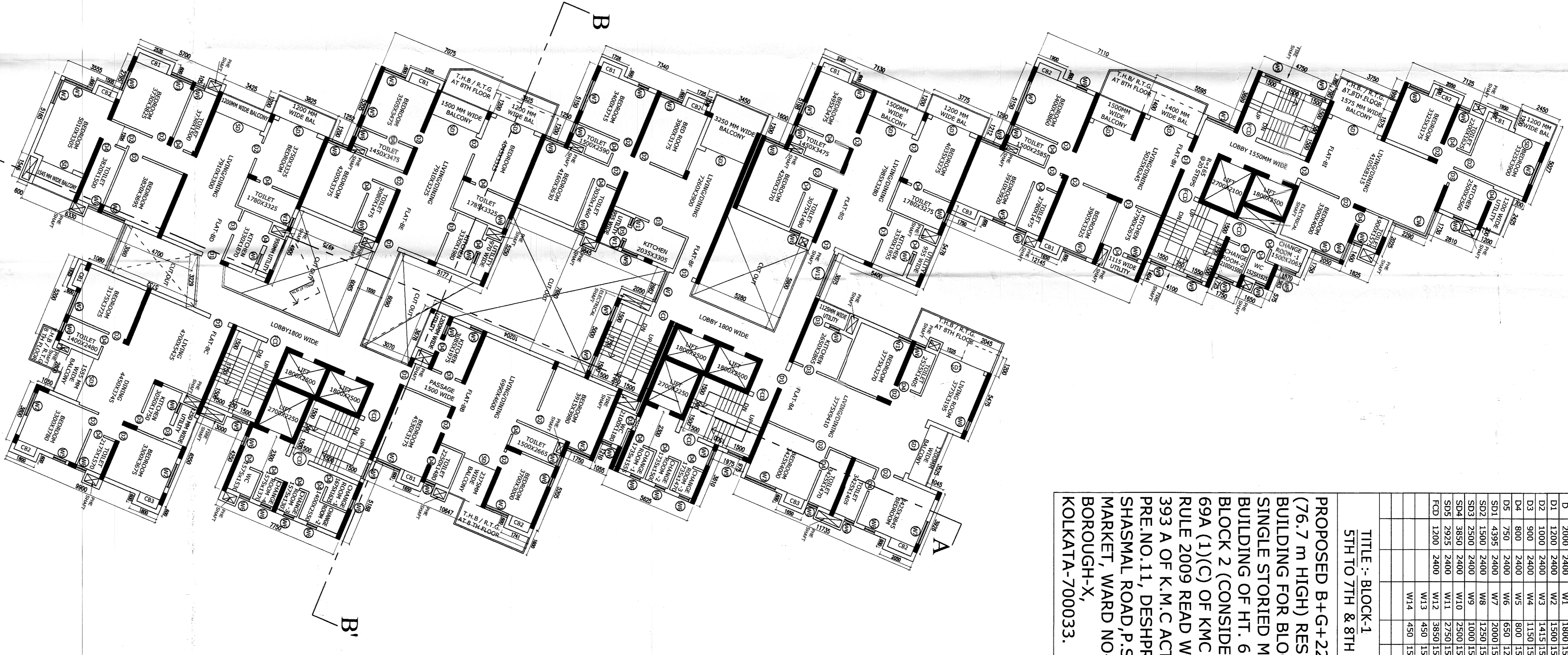

8TH FLOOR PLAN

DECLARATION OF OWNERS
 I/WE HEREBY DECLARE WITH FULL RESPONSIBILITY THAT I/WE SMALL ENGAGE ARCHITECT & S.E. DURING CONSTRUCTION, SHALL FOLLOW THE INSTRUCTIONS OF ARCHITECT & S.E. DURING CONSTRUCTION OF THE BUILDING AS PER B.S.P.L.M.
 K.M.C. AUTHORITY WILL NOT BE RESPONSIBLE FOR STRUCTURAL STABILITY OF THE BUILDING AND AUTHORITY WILL REMOVE THE SANCTION PLAN IN THE EVENT OF WATER RESERVOR AND SEPTIC TANK WILL BE UNDERGIVEN UNDER THE GUIDENCE OF E.E. ARCHITECT BEFORE STARTING OF BUILDING FOUNDATION WORK. PLOTS IDENTIFIED BY THE PLANNING AUTHORITY OF K.M.C. AUTHORITY WILL BE UNDERGIVEN UNDER THE GUIDENCE OF E.E. ARCHITECT BEFORE STARTING OF BUILDING FOUNDATION WORK.
 SIGNATURE OF OWNER

DECLARATION OF GEOTECH ENGINEER
 INVESTIGATION HAS INSPECTED THE SITE AND CARRIED OUT SOIL INVESTIGATION THEREON. IT IS CERTIFIED THAT THE EXISTING SOIL OF THE SITE IS ABLE TO CARRY THE LOAD COMING FROM THE PROPOSED CONSTRUCTION AND THE FOUNDATION SYSTEM PROPOSED HEREIN IS SAFE & STABLE IN ALL RESPECT FROM GEO TECHNICAL POINT OF VIEW.
 SIGNATURE OF GEOTECH ENGINEER (U/11)

DECLARATION OF STR. ENGINEER
 THE STRUCTURAL DESIGN AND DRAWING OF BOTH FOUNDATION AND SUPER STRUCTURE OF THE BUILDING HAS BEEN MADE BY ME CONSIDERING ALL POSSIBLE LOADS INCLUDING SEISMIC LOAD AS PER THE NATIONAL BUILDING CODE OF INDIA AND CERTIFIED THAT IT IS SAFE AND STABLE IN ALL RESPECTS. SOIL TESTING HAS BEEN DONE BY MR. ALOK ROY (MS GEOTECH ENGINEER) AT TIDOR MECHANICAL REPAIR WORKS. THE RECOMMENDATION OF SOIL TEST REPORT HAS BEEN CONSIDERED DURING STRUCTURAL CALCULATIONS.
 SIGN. OF STRUCTURAL ENGINEER

DECLARATION OF ARCHITECT
 CERTIFIED WITH FULL RESPONSIBILITY THAT THE BUILDING PLAN HAS BEEN DRAWN UP AS PER PROVISION OF K.M.C. BUILDING RULES 2009 AS AMENDED FROM TIME TO TIME AND THAT THE SITE CONDITIONS INCLUDING THE WIDTH OF THE ADJOINING ROAD COMPLY WITH THE PLAN AND WHICH HAS BEEN MEASURED AND VERIFIED BY ME.
 * IT IS A BUILDABLE SITE AND NOT A TANK OR FILED UP TANK.
 * THE PLOTS SWACANT & REMARKED BY ROADSIDE WALL WILL BE COMPLETED BEFORE STARTING OF BUILDING FOUNDATION.
 SIGNATURE OF ARCHITECT

ARCHITECTS :-
 THE DESIGN CELL
 2A COOPER STREET, KOLKATA - 700 026

SIGNATURE OF ARCHITECT
[Signature]
 VIRENDRA KUMAR CHAUDHA
 ARCHITECT
 REG. NO. CA/89/1764

DATE:- 28.11.19
Scale :- 1:150

PARTY'S COPY

Plan for Water Supply arrangement including SEMU, G & O/H. Reservoir should be submitted to the Office of the Ex-Engineer Water Supply and the sanction obtained before proceeding with the work of Water Supply any deviation may lead to disconnection/demolition.

CONSTRUCTION SITE SHALL BE MAINTAINED TO PREVENT MOSQUITO BREEDING AS REQUIRED UNDER 486 (1) & (2) OF CMG ACT 1980. IN SUCH MANNER SO THAT ALL WATER COLLECTION & PARTICULARLY LEFT WEALS, WATS, BASEMENT CUNING SITES, OPEN RECEPTACLES ETC. MUST BE EMPTIED COMPLETELY TWICE A WEEK.

Sanctioned By: *[Signature]*
Assistant Engineer (C-2) B. No. 100/1919

Approved By: *[Signature]*
The Building Committee 21/12/19

Before starting any Construction the site must conform with the plans sanctioned and all the conditions as proposed in the plan should be fulfilled.
The validity of the written permission to execute the work is subject to the above conditions.

The sanction refers to the proposed portion shown in red and the Executive Engineers makes no admission as to the correctness of the plan.

Design of all Structural Members including that of the foundation should conform to Standards specified in the National Building Code of India.

All Building Materials to necessary & construction should conform to standards specified in the National Building Code of India.

Necessary steps should be taken for the safety of the lives of the adjoining public and private properties during construction.

Non Commencement of Erection/ Re-Erection within Five year will Require Fresh Application for Sanction.

DEVIATION WOULD MEAN DEMOLITION

RESIDENTIAL BUILDING

A suitable pump has to be provided i.e. pumping unfiltered water for the distribution to the flushing cisterns and urinals in the building increase unfiltered water from street main is not suitable.

The building materials that will be stacked on Road/Passage or Foot-path beyond 3-metres or after construction of G. Floor, whichever is earlier may be seized forthwith by the K.M.C. at the cost and risk of the owner.

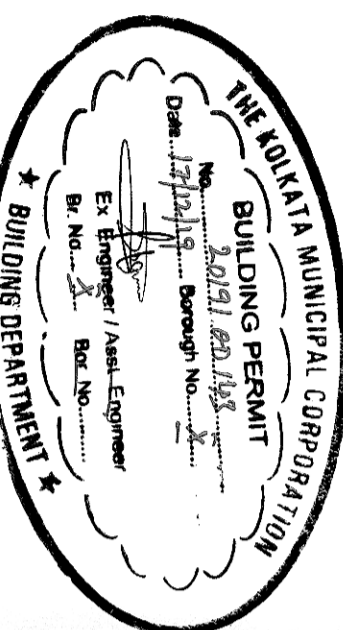

THE SANCTION IS VALUED UP TO: *1,40,000/-*

Sanctioned subject to demolition of open spaces as per plan before construction is started.
[Signature]
Executive Engineer (C) B. PLAN
Asst-Engineer (C)

No rain water pipe should be fixed or discharged on Road or Footpath. Drainage plan should be submitted at the Borough Executive Engineer's Office and the sanction obtained before proceeding with the drainage work.

Any unauthorised construction done in deviation from the Sanction Building permit and the Completion Plans may cause revocation of the Occupancy Certificate.

Sanctioned conditionally on an undertaking to be signed till they will not evict any tenants & will also provide the tenants with identical area in and around the premises by mutual arrangements.

13/12/2019

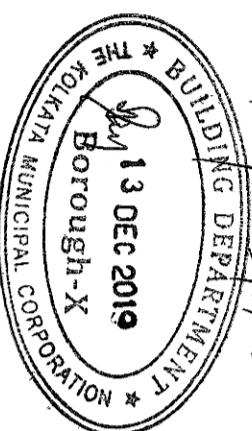

APPROVED

[Signature]

A. Premises concerned need to be taken for pollution free environment:-

- a) Where construction area/building with concrete fabric retaining dust barriers, or other actions, as appropriate for the location.
- b) Apply water mist or fog to the visible dust in a visible form or control condition for temporary stabilisation.
- c) Apply water mist or fog to the visible dust in a visible form or control condition for temporary stabilisation, in order to prevent or reduce any other such moving activity to keep the soil moist throughout the process.
- d) Limit vehicle speed to 5 kmph on the right side.
- e) Control dust from the site of the building under construction.
- f) Apply a cover or screen to enclose any road works or construction activities at completion of earth by water and maintain a distance of 50 metres from the road.
- g) Apply a cover or screen to enclose any road works or construction activities at completion of earth by water and maintain a distance of 50 metres from the road.
- h) Maintain a distance of 50 metres from the road.
- i) Maintain a distance of 50 metres from the road.
- j) Maintain a distance of 50 metres from the road.
- k) Maintain a distance of 50 metres from the road.
- l) Maintain a distance of 50 metres from the road.
- m) During construction work, including grading of mounds, suitable area level should not exceed more than 500mm.

6. Practices to be observed for pollution free environment:-

- a) Don't dispose of debris indiscriminately.
- b) Don't cut materials without proper dust control/cover facility.
- c) Don't keep materials without effective cover.
- d) Don't keep materials without effective cover.
- e) Don't keep materials without effective cover.
- f) Don't leave the soil, sand and cement stacks uncovered.
- g) Don't keep materials or debris uncovered.
- h) Don't keep materials or debris uncovered.
- i) Don't keep materials or debris uncovered.
- j) Don't keep materials or debris uncovered.
- k) Don't keep materials or debris uncovered.
- l) Don't keep materials or debris uncovered.
- m) Don't keep materials or debris uncovered.
- n) Don't keep materials or debris uncovered.
- o) Don't keep materials or debris uncovered.
- p) Don't keep materials or debris uncovered.
- q) Don't keep materials or debris uncovered.
- r) Don't keep materials or debris uncovered.
- s) Don't keep materials or debris uncovered.
- t) Don't keep materials or debris uncovered.
- u) Don't keep materials or debris uncovered.
- v) Don't keep materials or debris uncovered.
- w) Don't keep materials or debris uncovered.
- x) Don't keep materials or debris uncovered.
- y) Don't keep materials or debris uncovered.
- z) Don't keep materials or debris uncovered.

Extensive P. No. 100/1919
The Kottayam Municipal Corporation
Building Department, B-X
Dated: 13/12/2019