





SITE PLAN FOR PROP. G+V STD. RESIDENTIAL FLAT BUILDING. OF YOGADA HOUSING PROJECT PVT. LTD.
 AT MOUZA - BAHIRSARBAMANGALA, J.L NO -42, MAHALLA - B.S. PARA, R.S. PLOT NO.- 1561,1562, 1564, R.S. KH. NO.-348,
 L.R. PLOT NO.- 4143, L.R. KH. NO.- 16510, HOLDING NO.- 15, WARD NO.- 01, UNDER BURDWAN MUNICIPALITY, P.S. & DIST - BURDWAN.
 SCALE :- 1:200
 HEIGHT OF BUILDING- 18.75 M.

AREA OF LAND = 3246.005 SQ.M. = 34940 SFT.
 NATURE OF LAND = BASTU / VITI
 EXT. CONSTRUCTION SHOWN BY --- 
 PROPERTY LINE SHOWN BY --- 
 ROAD SHOWN BY --- 
 DRAIN SHOWN BY --- 

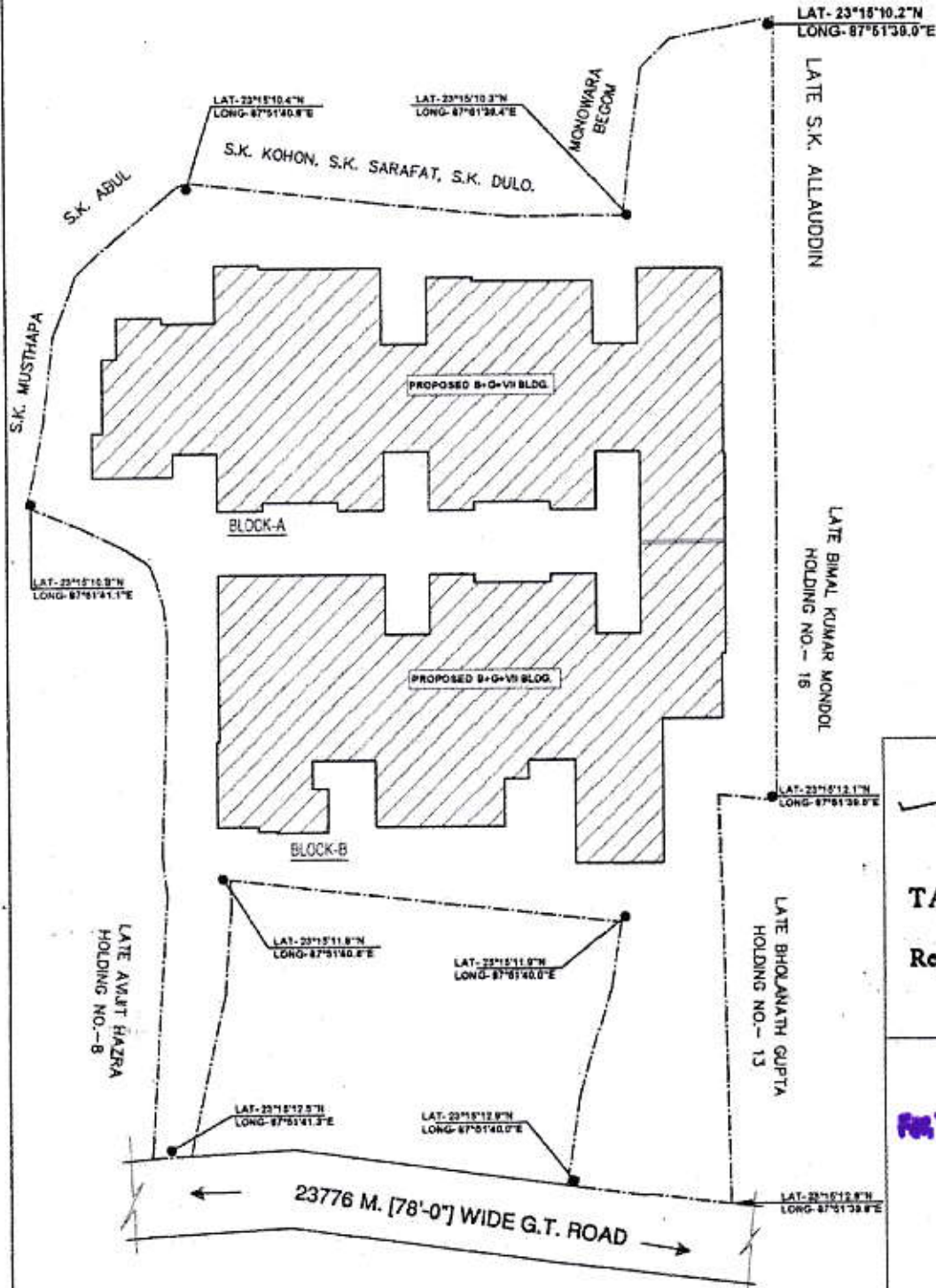

SITE PLAN
 SCALE:- 1:500

Tamal Chaudhuri

TAMAL CHAUDHURI
 B. Arch
 Regd no:- CA/2002/29203

SIGNATURE OF ARCHITECT

FOR YOGADA HOUSING PROJECT, PVT. LTD.

Mahendra Kumar Shaw
 Director

SIGNATURE OF OWNERS

DATE- 06.04.2019

SCALE:- 1:600

