

SITE PLAN OF PREMISES NO:- 3, PARK LANE, KOLKATA:- 700016,
BOROUGH:- VI, P.S. PARK STREET. WITHIN THE K.M.C.

SCALE- 1:100

AREA OF LAND :- 05 KA. 04 CH. 26 SFT.
= 353.586 SQ.MT.
SHOWN IN RED COLOUR.

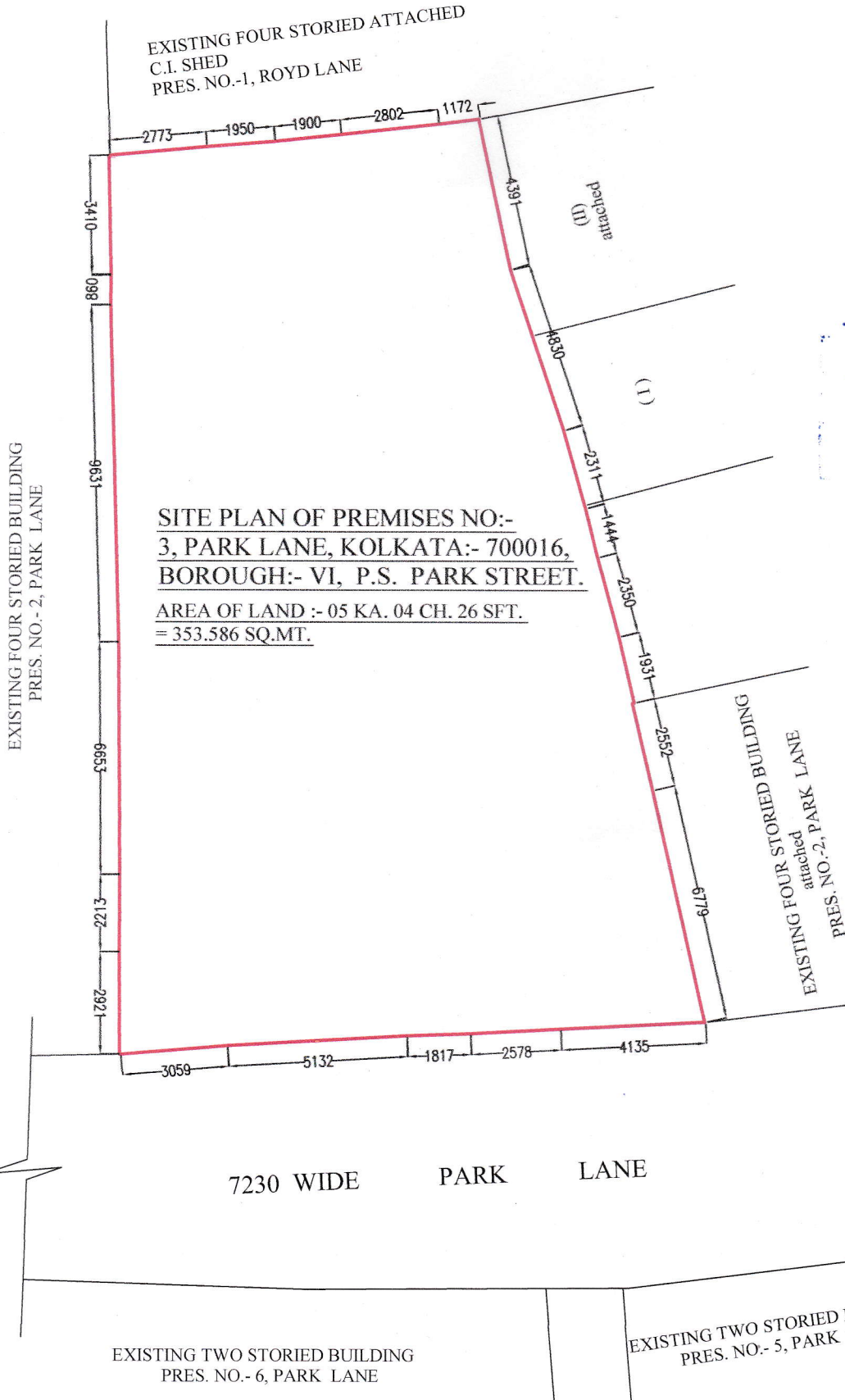
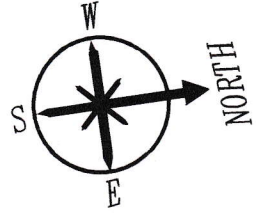

Supratim Choudhury
SUPRATIM CHOUDHURY
B. (Arch)
Regd. No.-CA/2002/28856
Council of Architecture.
SIGNATURE OF ARCHITECT

SIGNATURE OF OWNER/S

SITE PLAN