

THE SITE PLAN SHOWING THE PROPOSED G+III STORED COTTAGE TYPE RESIDENTIAL BUILDING OF SMT. PIU CHATTERJEE, W/O SRI TAPAS CHATTERJEE, AT- GOPALPUR, ASANSOL, ON R.S PLOT NO - 953,941,942,952,L.R PLOT NO-944,955,954,945,R.S.KH. NO-611,699,700,701,702,609,380,331,L.R.KH. NO-1074, MOUZA - GOPALPUR, J.L. NO - 10, WARD NO -55, P.S. - ASANSOL(S). DIST - PASCHIM BARDHAMAN. W.B. UNDER ASANSOL MUNICIPAL CORPORATION.

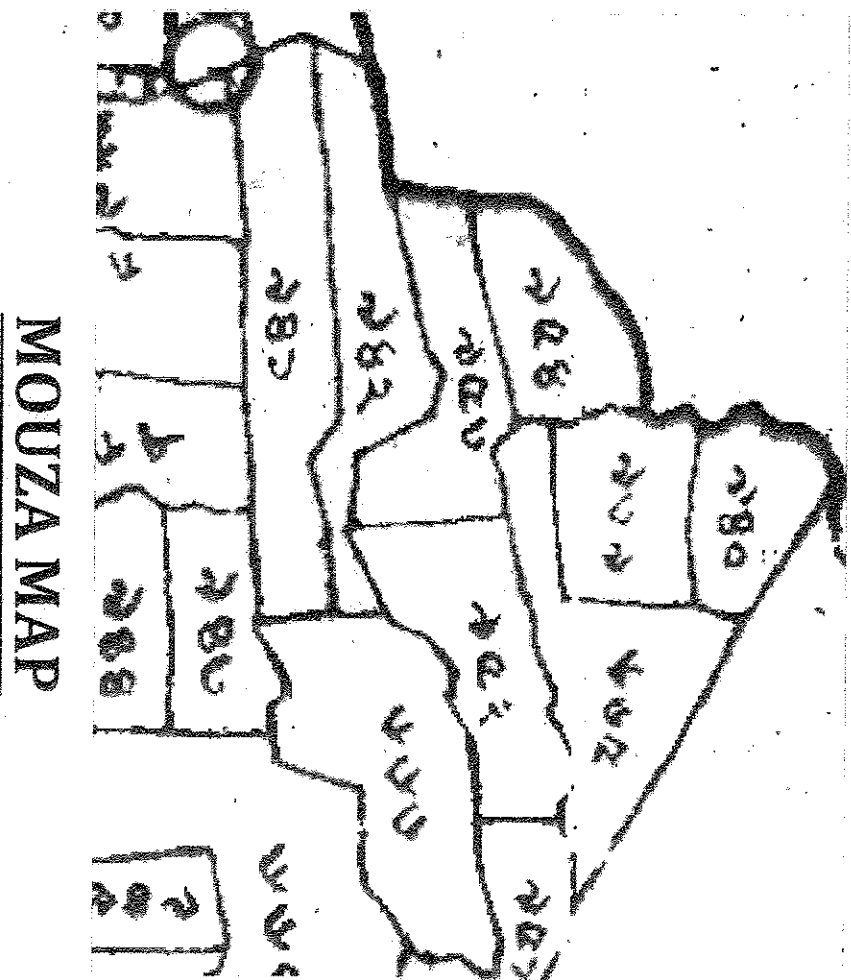

MOUZA MAP

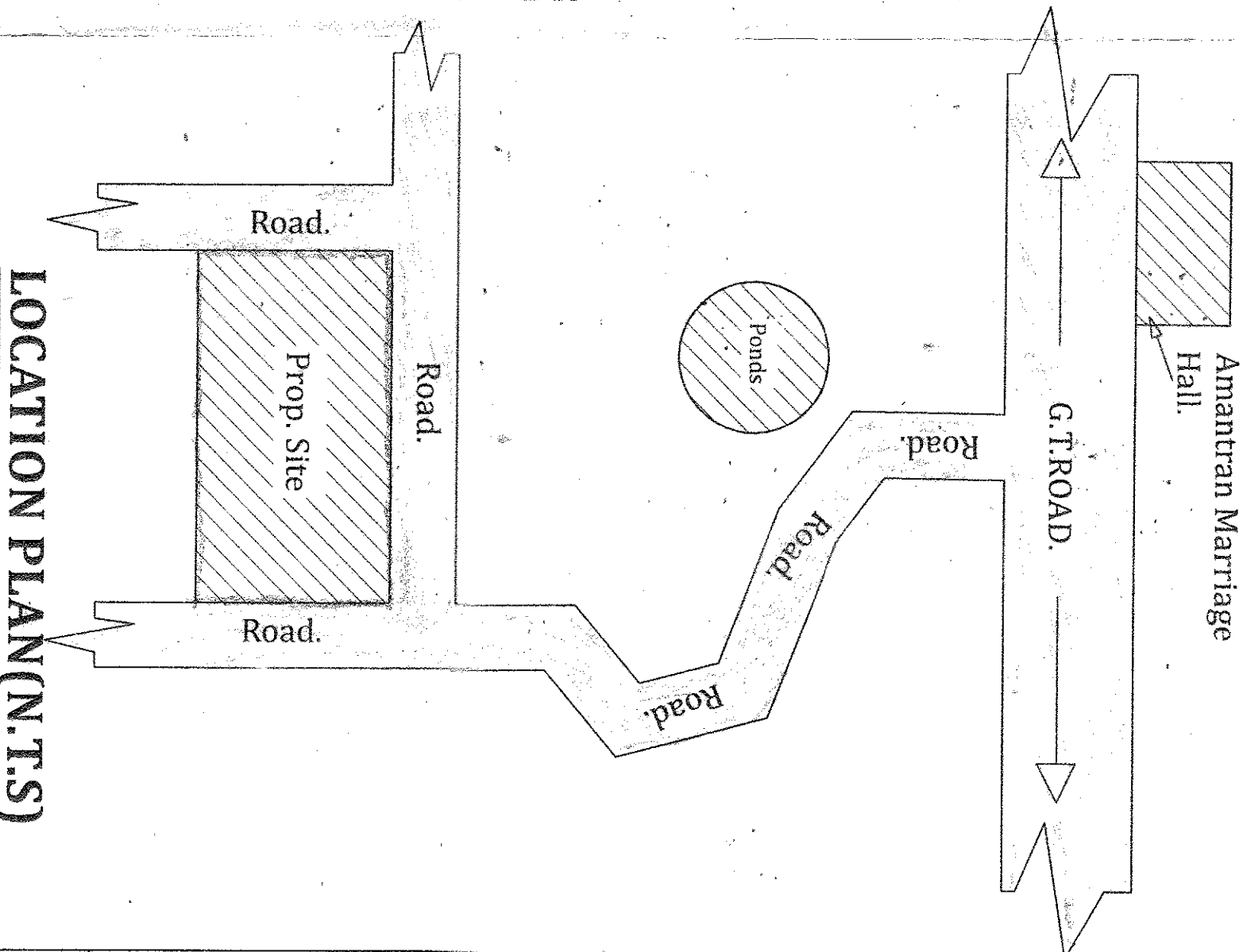

LOCATION PLAN(N.T.S)



SITE PLAN SCALE-1:200

OFFICE USE ONLY



Narayan Nayak  
19.03.2020  
Sub-Assistant Engineer  
Asansol Municipal Corporation

Assistant Engineer  
Asansol Municipal Corporation  
19.3.2020

Town Planner  
Asansol Municipal Corporation  
Executive Engineer  
Asansol Municipal Corporation

SITE PLAN APPROVED  
SECRETARY  
Asansol Municipal Corporation

MEMO No. 815/SPL/AMC/140/2020  
DATE 01.6.2020

**ABSTRACT AREA STATEMENT :-**

LAND AREA - 18 KH. - 12 CH. - 55 SQ.FT.=1254.659 SQ.M.  
CORNER PLAY FREE GIFTED TO A.M.C.=5.600 SQ.M.  
EFFECTIVE LAND AREA =1249.059  
EXISTING ACCESS: 5.250 METER WIDE ROAD.  
PERMISSIBLE FAR : 1.750  
PROPOSED HEIGHT : 12.80 M.  
PERMISSIBLE GROUND COVERAGE :624.529 SQ.M. i.e (50%)  
PROPOSED GROUND COVERAGE (232.212+181.865+169.871)  
= 583.948 SQ.M. i.e (46.751%)  
GROUND FLOOR AREA : (201.842+179.866+167.996)  
= 549.704 SQ.M.  
1ST FLOOR AREA : (227.212+175.666+158.415) =561.293 SQ. M.  
2ND FLOOR AREA : (210.542+179.865+167.998) = 558.405 S. M.  
3RD FLOOR AREA : (226.987+175.666+160.265) = 562.918 SQ.M.  
TOTAL FLOOR AREA : = 2244.32 SQ.M.  
FAR CALCULATION :  
TOTAL FLOOR AREA : = 2244.32 SQ.M.  
TOTAL SERVICE AREA : (69.044 + 71.808 + 102.856)  
= 243.708 SQ.M.  
TOTAL NET FLOOR AREA : (2244.32 - 243.708)  
= 2000.612 SQ.M.  
F.A.R = 2000.612 /1249.059 = 1.601

**DECLARATION OF ENGINEER**  
I HAVE CERTIFIED ON THE PLAN ITSELF WITH FULL RESPONSIBILITY THAT BUILDING RULES 1990 AS AMENDED FROM TIME TO TIME AND THAT THE SITE CONDITIONS INCLUDING THE ADJOINING ROAD CONFORM WITH THE PLAN AND THAT IT IS A BUILDABLE SITE AND NOT A TANK OR A FILLED UP LAND.

Suvarakar Chaudhuri  
B.C.E. M.I.G.S. I.C.W.A. M.E.  
Licence No: AMCO/4/075  
Structural Engineer  
Chartered Engineer(R-85389)  
Registered Valuer(VAL-462)  
Geotechnical Consultant

**STRUCTURAL CERTIFICATE**  
THE STRUCTURAL DESIGN AND DRAWING OF BOTH FOUNDATION AND CONSIDERING ALL POSSIBLE LOADS INCLUDING THE SEISMIC LOAD AS SUPERSTRUCTURE OF THE BUILDING HAS BEEN MADE BY ME PER NATIONAL BUILDING CODE OF INDIA AND CERTIFIED THAT IT IS SAFE AND STABLE IN ALL RESPECT.

Suvarakar Chaudhuri  
B.C.E. M.I.G.S. I.C.W.A. M.E.  
Licence No: AMCO/4/075  
Structural Engineer  
Chartered Engineer(R-85389)  
Registered Valuer(VAL-462)  
Technical Consultant

P. Chatterjee  
SIGNATURE OF OWNER

SIGNATURE OF STRUCTURAL ENGINEER