

LOCATION DETAILS OF THE PROJECT :-

SITE PLAN OF G+IV STOREYED (BLOCK - I, BLOCK - II) & II STOREYED (BLOCK - III)
RESIDENTIAL BUILDING AT PRE. NO. - 15, DR. N. G. SAHA ROAD, WARD NO. - 128,
BOROUGH - XIV, P.S. - BEHALA, KOLKATA - 700061, UNDER K.M.C.

CO-ORDINATES OF BOUNDARY LINE :-

	LATITUDE	LONGITUDE
1.	22° 29' 15" N	88° 17' 42" E
2.	22° 29' 15" N	88° 17' 43" E
3.	22° 29' 12" N	88° 17' 42" E
4.	22° 29' 12" N	88° 17' 44" E

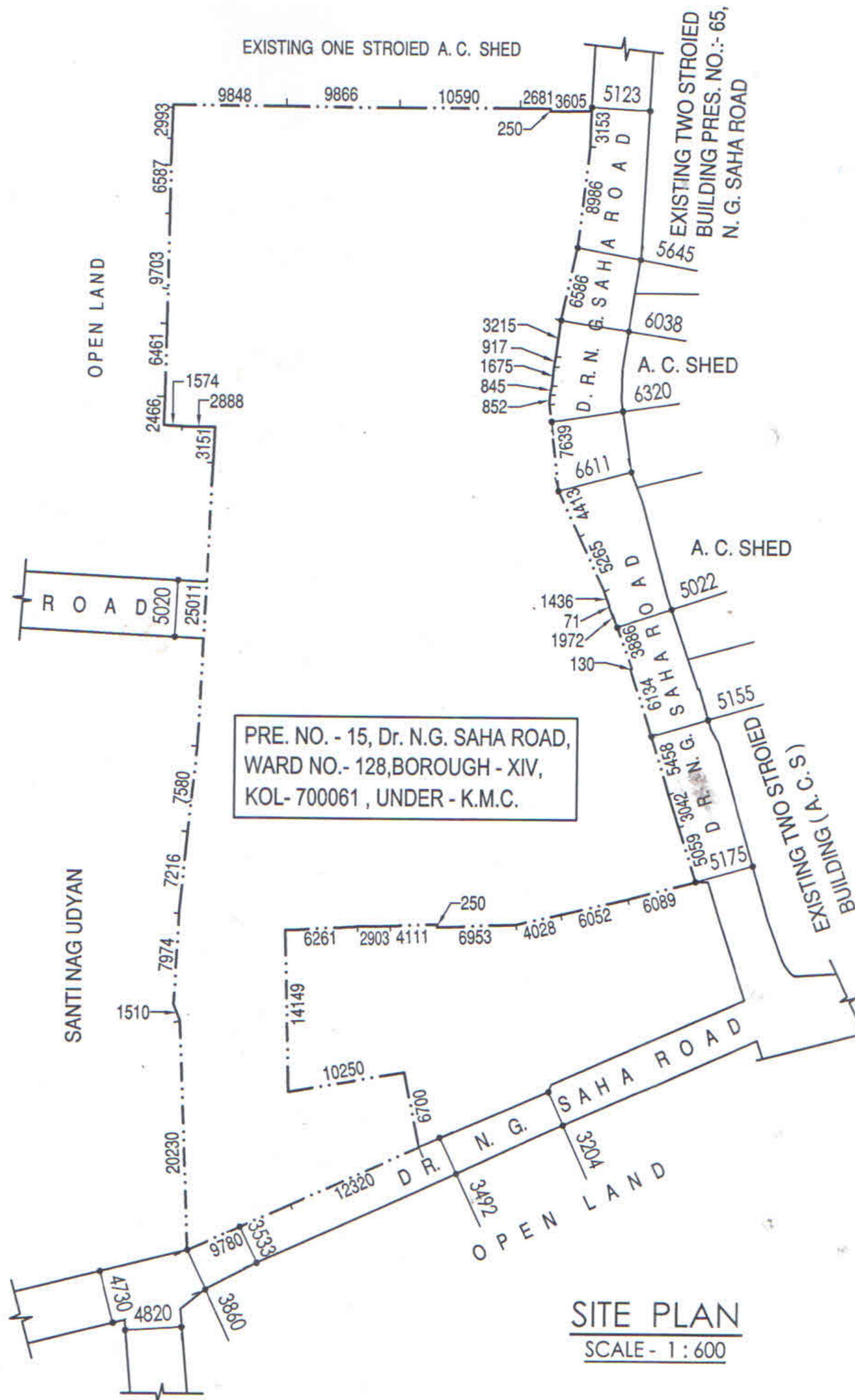

Somali Guha
SOMALI GUHA
B. ARCH. (CAL.), A. I.I.A.
REGN. No. CA/92/14663

