



No. 035990

BY SPEED POST

Phone : 2225-3438
2225-3734

KOLKATA IMPROVEMENT TRUST

Engineering Department (8th Floor)
P-16, India Exchange Place Extension
Kolkata - 700 073

No. 2E / OB / CE / / VIII-18 / 5905

Dated 05-09-18

Sri / Smt. BASANT KUMAR PARAKH

Tirupati Tower Pvt. Ltd.,
1, Garstin Place, The Orbit, Ground Floor,
P. O. - G.P.O.,
Kolkata - 700 001.

Re :- 50, Jnan Goswami Sarani,
Ward No. - 81,
Borough No.- X,
Kolkata - 700 053 .

Dear Sir / Madam,

In reply to your letter No.....NIL.....dated 13/08/2018.....

I have to inform you that the site/building plan submitted with your application has been examined with Trust Plan/Records. Accordingly the above property is not affected at present by any published / sanctioned Scheme / Alignment of the Trust.

The above observation has to be read with the copy of the site plan which is returned herewith duly endorsed on the reverse. The correctness of the site plan is not verified / certified.

Further, the letter should be treated as invalid or cancelled if any overwriting, erasing or any kind of disfiguration is made either on this letter or on the enclosed site plan.

Yours faithfully,

Chief Engineer

Kolkata Improvement Trust

Encl : Copy of endorsed site plan.

No. 2E / OB / CE / / / (1) /

Copy Forwarded to:-
D. G. BUILDING, K.M.C.
5, S. N. Banerjee Road
Kolkata-700013.

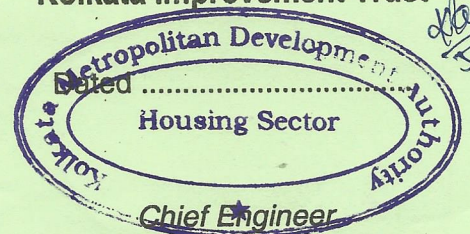

Kolkata Improvement Trust

SITE PLAN OF PREMISES NO. 50, JNAN GOSWAMI SARANI, (AMALGAMATED WITH 23A/159B, 23A/159C & 23A/159D, D. H. ROAD, BLOCK-G, NEW ALIPUR) WARD NO.-81, BOROUGH - X, P.S.- NEW ALIPORE, KOLKATA - 700053.

LAND AREA (12K.- 6CH.- 13 SQFT.) = 829.00 SQ.M. (M./L.)

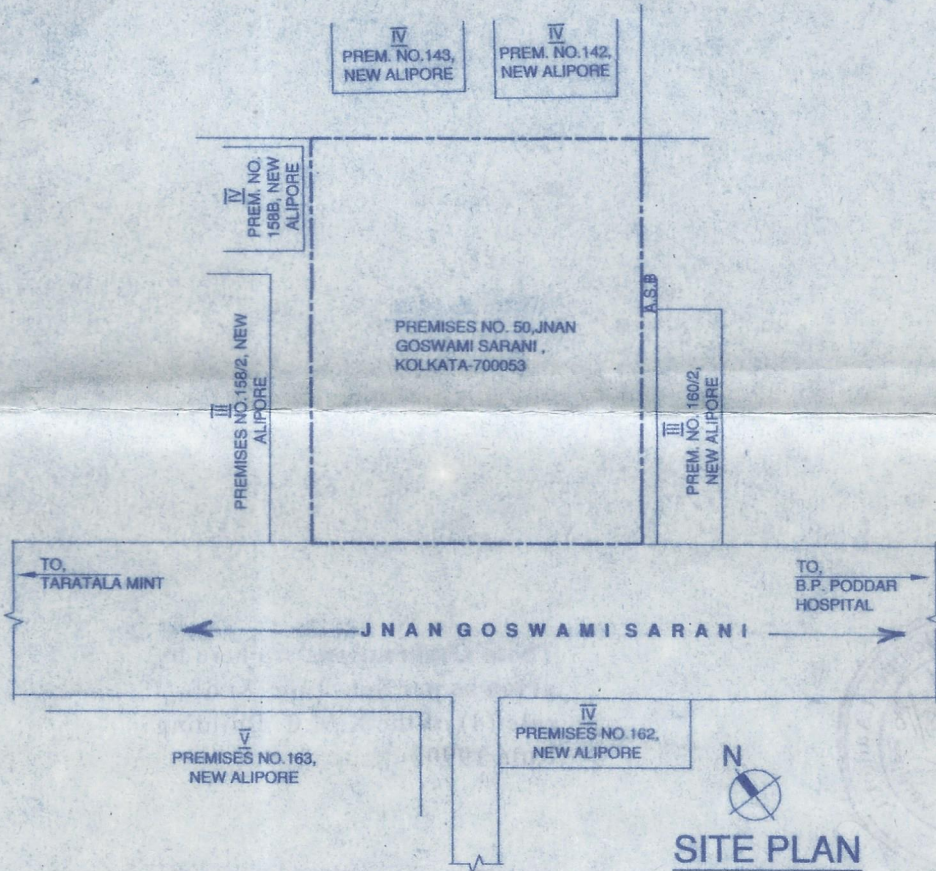

SITE PLAN
SCALE = 1 : 600

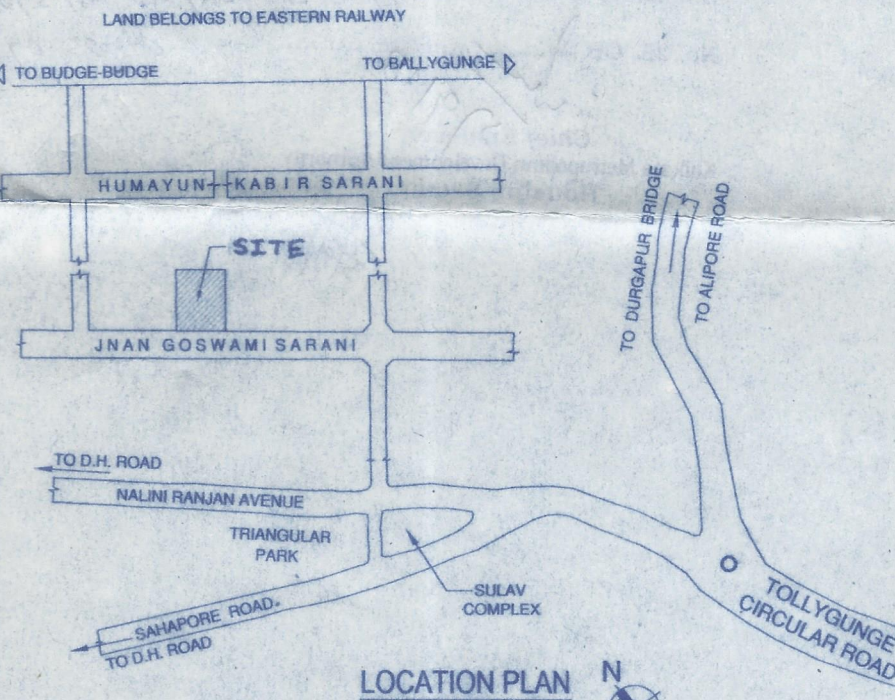

LOCATION PLAN
SCALE = 1 : 4000

BASANT KUMAR PARAKH

(Handwritten Signature)

DIRECTOR OF
TIRUPATI TOWER PVT. LTD.
CONSTITUTED ATTORNEY OF
1. DR. (MRS.) SARBANI MUKHERJEE
2. DR. BISWAJIT BANERJEE
3. DR. INDRAJIT BANERJEE

SIGNATURE OF APPLICANT'S



[Handwritten signature]
16/8/18

These Observations are here by given as per Sub-Rule (8) of rule (4) of the K.M.C. Building Rule 1990

This Plan was enclosed with Party's applications. The correctness of the plan is not verified / Certified Enclosure to the Letter

No. 2E, OB No. Date.....

2E/OB/CE/707/VIII-18/5905

dt. 05.09.18

[Handwritten signature]
Chief Engineer

Kolkata Metropolitan Development Authority
Housing Sector

[Handwritten signature]
5/9/18

BASANT KUMAR PANDA
DIRECTOR OF
KOLKATA METROPOLITAN DEVELOPMENT AUTHORITY
HOUSING SECTOR

Letter No. - 2E/OB/CE/707/VIII-18/ 5905

DATE ...05...09.18

BY SPEED POST

3T

700091 10.09.2018

0B25 00016436

EMS SPEED POST



EW 19017276 9IN

183

If undeliverable, please return to :-

KOLKATA METROPOLITAN DEVELOPMENT AUTHORITY
(Erstwhile Kolkata Improvement Trust)
O. B. Cell, Chief Engineer's Department,
UmayanBhawan, DJ-11, Sector-II, 1st Floor, Block-A,
Salt Lake, Kolkata - 700 091.
~~**KOLKATA IMPROVEMENT TRUST**~~

DEPARTMENT

P-16, INDIA EXCHANGE PLACE EXTENSION
K.I.T. Office Building (6th to 10th Floor)
KOLKATA - 700 073

BASANT KUMAR PARAKH

Tirupati Tower Pvt. Ltd.,

1, Garstin Place, The Orbit, Ground Floor,

P. O. - G.P.O.,

Kolkata - 700 001.



PO: Park Street HD-700016

0177769TH

10/09/2018, 12:03

0.0001:30gms
:18.00

SECH BHANAN S.O <700091>
Sesidch ICH Hub
Sesidch ICH Hub