

NOTES:-

- THIS DRAWING SHALL BE READ IN CONJUNCTION WITH ARCHITECTURAL DRAWING, SPECIFICATIONS AND SCHEDULE OF BEAMS.
- ALL DIMENSIONS ARE IN FEET & INCHES UNLESS OTHERWISE STATED.
- ALL REINFORCING SHALL BE IN ACCORDANCE WITH IS:1786 (1983) & IS:1786 (1983) PART 2.
- ALL REINFORCING SHALL BE IN ACCORDANCE WITH IS:1786 (1983) & IS:1786 (1983) PART 2.
- ALL REINFORCING SHALL BE IN ACCORDANCE WITH IS:1786 (1983) & IS:1786 (1983) PART 2.
- ALL REINFORCING SHALL BE IN ACCORDANCE WITH IS:1786 (1983) & IS:1786 (1983) PART 2.
- ALL REINFORCING SHALL BE IN ACCORDANCE WITH IS:1786 (1983) & IS:1786 (1983) PART 2.
- ALL REINFORCING SHALL BE IN ACCORDANCE WITH IS:1786 (1983) & IS:1786 (1983) PART 2.
- ALL REINFORCING SHALL BE IN ACCORDANCE WITH IS:1786 (1983) & IS:1786 (1983) PART 2.
- ALL REINFORCING SHALL BE IN ACCORDANCE WITH IS:1786 (1983) & IS:1786 (1983) PART 2.
- ALL REINFORCING SHALL BE IN ACCORDANCE WITH IS:1786 (1983) & IS:1786 (1983) PART 2.
- ALL REINFORCING SHALL BE IN ACCORDANCE WITH IS:1786 (1983) & IS:1786 (1983) PART 2.
- ALL REINFORCING SHALL BE IN ACCORDANCE WITH IS:1786 (1983) & IS:1786 (1983) PART 2.
- ALL REINFORCING SHALL BE IN ACCORDANCE WITH IS:1786 (1983) & IS:1786 (1983) PART 2.
- ALL REINFORCING SHALL BE IN ACCORDANCE WITH IS:1786 (1983) & IS:1786 (1983) PART 2.

SCHEDULE OF FLOOR BEAMS

BEAM M.D. TYPE	REINFORCEMENTS	STIRRUPS	SIZE & SPACING	REMARKS
FB-1	3-16# 2-12#	3-16#	2-8@8" 5/8"	
FB-2	3-16# 2-12#	3-16#	2-8@8" 5/8"	
FB-3	3-16# 2-12#	3-16#	2-8@8" 5/8"	
FB-4	3-16# 2-12#	3-16#	2-8@8" 5/8"	
FB-5	3-16# 2-12#	3-16#	2-8@8" 5/8"	
FB-6	3-16# 2-12#	3-16#	2-8@8" 5/8"	
FB-7	3-16# 2-12#	3-16#	2-8@8" 5/8"	
FB-8	3-16# 2-12#	3-16#	2-8@8" 5/8"	
FB-9	3-16# 2-12#	3-16#	2-8@8" 5/8"	
FB-10	3-16# 2-12#	3-16#	2-8@8" 5/8"	

SCHEDULE OF ISOLATED FOOTING

FOOTING M.D.	FOOTING DIMENSIONS	REINFORCEMENTS	REMARKS
F-1	12'0" TOR @ 5' C/C	12# TOR @ 5' C/C	
F-2	12'0" TOR @ 5' C/C	12# TOR @ 5' C/C	
F-3	12'0" TOR @ 5' C/C	12# TOR @ 5' C/C	
F-4	12'0" TOR @ 5' C/C	12# TOR @ 5' C/C	
F-5	12'0" TOR @ 5' C/C	12# TOR @ 5' C/C	
F-6	12'0" TOR @ 5' C/C	12# TOR @ 5' C/C	
F-7	12'0" TOR @ 5' C/C	12# TOR @ 5' C/C	
F-8	12'0" TOR @ 5' C/C	12# TOR @ 5' C/C	
F-9	12'0" TOR @ 5' C/C	12# TOR @ 5' C/C	
F-10	12'0" TOR @ 5' C/C	12# TOR @ 5' C/C	

SCHEDULE OF COLUMNS

COL. MARK	LEVEL	REINFORCEMENTS	REMARKS
C1, C2, C3, C4, C5, C6, C7, C8, C9, C10, C11, C12, C13, C14, C15, C16, C17, C18, C19, C20, C21, C22, C23, C24, C25	FOUNDATION TO 1ST FLOOR	8-16# 4-20#	
C1, C2, C3, C4, C5, C6, C7, C8, C9, C10, C11, C12, C13, C14, C15, C16, C17, C18, C19, C20, C21, C22, C23, C24, C25	2ND FLOOR TO ROOF	8-16# 4-20#	

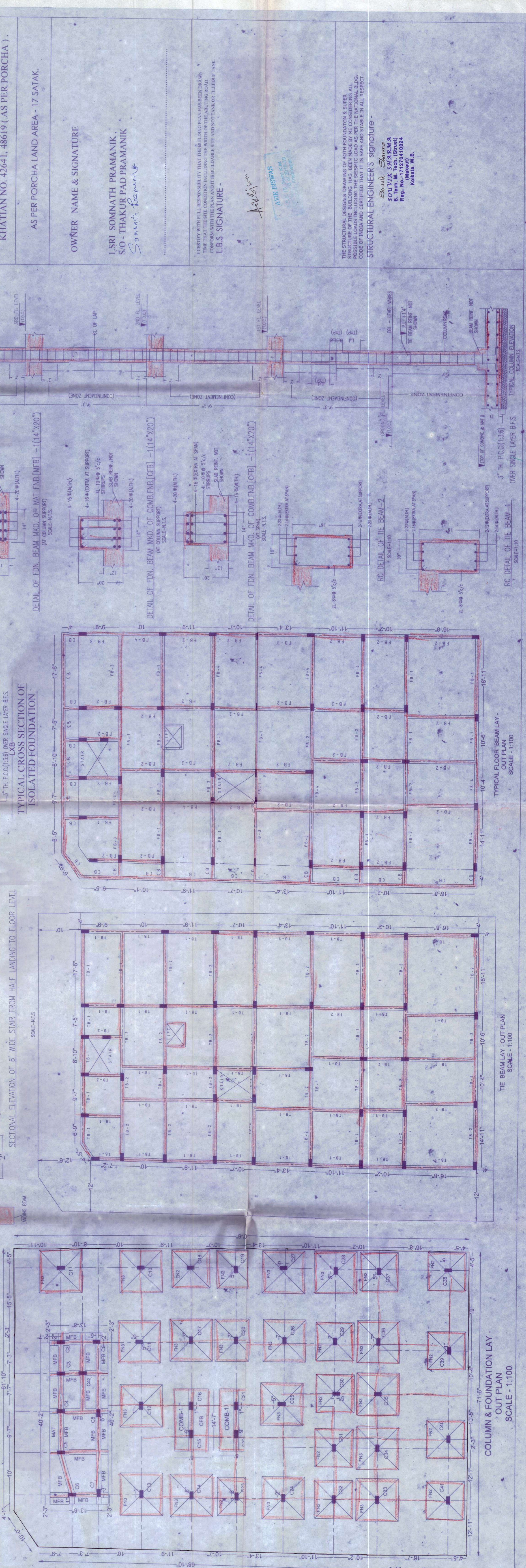
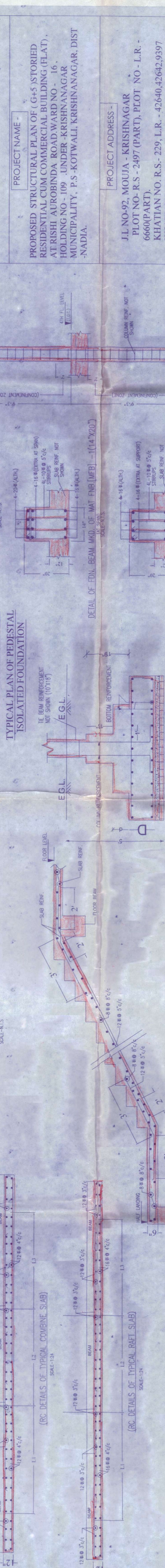
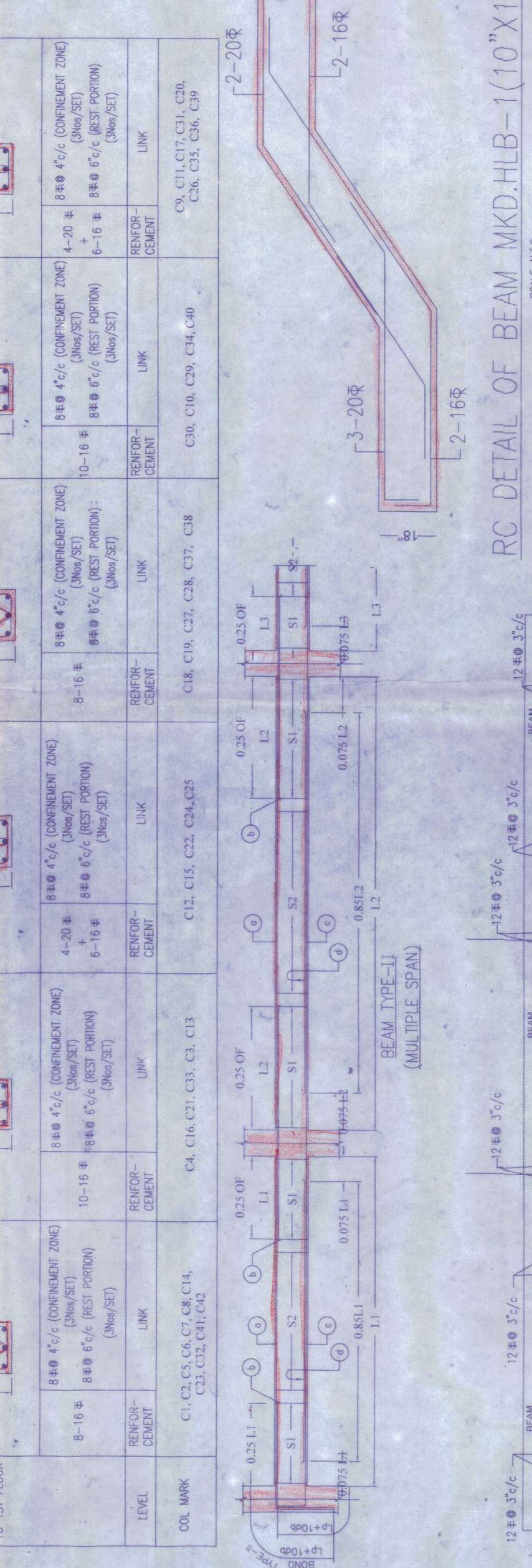
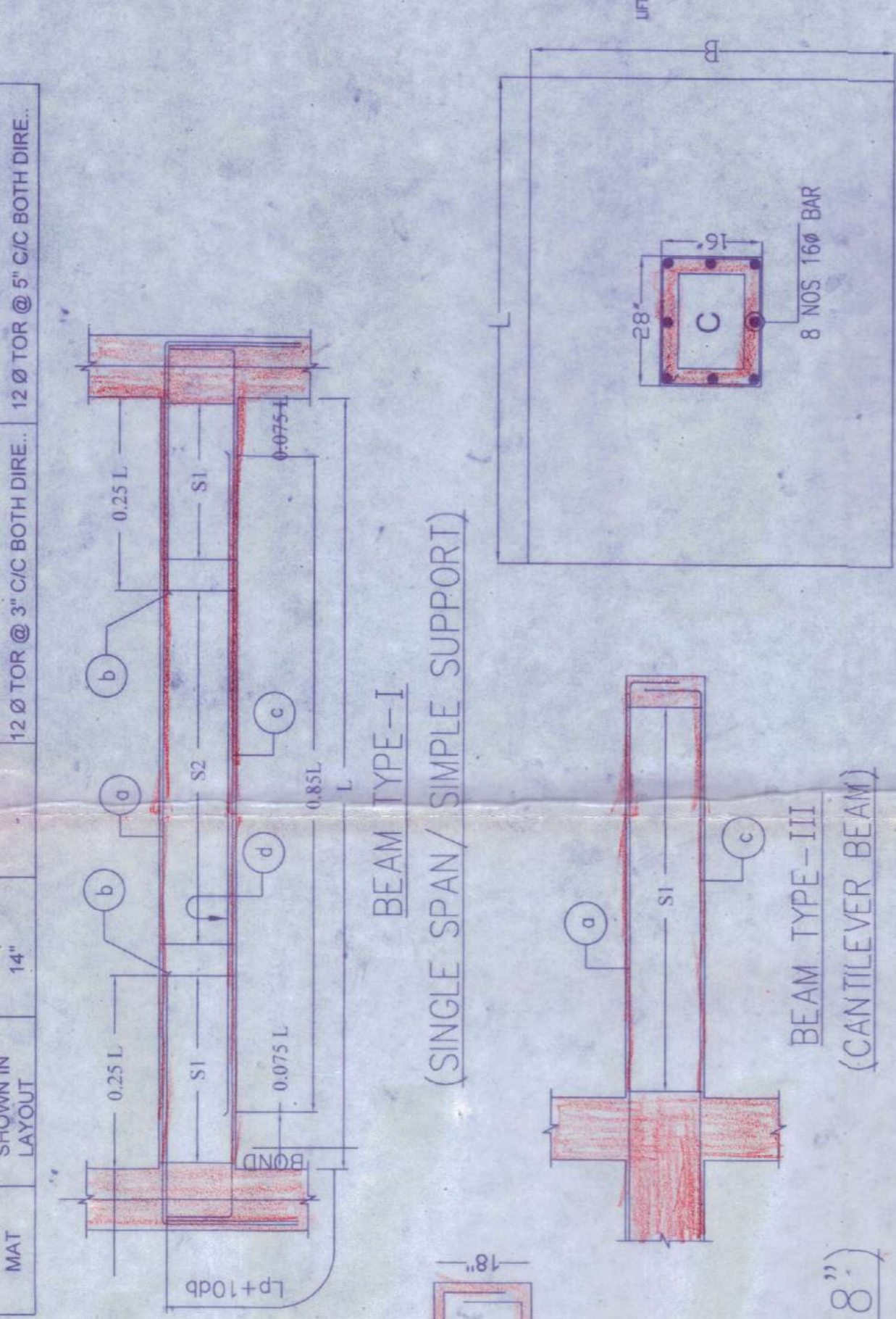
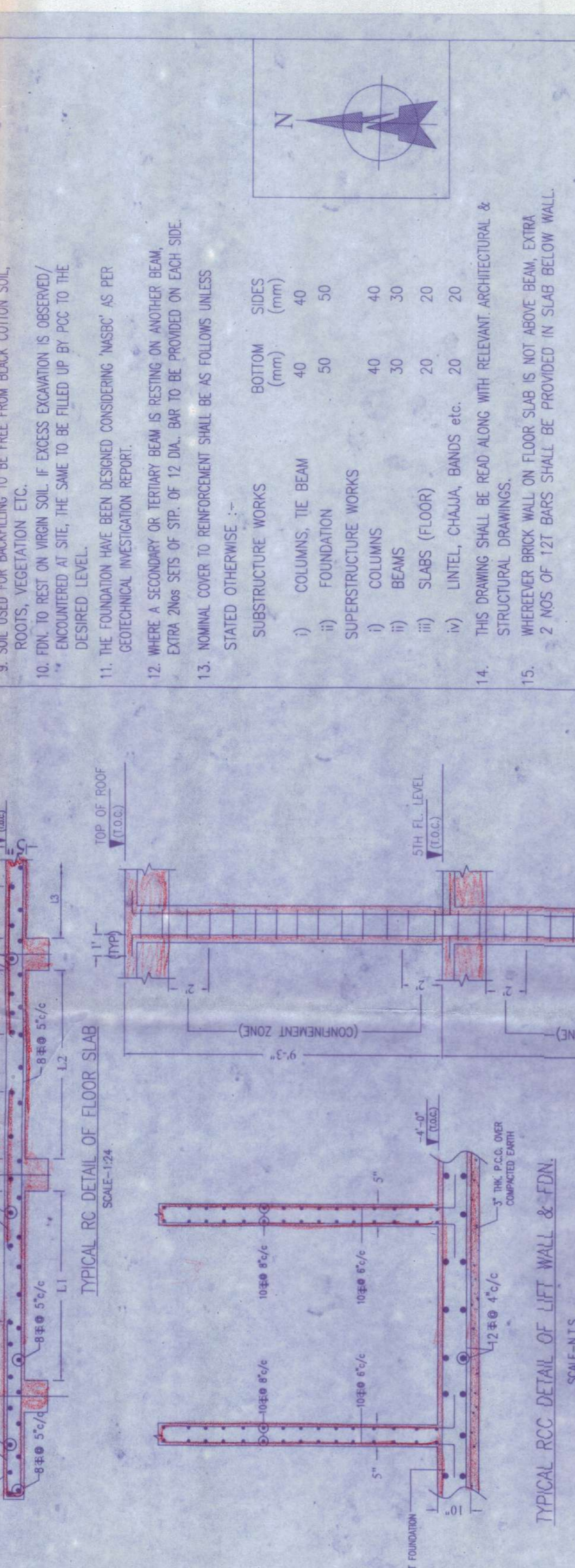

PROJECT NAME -
PROPOSED STRUCTURAL PLAN OF (G+5) STORIED RESIDENTIAL CUM COMMERCIAL BUILDING (FLAT), AT RISHI AUROBINDA ROAD, WARD NO. - 16, HOLDING NO. - 109, UNDER - KRISHNANAGAR MUNICIPALITY, P.S. - KOTWALI, KRISHNANAGAR, DIST - NADIA.

PROJECT ADDRESS -
JL NO-92, MOUJA - KRISHNANAGAR PLOT NO-R.S. - 2497 (PART), PLOT NO - L.R. - 6660(PART) KHATIAN NO. R.S. - 229, L.R. - 42640, 42642, 9397 KHATIAN NO. 42641, 48619 (AS PER PORCHA.)

AS PER PORCHA LAND AREA - 17 SATAK.

OWNER NAME & SIGNATURE
SRI SOMNATH PRAMANIK,
S/O - THAKUR PAD PRAMANIK
Somnath Pramanik

STRUCTURAL ENGINEER'S SIGNATURE
Sanku Chatterjee
SOMNATH PRAMANIK
Reg. No. - 171270410024
Kolkata, W.B.

1 CERTIFY WITH FULL RESPONSIBILITY THAT THE BUILDING PLAN HAS BEEN DRAWN & THAT THE SITE CONDITIONS INCLUDING THE WIDTH OF THE ADJUTING ROAD & THE ADJUTING ROAD IS BUILDABLE SITE, AND NOT TAKEN OR FILED UP PLAN. L.B.S. SIGNATURE -

REINFORCEMENTS

- 1) COLUMNS, TIE BEAM 40
- 2) FOUNDATION 50
- 3) SUPERSTRUCTURE WORKS 50
- 4) COLUMNS 40
- 5) BEAMS 40
- 6) SLABS (FLOOR) 20
- 7) LINTEL, CHAJJA, BANUS etc. 20

BOTTOM SIZES (mm)

- 1) COLUMNS, TIE BEAM 40
- 2) FOUNDATION 50
- 3) SUPERSTRUCTURE WORKS 50
- 4) COLUMNS 40
- 5) BEAMS 40
- 6) SLABS (FLOOR) 20
- 7) LINTEL, CHAJJA, BANUS etc. 20

11. THE FOUNDATION HAS BEEN DESIGNED CONSIDERING 'MISK' AS PER GEOTECHNICAL INVESTIGATION REPORT.

12. WHERE A SECONDARY OR TERTIARY BEAM IS RESTING ON ANOTHER BEAM, EXTRA 2nos SETS OF STP. OF 12. DIA. BAR TO BE PROVIDED ON EACH SIDE.

13. NOMINAL COVER TO REINFORCEMENT SHALL BE AS FOLLOWS UNLESS STATED OTHERWISE:-

14. THIS DRAWING SHALL BE READ ALONG WITH RELEVANT ARCHITECTURAL & STRUCTURAL DRAWINGS.

15. WHEREVER BRICK WALL ON FLOOR SLAB IS NOT ABOVE BEAM, EXTRA 2 NOS OF 12# BARS SHALL BE PROVIDED IN SLAB BELOW WALL.