

# SITE PLAN FOR

**SWAPNABHUMI REALTORS LIMITED**  
**MOUZA-CHARISWAR, J.L NO-29,**  
**PART OF R.S & L.R DAG NO-48,**  
**L.R KH. NO-1974, UNDER BEONTA II**  
**GRAM PANCHYET, P.S-KOLKATA**  
**LEATHER COMPLEX (BHANGAR),**  
**DIST- 24 PGS.(S)**

**AREA OF LAND 05 KA. 08 CH. 00 SFT.**  
**OR 09.09 DEC. OUT OF 94 DEC.**  
**SHOWN IN HATCH MARK.**



SCALE-1"=50'-0"

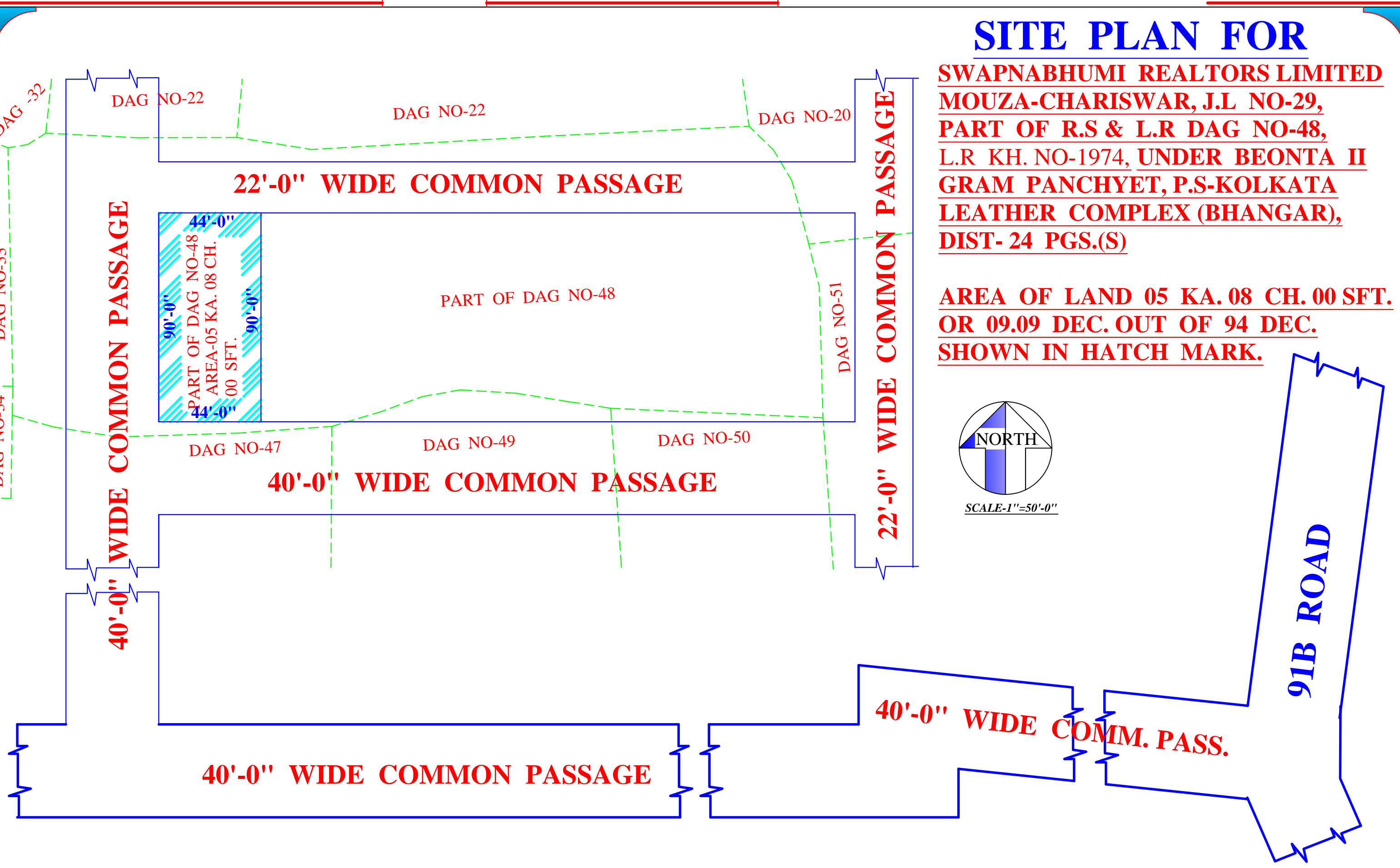

PRODUCED BY AN AUTODESK EDUCATIONAL PRODUCT

PRODUCED BY AN AUTODESK EDUCATIONAL PRODUCT