

I-28 = 130 to 138-1417/1969

B.K.Pur



पश्चिम बंगाल पश्चिम बंगाल WEST BENGAL

53AB 394075

1-1417/69

PLAM



विलेख	रुपये
(1) Rs	2
(2) Rs	2
Stamp	525
P.S.	658
Plat. Fee	10
Total Rs	1080

Signed Sealed and delivered by applicant as per order dt. 31/90 22/2/21

A.D.S.R. (Recorder)

14 FEB 2021

M/S SAMADDAR ENTERPRISE
Koushik Samaddar
Proprietor

True copy

PARTITION PLAN SHOWING INDIVIDUAL SHARES ON PART OF C.S. DAG NO. 1257. THANA - TITAGAR UNDER BARRACK - POPE MUNICIPALITY. SCALE: 1" = 15' 0".

DETAILS OF OWNER.

PLOT - NAME -

- P-1 - HETUNJOY GHOSH - 820 SF
- P-2 - ADIL KR GHOSH - 828 "
- P-3 - SUNIL KR GHOSH - 828 SF
- P-4 - SUSHIL KR GHOSH - 820 SF
- P-5 - SUKUMAR GHOSH - 828 SF

AREA
 820 SF
 828 "
 828 SF
 820 SF

L. MAHARAYA GHOSH. M.K. 3011
 A. D. S. R. BIKRAN
 SIKHAR
 A. D. S. R. BIKRAN

7' 0" 56' 0" 53' 0" 50' 0" 50' 0" 43' 0"

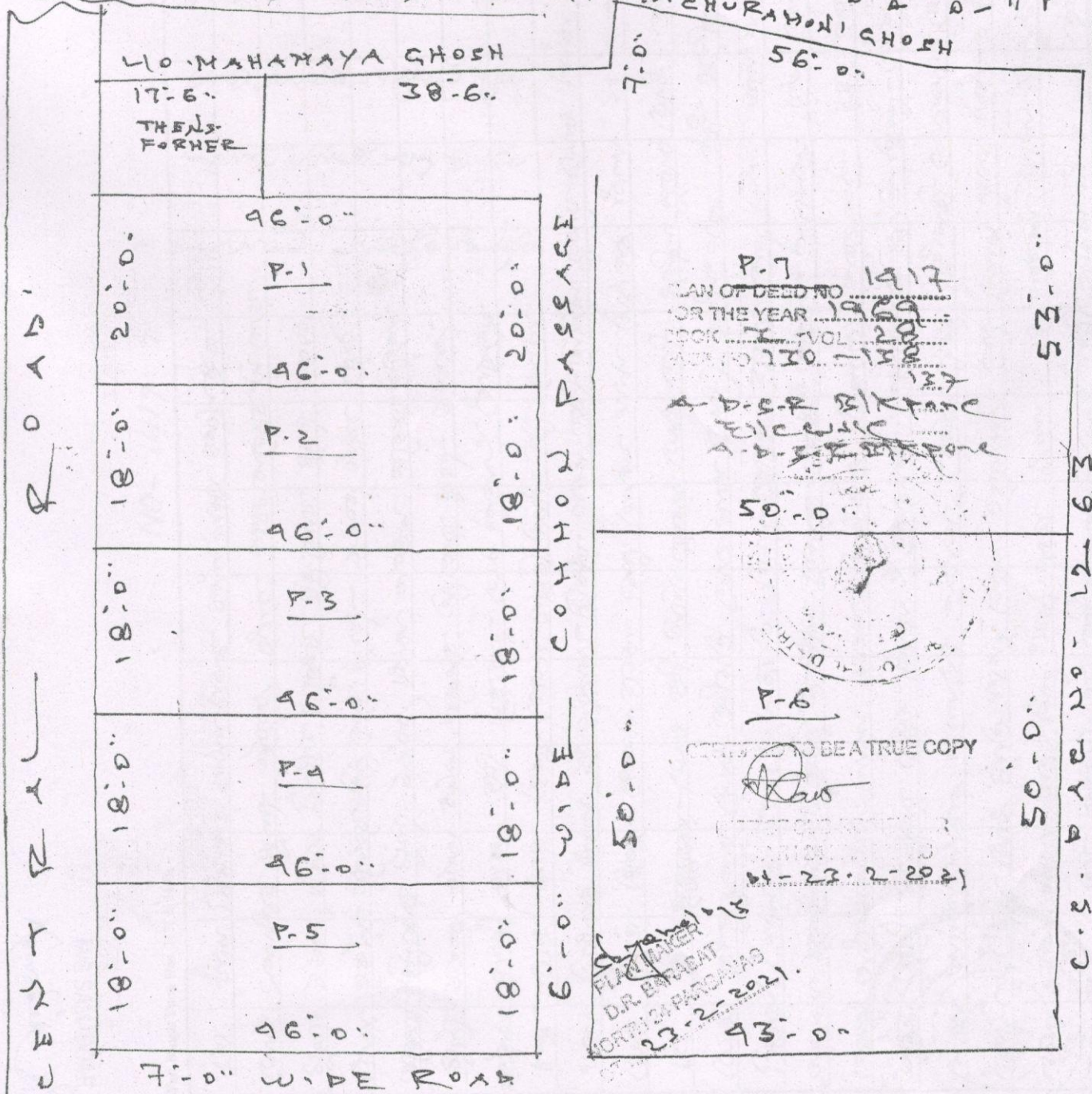

P.7 1917
 PLAN OF DEED NO. 1917
 FOR THE YEAR 1959
 BOOK 2 VOL 209
 PAGE NO 130 - 137

A. D. S. R. BIKRAN
 SIKHAR
 A. D. S. R. BIKRAN



P-6
 CERTIFIED TO BE A TRUE COPY
 [Signature]
 21-23-2-2021

23-2-2021
 43' 0"

REST OF C.S. DAG - 1257.

1	2	3	4	5	6	7	8	9	10	11	12	13	14	15	16	17	18	19	20	21	22	23	24	25	26	27	28	29	30	31	32	33	34	35	36	37	38	39	40	41	42	43	44	45	46	47	48	49	50	51	52	53	54	55	56	57	58	59	60	61	62	63	64	65	66	67	68	69	70	71	72	73	74	75	76	77	78	79	80	81	82	83	84	85	86	87	88	89	90	91	92	93	94	95	96	97	98	99	100
---	---	---	---	---	---	---	---	---	----	----	----	----	----	----	----	----	----	----	----	----	----	----	----	----	----	----	----	----	----	----	----	----	----	----	----	----	----	----	----	----	----	----	----	----	----	----	----	----	----	----	----	----	----	----	----	----	----	----	----	----	----	----	----	----	----	----	----	----	----	----	----	----	----	----	----	----	----	----	----	----	----	----	----	----	----	----	----	----	----	----	----	----	----	----	----	----	----	----	-----

5
NO-1417

West Bengal Form Nos. 1455 & 1486.



Stamp No. /001
Stamp No. /9
Stamp No. 25.601

Apply stamped under the Stamp Act, 1899
1st July 1957
57-58-59-60-61-62-63-64-65-66-67-68-69-70-71-72-73-74-75-76-77-78-79-80-81-82-83-84-85-86-87-88-89-90-91-92-93-94-95-96-97-98-99-100

69-70-71-72-73-74-75-76-77-78-79-80-81-82-83-84-85-86-87-88-89-90-91-92-93-94-95-96-97-98-99-100
S. K. Banerjee
Proprietor

Proprietor for Registration
Sub-Registrar, Office
1st July 1957
S. K. Banerjee
Proprietor

M/S SAMADDAR ENTERPRISE
Kamalika Samaddar
Proprietor

69-70-71-72-73-74-75-76-77-78-79-80-81-82-83-84-85-86-87-88-89-90-91-92-93-94-95-96-97-98-99-100
S. K. Banerjee
Proprietor

