

PROPOSED SITE PLAN OF G+III STORIED RESIDENTIAL BUILDING AT PREMISES NO.-57, TEACHERS COLONY, BELGHARIA, KOL-56, MOUZA-BASUDEVPUR, KHATIAN NO.-6, HOLDING NO.-365, WARD NO.-24, C.S./R.S.DAG NO.-113,114,115,116, & 117, P.O.-AGARPARA, P.S.-BELGHARIA, DIST.-24PARGANAS (NORTH) UNDER KAMARHATI MUNICIPALITY. SITE PLAN NO. 24E/19-25

LOT-A = 02 KH.-0 CH.-0 SQ.FT. = 133.82 SQ.M. = 1440 SQ.FT. LOT-B = 01 KH.-1 CH.-0 SQ.FT. = 133.82 SQ.M. = 765 SQ.FT. LOT-C = 03 KH.-0 CH.-0 SQ.FT. = 200.74 SQ.M. = 2160 SQ.FT. TOTAL AREA OF LAND = 06 KH.-1 CH.-0 SQ.FT. = 465.66 SQ.M. = 4365 SQ.FT.

PROPOSED GROUND FLOOR AREA (54.72%) = 221.93 SQ.M. = 2388 SQ.FT. PROPOSED 1ST. FLOOR AREA = 221.93 SQ.M. = 2388 SQ.FT. PROPOSED 2ND. FLOOR AREA = 221.93 SQ.M. = 2388 SQ.FT. PROPOSED 3RD. FLOOR AREA = 221.93 SQ.M. = 2388 SQ.FT. TOTAL FLOOR AREA = 887.72 SQ.M. = 9552 SQ.FT.

HEIGHT OF THE BUILDING 11.0M FROM GROUND LEVEL.

NAME OF THE ASSESSEE:- (1) SMT. BINAPANI CHAKRABORTY, (2) SMT. CHABI RANI CHAKRABORTY, (3) SRI ARUN CHAKRABORTY, (4) SRI SHYAMAL CHAKRABORTY (5) SMT. BHARATI CHAKRABORTY, (6) SMT. SIMA MUKHERJEE, (7) SMT. MADHABI KUSARI, (8) SMT. DIPA BANIK, (9) SMT. SANDHYA DAS, (10) SMT. SIPRA DUTTA, (11) SRI ASHISH DAS (12) SMT. RAMA AICH, (13) SMT. RINKU DAS.

APPROVED  
KAMARHATI MUNICIPALITY  
24-11-2019

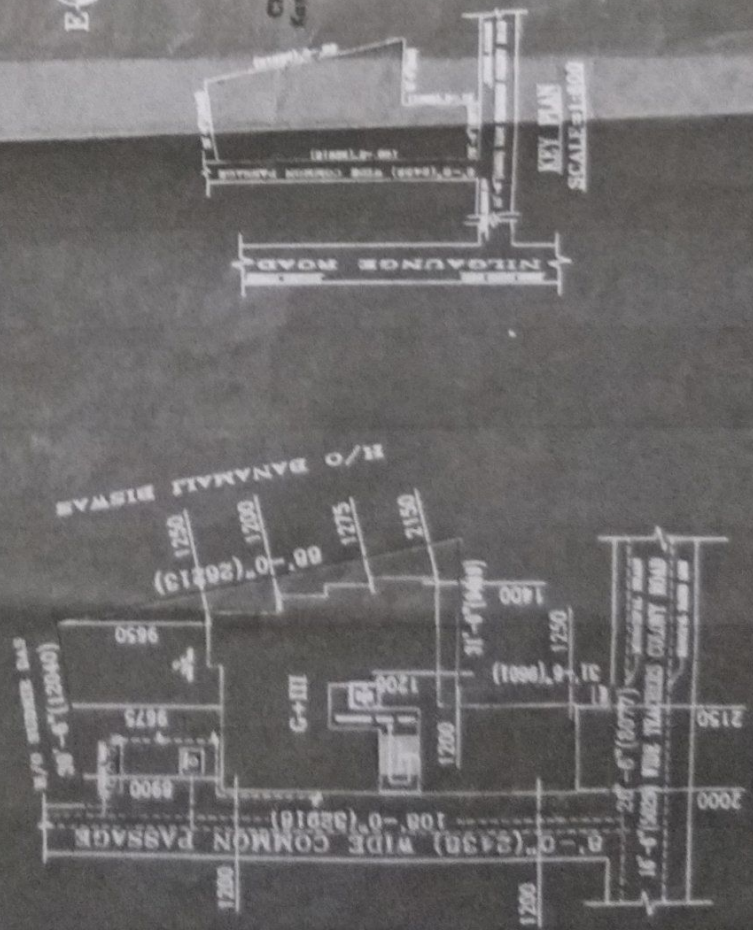

PROPOSED SITE PLAN  
SCALE=1:300

Signature of Consultant  
Member  
Chairman in Charge  
Kamarhati Municipality

SIGNATURE OF THE ENGINEER:

Signature of Owner  
Smt. Binapani Chakraborty  
Partner

SIGNATURE OF THE OWNER:  
CONSTITUTED POWER OF ATTORNEY

- (1) SMT. BINAPANI CHAKRABORTY (6) SMT. DIPA BANIK
- (2) SMT. CHABI RANI CHAKRABORTY (9) SMT. SANDHYA DAS
- (3) SRI ARUN CHAKRABORTY (10) SMT. SIPRA DUTTA
- (4) SRI SHYAMAL CHAKRABORTY (11) SRI ASHISH DAS
- (5) SMT. BHARATI CHAKRABORTY (12) SMT. RAMA AICH
- (6) SMT. SIMA MUKHERJEE (13) SMT. RINKU DAS
- (7) SMT. MADHABI KUSARI