

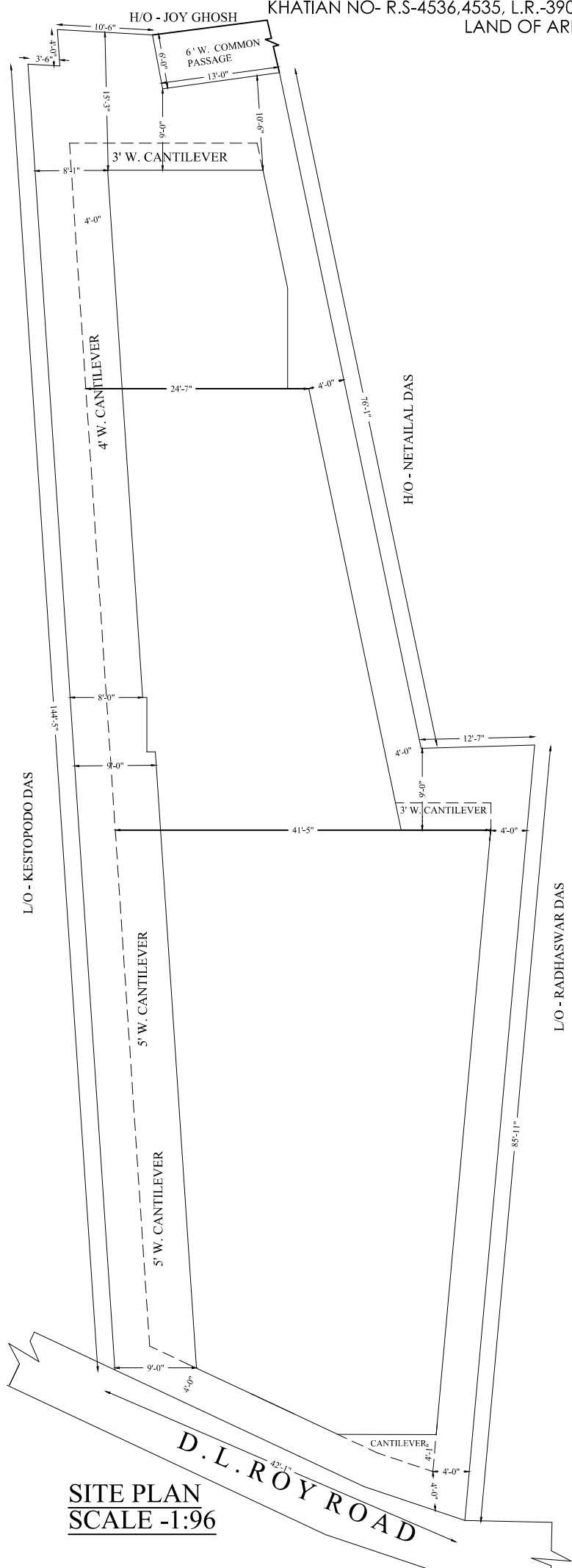

SITE PLAN SHOW IN FAVOUR OF SUSHANTA DAS , S/O LATE GOURANGA CHANDRA DAS AT D.L. ROY ROAD, UNDER KRISHNANAGAR MUNICIPALITY P.S - KOTWALI, DIST -NADIA, MOUZA - KRISHNAGAR , J.L. -NO - 92, PLOT NO: R.S-2326,2329. L.R-3840,3841 .  
 KHATIAN NO- R.S-4536,4535, L.R.-39066,3044,26426 WARD NO - 15, HOLDING NO -45  
 LAND OF AREA (13.33DEC),



**SITE PLAN**  
**SCALE -1:96**

<b>COLOUR CONVENTION :-</b> EXISTING YELLOW ○ ROAD GREEN ○ PLOT LINE BLACK ○	N 
---	--

Owner's name -  
 1.SUSHANTA DAS ,  
 S/O LATE GOURANGA CHANDRA DAS

<b>STRUCTURAL ENGG.</b>	<b>CHECKED BY -</b>
-------------------------	---------------------