

SITE PLAN ON R.S. PLOT NO. 2329 AND 2326 (PART) L.R. PLOT NO. 3840 AND 3841 (PART) RESPECTIVELY IN MOUZA KRISHNANAGAR J.L. NO. 92 P.S. KRISHNAGAR DIST. NADIA WARAND. OLD-14 NEW-15 HOLDING NO. 45, 45/1 AND 44/1 AT D.L. ROY ROAD UNDER THE KRISHNAGAR MUNICIPALITY

SCALE: 0"1" = 20'0"

OWNERS AREA COLOURED IN RED.

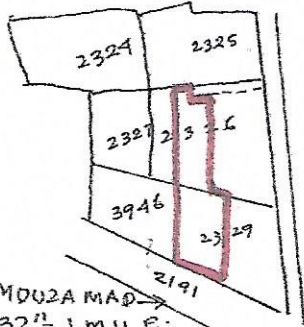

MOUZA MAD... 32 1/2 MILE.

G.P.S. LOCATION
 LATITUDE:- 23° 23' 40.7" (N)
 LONGITUDE:- 88° 29' 53.9" (E)

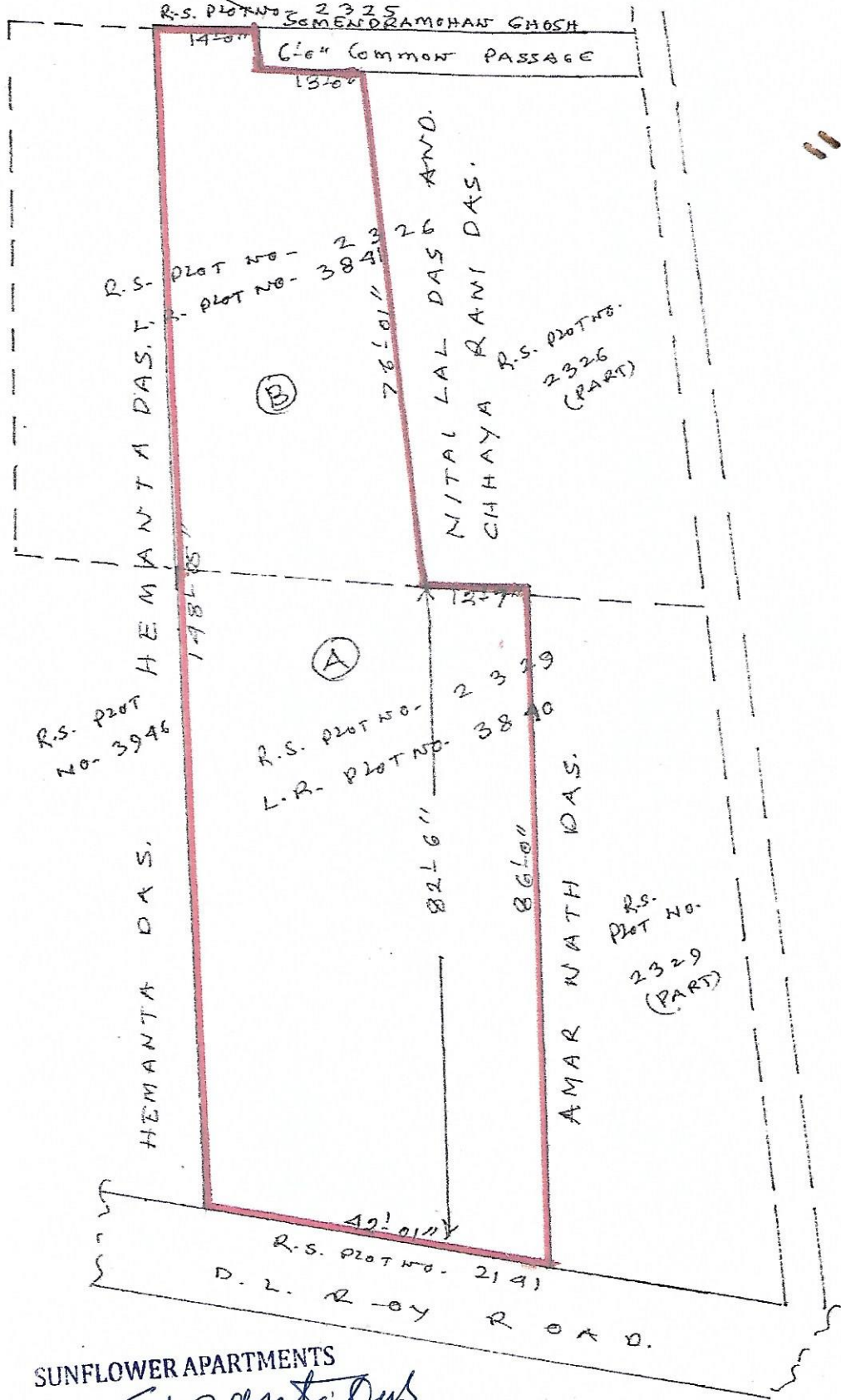

MOUZA	PLAT NO. R.S.	PLAT NO. L.R.	PLAT WISE AREA	L.R. KH. NO.	NAME OF OWNER	BLOCK	TOTAL AREA
KRISHNA NAGAR.	2329	3840	11.00		SRI SUSHANTA DAS.	A	13.33
J.L. NO. 92	2326	3841	2.33		S/O LATE GOVRANGA CHI DAS.	B	DEC. MORE OR LESS

SUNFLOWER APARTMENTS
Sunanta Das
 Promoter & Developer

DRAWN BY-
P. Pramanik
 PRASUN PRAMANIK
 Land Surveyor / Amin
 W.B.S.E.E. Trained
 Regn No. 2626007018/14
 Krishnagar, Nadia