

15

INDIA NON JUDICIAL

₹५० रु.

RS 150

भारत

एक सौ पचास रुपया ONE HUNDRED & FIFTY RUPEES

WEST BENGAL

Admissible Under Regs. Rule 21 and 22 of the W. & L. Act. 1909 Exempt from stamp duty under the Indian Stamp Act. 1912. It is provided in Schedule IA, No. 29 P. Fed. 50 is Paid in C.F.S.

₹ 37.50  
₹ 1.00  
₹ 38.50

Handwritten notes in Bengali script, including 'জি.সি.এ. অফিস' and other illegible text.

Jt. Sub-Registrar of Alipore At Behala

Handwritten text in Bengali script, likely a legal notice or document, containing names and dates.

Handwritten text at the bottom of the page, possibly a signature or date.



833  
 1000 Rupees  
 11/12/74  
 150/-  
 186- 60/-  
 1987- 7.10.20

150/-  
 11/12/74  
 Treasury, Alipore.



Presented for Registration  
 at 11/12/74 at 11/12/74  
 on 11/12/74 at 11/12/74  
 At the Joint Sub-Registrar  
 of Behala of Behala  
 by Gopalram Rabbani  
 Recutant/Clement/Attorney.

Handwritten notes in Odia script, possibly indicating the date and location of the registration.

Jt. Sub-Registrar of  
 Alipore At Behala

Gopalram Rabbani  
11/12/74  
Behala  
Behala  
Behala  
Behala  
Behala

Handwritten notes in Odia script, likely related to the registration details.

Ali  
Behala  
Behala  
Behala  
Behala

Rs 500  
 as consideration is  
 paid in my presence  
 by Gopalram Rabbani  
 to Gopalram Rabbani

Jt. Sub-Registrar of  
 Alipore At Behala

Jt. Sub-Registrar of

















Handwritten text at the top right, possibly a title or reference, including the words "Handwritten" and "number" written vertically.

Main body of handwritten text in Odia script, consisting of approximately 20 lines of dense, cursive handwriting.















(TRUE COPY)

AND PLAN FOR:- SM. GOURI RANI MUKHERJEE  
PAURI PUCCA ROAD. IN PART OF CS. DAG NO. 30  
S KHATIAN NO. 79. R. S. KHATIAN NO. 339/1 TOUJI NO. 35)  
J.L. NO. 15. R. S. NO. 82. MOUJA:- BASUDEY PUR. P. S. BEHALA

DISTRICT:- 24 PARGANAS.

AREA OF LAND:- 12.8 CH. OS. ~~...~~

~~NO SCALE~~ 20' 1" of 1" = 100' x 100'

...



SHED'S  
37'0"

LAND & BUILDING OF  
SRI SAILESWAR SARKAR

WALL

OPEN LAND OF  
SM. GOURI RANI MUKHERJEE  
AREA:- AKHATTAS ONLY.

V  
R  
N  
D  
O  
R  
S  
16'6"

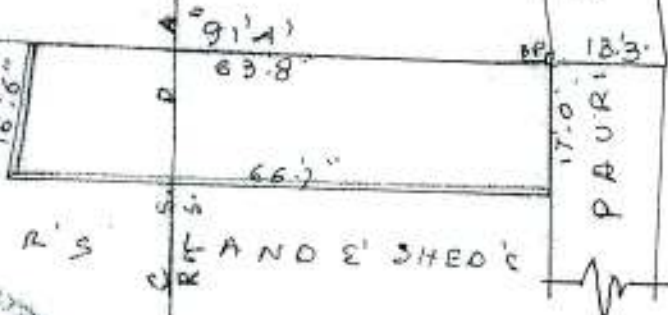

...



...

...



I, Volno-20, P-290, 294, Serial No-1599, Year-1974, S.R. Behala, Rs.



362  
1599  
12/12/96

1599  
12/12/96

True copy of the receipt  
of serial 1599. No. in year  
1974. Serial no. 1599  
Vol 20 P. 290-294 Receipts

S.R. Behala  
12.12.96

12/12/96  
Add. Dir. of...

8777 (2) ...