

SHEET NO. 01 OF 08  
 PROPOSED ON VIA STORED RESIDENTIAL BUILDING U/S 233A OF  
 C.M.C. ACT, 1980 COMPLYING K.M.C. BUILDING RULE 2009 AT 5th  
 NERODE BEHARI MULLICK ROAD, KOLKATA - 700026 UNDER K.M.C. IN  
 WARD NO. 05, BOROUGHS NO. 1, P.S. MANICATA, HAVING HEIGHT  
 30.30M  
 SCALE: 1:100 OR AS STATED

**DRAWING TITLE:**  
 STATEMENT OF THE PLAN CASE NO. 22100/24

**APPLICANT:**  
 M/S. NERODE BEHARI MULLICK ROAD  
 24, STATE OF WEST BENGAL  
 REG. NO. 2009/2004/2011 PLACE: DUMRA, PIN CODE: 700029

**PLANNING OFFICER:**  
 M/S. NERODE BEHARI MULLICK ROAD  
 REG. NO. 1984/2011 PLACE: MANICATA

**2. APPROVAL OF STRIP OF LAND:**  
 REG. NO. 1984/2011 PLACE: MANICATA

**3. APPROVAL OF STRIP OF LAND:**  
 REG. NO. 1984/2011 PLACE: MANICATA

**4. APPROVAL OF STRIP OF LAND:**  
 REG. NO. 1984/2011 PLACE: MANICATA

**5. APPROVAL OF STRIP OF LAND:**  
 REG. NO. 1984/2011 PLACE: MANICATA

**6. APPROVAL OF STRIP OF LAND:**  
 REG. NO. 1984/2011 PLACE: MANICATA

**7. APPROVAL OF STRIP OF LAND:**  
 REG. NO. 1984/2011 PLACE: MANICATA

**8. APPROVAL OF STRIP OF LAND:**  
 REG. NO. 1984/2011 PLACE: MANICATA

**9. APPROVAL OF STRIP OF LAND:**  
 REG. NO. 1984/2011 PLACE: MANICATA

**10. APPROVAL OF STRIP OF LAND:**  
 REG. NO. 1984/2011 PLACE: MANICATA

**11. PROPOSED AREA STATEMENT:**

SL. NO.	DESCRIPTION	AREA (SQ.M.)
1	TOTAL LOT AREA	10000.00
2	AREA UNDER BUILDING	1000.00
3	AREA UNDER PARKING	2000.00
4	AREA UNDER DRIVEWAY	1000.00
5	AREA UNDER FOOTPATH	500.00
6	AREA UNDER GREEN SPACE	1500.00
7	AREA UNDER VACANT LAND	1000.00
8	AREA UNDER ROAD	1000.00
9	AREA UNDER STRIP OF LAND	1000.00
10	AREA UNDER OTHER	1000.00
11	TOTAL AREA	10000.00

**12. DIMENSIONS & CAR PARKING CALCULATION:**

NO.	DESCRIPTION	ACTUAL AREA (SQ.M.)	% OF TOTAL AREA
1	AREA UNDER BUILDING	1000.00	10.00%
2	AREA UNDER PARKING	2000.00	20.00%
3	AREA UNDER DRIVEWAY	1000.00	10.00%
4	AREA UNDER FOOTPATH	500.00	5.00%
5	AREA UNDER GREEN SPACE	1500.00	15.00%
6	AREA UNDER VACANT LAND	1000.00	10.00%
7	AREA UNDER ROAD	1000.00	10.00%
8	AREA UNDER STRIP OF LAND	1000.00	10.00%
9	AREA UNDER OTHER	1000.00	10.00%
10	TOTAL AREA	10000.00	100.00%

**NOTES:**

1. ALL DIMENSIONS ARE IN METERS.
2. THE PROPOSED BUILDING SHALL BE CONSTRUCTED AS PER THE APPROVED PLAN.
3. THE PROPOSED BUILDING SHALL BE CONSTRUCTED WITHIN THE BOUNDARIES OF THE LOT.
4. THE PROPOSED BUILDING SHALL BE CONSTRUCTED WITHIN THE BOUNDARIES OF THE LOT.
5. THE PROPOSED BUILDING SHALL BE CONSTRUCTED WITHIN THE BOUNDARIES OF THE LOT.
6. THE PROPOSED BUILDING SHALL BE CONSTRUCTED WITHIN THE BOUNDARIES OF THE LOT.
7. THE PROPOSED BUILDING SHALL BE CONSTRUCTED WITHIN THE BOUNDARIES OF THE LOT.
8. THE PROPOSED BUILDING SHALL BE CONSTRUCTED WITHIN THE BOUNDARIES OF THE LOT.
9. THE PROPOSED BUILDING SHALL BE CONSTRUCTED WITHIN THE BOUNDARIES OF THE LOT.
10. THE PROPOSED BUILDING SHALL BE CONSTRUCTED WITHIN THE BOUNDARIES OF THE LOT.

**CERTIFICATE OF STRUCTURAL ENGINEER:**

I, THE SIGNATURE OF THE REGISTERED PROFESSIONAL ENGINEER HAS BEEN MADE BY ME ON THE BASIS OF THE PLAN AND THE INFORMATION PROVIDED BY THE APPLICANT.

**REGISTERED PROFESSIONAL ENGINEER:**  
 M/S. NERODE BEHARI MULLICK ROAD  
 REG. NO. 1984/2011 PLACE: MANICATA

**CERTIFICATE OF ARCHITECT:**

I, THE SIGNATURE OF THE REGISTERED PROFESSIONAL ARCHITECT HAS BEEN MADE BY ME ON THE BASIS OF THE PLAN AND THE INFORMATION PROVIDED BY THE APPLICANT.

**REGISTERED PROFESSIONAL ARCHITECT:**  
 M/S. NERODE BEHARI MULLICK ROAD  
 REG. NO. 1984/2011 PLACE: MANICATA

**DECLARATION OF APPLICANT (OWNER):**

I, THE SIGNATURE OF THE APPLICANT HAS BEEN MADE BY ME ON THE BASIS OF THE PLAN AND THE INFORMATION PROVIDED BY THE APPLICANT.

**APPLICANT:**  
 M/S. NERODE BEHARI MULLICK ROAD  
 REG. NO. 1984/2011 PLACE: MANICATA

**DOOR WINDOW SCHEDULE:**

NO.	DESCRIPTION	WIDTH (M)	HEIGHT (M)	AREA (SQ.M.)
1	DOOR	1.00	2.00	2.00
2	WINDOW	1.50	1.50	2.25
3	WINDOW	2.00	1.50	3.00
4	WINDOW	1.00	1.00	1.00
5	WINDOW	1.50	1.50	2.25
6	WINDOW	2.00	1.50	3.00
7	WINDOW	1.00	1.00	1.00
8	WINDOW	1.50	1.50	2.25
9	WINDOW	2.00	1.50	3.00
10	WINDOW	1.00	1.00	1.00
11	WINDOW	1.50	1.50	2.25
12	WINDOW	2.00	1.50	3.00
13	WINDOW	1.00	1.00	1.00
14	WINDOW	1.50	1.50	2.25
15	WINDOW	2.00	1.50	3.00
16	WINDOW	1.00	1.00	1.00
17	WINDOW	1.50	1.50	2.25
18	WINDOW	2.00	1.50	3.00
19	WINDOW	1.00	1.00	1.00
20	WINDOW	1.50	1.50	2.25
21	WINDOW	2.00	1.50	3.00
22	WINDOW	1.00	1.00	1.00
23	WINDOW	1.50	1.50	2.25
24	WINDOW	2.00	1.50	3.00
25	WINDOW	1.00	1.00	1.00
26	WINDOW	1.50	1.50	2.25
27	WINDOW	2.00	1.50	3.00
28	WINDOW	1.00	1.00	1.00
29	WINDOW	1.50	1.50	2.25
30	WINDOW	2.00	1.50	3.00

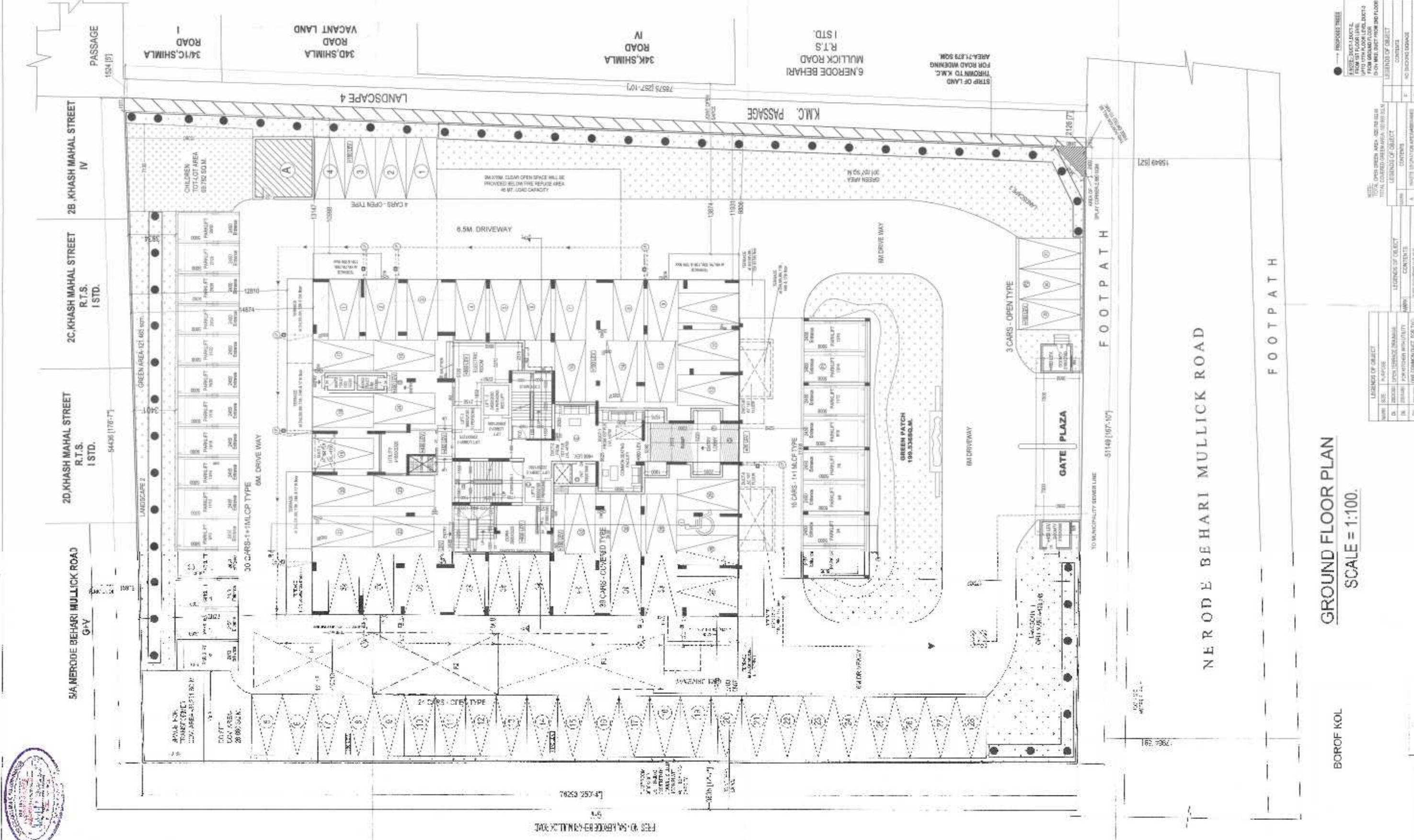

**GROUND FLOOR PLAN**  
 SCALE = 1:100

**LEGENDS OF OBJECT:**

MARK	DESCRIPTION
1	PROPOSED TREE
2	EXISTING TREE
3	PROPOSED DRIVEWAY
4	EXISTING DRIVEWAY
5	PROPOSED FOOTPATH
6	EXISTING FOOTPATH
7	PROPOSED GREEN SPACE
8	EXISTING GREEN SPACE
9	PROPOSED VACANT LAND
10	EXISTING VACANT LAND
11	PROPOSED ROAD
12	EXISTING ROAD
13	PROPOSED STRIP OF LAND
14	EXISTING STRIP OF LAND
15	PROPOSED OTHER
16	EXISTING OTHER

**BOROF KOL**

REG. NO. 1984/2011 PLACE: MANICATA