

**SITE PLAN OF A PLOT OF BASTU & DANGA LAND LYING SITUATE AT AND BEING HOLDING NO. 32, MD. KALACHAND ROAD AT MOUZA - GHOLA, J.L. NO. 14, TOLZI NO. 6, R.S. NO. 103 COMPRISED OF R.S. DAG NO. 834 (P) & 835 APPERTAINING TO R.S. KHATIAN NO. 4050 CORRESPONDING TO I.R. KHATIAN NO. 957 UNDER THE POLICE STATION OF GHOLA WITHIN THE LIMITS OF PANIHATI MUNICIPALITY IN WARD NO. 30 IN THE DISTRICT OF NORTH 24 PARGANAS.**

**AREA OF LAND IN R.S. DAG NO. 834 (P) : BASTU - 19 COTTAHAS 06 CHITTACKS = 32 DECIMALS**

**AREA OF LAND IN R.S. DAG NO. 835 (P) : DANGA - 03 COTTAHAS 00 CHITTACK = 05 DECIMAL**

**TOTAL AREA OF LAND : 22 COTTAHAS 06 CHITTACKS = 37 DECIMALS.**

**AREA MKD. WITH RED BORDER**

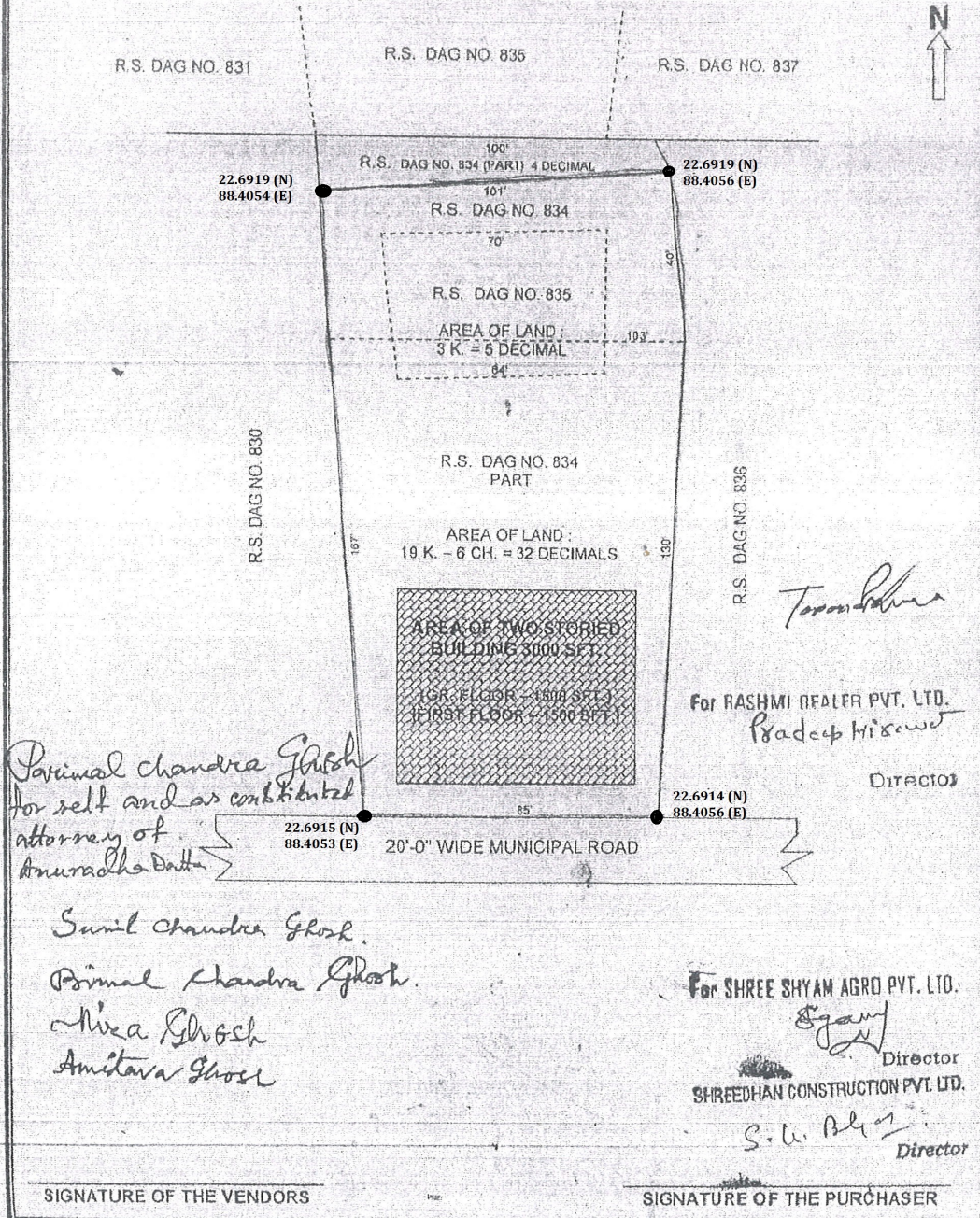

**For FTC CONCRETE PVT. LTD.**  
*Sandeep Chindub*  
**Director**