

SITE PLAN OF A PLOT OF BASTU & DANGA LAND LYING SITUATE AT AND BEING HOLDING NO. 32, MD. KALACHAND ROAD AT MOUZA - GHOLA, J.L. NO. 14, TOUZI NO. 6, R.S. NO. 103 COMPRISED OF R.S. DAG NO. 834 (P) & 835 APPERTAINING TO R.S. KHATIAN NO. 1050 CORRESPONDING TO L.R. KHATIAN NO. 957 UNDER THE POLICE STATION OF GHOLA WITHIN THE LIMITS OF PANIHATI MUNICIPALITY IN WARD NO. 30 IN THE DISTRICT OF NORTH 24 PARGANAS.

AREA OF LAND IN R.S. DAG NO. 834 (P) : BASTU - 19 COTTAHAS 06 CHITTACKS = 32 DECIMALS

AREA OF LAND IN R.S. DAG NO. 835 (P) : DANGA - 03 COTTAHAS 00 CHITTACK = 05 DECIMAL

TOTAL AREA OF LAND : 22 COTTAHAS 06 CHITTACKS = 37 DECIMALS.

AREA MKD. WITH RED BORDER

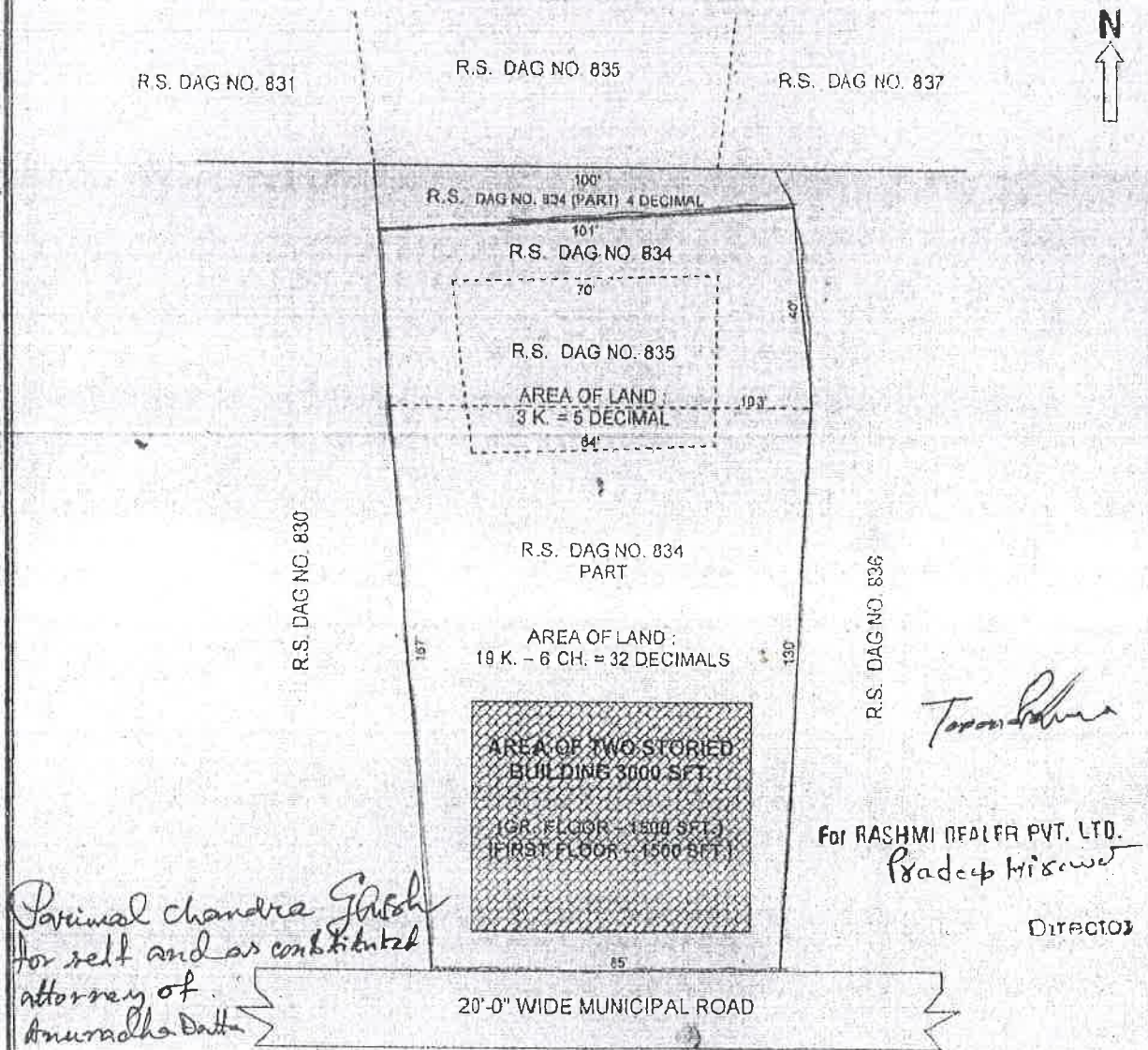

Parimal Chandra Ghosh
for self and as authorized
attorney of
Anuradha Datta

Sunil Chandra Ghosh.
Parimal Chandra Ghosh.
Niva Ghosh
Amitava Ghosh

Tapan Ghosh
For RASHMI REALTY PVT. LTD.
Radeep Misra
DIRECTOR

For SHREE SHYAM AGRO PVT. LTD.
Syam
Director
SHREEDHAN CONSTRUCTION PVT. LTD.
S. K. Bhowmik
Director

SIGNATURE OF THE VENDORS

SIGNATURE OF THE PURCHASER

For FTC CONCRETE PVT. LTD.
Sandeep Chindub
Director