

Licensed Professional Engineer
 License No. 12345
 Registered Professional Architect
 License No. 67890
 Project No. 12345
 Date: 12.06.2016

NOTES:
 1. ALL DIMENSIONS ARE IN METERS UNLESS OTHERWISE SPECIFIED.
 2. ALL EXTERNAL WALLS ARE 200 MM THICK UNLESS OTHERWISE SPECIFIED.
 3. THE DRAWING SHALL BE USED FOR THE PURPOSES INTENDED AND SHALL NOT BE USED FOR ANY OTHER PURPOSES WITHOUT THE WRITTEN CONSENT OF THE ARCHITECT.
 4. THE ARCHITECT SHALL BE RESPONSIBLE FOR THE ACCURACY OF THE INFORMATION PROVIDED IN THIS DRAWING.
 5. THE ARCHITECT SHALL BE RESPONSIBLE FOR THE ACCURACY OF THE INFORMATION PROVIDED IN THIS DRAWING.

CONTRACTOR'S OBLIGATIONS:
 1. THE CONTRACTOR SHALL BE RESPONSIBLE FOR OBTAINING ALL NECESSARY PERMITS AND APPROVALS FROM THE RELEVANT AUTHORITIES.
 2. THE CONTRACTOR SHALL BE RESPONSIBLE FOR THE ACCURACY OF THE INFORMATION PROVIDED IN THIS DRAWING.
 3. THE CONTRACTOR SHALL BE RESPONSIBLE FOR THE ACCURACY OF THE INFORMATION PROVIDED IN THIS DRAWING.

CONTRACTOR'S OBLIGATIONS:
 1. THE CONTRACTOR SHALL BE RESPONSIBLE FOR OBTAINING ALL NECESSARY PERMITS AND APPROVALS FROM THE RELEVANT AUTHORITIES.
 2. THE CONTRACTOR SHALL BE RESPONSIBLE FOR THE ACCURACY OF THE INFORMATION PROVIDED IN THIS DRAWING.
 3. THE CONTRACTOR SHALL BE RESPONSIBLE FOR THE ACCURACY OF THE INFORMATION PROVIDED IN THIS DRAWING.

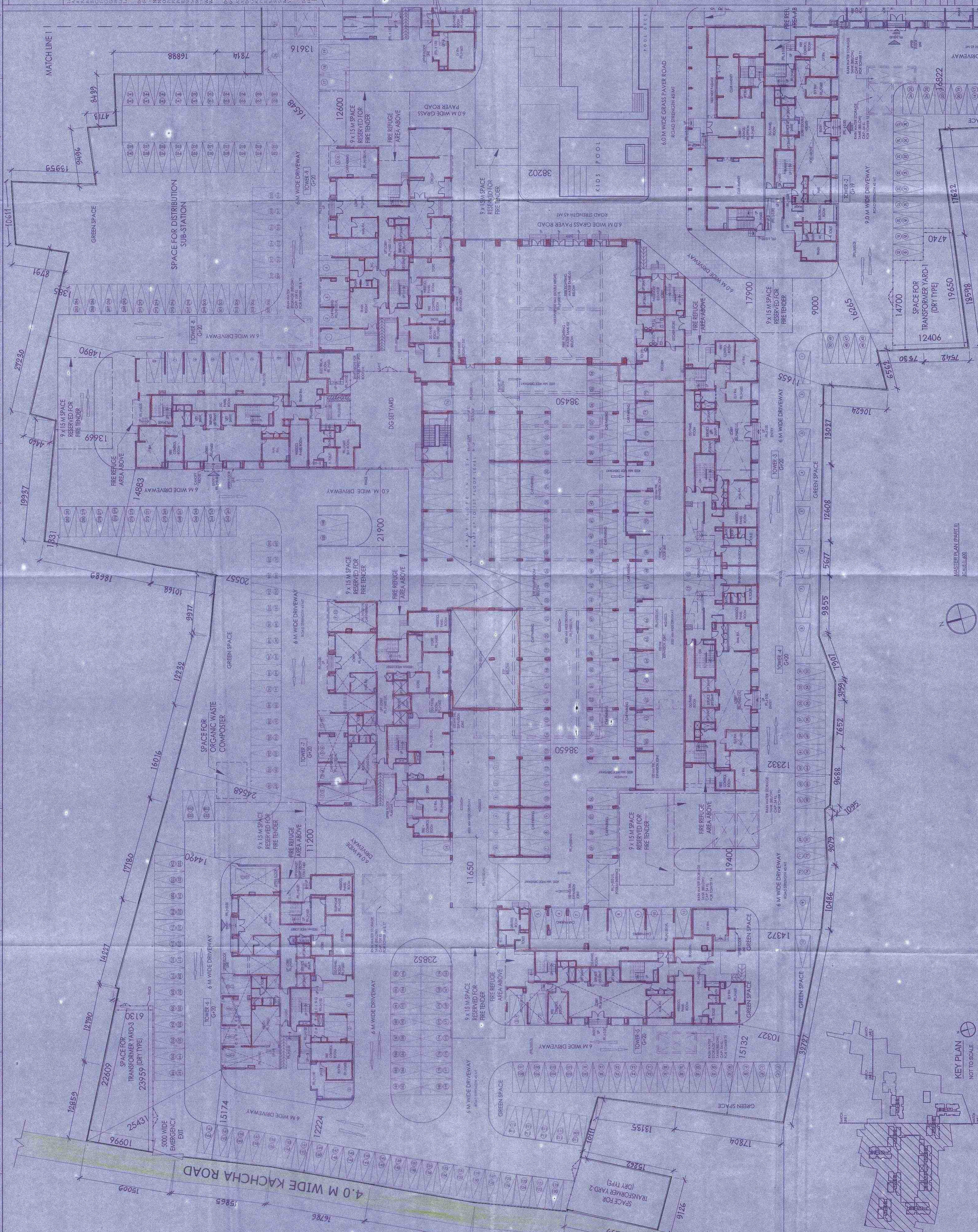

THIS DRAWING IS THE PROPERTY OF M/N CONSULTANTS ONE DESIGN SOLUTIONS. ANY REPRODUCTION OR USE OF THIS DRAWING WITHOUT THE WRITTEN CONSENT OF M/N CONSULTANTS ONE DESIGN SOLUTIONS IS STRICTLY PROHIBITED.

KEY PLAN
 NOT TO SCALE

MASTER PLAN (PART 2)
 Scale: 1:200
 Date: 12.06.2016
 Checked: PANKAJ ANBHAN
 Approved: ANBHAN
 Drawing No: TKD-SD-01.3
 Job No: 2016-2017/26TKD

CONTRACTOR'S OBLIGATIONS:
 1. THE CONTRACTOR SHALL BE RESPONSIBLE FOR OBTAINING ALL NECESSARY PERMITS AND APPROVALS FROM THE RELEVANT AUTHORITIES.
 2. THE CONTRACTOR SHALL BE RESPONSIBLE FOR THE ACCURACY OF THE INFORMATION PROVIDED IN THIS DRAWING.
 3. THE CONTRACTOR SHALL BE RESPONSIBLE FOR THE ACCURACY OF THE INFORMATION PROVIDED IN THIS DRAWING.

CONTRACTOR'S OBLIGATIONS:
 1. THE CONTRACTOR SHALL BE RESPONSIBLE FOR OBTAINING ALL NECESSARY PERMITS AND APPROVALS FROM THE RELEVANT AUTHORITIES.
 2. THE CONTRACTOR SHALL BE RESPONSIBLE FOR THE ACCURACY OF THE INFORMATION PROVIDED IN THIS DRAWING.
 3. THE CONTRACTOR SHALL BE RESPONSIBLE FOR THE ACCURACY OF THE INFORMATION PROVIDED IN THIS DRAWING.

PARTY'S COPY

ANY DEVIATION SHALL
MEAN DEMOLITION

APPROVED
Baltimore Municipal Corporation
Planning Department
REVISION 0106
(REVISED PLAN)

Building Plans Section
No. 04/11/06/1747/12 (2)
Project: RENOVATION OF BMS/REPAIR TO 100 (2)
Date: 01/05/06

- Approved Plans for Baltimore Municipal Corporation shall have to be approved.
- 1) Building Plans for Baltimore Municipal Corporation shall have to be approved.
 - 2) No weights of water shall be used, check ground is covered in water.
 - 3) Surface drainage shall be shown in ground under houses sewer directly or through any yard structures. These have got to be separately indicated.
 - 4) Plans showing internal sewer system and structure shall be approved.
 - 5) Plans showing any construction shall be approved with list of plans, numbered and all the walls, as the proposed in the plan shall be approved.
 - 6) Plans showing any construction shall be approved with list of plans, numbered and all the walls, as the proposed in the plan shall be approved.
 - 7) Plans showing any construction shall be approved with list of plans, numbered and all the walls, as the proposed in the plan shall be approved.

CHIEF ENGINEER
Baltimore Municipal Corporation

29

Approved Plans
Baltimore Municipal Corporation

Valid Up to 01/05/06
Executive Engineer
Baltimore Municipal Corporation

TRD-5D-01.2