

		R. SEAL & ASSOCIATES ARCHITECTS, ENGINEERS, CONSULTANTS 22A, RAJA NABA KRISHNA STREET, KOLKATA-700 005, PH.-2554-2558

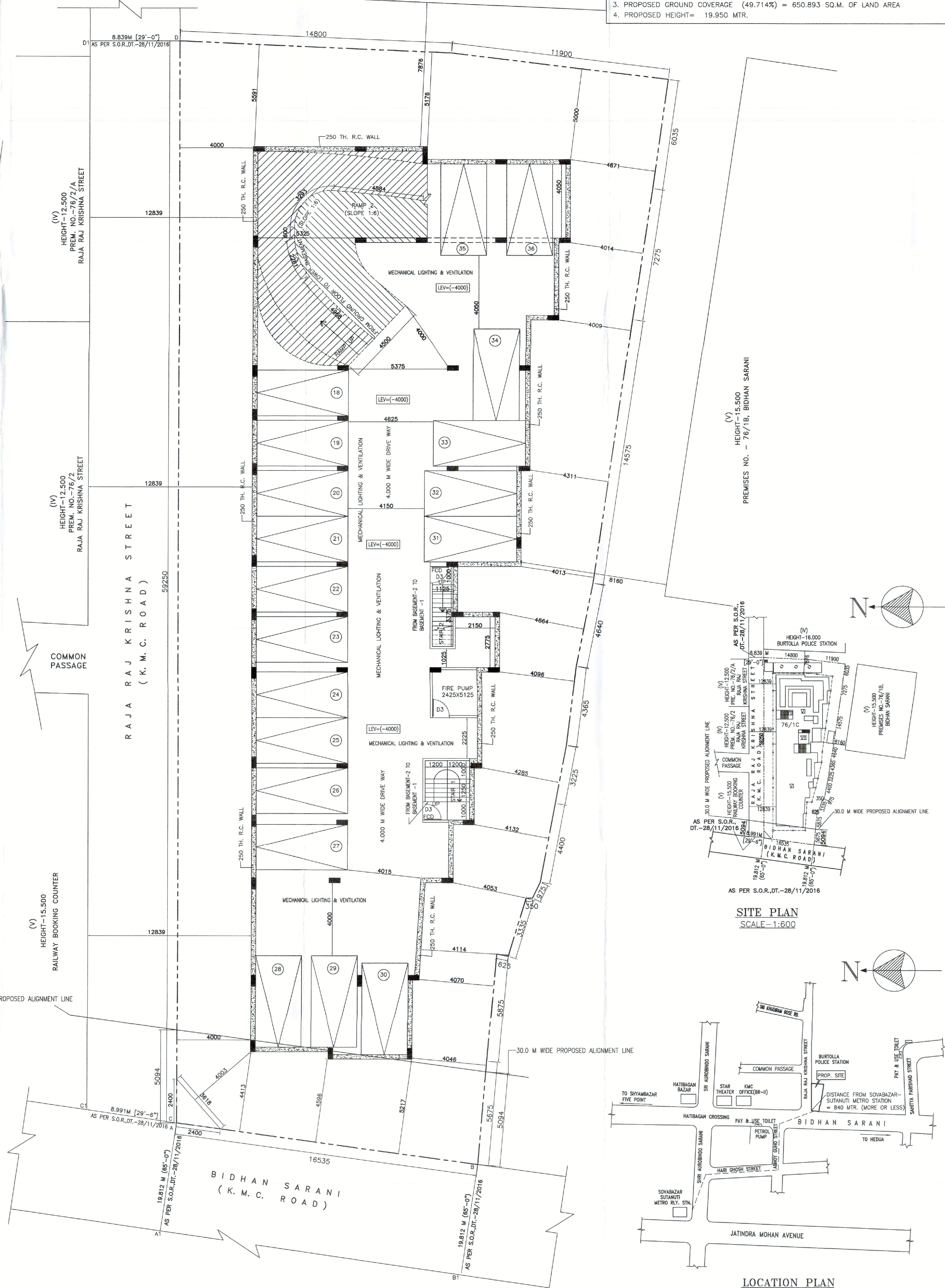
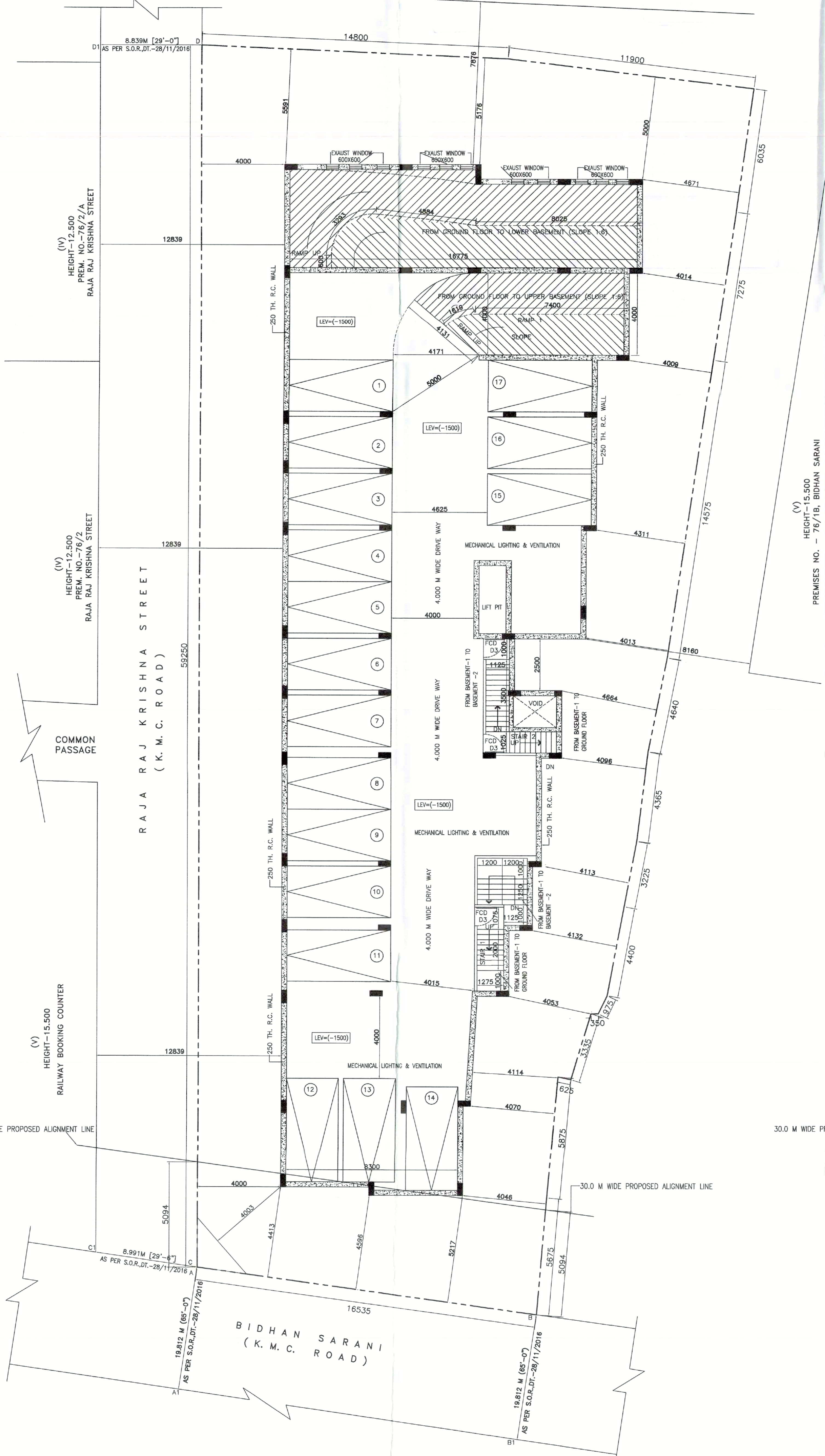

PROPOSED BASEMENT-2 (LOWER BASEMENT) FLOOR PLAN
SCALE-1:100

LOCATION PLAN
SCALE-1:4000

PARTY'S COPY**RESIDENTIAL BUILDING**

No rain water pipe should be fixed or discharged on Road or Footpath. Drainage plan should be submitted at the Borough Executive Engineer's Office and the sanction obtained before proceeding with the drainage work.

A suitable pump has to be provided i.e. pumping unfiltered water for the distribution to the flushing cisterns and urinals in the building incase unfiltered water from street main is not available.



Plan for Water Supply arrangement including SEMI G & O. H. reservoirs should be submitted at the Office of the Ex-Engineer Water Supply and the sanction obtained before proceeding with the work of Water Supply any deviation may lead to disconnection / demolition

CONSTRUCTION SITE SHALL BE MAINTAINED TO PREVENT MOSQUITO BREEDING AS REQUIRED UNDER (1) & (2) OF C.M.C. ACT 1980. IN SUCH MANNER SO THAT ALL WATER COLLECTION & PARTICULARLY LIFT WELLS, VATS, BASEMENT CURVED SITES, OPEN RECEPTACLES ETC. MUST BE EMPTIED COMPLETELY TWICE A WEEK.

The building materials that will be stacked on Road/Passage or Foot-path beyond 3-months or after construction of G. Floor, whichever is earlier may be seized forthwith by the K.M.C. at the cost and risk of the owner.

The sanction refers to the proposed portion shown in red and the Executive Engineers makes no admission as to the correctness of the plan.

Sanctioned conditionally on an understanding duly registered from the owner's to the effect that they will not evict any tenants & will also provide the tenants with identical area in and around the premises by mutual arrangements.

Displayed portion:- Sanctioned conditionally on understanding of the owner that the splayed portion will be free gifted to the K. M. C. and no wall can be constructed over it.

THE SANCTION IS VALID UP TO 25.08.2025

Before starting any Construction the site must conform with the plans sanctioned and all the conditions as proposed in the plan should be fulfilled.

The validity of the written permission to execute the work is subject to the above conditions.

Necessary steps should be taken for the safety of the lives of the adjoining public and private properties during construction.

All Building Materials to necessary & construction should conform to the standards specified in the National Building Code of India.

Non Commencement of Erection/ Re-Erection within Five year will require Fresh Application for Sanction

Approved By: H. D. C. Nigam No. 566
The Building Commissioner
Date: 25.08.2025

Alignment:- Sanctioned conditionally on understanding from the owner that if any part of the Building is to be constructed within that alignment of C.M.C. The same will be demolished by the owner and risk and the owner will not claim any compensation from the C.M.C.

Sanctioned subject to demolition of existing structure to provide open space as per plan before construction is started.

By: [Signature] No. 566
Executive Engineer (C)
For: [Signature]
Asst. Engineer (S)
For: [Signature]
Building Department
K.M.C.

DEVIATION WOULD MEAN DEMOLITION

**OFFICE OF THE E.E. (C)
BOROUGH-II**
Date: 25.08.2025
By: [Signature]
Asst. Engineer (S)
For: [Signature]
Building Department
K.M.C.