

MERIDIAN SPLENDORA, G+XVII (55.5 M HT.) & G+XVI (55.5 M HT.) STORIED RESIDENTIAL BUILDING AT PREMISES NO - 9A/1, UMAKANTA SEN LANE, KOLKATA-700030, WARD NO. - 004, BOROUGH - I, P.S. - CHITPUR, VIDE B.P. NO. - 2014010018, DATED - 03.05.14 AND SUBSEQUENTLY REGULARIZED RULE 26(2a & 2b) BY MBC. DATED-28.08.2015

22°36'55.1"N  
88°23'25.0"E (NW)

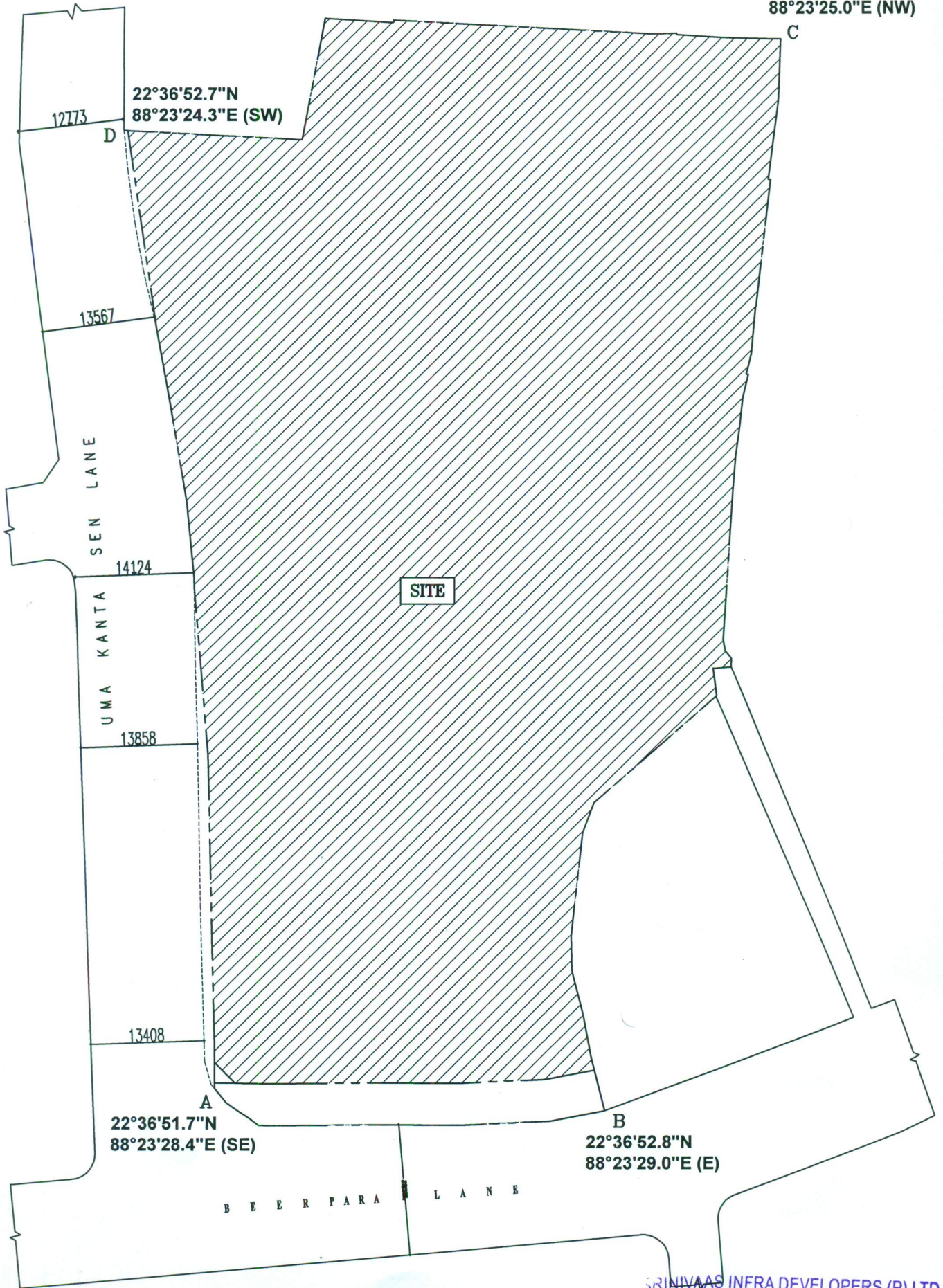

SRINIVAS INFRA DEVELOPERS (P) LTD.

LOCATION PLAN  
SCALE-N.T.S.



*Anil Goode*

Director