

क्र. नं. 3030 का. ...

दि. 01/02/93

कोटा नं. 1571/93 का. नं.

श्री श्री का. नं. 1571/93 का. नं. का. नं. का. नं.

2030 20
220 8
28

1-30
Brd. Sep. 1993
Bilal Kinn Chand



[Signature]
Sub-Registrar
Coimbatore Dist. Dist.
1993

[Signature]
Bilal Kinn Chand
Bilal Kinn Chand
Bilal Kinn Chand
Barasat

श्री श्री का. नं. 1571/93 का. नं.

7459

श्री श्री का. नं. 1571/93 का. नं.

[Signature]
Bilal Kinn Chand
Bilal Kinn Chand
Bilal Kinn Chand
Barasat
Stud.

श्री श्री का. नं. 1571/93 का. नं.

[Signature]
Sub-Registrar
Coimbatore Dist. Dist.
1993

क्रमांक नं. २०२४ दृशा ३१ अक्टूबर १९७३
कर्मिण ७ अक्टूबर
कार्यकार नं. २१११ (परी. क. २३३)
द्वारा (कार्य - कां. प्र. २३३३ ७३, नं. २३३३)

श्री आर. वि. लाल



Sub-Registrar
Coosipore Dum Dum.

३१/१०/७३

Handwritten text at the top right, possibly a title or header.

Handwritten text in the upper middle section.

Handwritten text in the middle section, first line.

Handwritten text in the middle section, second line.

Handwritten text in the middle section, third line.

Handwritten text in the middle section, fourth line.

Handwritten text in the lower middle section, first line.

Handwritten text in the lower middle section, second line.

Handwritten text in the lower middle section, third line.

Handwritten text in the bottom left section, first line.

Handwritten text in the bottom left section, second line.

Handwritten text in the bottom left section, third line.

Handwritten text in the bottom right section, first line.

Handwritten text in the bottom right section, second line.

Handwritten text in the bottom right section, third line.

LAND PLAN

PART OF C.S. DAG NO. 469. PLOT NO. 11/C
 IN MOUZA BADKA-J.L. NO. 9. P.S. DUN DUM.
 DT. 24 PARGANAS. SCALE. 20' FT. = 1" INCH.

11/10/2011
 B. NAKUMDER

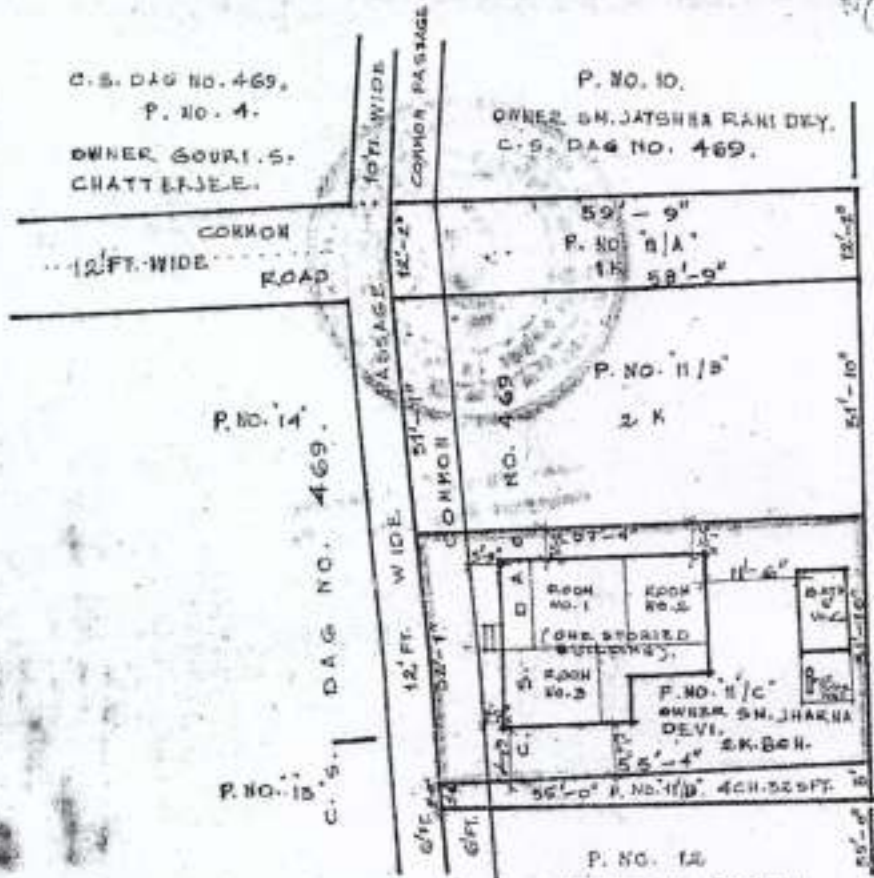

NOTE.
 AREA OF PLOT NO. 11/C
 MARKED RED LAND WITH
 PASSAGE = 2K.8CH.

DRAWN BY
 B. NAKUMDER.