

# KOLKATA WEST INTERNATIONAL CITY

REVISED LOCATION PLAN FOR CLUSTER - 2 RESIDENTIAL BUILDING COMPLEX AT THE PROJECT SITE OF "KOLKATA WEST INTERNATIONAL CITY" AT WEST HOWRAH.

LOCATION PLAN OF RESIDENTIAL CLUSTER-2 OVERLAPPED WITH DAG BOUNDARIES

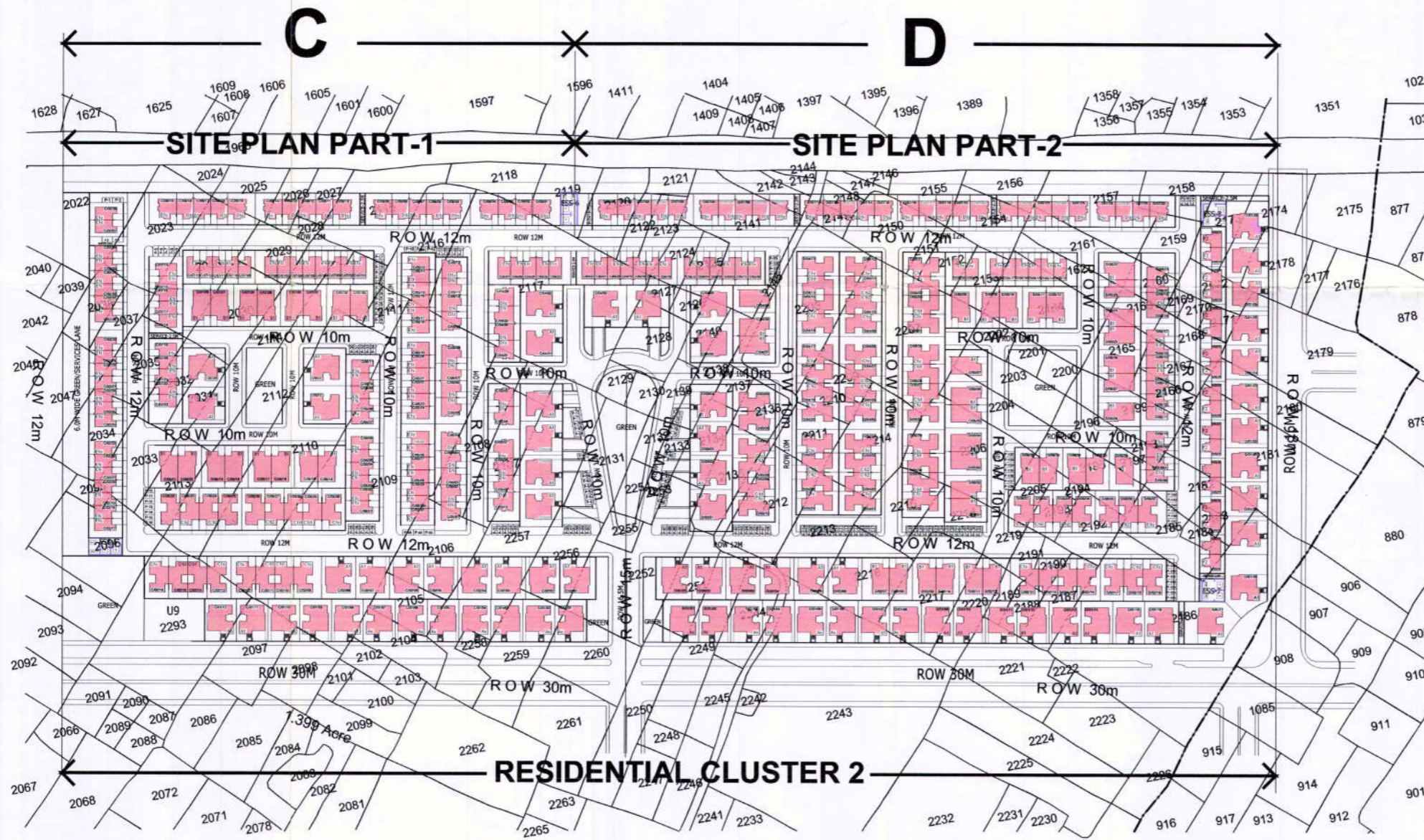
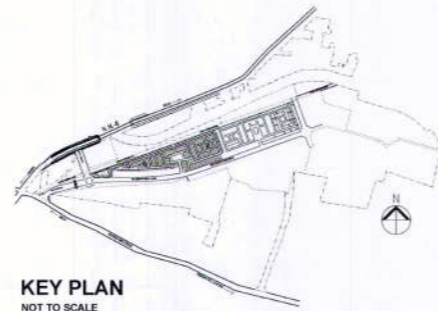

Kolkata West International City Pvt. Ltd.  
 Authorised Signatory

SIGNATURE OF OWNER

"I HEREBY CERTIFY WITH FULL RESPONSIBILITY ON THE PLAN ITSELF THAT THE BUILDING PLAN HAS BEEN DRAWN AS PER PROVISION OF DEVELOPMENT CONTROL REGULATION PREPARED FOR KOLKATA WEST INTERNATIONAL CITY TOWNSHIP PROJECT IN WEST HOWRAH THAT THE SITE CONDITION INCLUDING THE WIDTH OF THE ROAD CONFORM WITH THE PLAN AND IT IS BUILDABLE SITE AND NOT TANK OR FILLED UP TANK. THE SITE AND THE KEY PLAN CONFIRMS WITH SITE AS PER DEED SITE PLAN. IT IS DEMARKETED BY BOUNDARY WALL AND PILLAR."

SUNIL GAIKHE  
 CONSULTING ARCHITECT  
 Regd. No. CA/55/18350  
 SIGNATURE OF ARCHITECT

"THE STRUCTURAL DESIGN AND DRAWING OF BOTH FOUNDATION AND SUPERSTRUCTURE OF THE BUILDING HAS BEEN MADE BY ME CONSIDERING ALL POSSIBLE LOADS INCLUDING THE SEISMIC LOAD AS PER THE NATIONAL BUILDING CODE OF INDIA AND CERTIFIED THAT IT IS SAFE AND STABLE IN ALL RESPECT."

SIGNATURE OF STRUCTURAL ENGINEER

SPECIFICATION:

1. ALL DIMENSIONS ARE IN m OTHERWISE MENTIONED.
2. ALL ROOM DIMENSIONS ARE EXCLUDING THE PLASTER THICKNESS.
3. ALL EXTERNAL WALLS ARE 250mm TH. UNLESS OTHERWISE MENTIONED, CONSTRUCTED WITH CEMENT-SAND MORTAR (1:6).
4. ALL INTERNAL WALLS ARE 125mm THICK UNLESS OTHERWISE MENTIONED, CONSTRUCTED WITH CEMENT-SAND MORTAR (1:4).
5. REINFORCED CEMENT CONCRETE WORK WITH CEMENT-SAND-STONE (1:1.5:3), GRADE OF CONCRETE M20 AND GRADE OF STEEL Fe-550.
6. INTERNAL PLASTER 12MM TH. WITH CEMENT SAND MORTAR 1:6.
7. EXTERNAL PLASTER 20MM TH. WITH CEMENT SAND MORTAR 1:6.
8. CEILING PLASTER 6MM TH. WITH CEMENT SAND MORTAR 1:4.
9. PLAIN CEMENT CONCRETE (P.C.C.) WITH CEMENT-SAND-STONE (1:3:6).
10. WATERPROOFING ON ROOF TERRACE.
11. 40MM TH. DAMP PROOF (1:2:4) COURSE BELOW WALL.
12. ALL SORTS OF PRECAUTIONARY MEASURES WILL BE TAKEN AT THE TIME OF CONSTRUCTION OF INSPECTION PITS.
13. ASSUMING BEARING CAPACITY OF SOIL 87/Sqm.

Revisions	No.	Description	Date:
			4 June '13

SCALE 1:1200

KWIC/CLUSTER-2/LP1/SANC 03

**PROVISIONALLY  
SANCTIONED**

Before entering any agreement, the person  
concerned shall obtain the sanction of the  
proposed building plan. The plan  
shall be valid for a period of five years from  
the date of sanction and may be renewed  
for a further five years subject to the  
approval of the Council. Regulations and  
Building Bye Laws for Kolkata West  
International City.



Design of all structural members including  
that of the foundation shall conform to the  
standard as specified in the National Building  
Code of India.

The Sanction is valid  
up to 02/10/2018

*S. Mukherjee*  
3/10/2013  
Director,  
Statutory Planning Dept  
K.M.D.A.

← CLUSTER - C → ← CLUSTER - D →

← RESIDENTIAL CLUSTER - 2 →

← LOCAL PLAN OF RESIDENTIAL CLUSTER - 2 →