

SITE PLAN AT PREMISES NO.- 26C, DURGA PRASANNA PARAMHANSHA ROAD IN
 WARD NO.- 100, BOROUGH NO.- X, KOLKATA - 700 047, P.S.- NETAJI NAGAR
 SCALE :- 1 : 200

AREA OF THE PLOT OF LAND :- 443.794 Sqm. (06 K. - 10 CH. - 07 SFT.)

AREA SHOWING IN RED MKD.

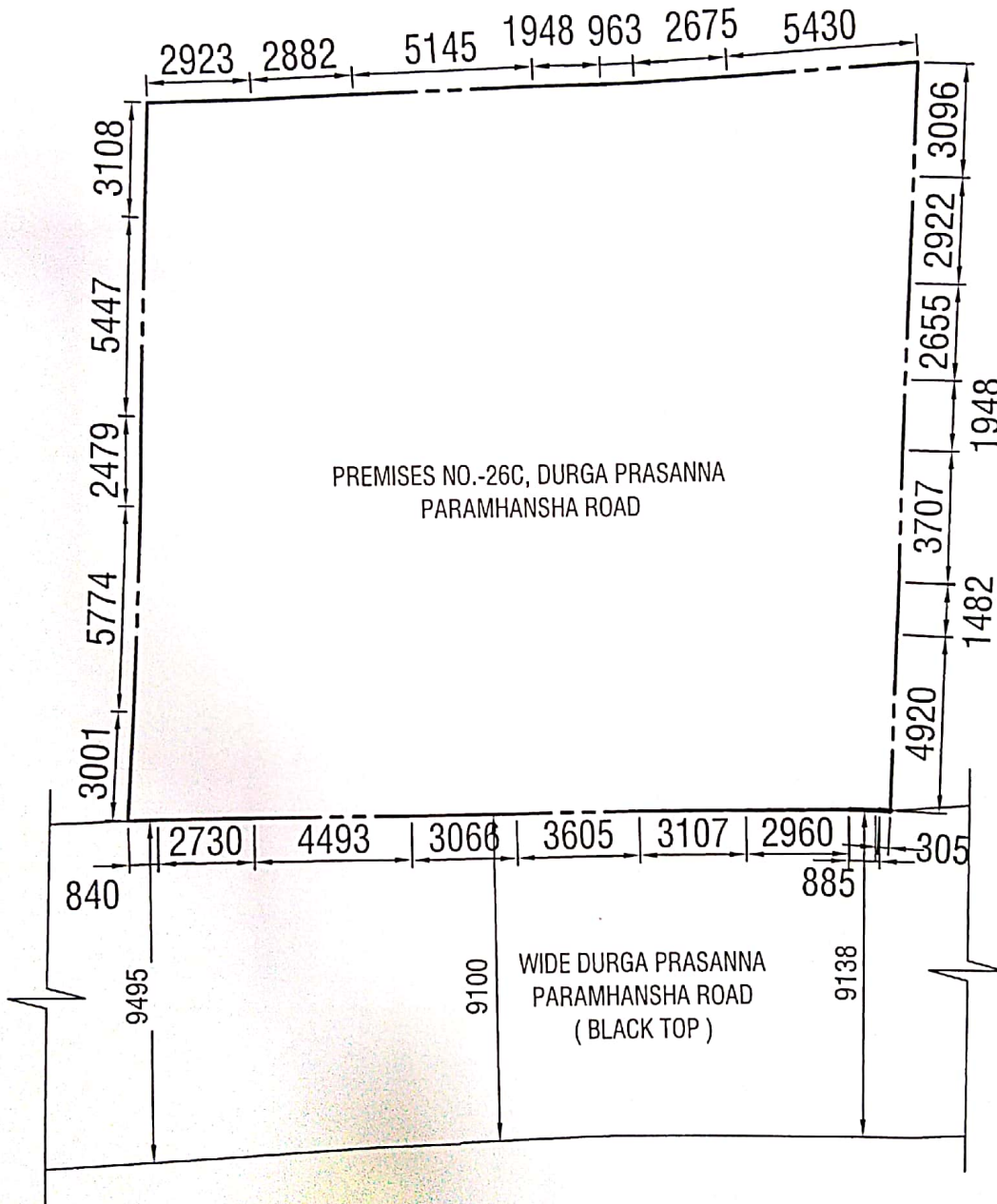

PREMISES NO.-26C, DURGA PRASANNA
 PARAMHANSHA ROAD

WIDE DURGA PRASANNA
 PARAMHANSHA ROAD
 (BLACK TOP)

SREE RAM CONSTRUCTION

R. m. k.
 Proprietor

SIGNATURE OF OWNERS / C. A.

DRAWN BY :- SAMIR KUMAR DUTTA
 L.B.S. NO.- 1303/1