

SITE PLAN AT PREMISES NO. 1810, NAYABAD, WARD NO.- 109, P.S.- PURBA JADAVPUR  
NOW PANCHASAYER, KOLKATA- 700 099, UNDER BOROUGH - XII [ K. M. C. ]

**Lati: N22°29'05.67816"**  
**Long: E88°24'52.06932"**

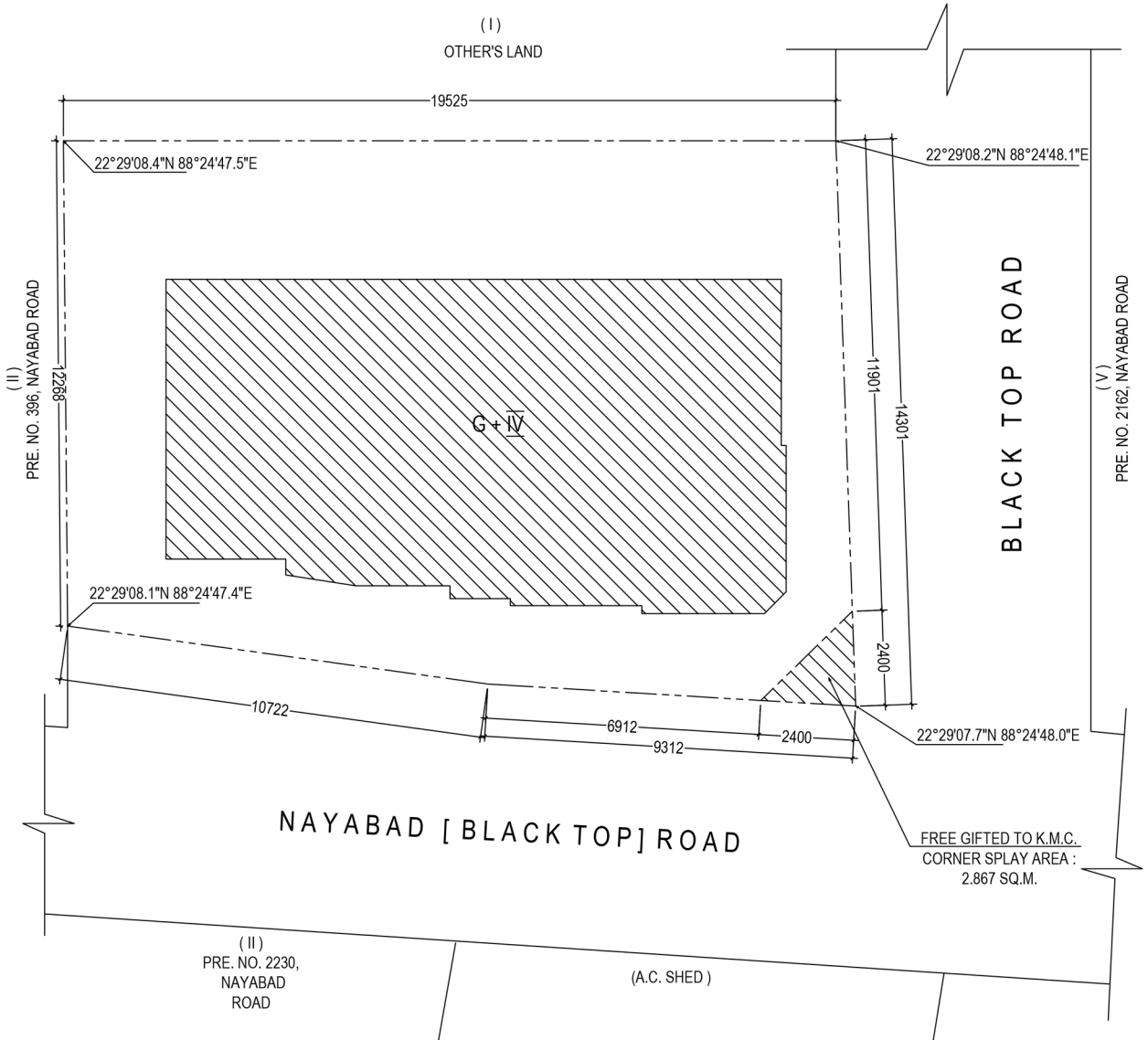

  
**ANUPAM GHOSH**  
Registered Architect  
Reg. No.- CA/2005/36555

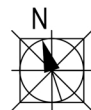

**SCALE : 1 : 100**

.....  
SIGNATURE OF ARCHITECT