

1 TYPICAL SECOND & FIFTH FLOOR PLAN
SCALE 1:100

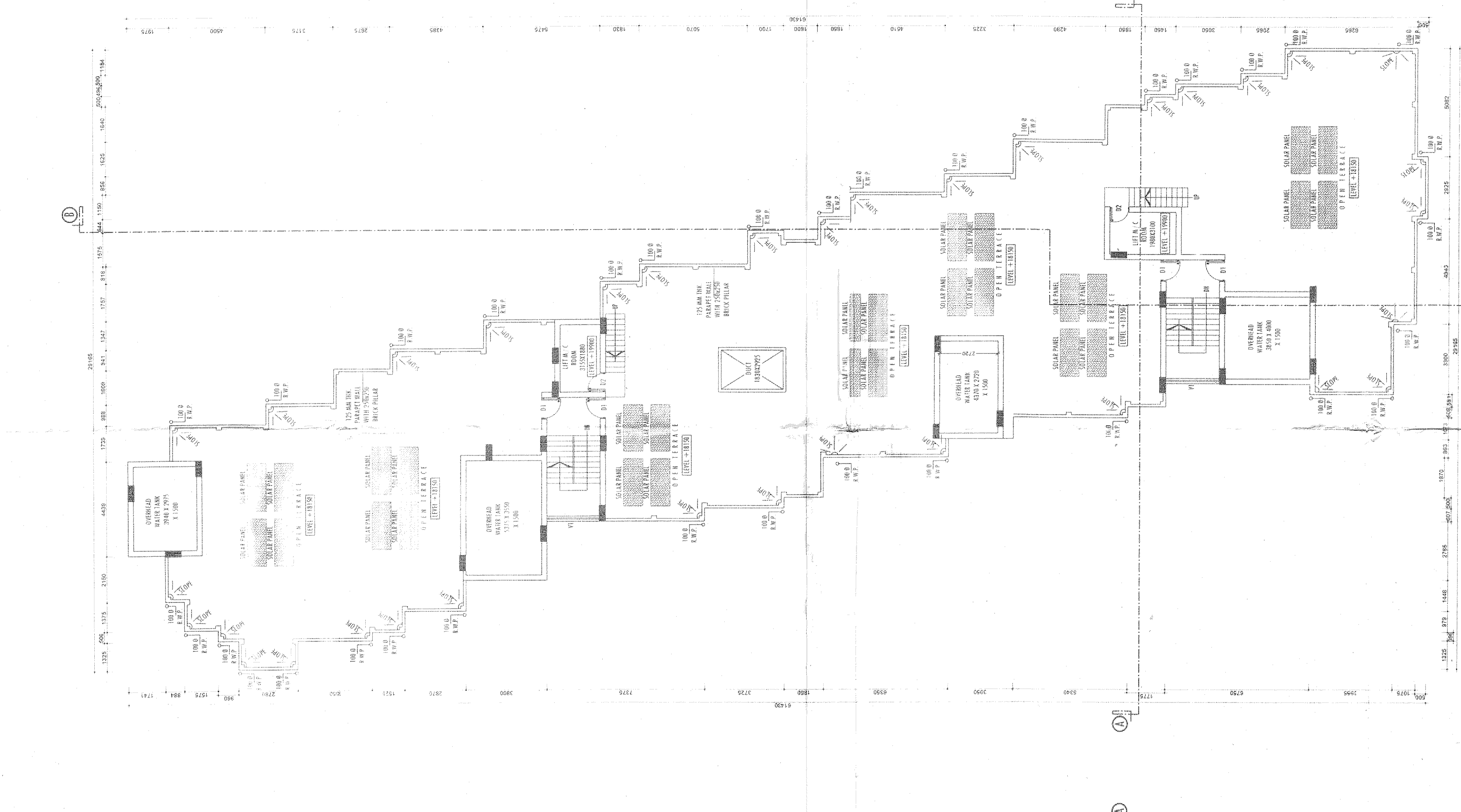

2 ROOF PLAN
SCALE 1:100

SCHEDULE OF DOOR & WINDOW:-

MARK	SIZE	DESCRIPTION
D1	1000X1500	FULL P.N.C.
D2	900X1500	FULL P.N.C.
D3	750X1500	FULL P.N.C.
W1	1500X1200	1/200, 2/300
W2	1000X1200	1/200, 2/300
V1	600X450	1/200, 2/300

PROJECT NAME:-
PROPOSED PLAN OF SIX (6+3)
STORED COMMERCIAL CUM
RESIDENTIAL (APARTMENT) BUILDING
OF SRI DILIP DUTTA, S/O LATE
BHOJANATH DUTTA
OVER R.S. PLOT NO. - 1562, 4517, 4518,
LR PLOT NO. - 2777, 14, 15, 16, 17, 18, 19,
AT MOUDA - COPPINATHPUR, Under-Charge, Building Plan,
P.S. - COKE-OVEN,
DIST - BURDWAN.

HOLDING NO. - 99/79,
FILE NO. - 23/03/2015,
C.O. NO. - 0/28,
NAME OF STREET - JADABENDRA
PANJA AVENUE, DURGAPUR-11.

- NOTES:-
1. ALL WORKS TO BE DONE AS PER THE DRAWING.
 2. ALL EXTERNAL WALLS 250MM, & INTERNAL WALLS 125MM. BRICKS OTHERS AS NOTED.
 3. ALL WORKS TO BE FINISHED BY CONCRETE WORK (1:1) & (1:2).
 4. ALL ROOF WORKS TO BE DONE IN ACCORDANCE WITH THE DRAWING.
 5. ALL CONCRETE WORKS TO BE DONE IN ACCORDANCE WITH THE DRAWING.
 6. ALL CONCRETE WORKS TO BE DONE IN ACCORDANCE WITH THE DRAWING.
 7. ZONING & SETBACKS TO BE DONE IN ACCORDANCE WITH THE DRAWING.
 8. 125MM & 75MM BRICK WORK IN 1:4 MORTAR.
 9. 125 WIDE SURFACE DRAIN SHOULD BE PROVIDED ALL ROUND THE PERIMETER OF THE BUILDING.
 10. ZONE OF THE BUILDING TO BE CONSTRUCTED USING CIVIL-CLASS BRICKS.

AREA CALCULATION:-

FLOOR AREA	AREA
GROUND FLOOR	824.43 SQ.M.
FIRST FLOOR	728.12 SQ.M.
SECOND FLOOR	728.12 SQ.M.
THIRD FLOOR	728.12 SQ.M.
FOURTH FLOOR	728.12 SQ.M.
FIFTH FLOOR	728.12 SQ.M.
GROUND COVERAGE	45.94 %
TOTAL AREA (1ST TO 5TH)	3646.85 SQ.M.
F.A.R.	2.28

SIGNATURE OF OWNER:-
Dilip Dutta

SIGNATURE OF ENGINEER:-
Apurva

DATE: 23.03.2015
PROJECT: GENESIS INFRASTRUCTURE DEVELOPMENT SERVICES
SHEET NO. - GDS/ARCH-03-03

APPROVED
[Signature]
[Stamp]

GENESIS INFRASTRUCTURE DEVELOPMENT SERVICES
(AN ORGANIZATION OF CONSULTANT ENGINEERS)
E-mail: id-gds@gmail.com & gdsengineering@gmail.com
SPECIALIST IN CONSULTING ARCHITECTURAL DESIGN, SURVEYING & PROJECT MANAGEMENT
OFFICE: 5/1, 1st Floor, Bhabani Chandra Ghosh Road, Chhatrapati Shivaji Maharaj, Kolkata - 700016
Contact No. - 9133333333, 9137888884

Checked by: HIGHISH SCALE 1:100, N.T.S.
DATE: 23.03.2015
PROJECT: GENESIS INFRASTRUCTURE DEVELOPMENT SERVICES
SHEET NO. - GDS/ARCH-03-03

REFERENCES

REV	DESCRIPTION	DATE	DRN.	CHD.	APP.	OFFICE USED:-