



PROPOSED PLAN OF ADDITIONAL ONE FLOOR
 (BLOCK - F) ABOVE EXISTING & SANCTIONED
 (WIDE BR - C - 405 / 1998 - 99)
 (WIDE BR - C - 02 / 2013 - 14)
 (WIDE BR - C - 59 / 2015 - 16)
 G+4 (BLOCK - B.C.E), G+5 (BLOCK - G) & G+6 (BLOCK - F)
 STORED RESIDENTIAL BUILDING AT HOLDING NO.
 184, SHIBPUR ROAD, P.S.: SHIBRAH, H.M.C. WARD NO - 37,
 BOROUGH - VI, DIST.: HOWRAH, PIN CODE - 71102
 DAG NO. 337/446, 332/448, 332/453, 332/452, 332/450, 331/445,
 AH NO. 189, 180, 243, 254, MOUZA - SHIBPUR, SHEET NO. 97

DECLARATION
 THE FLOOR (BLOCK - F) ABOVE EXISTING & SANCTIONED (WIDE BR - C - 405 / 1998 - 99) (WIDE BR - C - 02 / 2013 - 14) (WIDE BR - C - 59 / 2015 - 16) G+4 (BLOCK - B.C.E), G+5 (BLOCK - G) & G+6 (BLOCK - F) STORED RESIDENTIAL BUILDING AT HOLDING NO. 184, SHIBPUR ROAD, P.S.: SHIBRAH, H.M.C. WARD NO - 37, BOROUGH - VI, DIST.: HOWRAH, PIN CODE - 71102 DAG NO. 337/446, 332/448, 332/453, 332/452, 332/450, 331/445, AH NO. 189, 180, 243, 254, MOUZA - SHIBPUR, SHEET NO. 97

Ar. Jayanti Kumar Mishra
AYYAMI KUMAR MISHRA
 Constituted Attorney at Law
 1) SANKAR KUMAR MUKHERJEE
 2) SANKAR KUMAR MUKHERJEE
 3) NANDINI MUKHERJEE
 4) SMIT ELAROI
 SIGNATURE OF APPLICANT

STRUCTURAL DECLARATION
 I, THE ARCHITECT, HEREBY CERTIFY THAT THE STRUCTURE OF THE BUILDING HAS BEEN DESIGNED BY ME IN ACCORDANCE WITH THE NATIONAL BUILDING CODE OF INDIA.
 I, THE ARCHITECT, HEREBY CERTIFY THAT THE STRUCTURE OF THE BUILDING HAS BEEN DESIGNED BY ME IN ACCORDANCE WITH THE NATIONAL BUILDING CODE OF INDIA.
 I, THE ARCHITECT, HEREBY CERTIFY THAT THE STRUCTURE OF THE BUILDING HAS BEEN DESIGNED BY ME IN ACCORDANCE WITH THE NATIONAL BUILDING CODE OF INDIA.

Sadananda Barua
Sadananda Barua
 E.S.E. - 13 (I)
 SIGNATURE OF STRUCTURAL ENGINEER

ARCHITECT:
SUDIP SUR & ASSOCIATES
 Architects, Engineers, Interior Designer
 184, SHIBPUR ROAD, P.S.: SHIBRAH, H.M.C. WARD NO - 37,
 BOROUGH - VI, DIST.: HOWRAH, PIN CODE - 71102
 TEL: 984-4474, 9844-1994, E-MAIL: sursudip@rediffmail.com

NOTES:
 1. ALL DIMENSIONS ARE IN MM UNLESS OTHERWISE MENTIONED
 2. WRITTEN DIMENSION SHALL SUPERSEDE MEASURED DIMENSION

SCALE: 1:100	DRAWN BY: SATYA DAS	DRAW NO: AR-55
DATE: JAN. 2017	CHKD BY: SUDIP SUR	

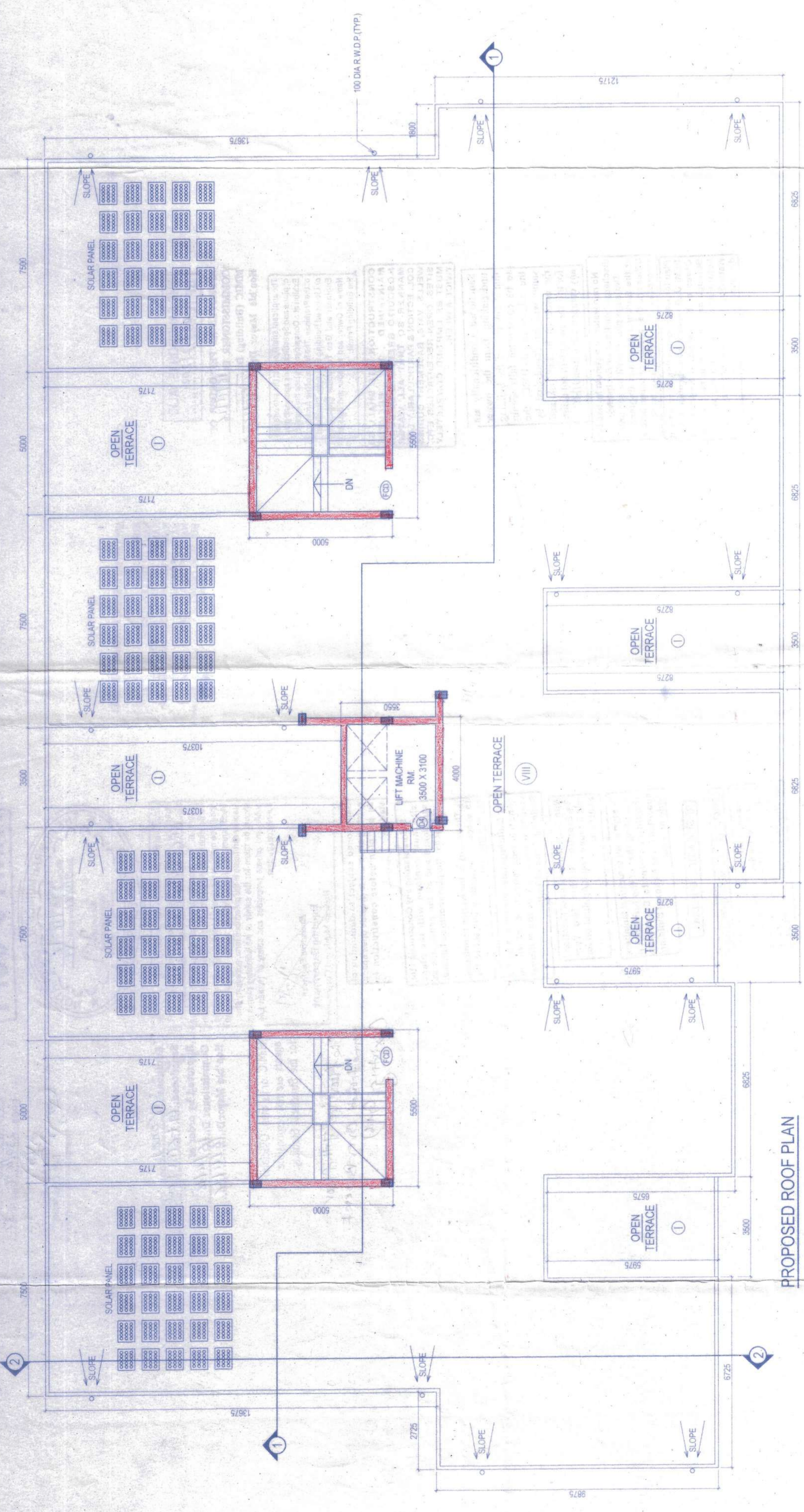

PROPOSED ROOF PLAN
 BLOCK - F
 SCALE: 1:100



PROPOSED 7TH FLOOR PLAN
 BLOCK - F
 SCALE: 1:100