

SITE PLAN OF UNDIVIDED 1/7 th. SHARE OF LAND MEASURING ABOUT 06 COTTAH-00 CHITAK-14 SQ.FT. TOGETHER WITH TILE SHED STRUCTURE MEASURING 200 SFT. COMPRISING IN DAG NO.-637, R.S. KHATIAN NO.-108, MOUZA-SIRITI, AT PREMISES NO.- 79, KARUNAMOYEE GHAT ROAD, P.S.-HARIDEVPUR, KOLKATA-700 082, UNDER THE K.M.C. (S.S.UNIT) WARD NO.-115.

AREA SHOWN BY RED BORDER
SCALE = 1:200

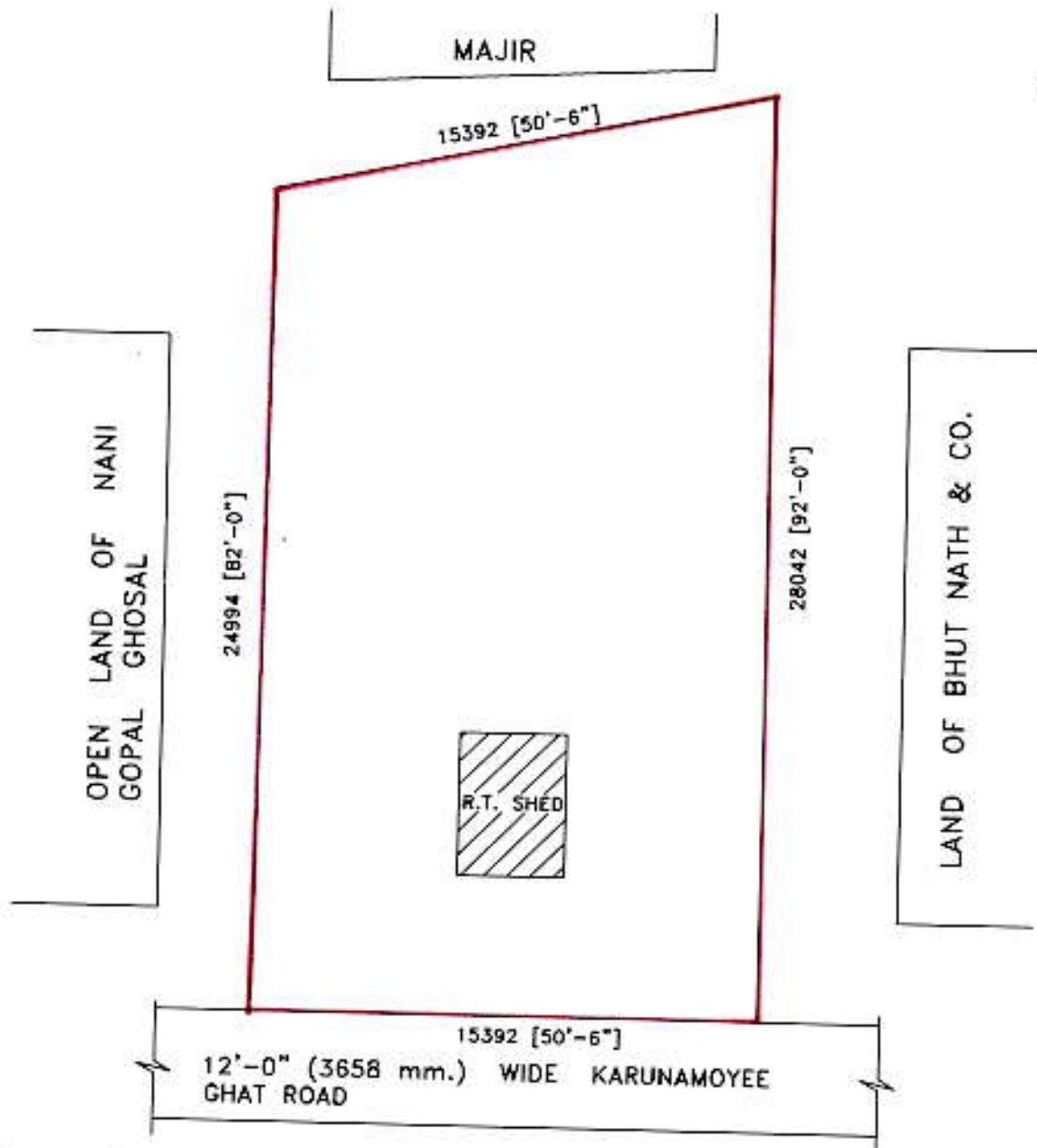

Vikram Singh

For SUN CONSTRUCTION
Bikash Das
Partner

For SUN CONSTRUCTION
Chiranjit Batta
Partner

Shekhar Chandra Bhattacharjee
Shekhar Ch. Bhattacharjee
SIG. OF OWNER (S)

For SUN CONSTRUCTION
Sumendu Banerjee
Partner

For SUN CONSTRUCTION
Sandip Batta
Partner

Sikhan

SIG. OF PURCHASER

Shekhar@SikhanCh-Bhattacharjee