

RS DAG NO-395, L.R DAG NO-143, L.R KHATIAN NO-544, UNDER  
KINAIER GRAM PANCHAYET, AT MOUZA - KHORDABAHERA, II,  
NO-46, P.O-BARABAHERA, P.S - UTTARPARA, DIST - HOOGHLY,  
PIN-712246 W.B.



TOTAL LAND AREA = 03 KAT.09 CH.15 SFT.(MARKED BY RED COLOUR)  
COVER AREA = 1000 SFT.

NAME OF PURCHASER :- SRI SHYAM CONSTRUCTION (PROP.-SHYAMSUNDAR AGARWAL)

NAME OF VENDOR :- SRI PANCHANAN SASMAL

SCALE :- 1"=15'-0"

PIG - SRI BISWAJIT DUTTA & OTHERS

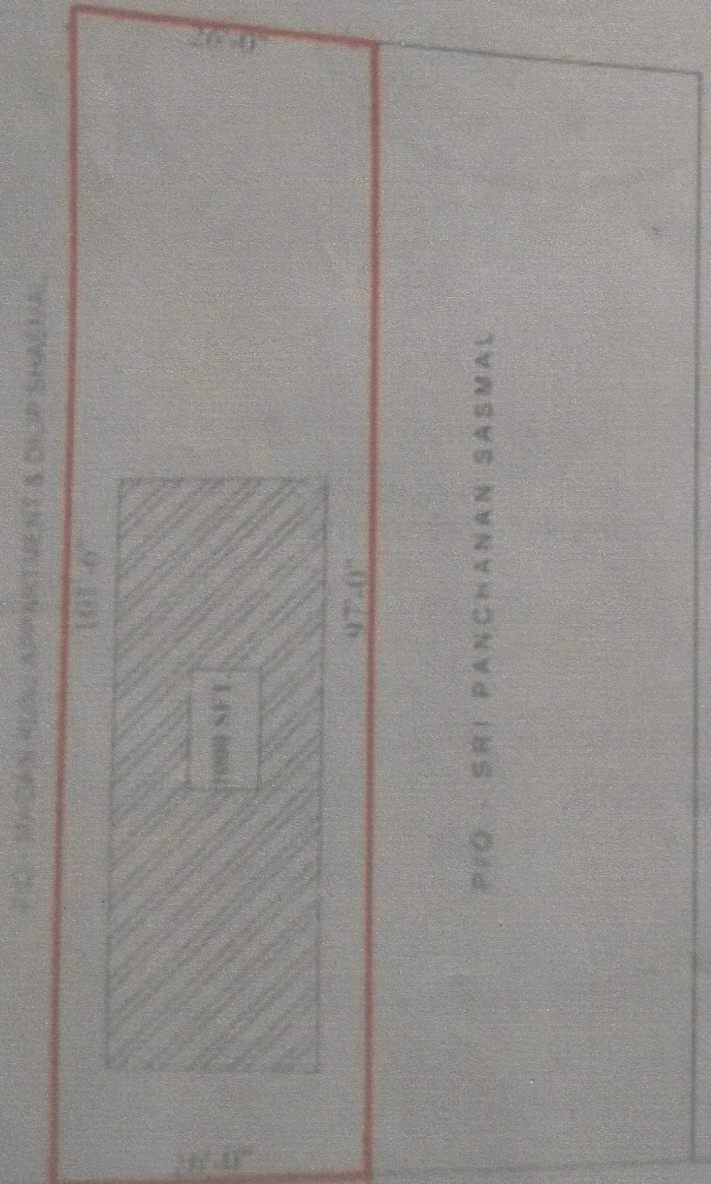

Latitude - 22°42'8" N  
Longitude - 88°20'28" E

SHYAM CONSTRUCT

*Shyam Sundar Agarwal*

SIGNATURE OF PURCHASER

*Sri Panchanan Sasmal*

SIGNATURE OF VENDOR

*Shatterjee*

SUKANTA CHATTERJEE  
D.C.E  
I.S.S. of Konegar Municipality  
Reg. No-18171

ROAD NAME: KAGAN PARA PANCHAYET ROAD

DRAWN BY