

**SITE PLAN OF A PIECE OF A LAND OF STARSHINE TIE UP PRIVATE LIMITED, DIR:- (1) SRI UTTAM KUMAR SAHA, (2) SRI DIPAK DE, (3) SRI RAJESH SINGH AT MOUZA - KALIDAHHA, J. L. NO. - 23 IN C.S. KHATTAN NO. 21 & 390, R.S. KHATTAN NO. 1830, C.S. DAG NO. 11 & 32, R.S. DAG NO. 186 IN RESPECT OF MUNICIPAL HOLDING NO.-9(OLD-102), DUM DUM COSSIPORE ROAD, WARD NO.- 16, P.S.-DUM DUM DISTRICT - 24 PARGANAS (N), UNDER SOUTH DUM DUM MUNICIPALITY.**

**SITE PLAN FOR PROPOSED ( AS PER RULE ) BUILDING**

**NATURE OF LAND - BASTU**

**AREA STATEMENT**

TOTAL AREA OF LAND-18 KH. 00 CH. 00 SFT.-i.e. 1204.46 Sqm. (AS PER DEED)

TOTAL AREA OF LAND-18 KH. 00 CH. 00 SFT.-i.e. 1204.46 Sqm. (AS PER MEASURED)

PERMISSIBLE COVERED AREA --(50.00 %)-----602.23 Sqm.

**CERTIFICATE OF OWNERS**

I ALSO UNDERTAKE TO REPORT THAT THERE IS NO COURT CASE OR ANY COMPLAINT FROM MY ANY CORNER OF MY PROPERTY AS PER SITE. I ALSO UNDERTAKE THAT I HAVE NOT SOLD OR TRANSFER ANY PORTION OF MY PROPERTY, TO ANY BODY UPTIL NOW SOUTH DUM DUM MUNICIPALITY WILL NOT BE LIABLE IF ANY TYPE OF DISPUTE ARISES IN FUTURE.

CERTIFIED THAT THE TIME OF CONSTRUCTION OF MY BUILDING I REPAIR OR CONSTRUCTED THE PORTION OF EXISTING DRAIN AND ROAD IN FRONT OF MY PREMISES OF ANY DAMAGE OCCURS

**STAR SHINE TIEUP PVT. LTD.**  
Director *Santan Prasad Saha*

**STARSHINE TIE-UP PVT. LTD.**  
DIRECTOR *Richard Saha*

**SIG. OF OWNER**

**SANJOY BALA**  
License Building Surveyor  
S.D.D.M. Class-1  
Licence Number S.D.D.M/33/2011-2012  
*Sanjoy Bala*  
04/05/2011

**SIG. OF L.B.S.**  
DRAWN BY: SWEET HOME/ DT. 04.05.2011 SCALE:- 1:200 & N.T.S



PROPOSED SITE  
NOT TO SCALE  
LOCATION PLAN

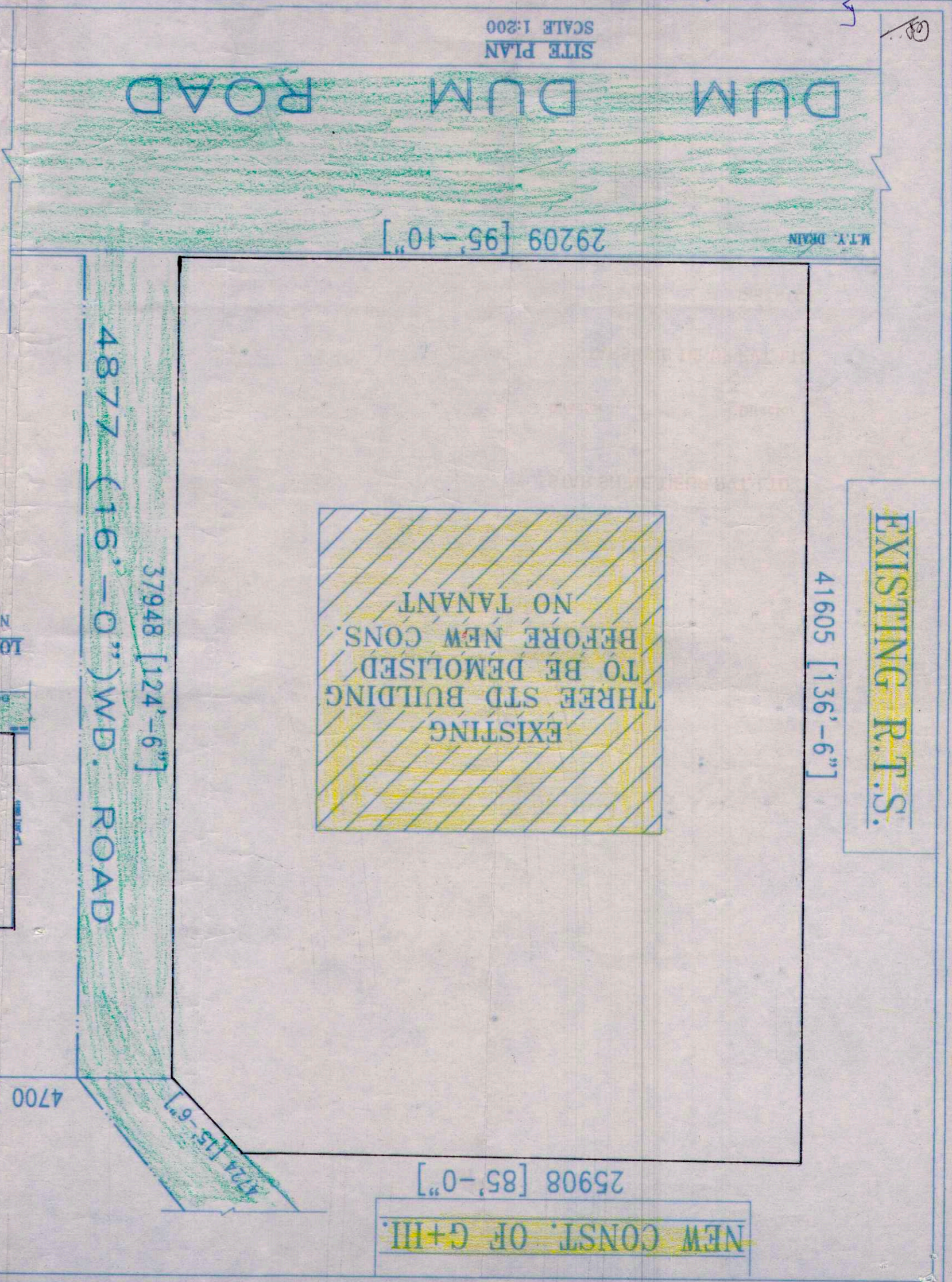
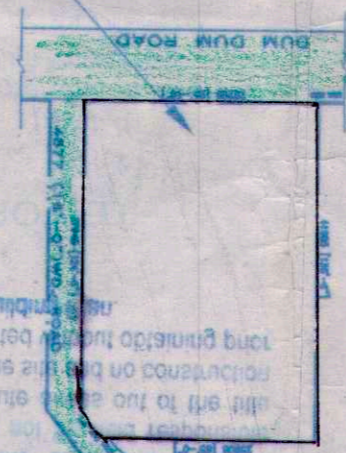

**NEW CONST. OF G+HI.**

**EXISTING R.T.S.**

41605 [136'-6"]

29209 [95'-10"]

SITE PLAN  
SCALE 1:200

DUM DUM ROAD

M.T.Y. DRAIN