

PREMISES NO. 36 A, BENINANDAN STREET, WARD NO. 071, P. S. KALIGHAT,
KOLKATA 700 025 UNDER BOROUGH IX [K. M. C.]

LATITUDE : 22°32'11.81"N

LONGITUDE : 88°20'43.29"E

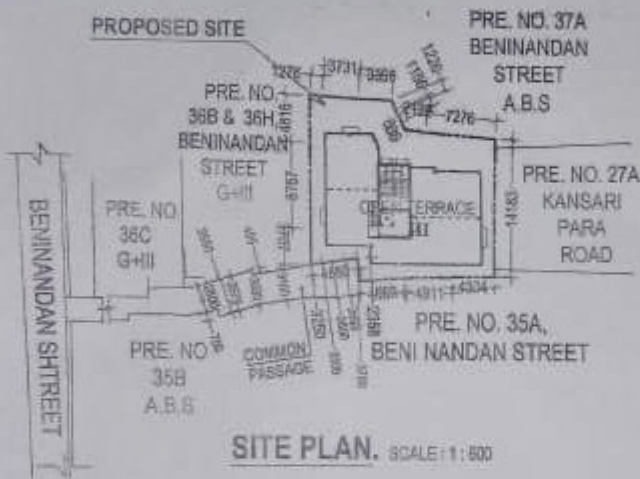

Malay Kumar Basu
21/10/2019

MALAY KUMAR BASU
B.C.E; P.G.D.P.M., MIE (Arch)
M.I.G.O., M-Tech (Struc).
Chartered Engineer (I)
12/A, Jadu Bhattacharjee Lane
Kolkata - 700 025

E.S.E.-1/97
K.M.C.



DATED : 25.09.2019

SCALE : 1 : 75

ALL DIMENSIONS ARE IN MM.
UNLESS OTHERWISE MENTIONED