

11

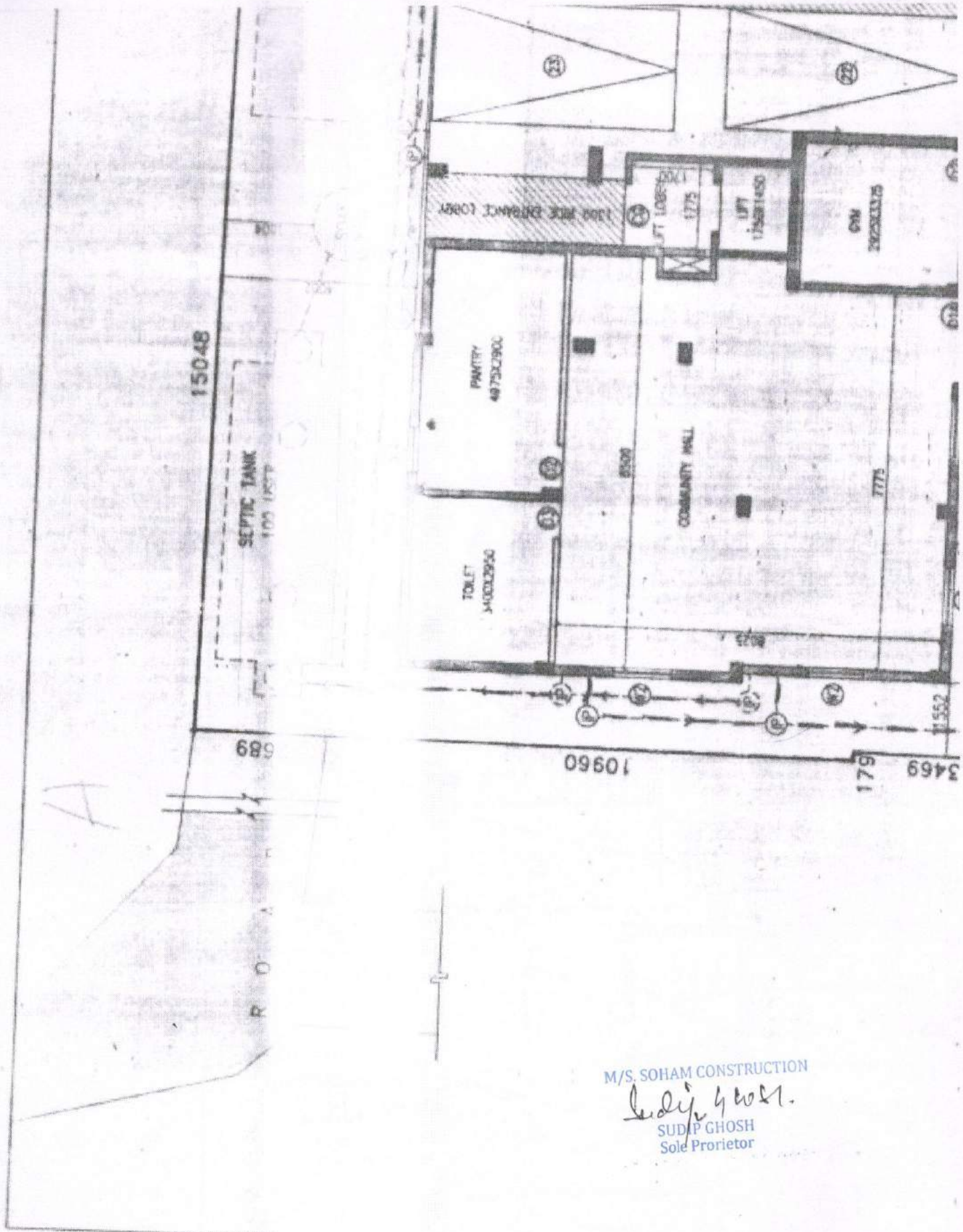

M/S. SOHAM CONSTRUCTION  
*Sudip Ghosh*  
 SUDIP GHOSH  
 Sole Proprietor







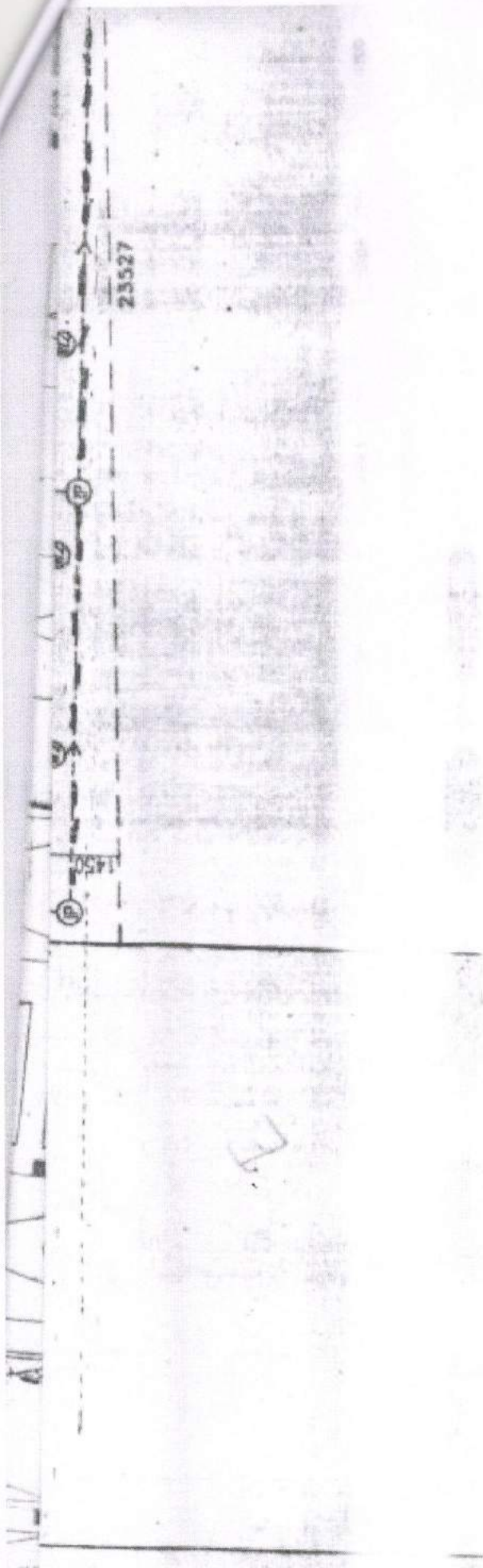

POND

AREA-15 DECIMAL

M/S. SOHAM CONSTRUCTION

*Sudip Ghosh*

SUDIP GHOSH  
Sole Proprietor

1823

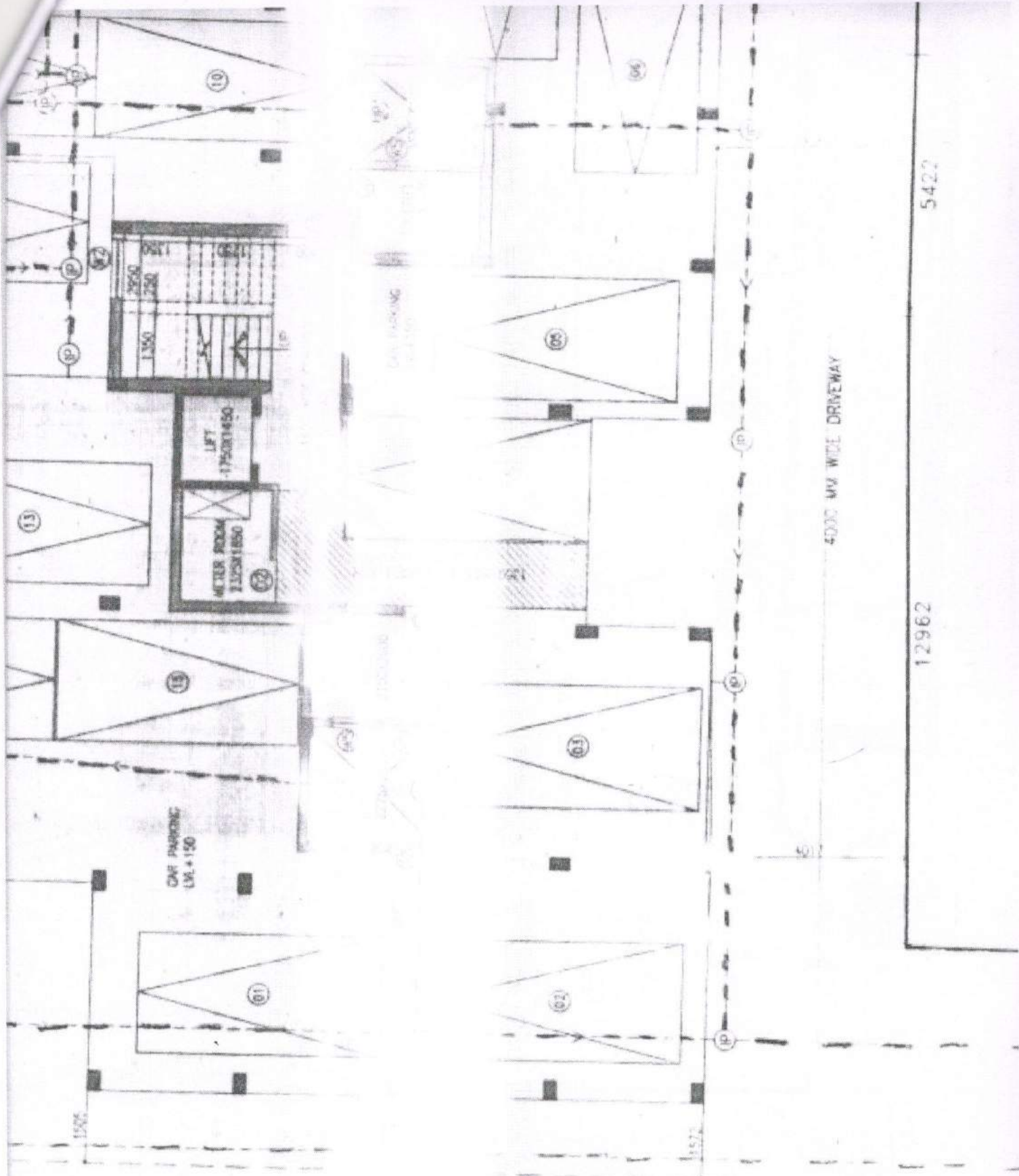

26505

M/S. SOHAM CONSTRUCTION  
*Sudip Ghosh*  
 SUDIP GHOSH  
 Sole Proprietor

2ND. FLOOR	799.02	20.97
3RD. FLOOR	799.02	20.97
4TH. FLOOR	789.02	20.97
TOTAL	3914.82	104.85

**TOTAL FLOOR AREA INCLUDING CB =**  
**CAR PARKING CALCULATION**

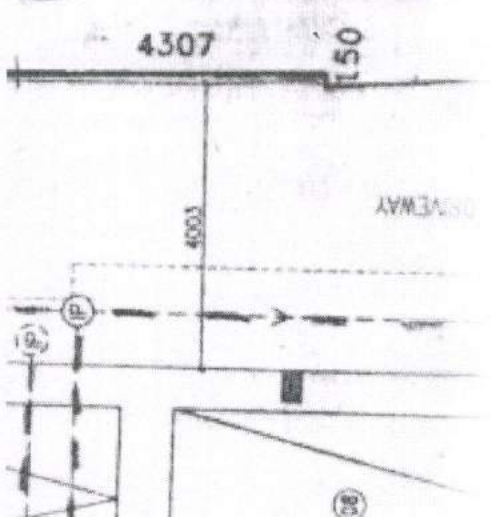
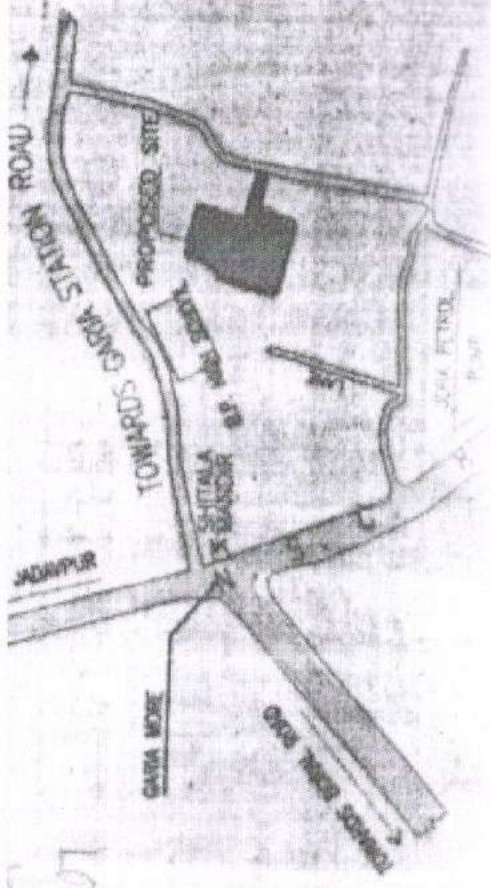

FOR OTHER USES	
GRAND TOTAL	2

M/S. SOHAM CONSTRUCTION  
*Sudip Ghosh*  
 SUDIP GHOSH  
 Sole Proprietor

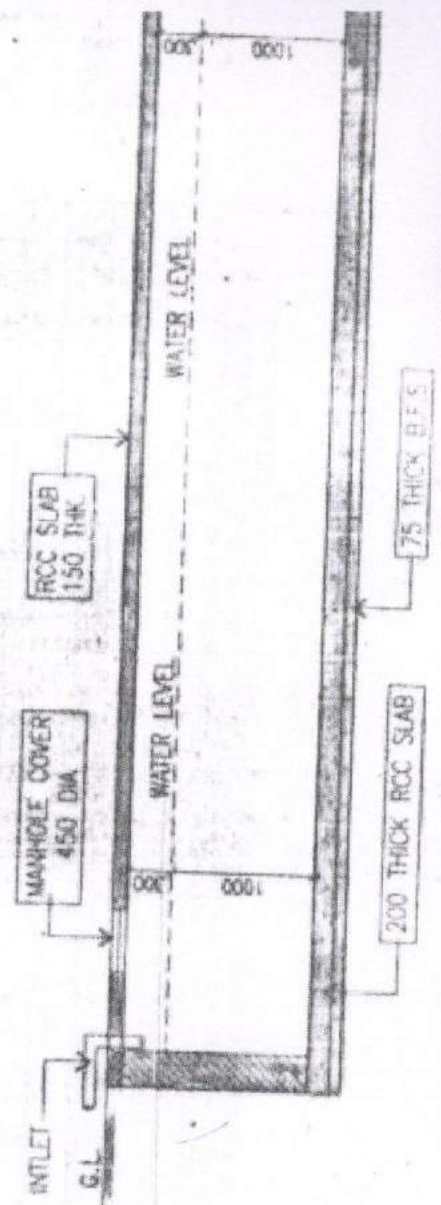
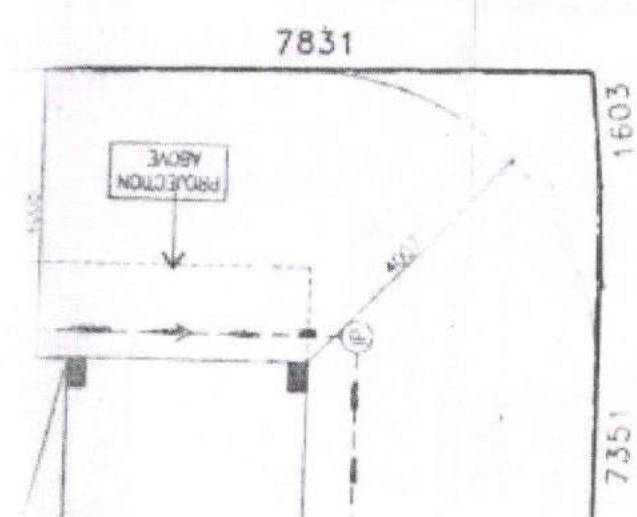

SECTION UU

771.79	26.18	-	6.0	739.61	708.17	-	22.40	18.12
771.79	26.18	-	6.0	739.61	708.17	-	23.15	19.43
771.79	26.18	-	6.0	739.61	708.17	-	23.15	19.43
3814.73	132.09	-	30.0	3652.64	2807.44	-	23.15	19.43
							91.85	76.41

(3652.64-492.77)/20  
= 1.515

41) = 3891.14 SQM

**DOOR & WINDOW SCHEDULE**

SLNO.	MARK	SIZE	TYPE
08	SD1	1500X2100	COLLAPSIBLE DOOR
09	W1	1500X1200	SLIDING DOOR
10	W1A	1350X1200	FULL GLAZED WINDOW
11	W2	1200X1200	DO
12	W3	1000X1800	DO
13	W4	800X1200	DO
14	W5	900X1000	DO
15	W6	600X1000	DO

M/S SOHAM CONSTRUCTION  
*Sudip Ghosh*  
 SUDIP GHOSH  
 Sole Proprietor

**CERTIFICATE OF STRUCTURAL ENGINEER :**

THE STRUCTURAL DESIGN & DRAWING OF BOTH FOUNDATION AND SUPER STRUCTURE OF THE BUILDING HAS BEEN PREPARED BY ME CONSIDERING ALL POSSIBLE LOADS INCLUDING SEISMIC LOAD AS PER NATIONAL BUILDING CODE OF INDIA AND THE FOUNDATION IS CAPABLE OF TAKING THE LOAD CERTIFIED THAT IT IS SAFE AND STABLE IN ALL RESPECT.

*MS*

MS. MITA SAHA  
 M.I.E., M.E. (Struct), C.E.  
 ESE-92(1)

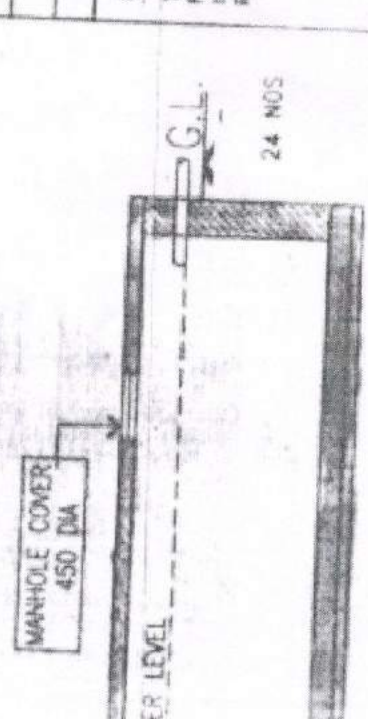





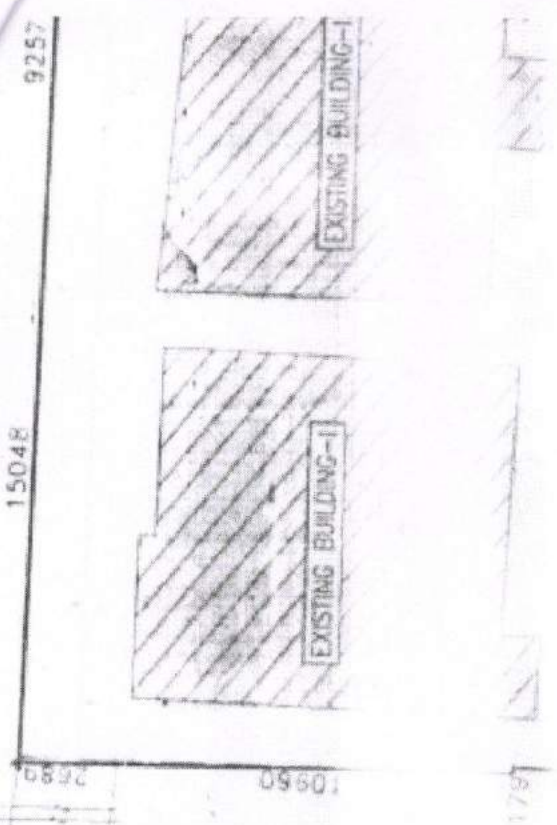

POND

18234 1676

M/S. SOHAM CONSTRUCTION

*Sudip Ghosh*

SUDIP GHOSH  
Sole Proprietor

17491

5000

3931

ROAD

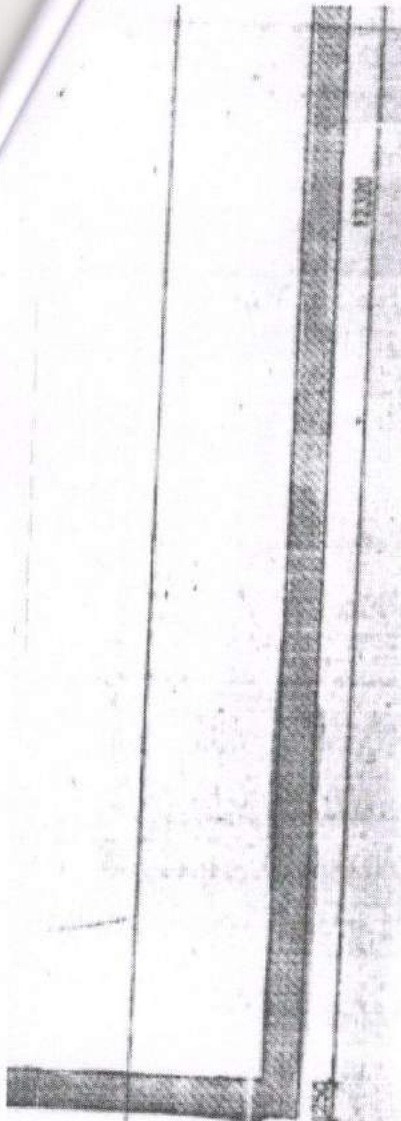

(X)



4307 8 5824 7831

12962  
5422  
7351  
1603

M/S. SOHAM CONSTRUCTION

*Sudip Ghosh*

SUDIP GHOSH  
Sole Proprietor

**ALOK ROY**

Enlisted Geotechnical Engineer  
Rajpur-Sonarpur Municipality  
No.- 009 / G.T. Eng., Class-I

SIGNATURE OF GEOTECHNICAL ENGINEER

*Sudip Ghosh*

M/S. SOHAM CONSTRUCTION

*Sudip Ghosh*

SUDIP GHOSH  
Sole Proprietor

Registered Architect

EBA-782 No.- CA/2010/50694

SIGNATURE OF ARCHITECT

PROJECT

PROPOSED (G+4) STORED RESIDENTIAL BUILDING AT GARIA ROAD, HOLDING NO.-233, P.S. DAG NO.-152, 153, 154, 155, 153/1847, 153/1848, 154/1849, KHATAN NO.-222, 223, 224, J.L. NO.- 47, MOUZA - BARIHANS FARIABAD, UNDER RAJPUR SONARPUR MUNICIPALITY, WARD NO.-29, P.S.-SONARPUR, DIST - 24 PARGANAS (S), KOLKATA

SHEET TITLE :

GR. FLOOR PLAN, SITE PLAN, KEY PLAN, SEPTIC TANK & WATER RESERVOIR

DRAWING NO:- FJA/S.C./GARIA ROAD/SAN./ARC 1

SCALE : 1:100

SHEET : AC

DEALT BY : P N



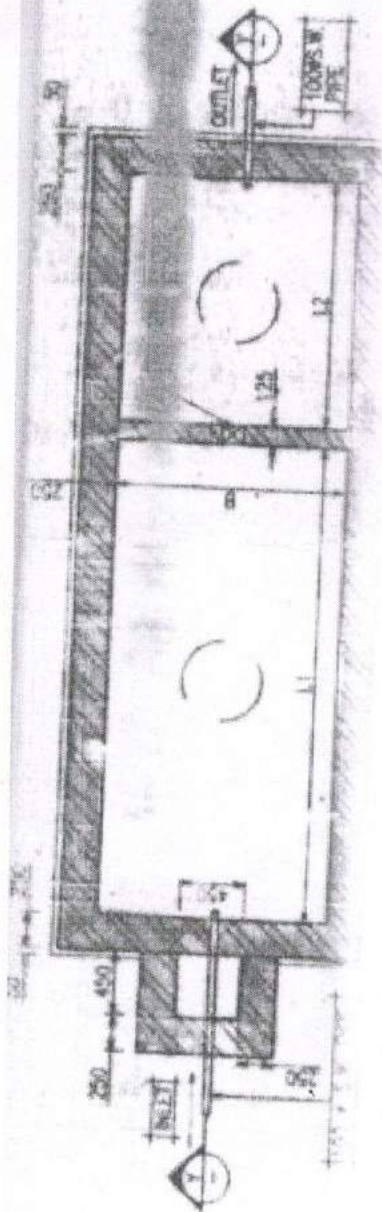

M/S. SOHAM CONSTRUCTION  
*Sudip Ghosh*  
SUDIP GHOSH  
Sole Proprietor

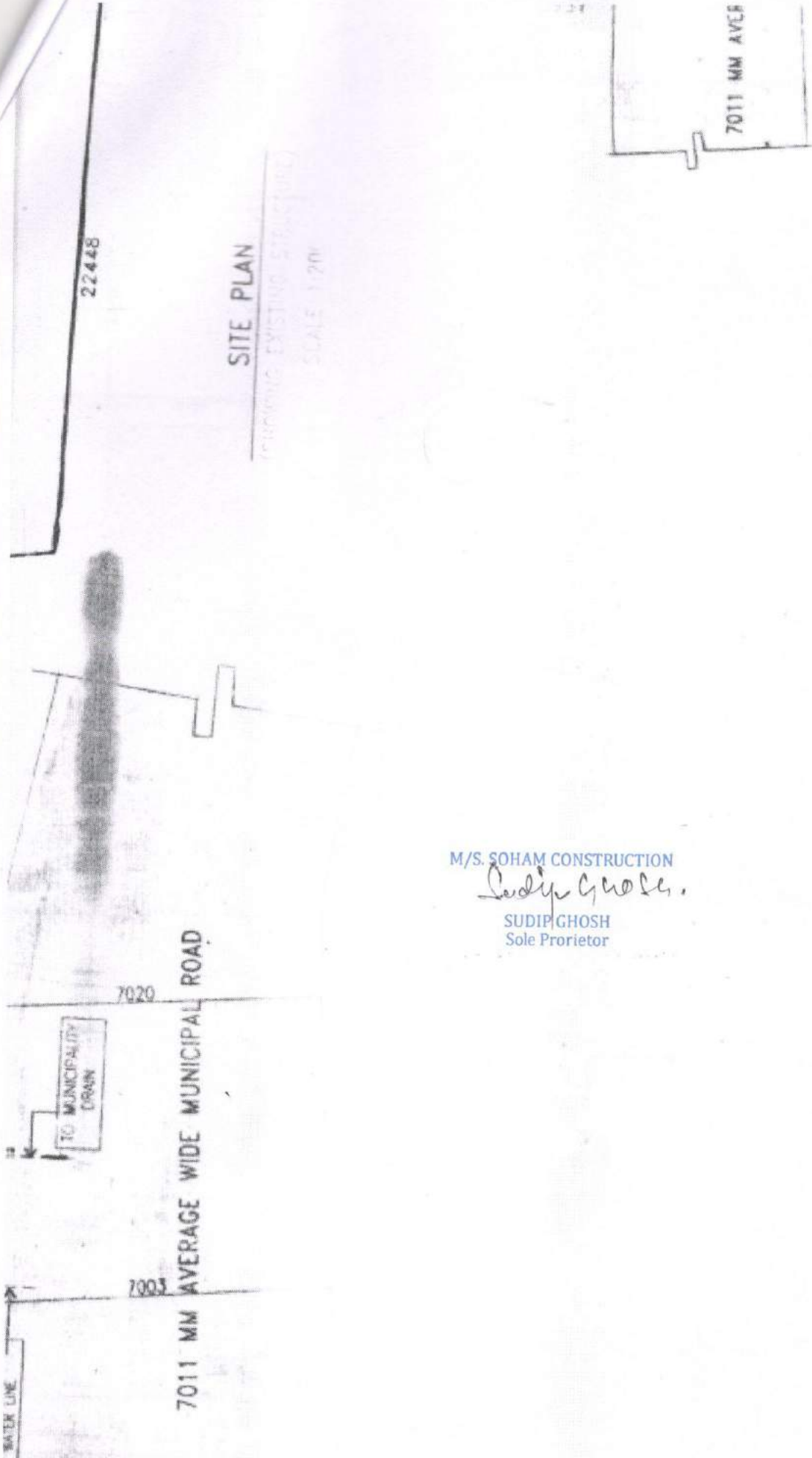

**SITE PLAN**

FOR THE EXISTING STRUCTURE  
SCALE 1:20

M/S. SOHAM CONSTRUCTION

*Sudip Ghosh*

SUDIP GHOSH  
Sole Proprietor

22448

7020

7003

7011 MM AVERAGE WIDE MUNICIPAL ROAD

7011 MM AVCE

TO MUNICIPALITY DRAIN

WATER LINE

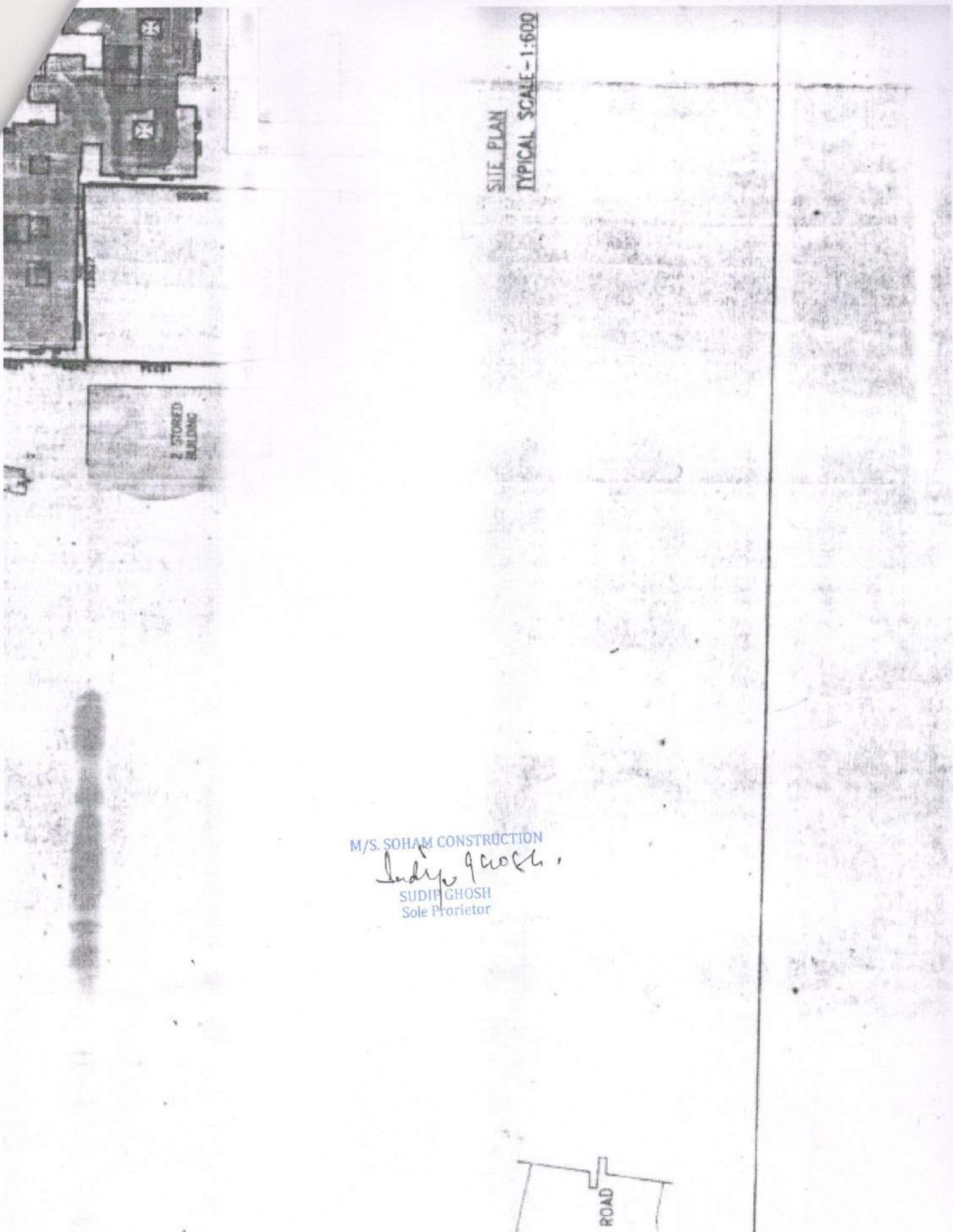

SITE PLAN  
TYPICAL SCALE - 1:600

M/S. SOHAM CONSTRUCTION  
*Sudip Ghosh*  
SUDIP GHOSH  
Sole Proprietor

06/02/2017

SCALE : 1:100

(UNLESS OTHERWISE MENTIONED)

OFFICE USE ONLY

Checked by

*Partha Gupta*  
Local Office Engineer-in-Charge  
RAJF JR-SONARPUR MUNICIPALITY  
06/04/2017

M/S. SOHAM CONSTRUCTION

*Sudip Ghosh*

SUDIP GHOSH

Sole Proprietor

APPROVED

Plan No. *53/09/29/60* Dated *06/06/2017*

Valid Upto *06/06/2022*

*Partha Gupta*

Partha Gupta  
Municipal Engineer

*Dr. Pallab Das*

Dr. Pallab Das  
Chairman

RAJF JR-SONARPUR MUNICIPALITY