

PROJECT

PROPOSED "G+14" STORED RESIDENTIAL BUILDINGS FOR PHASE -1 OF "SHIRAM GRAND CITY" (AN INTEGRATED IT TOWNSHIP AND AUTOMATIVE ANCILLARY PARK) LOCATED AT UTTARPARA HOOGHLY FALLING UNDER UTTARPARA KOTRANG MUNICIPALITY AND KANAIPUR PANCHAYAT, MOUZA - KOTRANG, KONNAGAR, BHADRAKALI, BARABAHARA, KHORDABAHARA, MAKHLA, DISTRICT- HOOGHLY.

TITLE

MASTER PLAN FIRST FLOOR - PHASE - 1

DC /MBA/ MASTER IS/ FL / A-34 - E1	DRAWN BY
1 - 400	CHKD BY
13.8.2015	DATE
DM6380	JOB NO
	AP/ CD BY
	DESIGNED BY
	ISSUE STATUS
K.M.D.A.	

1. ALL EXTERNAL WALLS ARE 200 THK. IN ALL FLOOR.
2. ALL DIMENSIONS ARE IN MILLIMETER

For Mr. of Shiram Grand City Pvt. Ltd.
Shir
Authorized Signatory

SIGNATURE OF OWNER

DECLARATION OF STRUCTURAL ENGINEER
THE STRUCTURAL DESIGN AND CALCULATION OF THE BUILDING HAS BEEN MADE BY ME CONSIDERING ALL SUPERSTRUCTURE OF THE BUILDING HAS BEEN MADE BY ME CONSIDERING ALL POSSIBLE LOADS INCLUDING THE SEISMIC LOAD AS PER NATIONAL BUILDING CODE OF INDIA AND CERTIFY THAT IT IS SAFE AND STABLE IN ALL RESPECTS

ANURAJ PARIHART
S.E., STRUC. ENGINEER
REG. NO. 42467/1999
K.M.E.R.P., K. J. SOUMYANARAYAN
R.M.I.S.C., M.C.

SIGNATURE OF STRUCTURAL ENGINEER
STRUCTURAL CONSULTANT

DECLARATION OF ARCHITECT

CERTIFY THAT ALL THE ARCHITECTURAL DRAWING OF THE PROJECT AT HAND HAVE BEEN PREPARED BY ME IN COMPLIANCE WITH THE WEST BENGAL MUNICIPAL BUILDING RULE 2007. I SHALL BE HELD RESPONSIBLE IF ANY INADEQUATE OR INCORRECT INFORMATION IS FURNISHED BY ME OR ANY VIOLATION OF PROVISIONS OF THESE RULES. (THE WEST BENGAL MUNICIPAL BUILDING RULES 2007) IS FOUND IN ANY OF THE DRAWING AND DOCUMENTS ISSUED BY ME AND SUBMITTED TO THE LICENSING AUTHORITY FOR OBTAINING SANCTION.

V. Chakrabarti
Architect
Registration No.: CA 9881/1994

SIGNATURE OF ARCHITECT
ARCHITECTS -

THE DESIGN CELL
2A, COOPER STREET
KOLKATA - 26

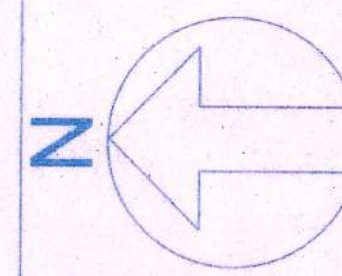

12.0M WIDE ROAD

12.0M WIDE ROAD

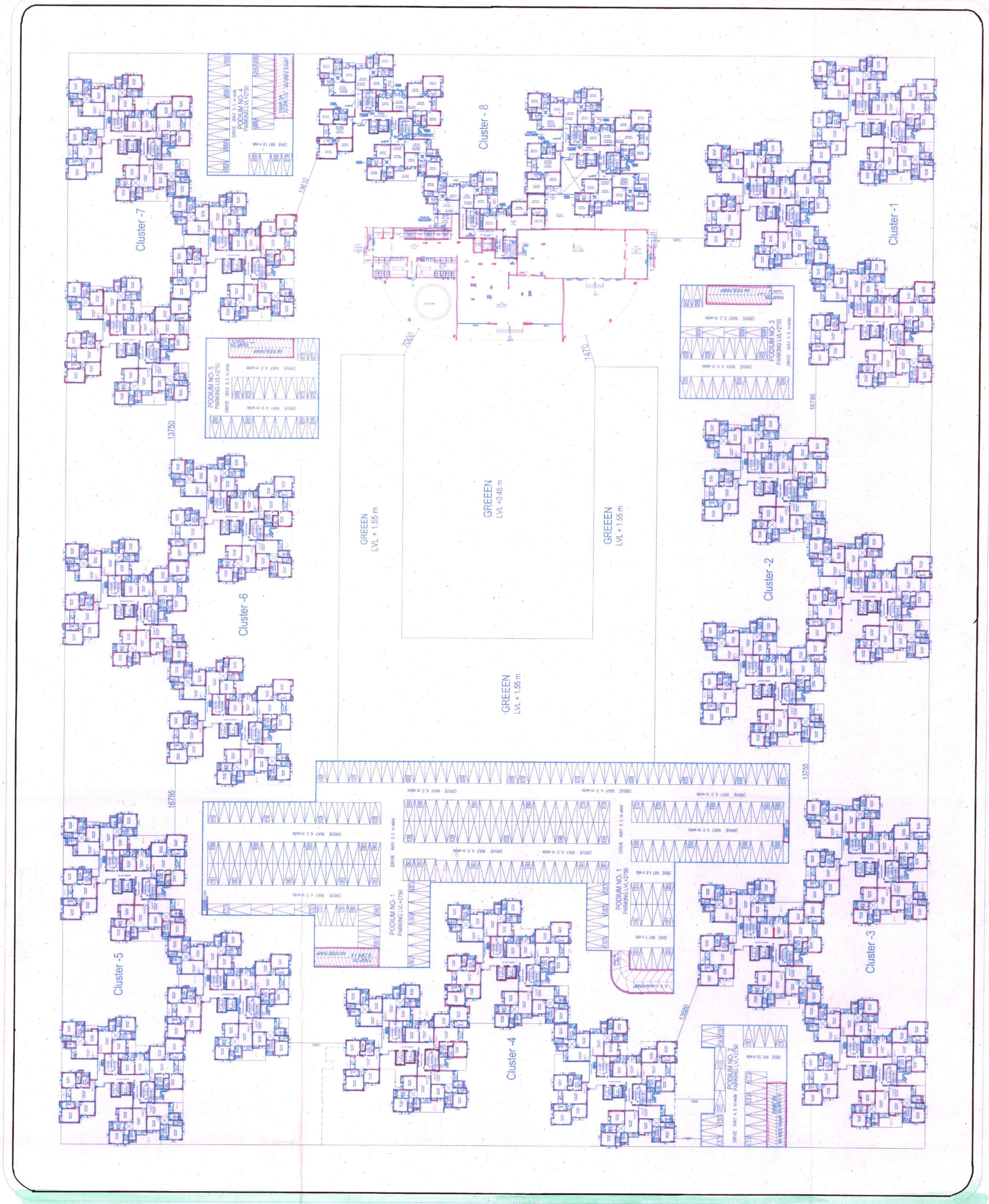

12.0 M WIDE EXTERNAL ROAD

20.0 M WIDE GREEN AREA

12.0 M WIDE EXTERNAL ROAD

MASTER PLAN - FIRST FLOOR

1. This document contains...
2. This document contains...
3. This document contains...
4. This document contains...
5. This document contains...
6. This document contains...
7. This document contains...
8. This document contains...
9. This document contains...
10. This document contains...

Director of all regional...
1997/18
K. M. D. A.

Dr. Director of Planning
LUPC (M) 18/19/98

1997/18
K. M. D. A.

SANCTIONED
K. M. D. A.