

PROJECT  
 PROPOSED \* G+14 \* STORED RESIDENTIAL BUILDINGS FOR PHASE - 1 OF "SHRIRAM GRAND CITY" (AN INTEGRATED IT TOWNSHIP AND AUTOMATIVE ANCILLARY PARK) LOCATED AT UTTARPARA HOOGHLY FALLING UNDER UTTARPARA KOTRANG MUNICIPALITY AND KANAIPUR PANCHAYAT, MOUZA- KOTRANG, KONNAGAR, BHADRAKALI, BARABAHARA, KHORDABAHARA, MAKHLA, DISTRICT- HOOGHLY.

TITLE  
 SITE PLAN - PHASE I

DWG. NO.	DC /KMDA/ SITE PLAN/ A- 36
SCALE	1 : 400
DATE	10.8.2015
JOB NO.	DME330
DRAWN BY	
CHECK BY	
APPROVED BY	
DESIGNED BY	
ISSUE STATUS	K.M.D.A.

1. ALL EXTERNAL WALLS ARE 200 THK. IN HALF FLOOR.  
 2. ALL INTERNAL WALLS ARE 120 THK.  
 3. ALL DIMENSIONS ARE IN MILLIMETER.

Chief Executive Officer  
 City Corporation, Kolkata  
 Bldg. 32, 1st Floor, Sector V  
 Salt Lake, Kolkata - 700 061  
 SIGNATURE OF OWNER

DECLARATION OF STRUCTURAL ENGINEER  
 THE STRUCTURAL DESIGN AND DRAWINGS OF BOTH FOUNDATION AND SUPERSTRUCTURE OF THE BUILDING HAS BEEN MADE BY ME CONSIDERING ALL SUPERSTRUCTURE OF THE BUILDING HAS BEEN MADE BY ME CONSIDERING ALL THE LOADS AS PER NATIONAL BUILDING CODE OF INDIA AND CERTIFY THAT IT IS SAFE AND STABLE IN ALL RESPECTS.

SANJIV L. BANERJEE  
 M.E. STRUCTURAL ENGINEER  
 R.C.E. (REGD. NO. 11784)  
 S.S. CONSULTANTS PVT. LTD.  
 SIGNATURE OF STRUCTURAL ENGINEER

STRUCTURAL CONSULTANT

DECLARATION OF ARCHITECT  
 I CERTIFY THAT ALL THE ARCHITECTURAL DRAWINGS OF THE PROJECT AT HAND AND NOTION HAVE BEEN PREPARED BY ME COMPLYING WITH THE WEST BENGAL MUNICIPAL BUILDING RULES 2007. I SHALL BE HELD RESPONSIBLE FOR ANY INCORRECT INFORMATION IS FURNISHED BY ME OR ANY VIOLATION OF PROVISIONS OF THESE RULES.  
 (THE WEST BENGAL MUNICIPAL BUILDING RULES 2007 IS FOUND IN ANY OF THE DRAWING AND DOCUMENTS, SIGNED BY ME AND SUBMITTED TO THE SANCTIONING AUTHORITY FOR OBTAINING SANCTION.)

Architects  
 Sankar  
 Architects  
 Kolkata  
 Regd. No. 2485 11784  
 SIGNATURE OF ARCHITECT

ARCHITECTS -

THE DESIGN CELL  
 2A, COOPER STREET  
 KOLKATA-26

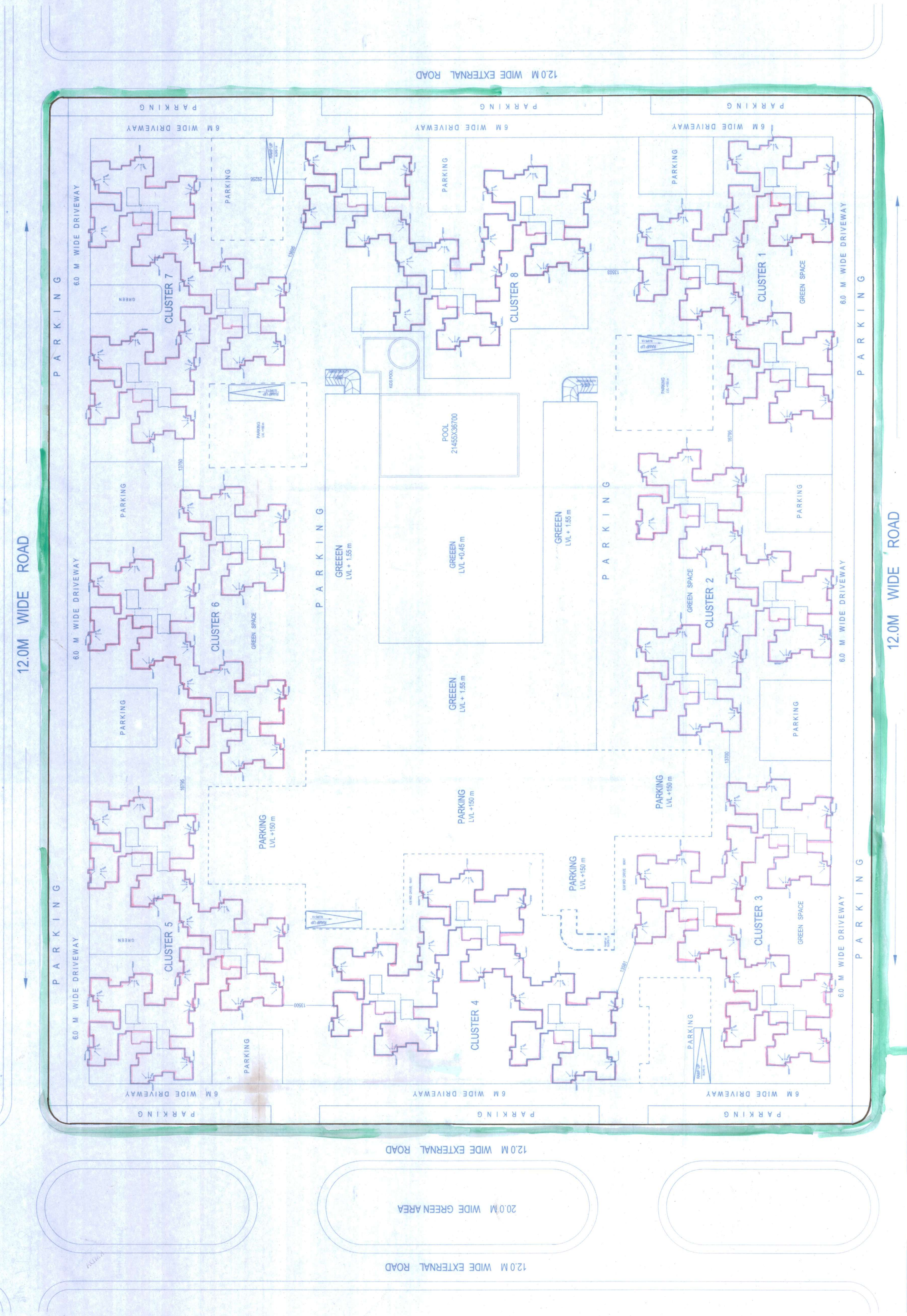
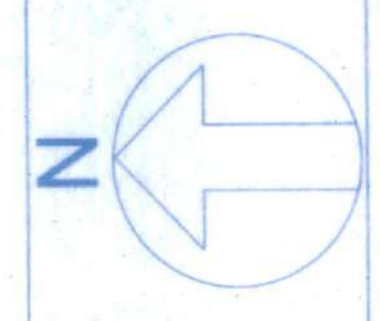

SITE PLAN

Design of all structural members including  
that of the foundation shall conform to the  
standard as specified in the National Building  
Code of latest edition

**CHECKED  
&  
VERIFIED**

*[Handwritten Signature]* 09/11/16

Dy. Director of Planning  
LUPC / W.B. / S.P. Unit  
K. M. D. A.

*[Handwritten Signature]*  
09/11/16  
Director-in-Charge  
Statutory Planning Unit, KMDA

*[Handwritten Signature]*  
Secretary  
KMDA

**SANCTIONED**