

DHARMIK NIRMAN PRIVATE LIMITED

*Shobha Shah*  
Joint Director

ASPIRATIONS TOWERS PRIVATE LIMITED

*Shobha Shah*  
Joint Director

DHARMIK INFRACON PRIVATE LIMITED

*Shobha Shah*  
Joint Director

**SURVEY PLAN OF PREMISES  
NO.4 NAKTALA ROAD.  
KOLKATA-700047.**



SCALE 1 : 200

LAND AREA  
1983.153 SQ.METRE.  
29K. 10CH. 17SFT.  
(MORE OR LESS)

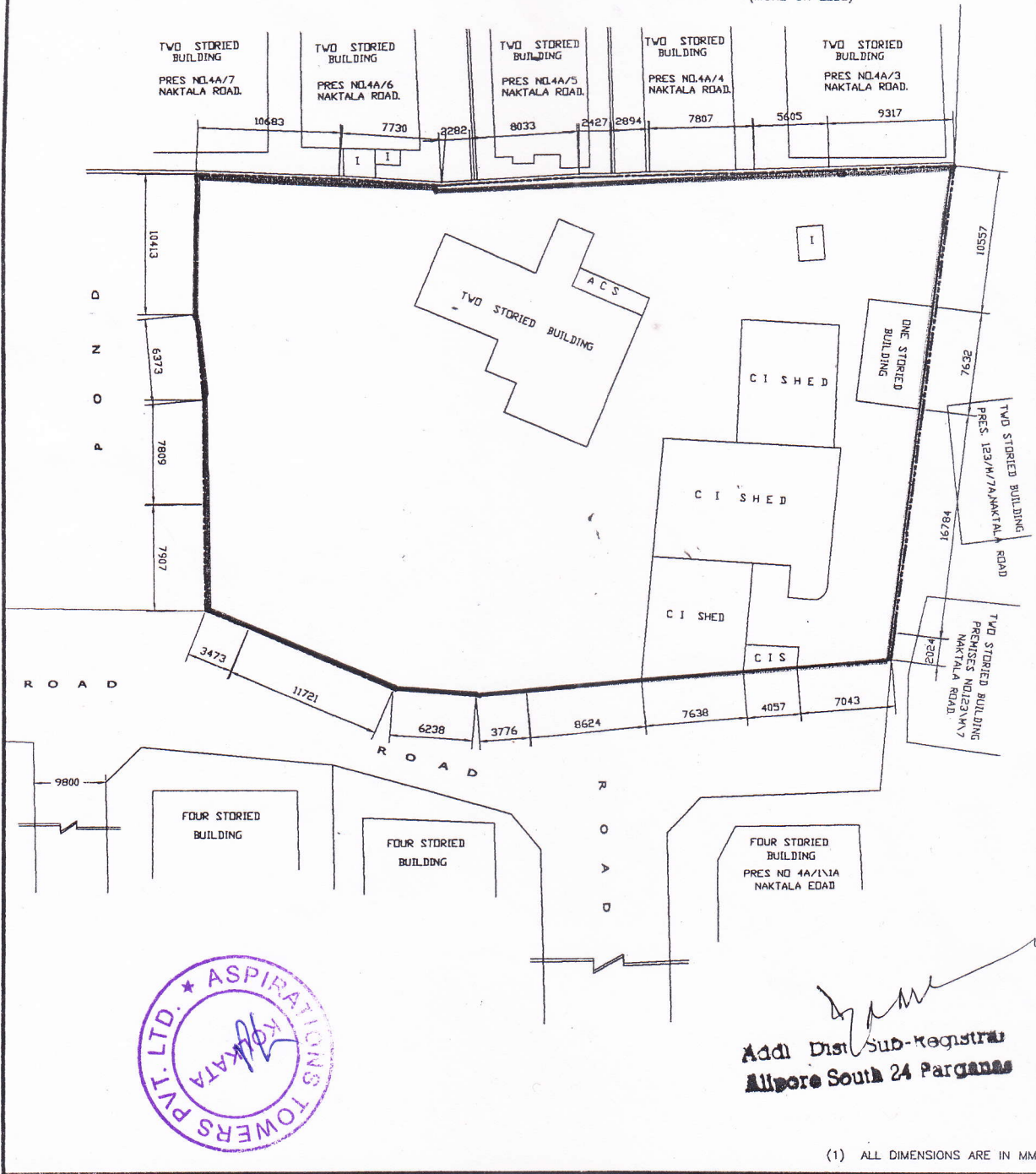

*Shobha Shah*  
Addl Dist Sub-Registrar  
Alipore South 24 Parganas

(1) ALL DIMENSIONS ARE IN MM.

*Ketan Shah*  
*Sunita Prateep*

*Sulochana A. Hiranani*  
*Jyotsna Shah*

*Shobha Shah*  
*Rajendra Shah*  
*P.D. Shah*