

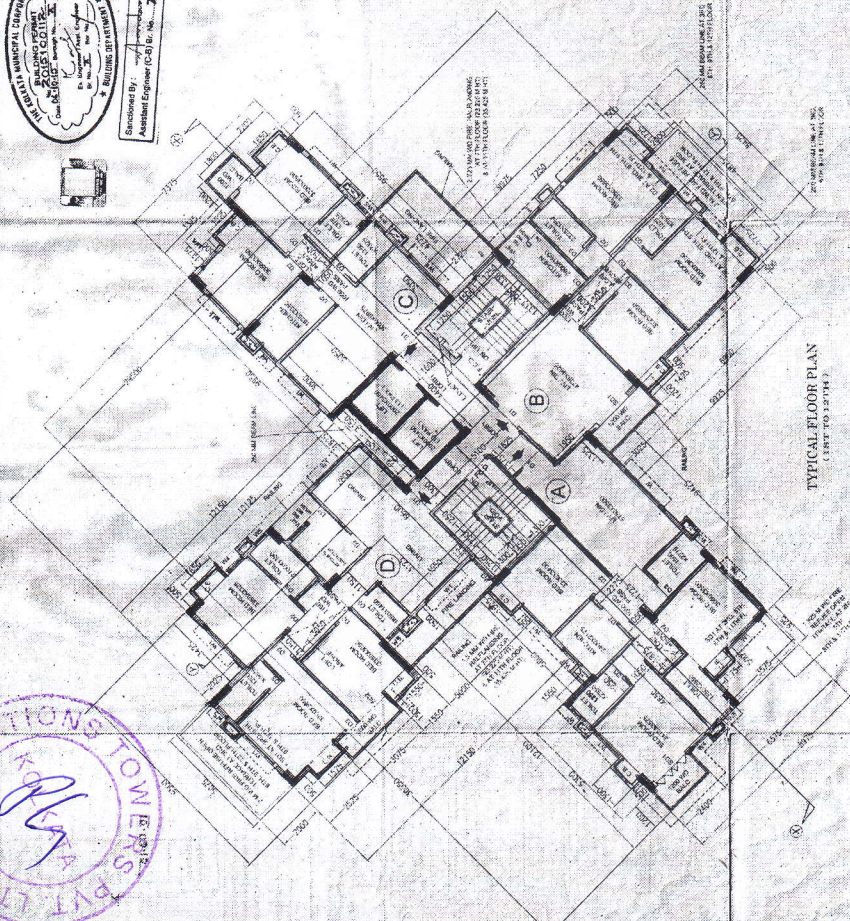

Structured By: **Anjali Memorial Corporation**
 Assistant Engineer (C-8) (R. No. 10/2003)

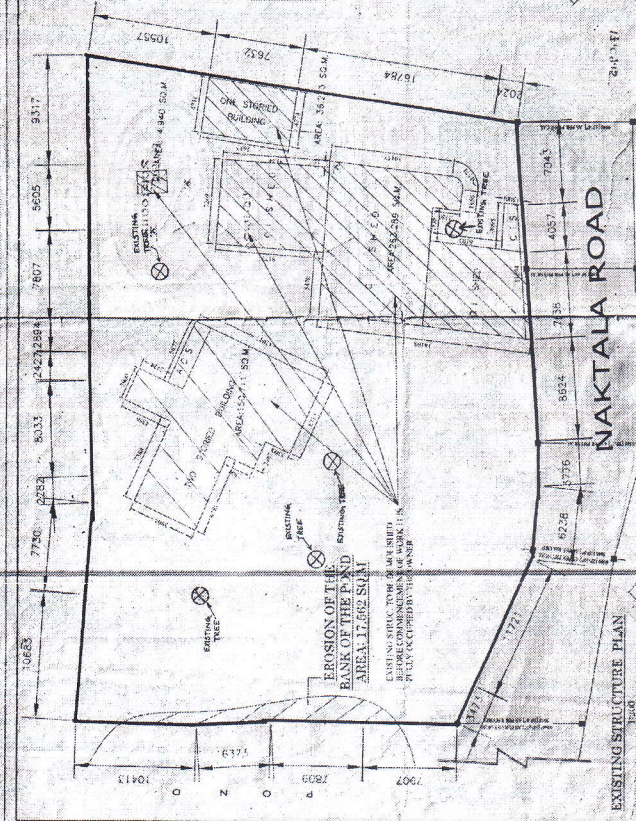

CERTIFICATE OF STRUCTURAL ENGINEER

THE DRAWINGS AND SPECIFICATIONS OF THE BUILDING HAVE BEEN MADE BY ME, CONSIDERING ALL RELEVANT LOADS INCLUDING WIND, SEISMIC, AND OTHER LOADS AS PER IS 800, IS 875, IS 801, IS 802, IS 803, IS 804, IS 805, IS 806, IS 807, IS 808, IS 809, IS 810, IS 811, IS 812, IS 813, IS 814, IS 815, IS 816, IS 817, IS 818, IS 819, IS 820, IS 821, IS 822, IS 823, IS 824, IS 825, IS 826, IS 827, IS 828, IS 829, IS 830, IS 831, IS 832, IS 833, IS 834, IS 835, IS 836, IS 837, IS 838, IS 839, IS 840, IS 841, IS 842, IS 843, IS 844, IS 845, IS 846, IS 847, IS 848, IS 849, IS 850, IS 851, IS 852, IS 853, IS 854, IS 855, IS 856, IS 857, IS 858, IS 859, IS 860, IS 861, IS 862, IS 863, IS 864, IS 865, IS 866, IS 867, IS 868, IS 869, IS 870, IS 871, IS 872, IS 873, IS 874, IS 875, IS 876, IS 877, IS 878, IS 879, IS 880, IS 881, IS 882, IS 883, IS 884, IS 885, IS 886, IS 887, IS 888, IS 889, IS 890, IS 891, IS 892, IS 893, IS 894, IS 895, IS 896, IS 897, IS 898, IS 899, IS 900, IS 901, IS 902, IS 903, IS 904, IS 905, IS 906, IS 907, IS 908, IS 909, IS 910, IS 911, IS 912, IS 913, IS 914, IS 915, IS 916, IS 917, IS 918, IS 919, IS 920, IS 921, IS 922, IS 923, IS 924, IS 925, IS 926, IS 927, IS 928, IS 929, IS 930, IS 931, IS 932, IS 933, IS 934, IS 935, IS 936, IS 937, IS 938, IS 939, IS 940, IS 941, IS 942, IS 943, IS 944, IS 945, IS 946, IS 947, IS 948, IS 949, IS 950, IS 951, IS 952, IS 953, IS 954, IS 955, IS 956, IS 957, IS 958, IS 959, IS 960, IS 961, IS 962, IS 963, IS 964, IS 965, IS 966, IS 967, IS 968, IS 969, IS 970, IS 971, IS 972, IS 973, IS 974, IS 975, IS 976, IS 977, IS 978, IS 979, IS 980, IS 981, IS 982, IS 983, IS 984, IS 985, IS 986, IS 987, IS 988, IS 989, IS 990, IS 991, IS 992, IS 993, IS 994, IS 995, IS 996, IS 997, IS 998, IS 999, IS 1000.

BIBEK BIKASH MULLICK
 S.E.E. - 1775
 ANJALI MEMORIAL CORPORATION
 S.O. OF STRUCTURAL ENGINEER

V. Sengupta
 HOUSHILK SENGUPTA
 S.E.E. - 1776 (R.N.C.I.)
 S.O. OF STRUCTURAL ENGINEER

PROJECT
 PROPOSED G+12 STORED (HT: 40 M)
 RESIDENTIAL BUILDING AT PRE. NO.
 4 NAKTALA ROAD, KOLKATA-700 047,
 WARD NO-108 BR-X, P.S. NETAJI NAGAR.

DATE 22.08.2014
SCALE 1:100

ANJALI MEMORIAL CORPORATION
 Kolkata, West Bengal, India

DECLARATION OF ARCHITECT

I, THE ARCHITECT, HAVE PREPARED THE ARCHITECTURAL DRAWINGS AND SPECIFICATIONS OF THE BUILDING AS PER THE REQUIREMENTS OF THE BUILDING ACT, 1956 AND THE BUILDING REGULATIONS, 1957, AND I AM RESPONSIBLE FOR THE ACCURACY AND COMPLETENESS OF THE SAME. I HAVE ALSO CHECKED THE DRAWINGS AND SPECIFICATIONS OF THE BUILDING AS PER THE REQUIREMENTS OF THE BUILDING ACT, 1956 AND THE BUILDING REGULATIONS, 1957, AND I AM RESPONSIBLE FOR THE ACCURACY AND COMPLETENESS OF THE SAME.

ANJALI TOWERS PVT. LTD.
 S.O. OF ARCHITECT

DECLARATION OF OWNER

I, THE OWNER, HAVE READ AND UNDERSTOOD THE ARCHITECTURAL DRAWINGS AND SPECIFICATIONS OF THE BUILDING AND I AM RESPONSIBLE FOR THE ACCURACY AND COMPLETENESS OF THE SAME. I HAVE ALSO CHECKED THE DRAWINGS AND SPECIFICATIONS OF THE BUILDING AS PER THE REQUIREMENTS OF THE BUILDING ACT, 1956 AND THE BUILDING REGULATIONS, 1957, AND I AM RESPONSIBLE FOR THE ACCURACY AND COMPLETENESS OF THE SAME.

ANJALI TOWERS PVT. LTD.
 S.O. OF OWNER

TYPE	WIDTH	HT	TYPE	WIDTH	HT
DOOR	1000	2100	DOOR	1000	2100
WINDOW	1500	1800	WINDOW	1500	1800
...