

**SITE PLAN AT HOLDING NO. - 3112, WARD NO. - 8, MOUZA - JAGANNATHPUR, J. L. NO. -51,
L.R. KHATIAN NO. - 1467, R.S. DAG NO.- 563,564,565 , L.R. DAG NOS. - 689,690,691, P. S. -
SONARPUR,DISTRICT - 24 PARGANAS (SOUTH), UNDER RAJPUR-SONARPUR MUNICIPALITY**

LATITUDE : 22°31'48.01" NORTH
 LONGITUDE : 88°19'48.01" EAST
 TOTAL LAND (AS PER ASSESSMENT DEED) = 2148.643 SQM
 TOTAL LAND (AS PER PHYSICAL) = 2229.89 SQM.
 STRIP OF LAND = 81.26 SQM.
 NET LAND AREA = (2229.89-81.26) SQM. = 2148.63 SQM.

RS DAG NO: 752
33620

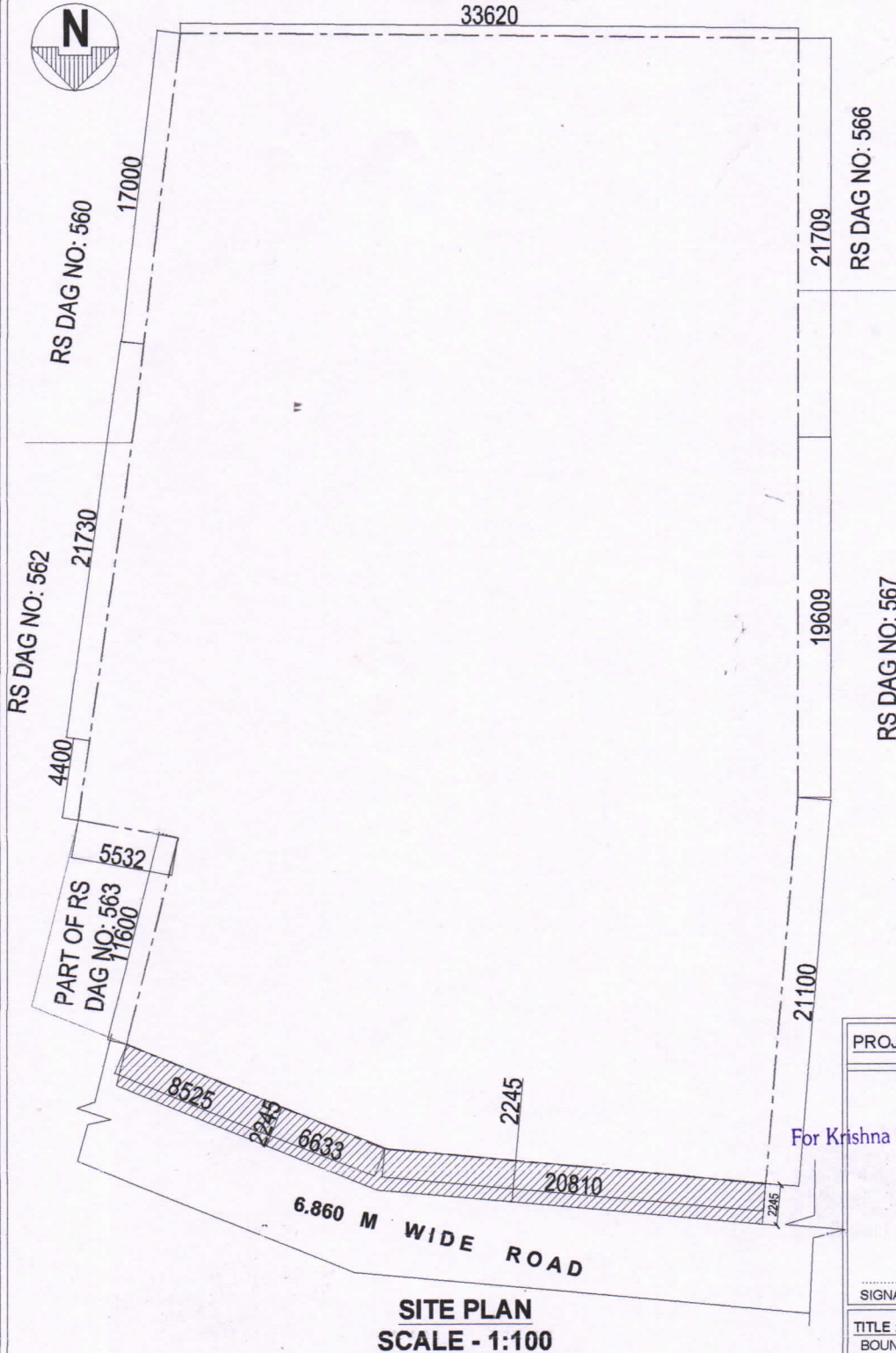
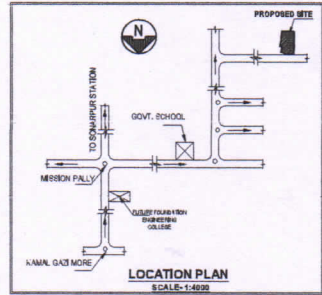

PROJECT NAME : MISSION NIKETAN

For Krishna Hi-Tech Builders Private Limited
Ramkrishna Das
 Director

SIGNATURE OF THE AUTHORIZED SIGNATORY (S)

TITLE :
BOUNDARY PLAN & KEY PLAN OF MISSION NIKETAN



Krishna Hi-Tech Builders Private Ltd.

637, Rajdanga Main Road, Kolkata - 700 107

Phone : 91-33-2442 4687 / 4688 / 0939

E-mail : tapas@krishnahitech.in

Fax : 91-33-2442 4688

CIN : U45400WB2015PTC208172

LAND AREA STATEMENT (Block-1 & Block-2) PROJECT : MISSION NIKETAN

S/No.	PARTICULARS OF THE LAND	UNIT	Total Area
1	TOTAL BUILT UP AREA OF THE PROJECT = 4254.86	SQM	4254.860
2	TOTAL LAND (AS PER ASSESSMENT DEED) = 2148.643 SQM	SQM	2148.643
3	TOTAL LAND (AS PER PHYSICAL) = 2229.89 SQM.	SQM	2229.890
4	STRIP OF LAND = 81.26 SQM.	SQM	81.260
5	NET LAND AREA = (2229.89-81.26 = 2148.63) SQM.	SQM	2148.630

For Krishna Hi-Tech Builders Private Limited

Ramkrishna Das.
Director