

GENERAL NOTES:

- Unless otherwise stated all construction activities shall be carried out conforming to relevant (Indian) standard codes of practice.
- All dimensions are in millimeters & levels are in Metre. Except otherwise mentioned only written dimensions shall be followed.
- All levels given in structural drawings are in accordance with architectural drawings, and indicates structural level only (without finish). However architectural drawing to be coordinated for all levels.
- All structural drawing shall be read along with this drawing as well as relevant architectural drawings.
- Any discrepancy in the structural and architectural drawings shall be brought to the notice of design office before execution of work.

STRUCTURAL CONCRETE:

- Unless otherwise specified Grade of Concrete in structural members shall be as follows.
 - Base Slab, Equipment Fdn, etc.-M20
 - Column/beam - As specified in schedule-M20
 - P.C.C. & base foundation-(1:4:8) M10
 - P.C.C. under floor-(1:3:6)
- For U/G Tank and O/H Tanks concrete grade shall be M-20 added with water proofing compound like 'CONPLAST K4211C' or similar product as per manufacturer's specification approved by the consultants.

REINFORCEMENT:

- Unless otherwise specified all reinforcement to be used shall be TMT of grade Fe-415 (for dia 12 & above) & Fe-415 (for dia 8 & 10) conforming to IS-1786-1985 and elongation shall be minimum 14.5 percent.
- Adequate chair bars to be provided to keep the top reinforcement in proper position.
- Unless otherwise stated lap length of Bars is 50 x D (where D = Dia of bars)
- Unless otherwise specified distribution reinforcement shall be B T @ 300 c/c

7. UNLESS OTHERWISE STATED CONCRETE COVER TO MAIN REINFORCEMENT SHALL BE AS FOLLOWS:

- Wall-40 mm from out side of link. (v) Foundation - 50 mm (vi) R.C. wall - 40 at soil side & 20 at internal side (vii) Col-40 mm (To Edge Of Slab) (viii) Floor slab - 20 mm (ix) Floor Beam - 25 mm

SPECIAL NOTE:

- If any loose pockets in soil are encountered while excavation it shall be filled up with P.C.C.(1:4:8)

1. 'Lud'-developments length of bars shall be as follows:-

- 'Lud'-developments length of bars shall be as follows:-
 - 47x dia of bar

c. Special notes regarding curing.

- Reinforcement should be kept moist for 7 days after casting. The first 14 days packing is a must in slab-beam and column to be covered with wet gunny bags, which shall not be kept dry at any time for 4 days.

FLOOR SLAB REINFORCEMENT SCHEDULE

| Grade | Thick | Bottom Reinforcement | Top Reinforcement |
|-------|-------|----------------------|-------------------|
| S1 | 120 | 8c @ 150 c/c | 8c @ 200 c/c |
| S2 | 120 | 8c @ 150 c/c | 8c @ 200 c/c |

- Provide reinforcement @ 200mm/400mm at discontinuous support at top.
- Provide reinforcement @ 200mm/400mm at discontinuous support at bottom.
- Provide support reinforcement at distance 0.02L / 0.30L from the face of support.
- No curtailment of bottom reinforcement shall be done for beam having spacing 200/c or more.

PILE NOTES

- Piles bored cast in situ piles.
- Location of piles with respect to column centres should be as per drawing.
- Out-off level of pile as per section.
- 4.5:2:1 Part shall be followed for all related technical matter.
- Grade of concrete in 20.
- Grade of steel Fe-415, grade of concrete M20.
- Cover of pile cap-50 mm.

PROPOSED PLAN I
OF B-G-H-V STORED RESIDENTIAL BUILDING
AT HOLDING NO-52, KHETRA MITRA LANE SAIKIA,
P.S & MOUZA-GOLABAKILR, DAG NO-370,371,372,
L.R.K.H.NO-32,88,218,279,391,404,682, J.L. NO-T, SHEET NO-20,
WARD NO-II, BOROUGH-II, DIST - HOWRAH, UNDER H.M.C.
PIN - 711106.

STRUCTURAL DETAIL
 SHEET NO.-5 OF 7
 ALL DIMENSIONS ARE IN M.M.
 SCALE = 1:10, 25, 50, 100, 100 & 10000

Subrata Kumar
 SUBRATA KUMAR
 I.B.S. of Govt. Engineering College
 Class - I, No. - 7/8
 SIGN OF STR. ENG.

Subrata Kumar
 Subrata Kumar Chattopadhyay
 37, Lakshmi Das Lane, How-1
 License No. BSE 01 06
 SIGN OF STR. ENG.

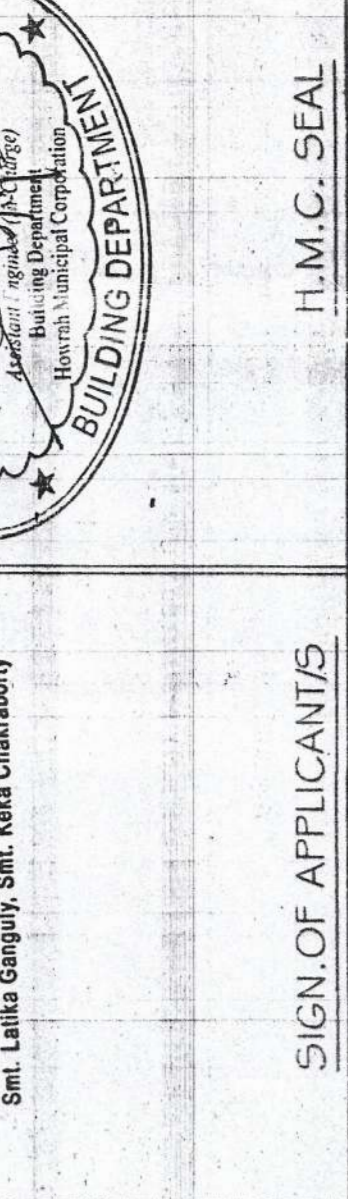

CONSTITUTED LEGAL ATTORNEY
 Subrata Kumar Chattopadhyay
 37, Lakshmi Das Lane, How-1
 License No. BSE 01 06
 SIGN OF L. B. S. A. B. A.

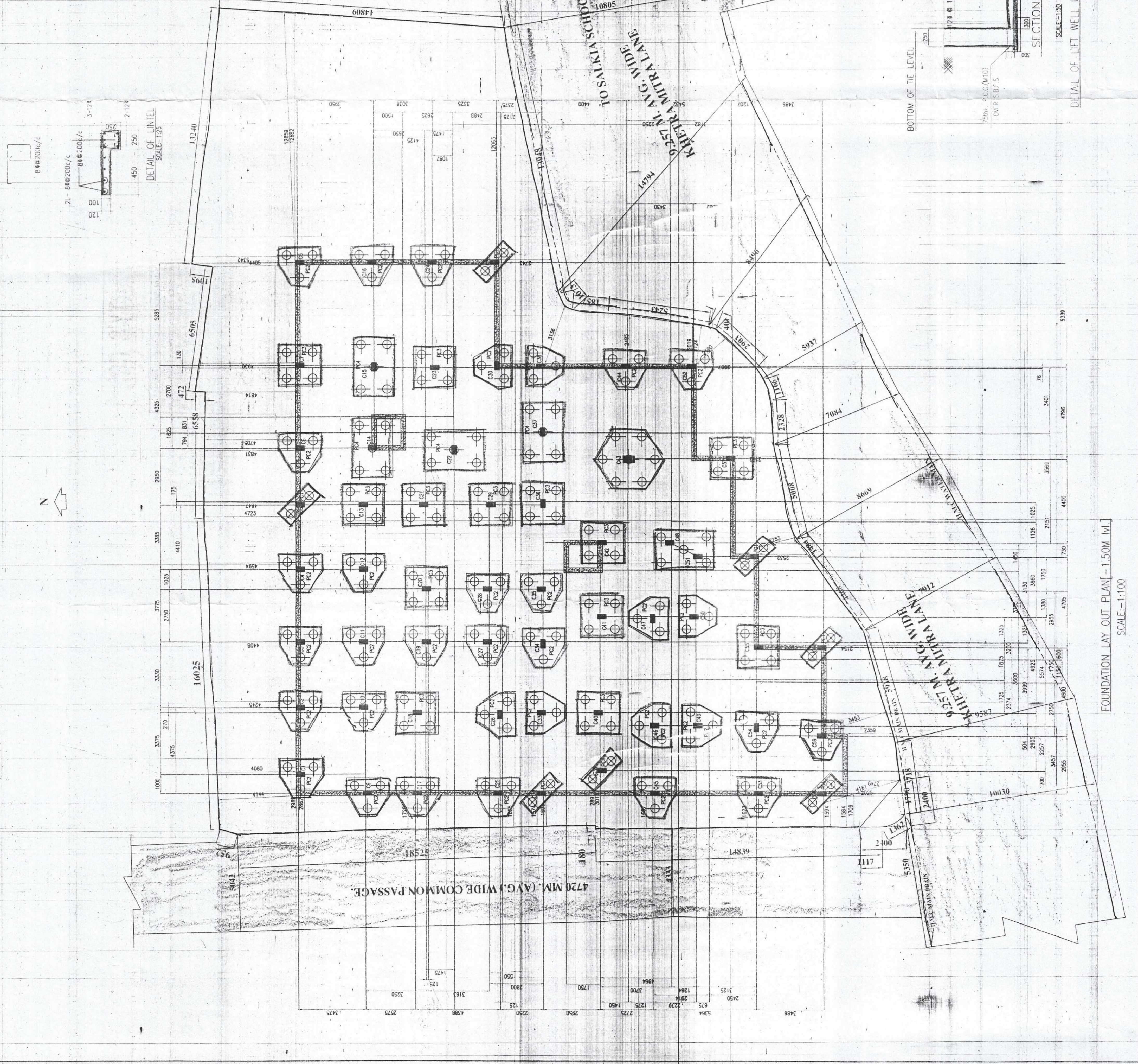
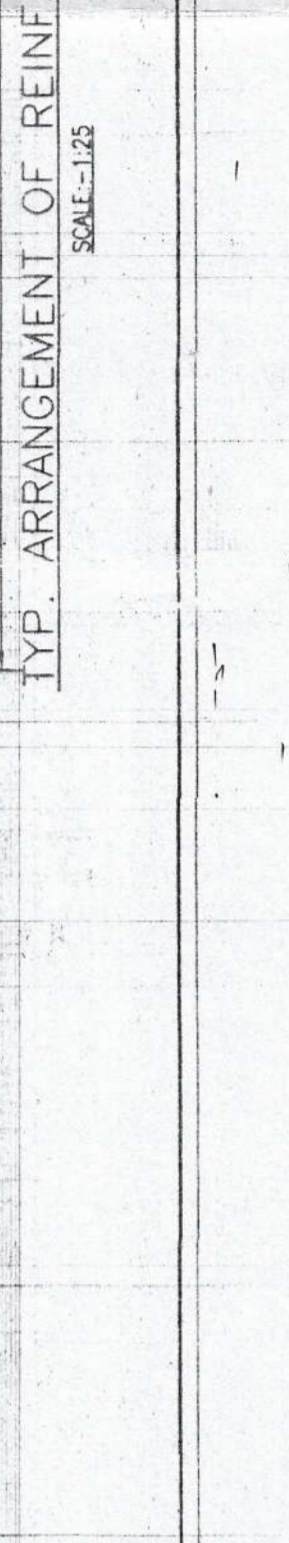
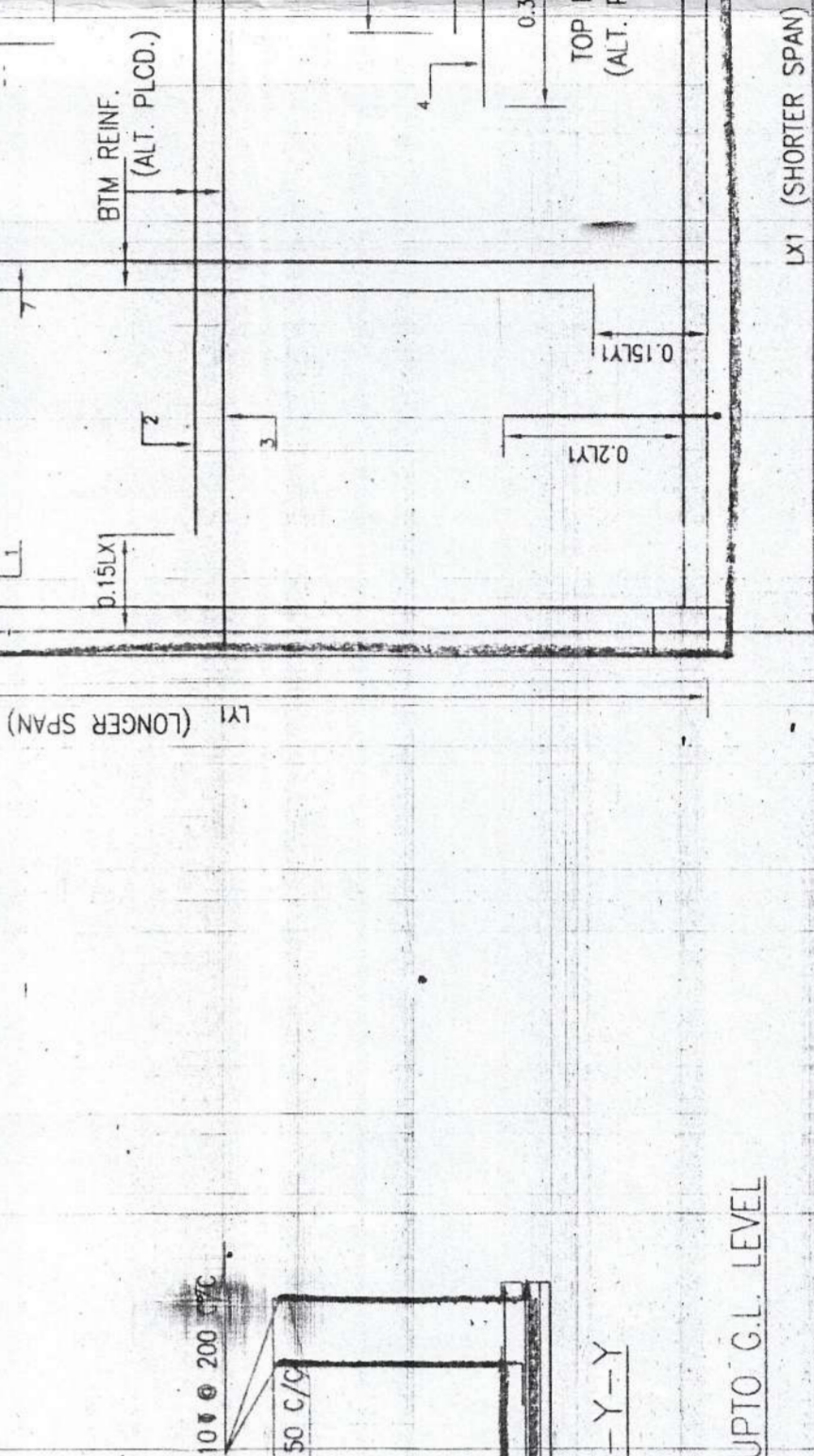
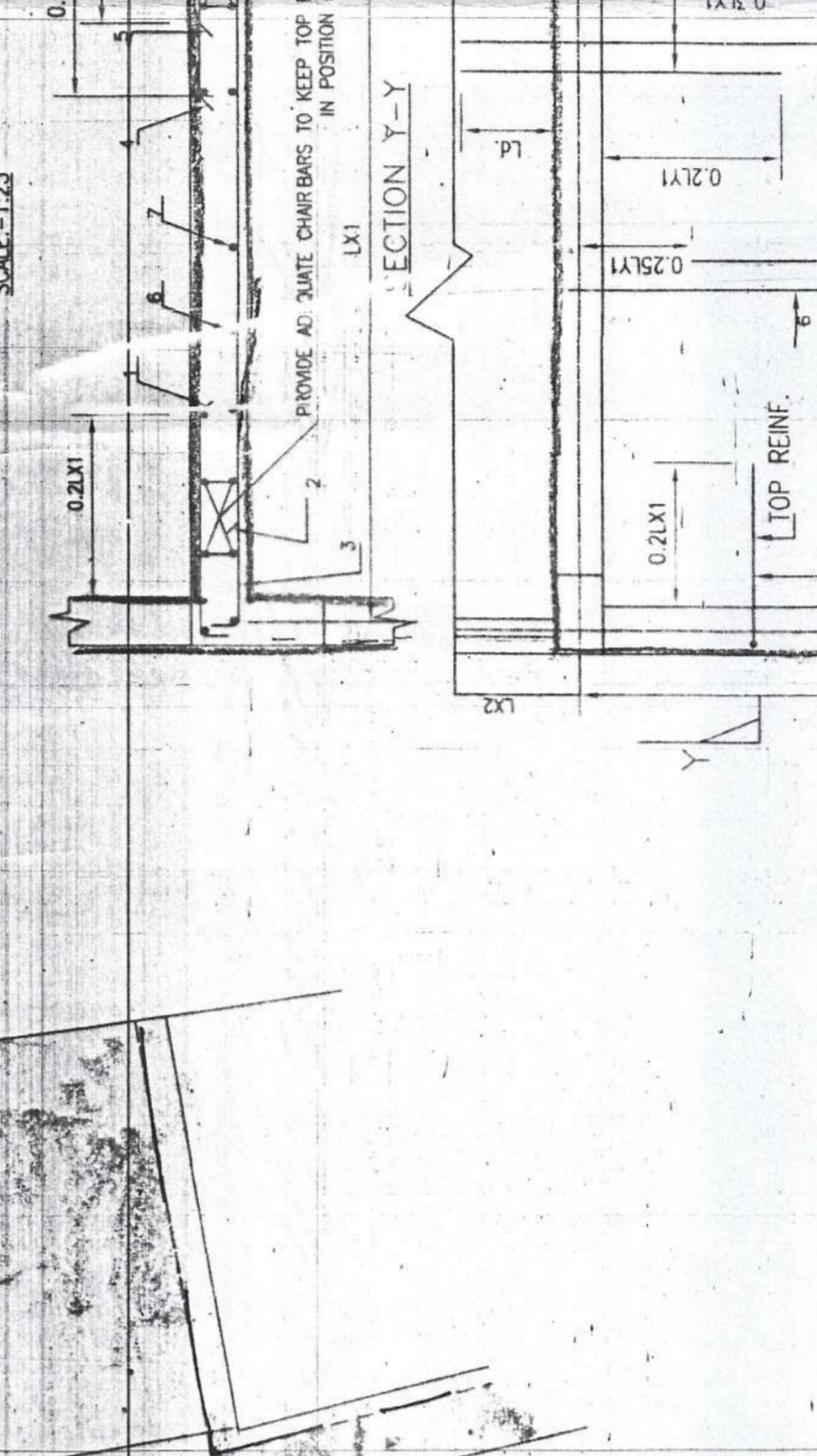
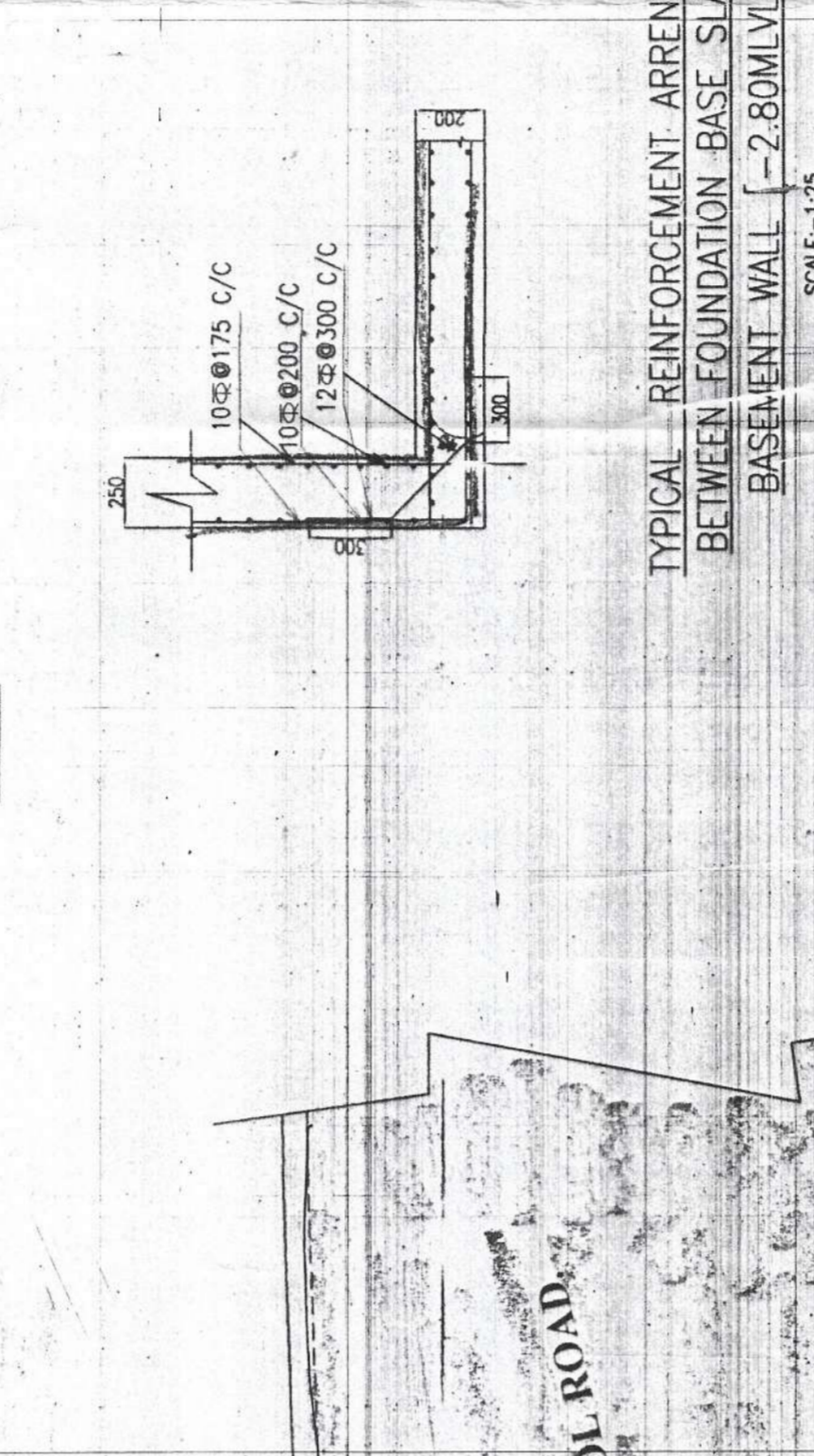
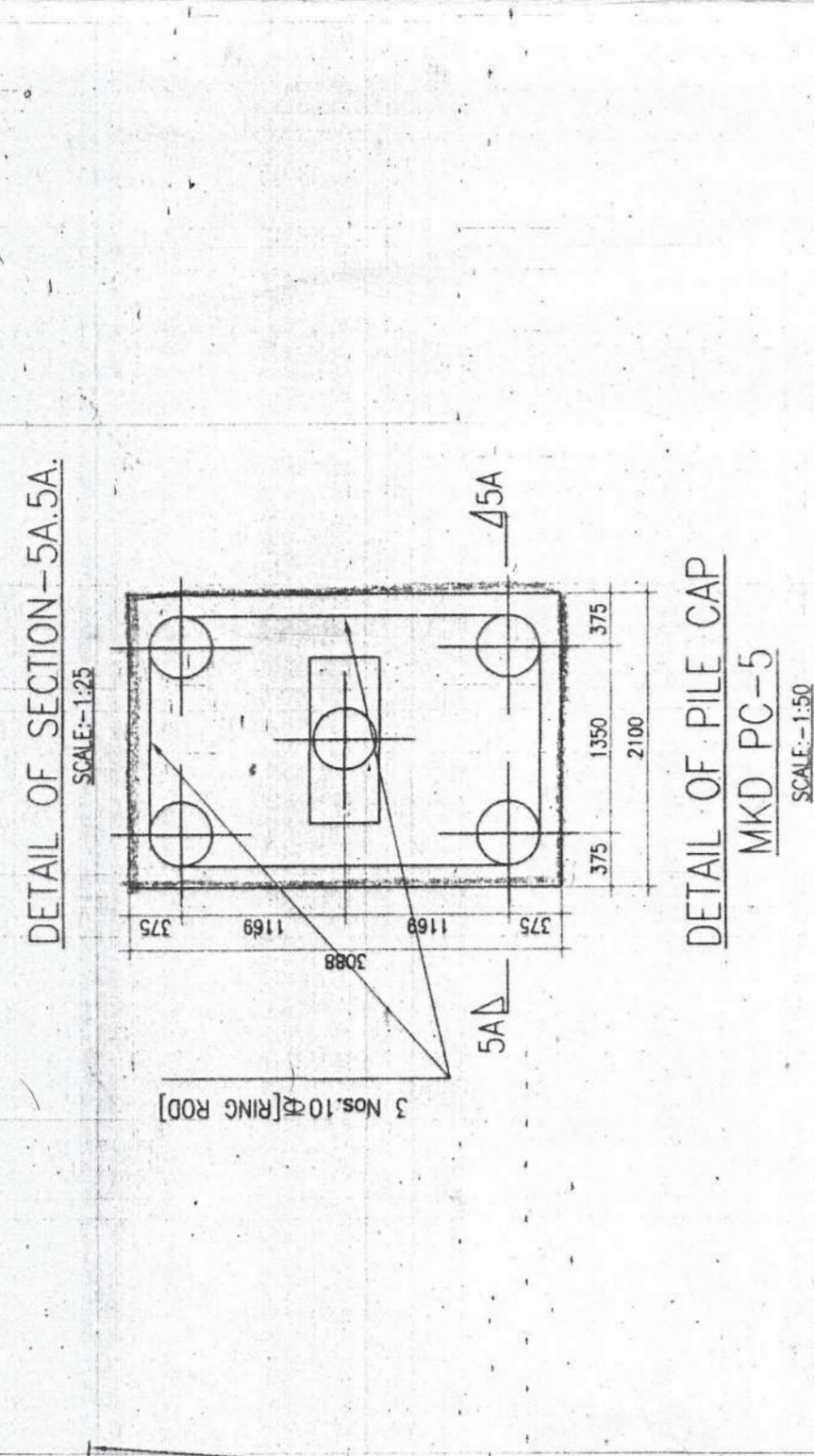
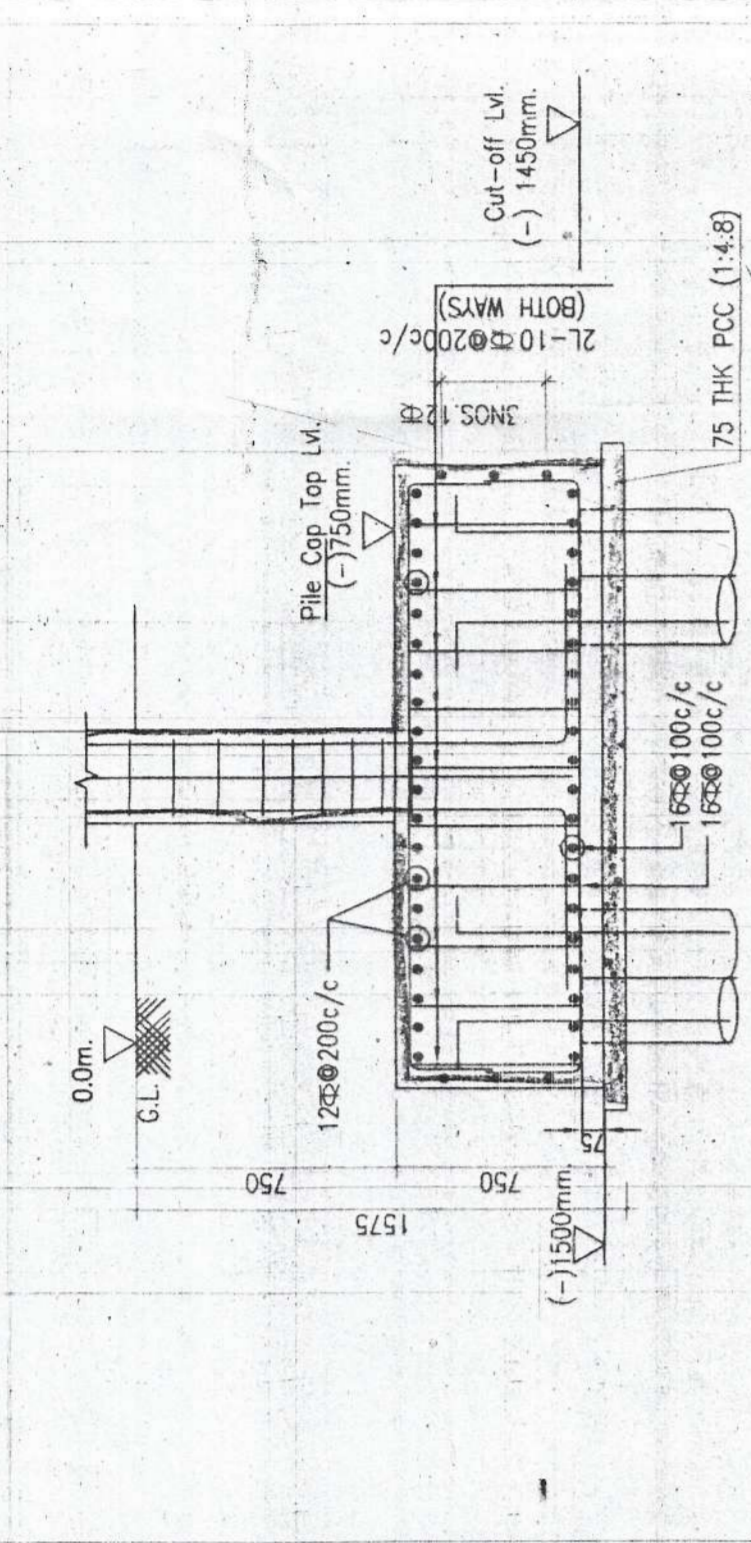

FOUNDATION LAY OUT PLAN - 1:500 (V.)
 SCALE = 1:100