

H TYPICAL FIRST TO FOURTH FLOOR PLAN
SCALE: 1:100

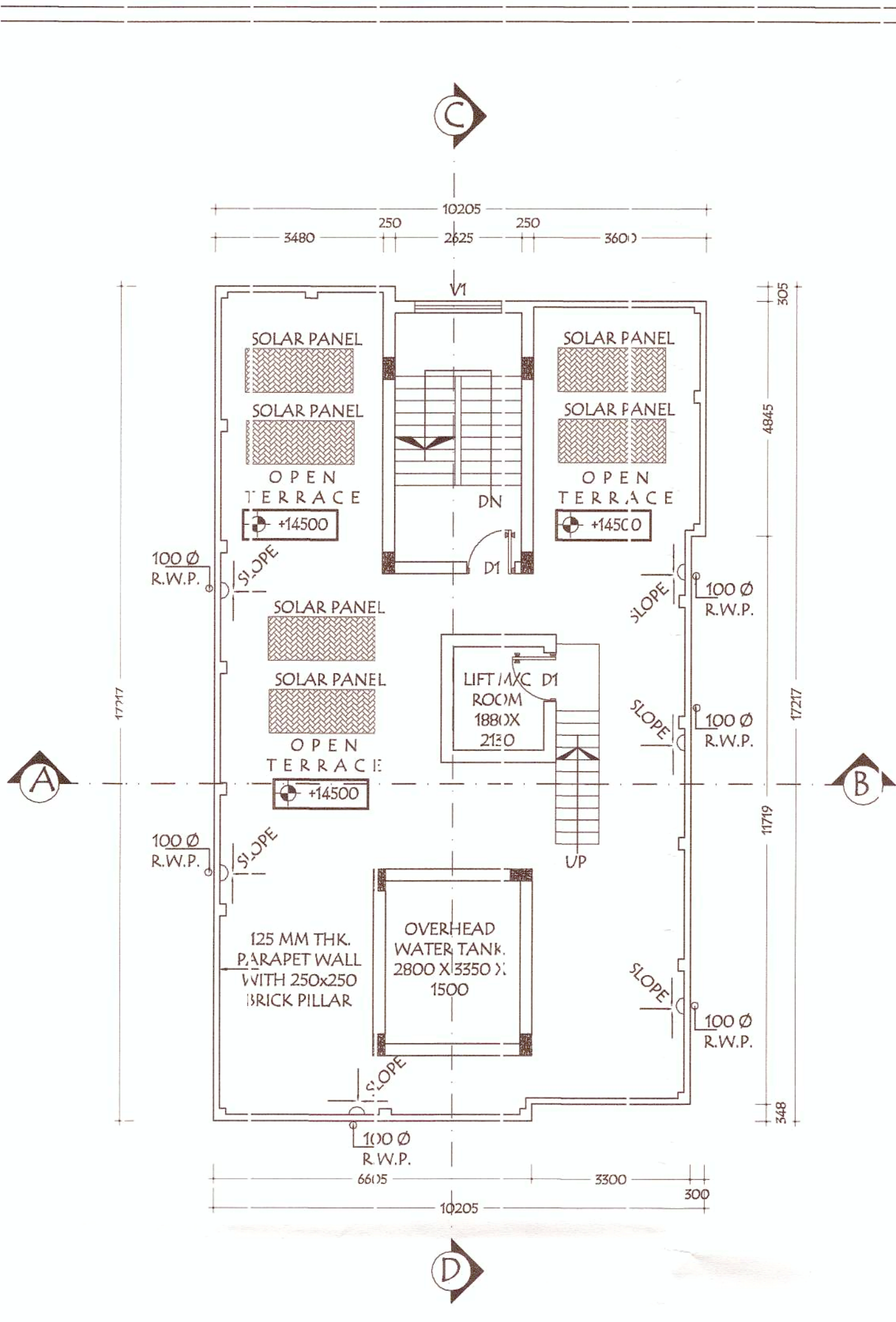

I ROOF PLAN
SCALE: 1:100

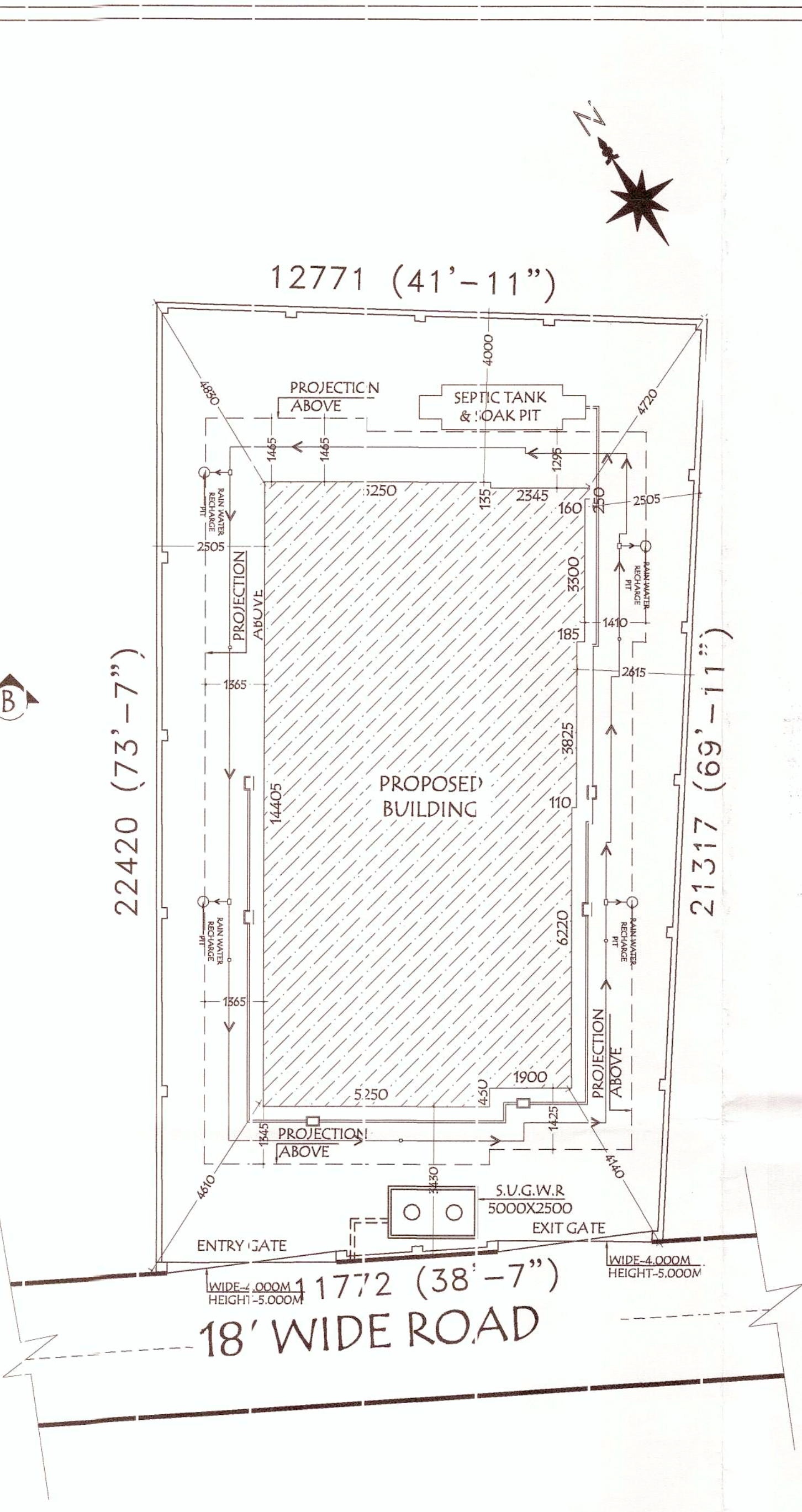

J SITE PLAN
SCALE: 1:100

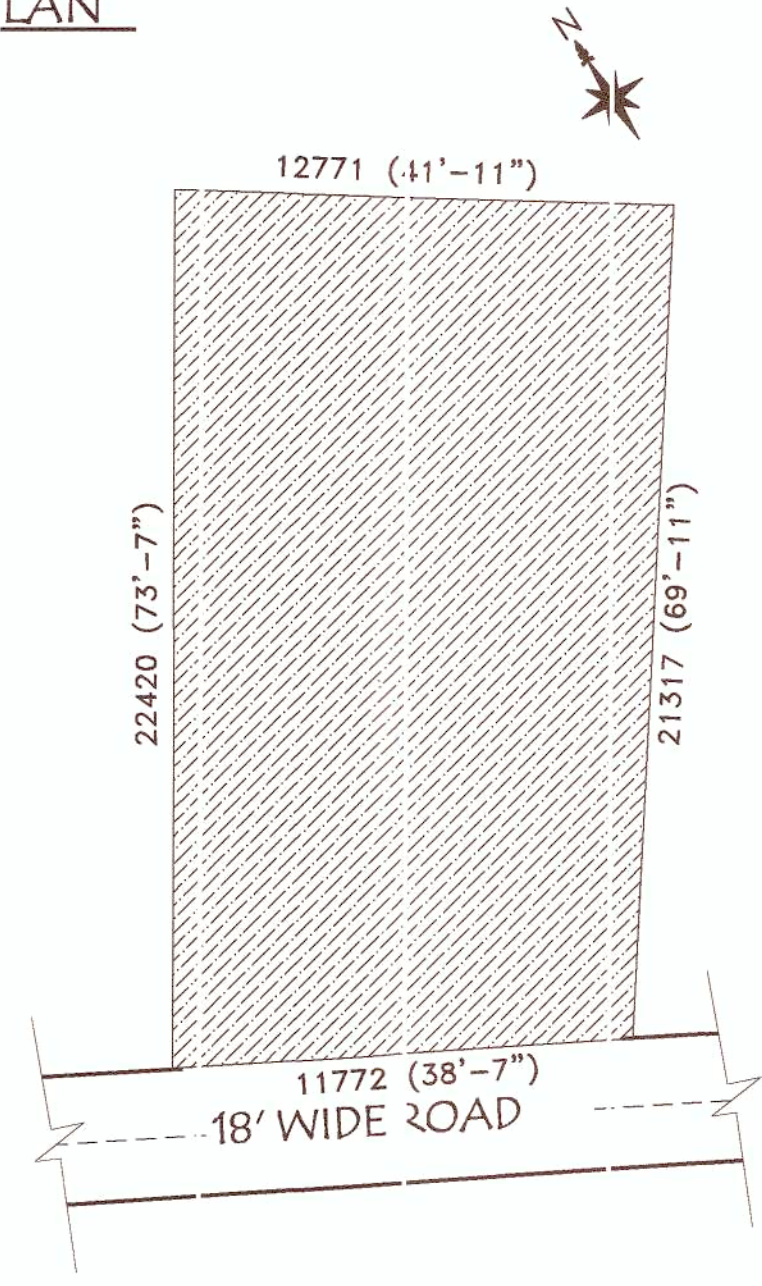

K LAYOUT PLAN
SCALE: 1:200

SCHEDULE OF DOOR & WINDOW:-

| MARK | SIZE | DESCRIPTION |
|------|-----------------------------|--------------------------|
| D1 | 100X2100 | FULLY PNL |
| D2 | 900X2100 | FULLY PNL |
| D3 | 750X2100 | FULLY PNL |
| W | 1800X1200 | SLIDING WINDOW |
| W1 | 1500X1200 | SLIDING WINDOW |
| V | 600X450 | L.PVC MOVABLE VENTILATOR |
| V1 | VENTILATION FOR STAIR CASE. | |
| C.G | COLLAPSIBLE GATE. | |

PROJECT NAME:-
 PLAN OF PROPOSED (G+3+1) FIVE STORIED RESIDENTIAL APARTMENT BUILDING OF MR. RAJIB CHAKRABORTY S/O MR. DEBA PRASAD CHAKRABORTY, MR. MANAS CHAKRABORTY S/O MR. DEBA PRASAD CHAKRABORTY, & MRS. MINA CHAKRABORTY W/O MR. DEBA PRASAD CHAKRABORTY, L.R PLOT NO.-61, KHATIAN NO.-2750,2751,2752, J.L NO.-074, MOUZA- FARIDPUR, P.S- FARIDPUR, DIST-PASCHIM BARDHAMAN, WARD NO.-21 HOLDING NO.-207

- NOTES :-**
- ALL DIMENSIONS ARE IN M.M. AND ALL LEVELS ARE IN M.
 - WRITE TEN DIMENSIONS MUST BE FOLLOWED
 - ALL EXTERNAL WALLS 24TH. & INTERNAL WALLS 125THK. UNLESS OTHERWISE MENTIONED
 - ALL MASONRY WORKS ARE BOUNDED BY CEMENT MORTAR (1:6) & (1:4).
 - EXTERNAL PLASTER IS 2" THK. & INTERNAL PLASTER IS 12MM THK.
 - ALL CONC. GRADE IS M20 & AND GRADE OF STEEL FE-500
 - 250T.HK. BRICK WORK IN 1:6 MORTAR
 - 125T.HK. & 75THK. BRICK WORK IN 1:4 MORTAR
 - 150 WIDE SURFACE DRAIN SHOULD BE PROVIDED ALL ROUND THE BUILDING.
 - 25% OF THE BUILDING TO BE CONSTRUCTED USING FLY-ASH BRICKS

AREA CALCULATION:-

| LAND AREA | PLINTH AREA | |
|---------------|--------------|---------------|
| | FLOOR | AREA |
| 267.78 S.Q.M. | GROUND FLOOR | 103.30 S.Q.M. |
| | FIRST FLOOR | 168.95 S.Q.M. |
| | SECOND FLOOR | 168.95 S.Q.M. |
| | THIRD FLOOR | 168.95 S.Q.M. |
| | FOURTH FLOOR | 168.95 S.Q.M. |
| | TOTAL | 779.10 S.Q.M. |

GROUND COVERAGE = 33.58 %
 F.A.R = 2.25
 NO OF FLAT = 08
 NO OF PARKING = 08

SIGNATURE OF STRUCTURAL ENGINEER:-
 Hirak Ghosh
 Hirak Ghosh
 Structural Engineer
 Lic No. - L.B.PM/183/AMC/DMC/DPD/185
 UCE, B.TECH, G.I.D.S., Durgapur-18
 Contact No. - 9332333331

VETTED BY:-
 Dr. S.N. Mukherjee
 Professor
 CIVIL ENGINEERING DEPT.
 JADAVPUR UNIVERSITY
 KOLKATA - 700032 (W.B)

TITLE:-
 TYPICAL FIRST TO FOURTH FLOOR PLAN, ROOF PLAN, SITE PLAN, LAYOUT PLAN.

CERTIFICATE & SIGNATURE OF ARCHITECT:-
 Hirak Ghosh
 Hirak Ghosh
 Consultant Civil Engineer
 Lic No. - L.B.PM/183/AMC/DMC/DPD/185
 G.I.D.S., Durgapur-18

CERTIFICATE OF GEO-TECHNICAL ENGINEER:-
 M. S. Ghosh
 M. S. Ghosh
 Geotechnical Engineer
 Lic No. - L.B.PM/183/AMC/DMC/DPD/185
 G.I.D.S., Durgapur-18

SIGNATURE OF DEVELOPER/OWNER
 Mina Chakraborty
 Manoj Chakraborty
 Rajib Chakraborty

GIDS Engineering Pvt.Ltd.
 (Architects, Engineers, Contractors and Business Solutions)
 E-mail Id: gidsbengal@gmail.com & gidsbengal.project@gmail.com
 SPECIALIST IN CONSULTING STRUCTURAL DESIGN, SURVEYING & SOIL INVESTIGATING
 OFFICE: C-29, 4th street, Doctor's Colony, City Centre Durgapur - 713216
 Contact No. - 91933323331, 91719999140

CHECKED BY : P. DAS
DATE : 25.06.2020
SCALE : 1:100, N.T.S.
SHEET NO.: GIDS/AR/CH/D.M.C/03-03