

...E PLAN AT HOLDING NO. 58/3 BHATTACHARJEE PARA LANE,  
 JAG. NO.-190,231 (L.R.) KN.NO. - 520,521,522 (L.R.) J.L NO.-01,  
 MOUZA +P.S.- SHIBPUR, DIST- HOWRAH, WARD NO.-44,  
 BOROUGH NO.- VI, PIN - 711104.

Project Name:- Bhattacharya Kuni

NAME OF OWNER :- SMT. ANAMIKA DAS BHATTACHARJEE  
 SMT. SUMITRA BHATTACHARJEE  
 SRI. AVIK BHATTACHARJEE

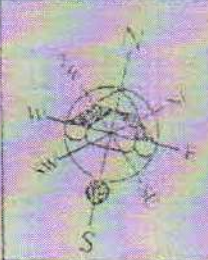

SCALE - 1:400

AREA OF LAND 21K.-14CH.-36 SQ.FT. SHOWN IN RED BORDER.

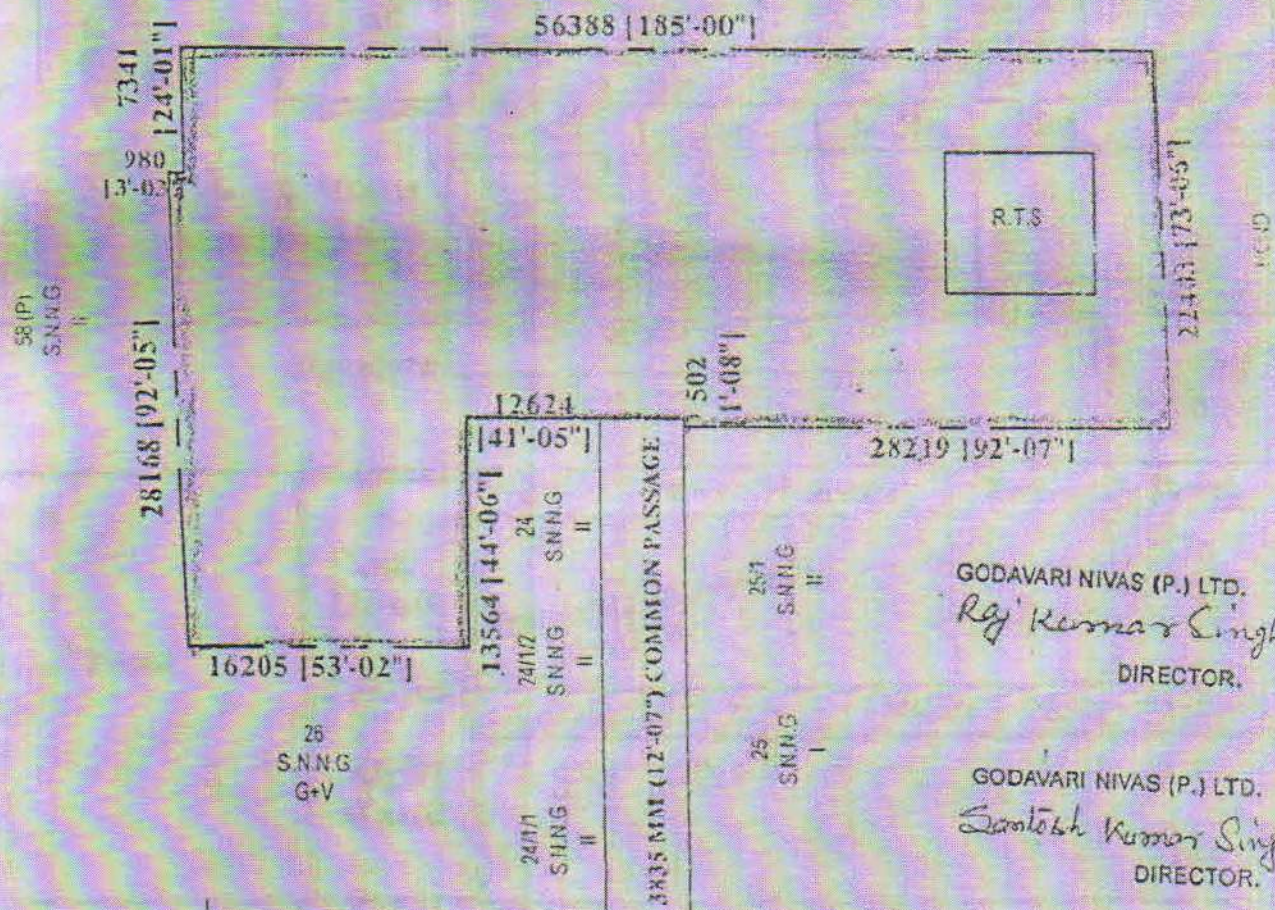
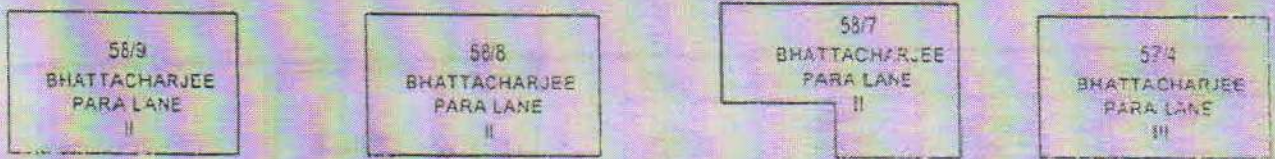

GODAVARI NIVAS (P.) LTD.  
*Raj Kumar Singh*  
 DIRECTOR.

GODAVARI NIVAS (P.) LTD.  
*Santosh Kumar Singh*  
 DIRECTOR.

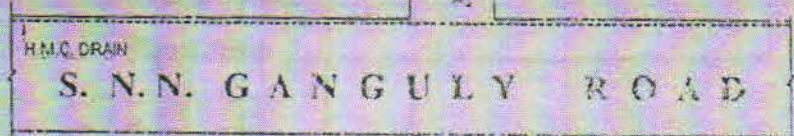

Latitude-22.584545  
 Longitude-88.299545

GODAVARI NIVAS PVT. LTD.  
*Santosh Kumar Singh*  
 Director

DRAWN BY  
 NANDITA PRAMANIC  
 19.02.2018