

4TH FLOOR PLAN
SCALE = 1:100

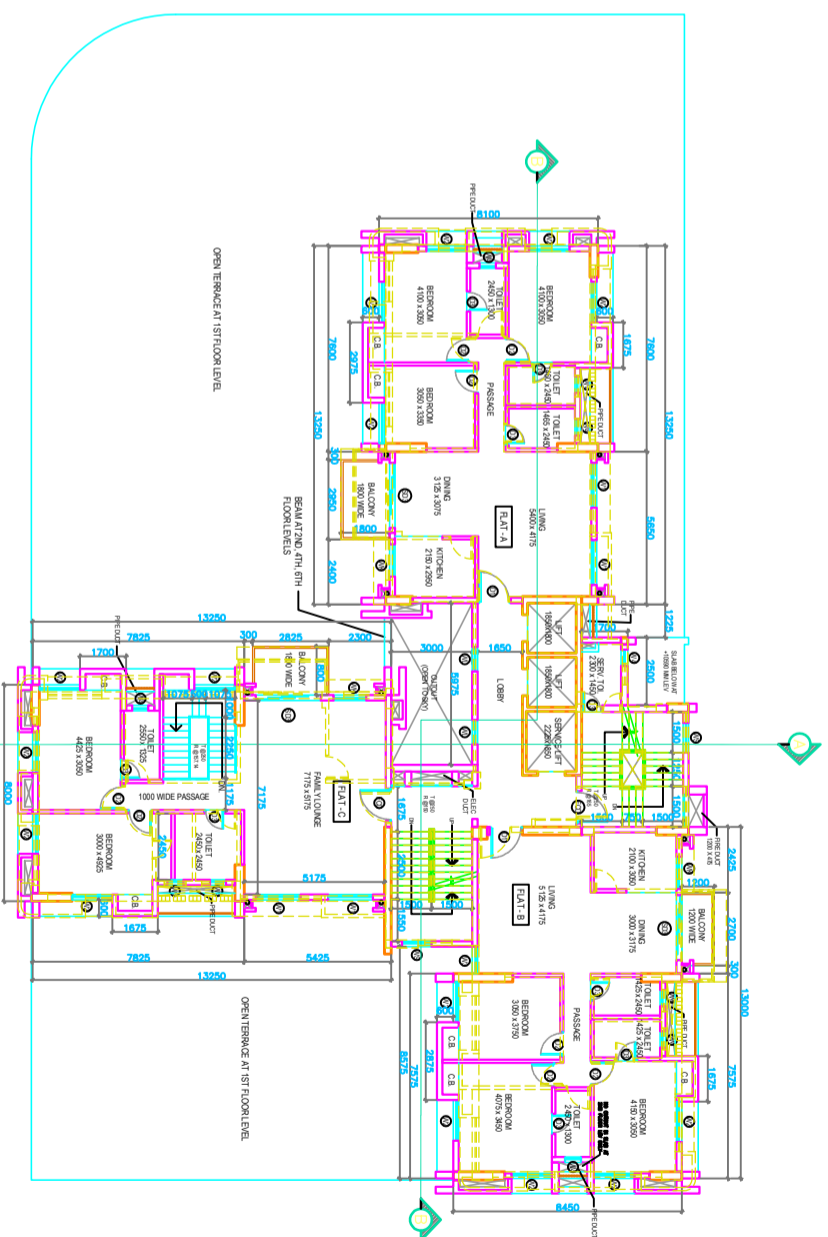

5TH FLOOR PLAN
SCALE = 1:100

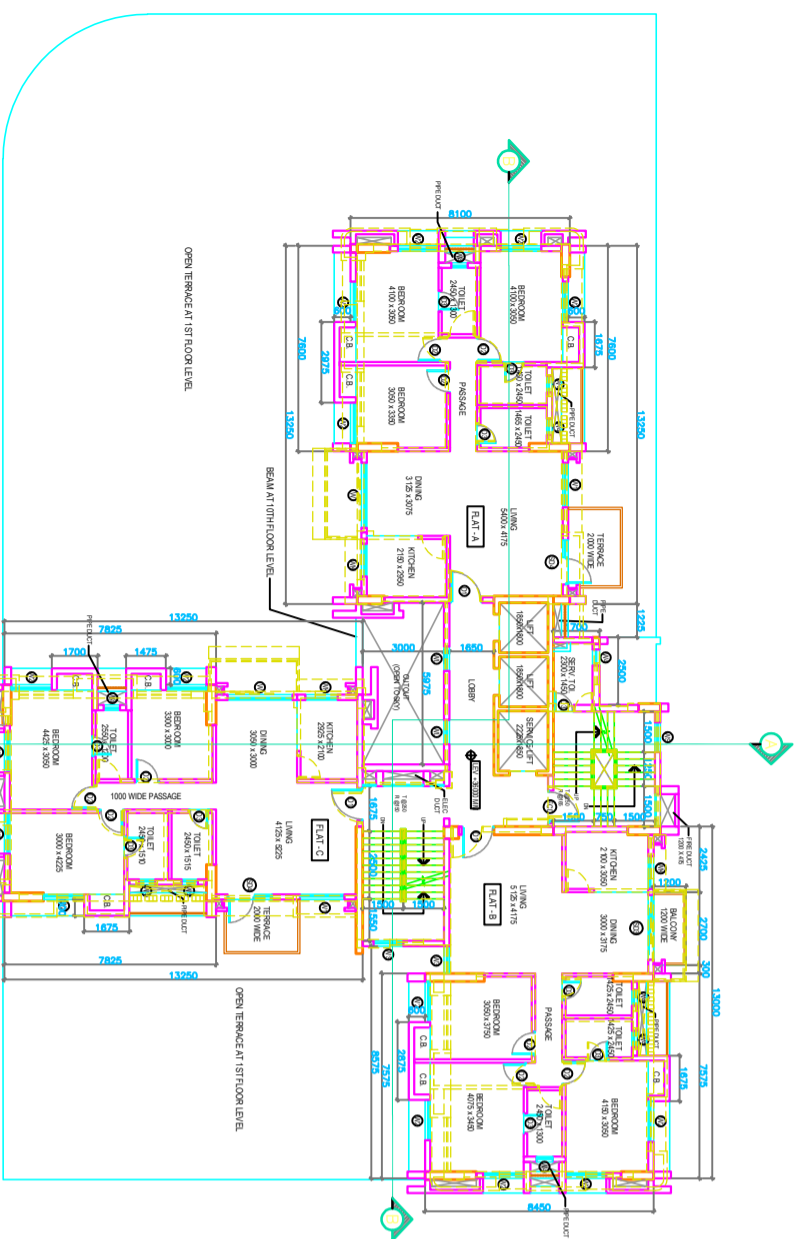

10TH FLOOR PLAN
SCALE = 1:100

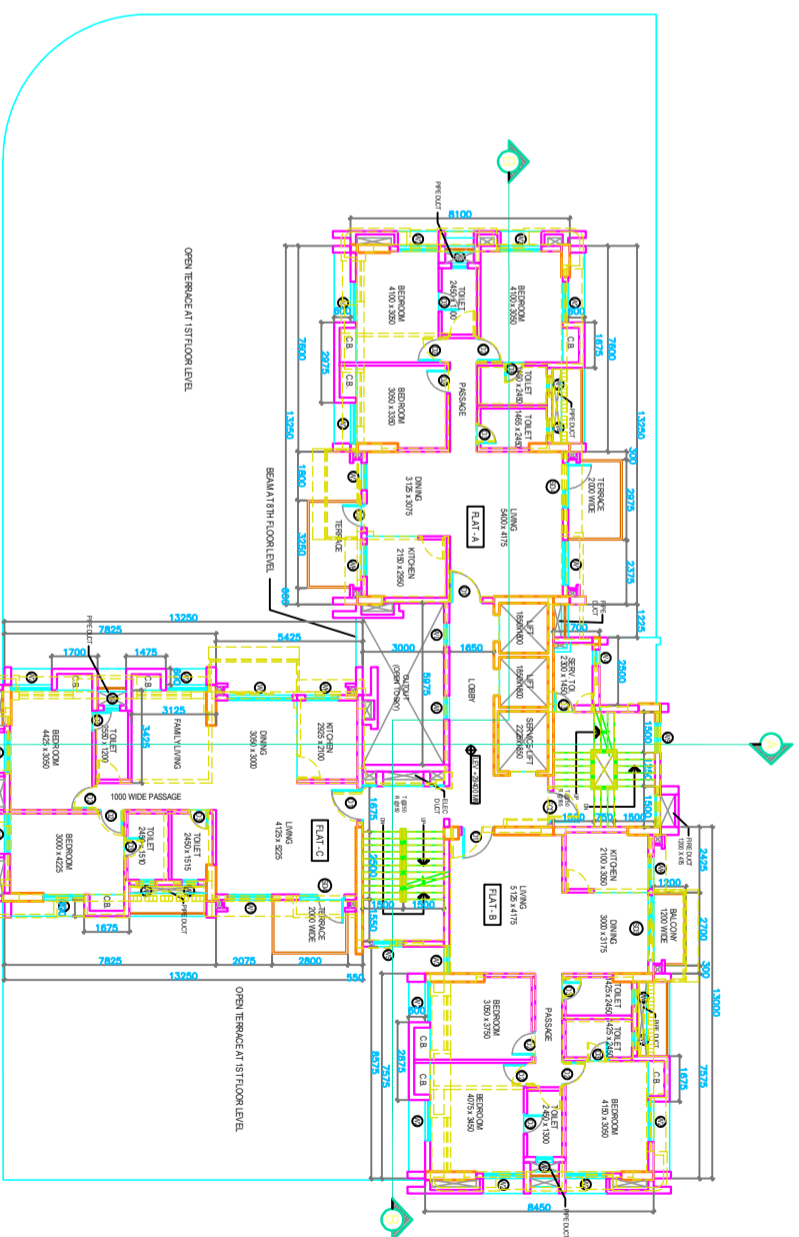

11TH FLOOR PLAN
SCALE = 1:100

NOTES:-

1. ALL DIMENSIONS ARE IN MM, UNLESS OTHERWISE MENTIONED.
2. ALL DIMENSIONS ARE TO FACE UNLESS OTHERWISE MENTIONED.
3. GENERAL FINISH WORK IS TO BE AS PER SPECIFICATION.
4. DEPTH OF UNDERGROUND WATER RESERVOIR SHOULD NOT EXCEED THE DEPTH OF FOUNDATION.
5. FINISHES RESPECTIVELY TO BE USED AS PER MDP & R.C.C. FINISH SPECIFICATION.
6. FINISHES TO BE USED AS PER MDP & R.C.C. FINISH SPECIFICATION.
7. GOVERNMENT APPROVAL IS TO BE OBTAINED FOR ALL WORKS.
8. FOR SPECIFICATION OF MATERIALS & WORKMANSHIP, N.B.C. IS TO BE REFERRED TO.
9. OPEN TERRACE WITH LIME TERRACING OF RATIO 2:27.
10. DAMP PROOF COURSE TO BE PROVIDED WITH P.C.C. (1:2:4).

SCHEDULE OF DOORS AND WINDOWS

NO.	TYPE	WIDTH	HEIGHT	DESCRIPTION
1	W	1000	1800	WOODEN WINDOW
2	W	1000	1800	WOODEN WINDOW
3	W	1000	1800	WOODEN WINDOW
4	W	1000	1800	WOODEN WINDOW
5	W	1000	1800	WOODEN WINDOW
6	W	1000	1800	WOODEN WINDOW
7	W	1000	1800	WOODEN WINDOW
8	W	1000	1800	WOODEN WINDOW
9	W	1000	1800	WOODEN WINDOW
10	W	1000	1800	WOODEN WINDOW
11	W	1000	1800	WOODEN WINDOW
12	W	1000	1800	WOODEN WINDOW
13	W	1000	1800	WOODEN WINDOW
14	W	1000	1800	WOODEN WINDOW
15	W	1000	1800	WOODEN WINDOW
16	W	1000	1800	WOODEN WINDOW
17	W	1000	1800	WOODEN WINDOW
18	W	1000	1800	WOODEN WINDOW
19	W	1000	1800	WOODEN WINDOW
20	W	1000	1800	WOODEN WINDOW
21	W	1000	1800	WOODEN WINDOW
22	W	1000	1800	WOODEN WINDOW
23	W	1000	1800	WOODEN WINDOW
24	W	1000	1800	WOODEN WINDOW
25	W	1000	1800	WOODEN WINDOW
26	W	1000	1800	WOODEN WINDOW
27	W	1000	1800	WOODEN WINDOW
28	W	1000	1800	WOODEN WINDOW
29	W	1000	1800	WOODEN WINDOW
30	W	1000	1800	WOODEN WINDOW
31	W	1000	1800	WOODEN WINDOW
32	W	1000	1800	WOODEN WINDOW
33	W	1000	1800	WOODEN WINDOW
34	W	1000	1800	WOODEN WINDOW
35	W	1000	1800	WOODEN WINDOW
36	W	1000	1800	WOODEN WINDOW
37	W	1000	1800	WOODEN WINDOW
38	W	1000	1800	WOODEN WINDOW
39	W	1000	1800	WOODEN WINDOW
40	W	1000	1800	WOODEN WINDOW
41	W	1000	1800	WOODEN WINDOW
42	W	1000	1800	WOODEN WINDOW
43	W	1000	1800	WOODEN WINDOW
44	W	1000	1800	WOODEN WINDOW
45	W	1000	1800	WOODEN WINDOW
46	W	1000	1800	WOODEN WINDOW
47	W	1000	1800	WOODEN WINDOW
48	W	1000	1800	WOODEN WINDOW
49	W	1000	1800	WOODEN WINDOW
50	W	1000	1800	WOODEN WINDOW
51	W	1000	1800	WOODEN WINDOW
52	W	1000	1800	WOODEN WINDOW
53	W	1000	1800	WOODEN WINDOW
54	W	1000	1800	WOODEN WINDOW
55	W	1000	1800	WOODEN WINDOW
56	W	1000	1800	WOODEN WINDOW
57	W	1000	1800	WOODEN WINDOW
58	W	1000	1800	WOODEN WINDOW
59	W	1000	1800	WOODEN WINDOW
60	W	1000	1800	WOODEN WINDOW
61	W	1000	1800	WOODEN WINDOW
62	W	1000	1800	WOODEN WINDOW
63	W	1000	1800	WOODEN WINDOW
64	W	1000	1800	WOODEN WINDOW
65	W	1000	1800	WOODEN WINDOW
66	W	1000	1800	WOODEN WINDOW
67	W	1000	1800	WOODEN WINDOW
68	W	1000	1800	WOODEN WINDOW
69	W	1000	1800	WOODEN WINDOW
70	W	1000	1800	WOODEN WINDOW
71	W	1000	1800	WOODEN WINDOW
72	W	1000	1800	WOODEN WINDOW
73	W	1000	1800	WOODEN WINDOW
74	W	1000	1800	WOODEN WINDOW
75	W	1000	1800	WOODEN WINDOW
76	W	1000	1800	WOODEN WINDOW
77	W	1000	1800	WOODEN WINDOW
78	W	1000	1800	WOODEN WINDOW
79	W	1000	1800	WOODEN WINDOW
80	W	1000	1800	WOODEN WINDOW
81	W	1000	1800	WOODEN WINDOW
82	W	1000	1800	WOODEN WINDOW
83	W	1000	1800	WOODEN WINDOW
84	W	1000	1800	WOODEN WINDOW
85	W	1000	1800	WOODEN WINDOW
86	W	1000	1800	WOODEN WINDOW
87	W	1000	1800	WOODEN WINDOW
88	W	1000	1800	WOODEN WINDOW
89	W	1000	1800	WOODEN WINDOW
90	W	1000	1800	WOODEN WINDOW
91	W	1000	1800	WOODEN WINDOW
92	W	1000	1800	WOODEN WINDOW
93	W	1000	1800	WOODEN WINDOW
94	W	1000	1800	WOODEN WINDOW
95	W	1000	1800	WOODEN WINDOW
96	W	1000	1800	WOODEN WINDOW
97	W	1000	1800	WOODEN WINDOW
98	W	1000	1800	WOODEN WINDOW
99	W	1000	1800	WOODEN WINDOW
100	W	1000	1800	WOODEN WINDOW

WE DO HEREBY UNDERTAKE WITH FULL RESPONSIBILITY THAT WE ENGAGED ARCHITECT AND E.S.E. AND FOLLOWED THEM PER B.S. PLAN, THE K.M.C. AUTHORITY WILL NOT BE RESPONSIBLE FOR STRUCTURAL STABILITY OF THE BUILDING AND ADJOINING STRUCTURES, IF ANY SUBMITTED WILL REMOVE THE SANCTION PLAN.

SIGNATURE OF OWNER

DECLARATION OF STRUCTURAL ENGINEER:
I DO HEREBY CERTIFY THAT THE ERECTION OF B.G.M.II STORED BUILDING ON PREMISES NO. 130, N.S.C. BOSE ROAD, SUPERVISED BY ME AND HAS BEEN COMPLETED ACCORDING TO THE B.S. PLAN NO. - 178, DATED - 18.08.2010 AND REVISED FROM 18.08.19 (P.T.O) 17.08.2010 BY D.G.(B.D.O.) ON DATED 02.03.16, WITH SOME CHANGES.

THE WORK IS GOING ON TO THE BEST OF MY SATISFACTION, THE WORKMANSHIP AND ALL THE MATERIALS QUALITY AND GENERAL AND DETAILED SPECIFICATION, NO PROVISION OF K.M.C. BLDG. RULES 2009 HAS BEEN VIOLATED IN COURSE OF THE WORK. THE STRUCTURE IS SAFE AND STABLE IN ALL RESPECTS.

SIGNATURE OF ARCHITECT

DECLARATION OF ARCHITECT:
I DO HEREBY CERTIFY WITH FULL RESPONSIBILITY THAT THE SANCTIONED PLAN NO. - 178, DATED - 18.08.2010 AND REVISED FROM 18.08.19 (P.T.O) 17.08.2010 BY D.G.(B.D.O.) ON DATED 02.03.16, WITH SOME CHANGES.

THE WORK IS GOING ON IN ACCORDANCE WITH THE BEST OF MY SATISFACTION, THE WORKMANSHIP AND ALL THE MATERIALS QUALITY AND DETAILED SPECIFICATION, NO PROVISION OF K.M.C. BLDG. RULES 2009 HAS BEEN VIOLATED IN COURSE OF THE WORK.

SIGNATURE OF ARCHITECT

PROJECT:
REGULARIZATION PLAN U/R - 2664-21b) OF B.G.M.II STORED RESIDENTIAL BUILDING OF PREMISES NO. 130, N.S.C. BOSE ROAD, KOLKATA-700040, WARD NO. - 95, BOROUGH NO. - X, UNDER K.M.C.

SANCTIONED PLAN VIDE NO. - 178, DATED - 18-08-2010 AND REVISED FROM 18.08.19 (P.T.O) 17.08.2010 BY D.G.(B.D.O.) ON DATED 02.03.16

ARCHITECT
MAHESWARI & ASSOCIATES
37A, BAKER ROAD, 2ND FLOOR,
KOLKATA - 700027
TEL: 65535669, WWW.MAHESWARI.COM

SCALE: 1:100
DATE: 01-11-2017