

PROPOSED FIVE STORIED RESIDENTIAL BUILDING PLAN OF SRI ASHIM MITRA & ANOTHER, AT MOUZA- SATGACHI IN C.S. DAG NO. 53,55 C.S. KHATIAN NO. 834, IN RESPECT OF MUNICIPAL HOLDING NO. 20, R.N. GUHA ROAD, J.L. NO. 20, WARD NO. 09, UNDER SOUTH DUM DUM MUNICIPALITY, P.S. DUM DUM, DIST. NORTH 24 PARGANAS

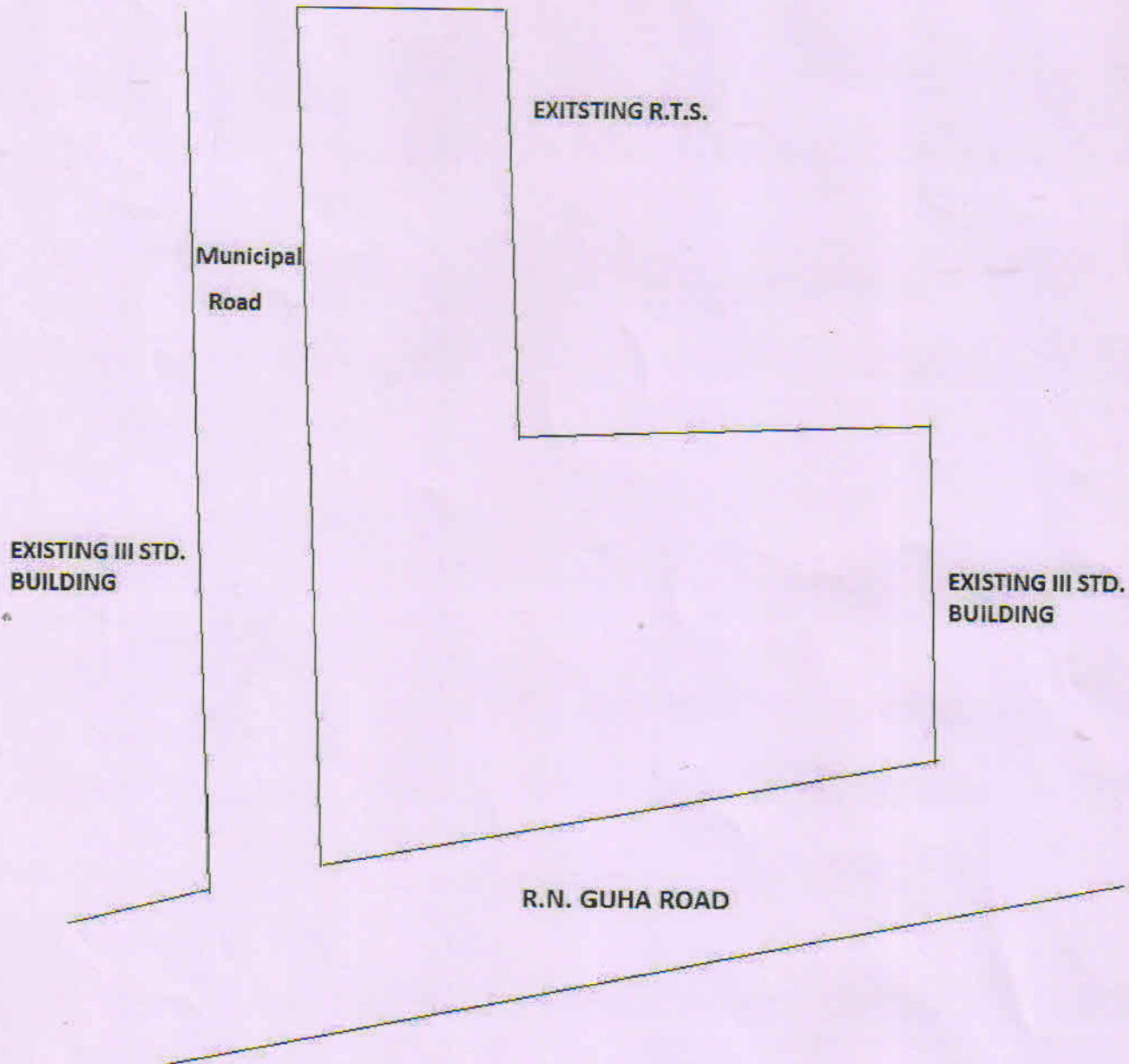

LATITUDE : 22.624062
LONGITUDE : 88.413093

MITRA BUILDERS
Ashim Mitra
SIGNATURE OF OWNER