

E X T E N D E D  
C A N A L  
E M B Y P A S S

GROUND FLOOR PLAN  
SCALE: 1/8"=1'-0"

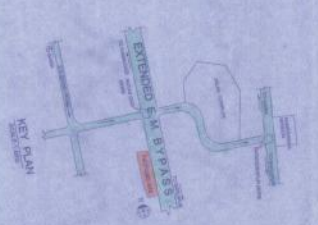

| AREA |             | AREA |             | AREA |             | AREA |             | AREA |             | AREA |             | AREA |             | AREA |             | AREA |             | AREA |             |
|------|-------------|------|-------------|------|-------------|------|-------------|------|-------------|------|-------------|------|-------------|------|-------------|------|-------------|------|-------------|
| NO.  | DESCRIPTION | NO.  | DESCRIPTION | NO.  | DESCRIPTION | NO.  | DESCRIPTION | NO.  | DESCRIPTION | NO.  | DESCRIPTION | NO.  | DESCRIPTION | NO.  | DESCRIPTION | NO.  | DESCRIPTION | NO.  | DESCRIPTION |
| 1    | ...         | 2    | ...         | 3    | ...         | 4    | ...         | 5    | ...         | 6    | ...         | 7    | ...         | 8    | ...         | 9    | ...         | 10   | ...         |

| GENERAL INFORMATION |             | GENERAL INFORMATION |             | GENERAL INFORMATION |             | GENERAL INFORMATION |             | GENERAL INFORMATION |             | GENERAL INFORMATION |             | GENERAL INFORMATION |             | GENERAL INFORMATION |             | GENERAL INFORMATION |             | GENERAL INFORMATION |             |
|---------------------|-------------|---------------------|-------------|---------------------|-------------|---------------------|-------------|---------------------|-------------|---------------------|-------------|---------------------|-------------|---------------------|-------------|---------------------|-------------|---------------------|-------------|
| NO.                 | DESCRIPTION | NO.                 | DESCRIPTION | NO.                 | DESCRIPTION | NO.                 | DESCRIPTION | NO.                 | DESCRIPTION | NO.                 | DESCRIPTION | NO.                 | DESCRIPTION | NO.                 | DESCRIPTION | NO.                 | DESCRIPTION | NO.                 | DESCRIPTION |
| 1                   | ...         | 2                   | ...         | 3                   | ...         | 4                   | ...         | 5                   | ...         | 6                   | ...         | 7                   | ...         | 8                   | ...         | 9                   | ...         | 10                  | ...         |

**GENERAL INFORMATION OF BUILDING**

1. The building is a commercial building with a total area of approximately 10,000 sq. ft. It is located at the intersection of Main Street and Elm Street.

2. The building is a two-story structure with a flat roof. It is constructed of concrete and steel.

3. The building is currently vacant and is being prepared for renovation.

4. The building is being renovated to meet current building codes and standards.

5. The building is being renovated to provide modern office space and retail space.

6. The building is being renovated to provide a high-quality interior environment.

7. The building is being renovated to provide a safe and secure environment.

8. The building is being renovated to provide a sustainable environment.

9. The building is being renovated to provide a flexible environment.

10. The building is being renovated to provide a cost-effective environment.

**DECLARATION OF C.E.T.A.**

I, the undersigned, being a duly licensed Professional Engineer in the State of California, do hereby certify that the above described building and its contents are in compliance with the applicable building codes and standards of the State of California.

Signature: \_\_\_\_\_  
Date: \_\_\_\_\_

**DECLARATION OF STRUCTURAL CONSULTANT**

I, the undersigned, being a duly licensed Structural Engineer in the State of California, do hereby certify that the above described building and its contents are in compliance with the applicable building codes and standards of the State of California.

Signature: \_\_\_\_\_  
Date: \_\_\_\_\_

**APPROVED**

Signature: \_\_\_\_\_  
Date: \_\_\_\_\_

**CONSULTANTS**

Signature: \_\_\_\_\_  
Date: \_\_\_\_\_

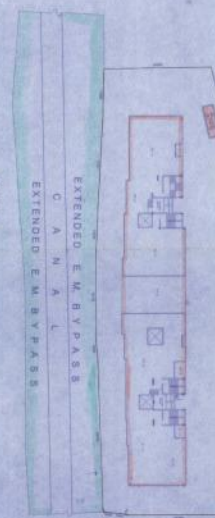

**PROPOSED PLAN OF THE Bldg. - X**

PROPOSED PLAN OF THE Bldg. - X  
BUILDING AT HIGHWAY 99, 100, 101, 102, 103, 104, 105, 106, 107, 108, 109, 110, 111, 112, 113, 114, 115, 116, 117, 118, 119, 120, 121, 122, 123, 124, 125, 126, 127, 128, 129, 130, 131, 132, 133, 134, 135, 136, 137, 138, 139, 140, 141, 142, 143, 144, 145, 146, 147, 148, 149, 150, 151, 152, 153, 154, 155, 156, 157, 158, 159, 160, 161, 162, 163, 164, 165, 166, 167, 168, 169, 170, 171, 172, 173, 174, 175, 176, 177, 178, 179, 180, 181, 182, 183, 184, 185, 186, 187, 188, 189, 190, 191, 192, 193, 194, 195, 196, 197, 198, 199, 200, 201, 202, 203, 204, 205, 206, 207, 208, 209, 210, 211, 212, 213, 214, 215, 216, 217, 218, 219, 220, 221, 222, 223, 224, 225, 226, 227, 228, 229, 230, 231, 232, 233, 234, 235, 236, 237, 238, 239, 240, 241, 242, 243, 244, 245, 246, 247, 248, 249, 250, 251, 252, 253, 254, 255, 256, 257, 258, 259, 260, 261, 262, 263, 264, 265, 266, 267, 268, 269, 270, 271, 272, 273, 274, 275, 276, 277, 278, 279, 280, 281, 282, 283, 284, 285, 286, 287, 288, 289, 290, 291, 292, 293, 294, 295, 296, 297, 298, 299, 300, 301, 302, 303, 304, 305, 306, 307, 308, 309, 310, 311, 312, 313, 314, 315, 316, 317, 318, 319, 320, 321, 322, 323, 324, 325, 326, 327, 328, 329, 330, 331, 332, 333, 334, 335, 336, 337, 338, 339, 340, 341, 342, 343, 344, 345, 346, 347, 348, 349, 350, 351, 352, 353, 354, 355, 356, 357, 358, 359, 360, 361, 362, 363, 364, 365, 366, 367, 368, 369, 370, 371, 372, 373, 374, 375, 376, 377, 378, 379, 380, 381, 382, 383, 384, 385, 386, 387, 388, 389, 390, 391, 392, 393, 394, 395, 396, 397, 398, 399, 400, 401, 402, 403, 404, 405, 406, 407, 408, 409, 410, 411, 412, 413, 414, 415, 416, 417, 418, 419, 420, 421, 422, 423, 424, 425, 426, 427, 428, 429, 430, 431, 432, 433, 434, 435, 436, 437, 438, 439, 440, 441, 442, 443, 444, 445, 446, 447, 448, 449, 450, 451, 452, 453, 454, 455, 456, 457, 458, 459, 460, 461, 462, 463, 464, 465, 466, 467, 468, 469, 470, 471, 472, 473, 474, 475, 476, 477, 478, 479, 480, 481, 482, 483, 484, 485, 486, 487, 488, 489, 490, 491, 492, 493, 494, 495, 496, 497, 498, 499, 500, 501, 502, 503, 504, 505, 506, 507, 508, 509, 510, 511, 512, 513, 514, 515, 516, 517, 518, 519, 520, 521, 522, 523, 524, 525, 526, 527, 528, 529, 530, 531, 532, 533, 534, 535, 536, 537, 538, 539, 540, 541, 542, 543, 544, 545, 546, 547, 548, 549, 550, 551, 552, 553, 554, 555, 556, 557, 558, 559, 560, 561, 562, 563, 564, 565, 566, 567, 568, 569, 570, 571, 572, 573, 574, 575, 576, 577, 578, 579, 580, 581, 582, 583, 584, 585, 586, 587, 588, 589, 590, 591, 592, 593, 594, 595, 596, 597, 598, 599, 600, 601, 602, 603, 604, 605, 606, 607, 608, 609, 610, 611, 612, 613, 614, 615, 616, 617, 618, 619, 620, 621, 622, 623, 624, 625, 626, 627, 628, 629, 630, 631, 632, 633, 634, 635, 636, 637, 638, 639, 640, 641, 642, 643, 644, 645, 646, 647, 648, 649, 650, 651, 652, 653, 654, 655, 656, 657, 658, 659, 660, 661, 662, 663, 664, 665, 666, 667, 668, 669, 670, 671, 672, 673, 674, 675, 676, 677, 678, 679, 680, 681, 682, 683, 684, 685, 686, 687, 688, 689, 690, 691, 692, 693, 694, 695, 696, 697, 698, 699, 700, 701, 702, 703, 704, 705, 706, 707, 708, 709, 710, 711, 712, 713, 714, 715, 716, 717, 718, 719, 720, 721, 722, 723, 724, 725, 726, 727, 728, 729, 730, 731, 732, 733, 734, 735, 736, 737, 738, 739, 740, 741, 742, 743, 744, 745, 746, 747, 748, 749, 750, 751, 752, 753, 754, 755, 756, 757, 758, 759, 760, 761, 762, 763, 764, 765, 766, 767, 768, 769, 770, 771, 772, 773, 774, 775, 776, 777, 778, 779, 780, 781, 782, 783, 784, 785, 786, 787, 788, 789, 790, 791, 792, 793, 794, 795, 796, 797, 798, 799, 800, 801, 802, 803, 804, 805, 806, 807, 808, 809, 810, 811, 812, 813, 814, 815, 816, 817, 818, 819, 820, 821, 822, 823, 824, 825, 826, 827, 828, 829, 830, 831, 832, 833, 834, 835, 836, 837, 838, 839, 840, 841, 842, 843, 844, 845, 846, 847, 848, 849, 850, 851, 852, 853, 854, 855, 856, 857, 858, 859, 860, 861, 862, 863, 864, 865, 866, 867, 868, 869, 870, 871, 872, 873, 874, 875, 876, 877, 878, 879, 880, 881, 882, 883, 884, 885, 886, 887, 888, 889, 890, 891, 892, 893, 894, 895, 896, 897, 898, 899, 900, 901, 902, 903, 904, 905, 906, 907, 908, 909, 910, 911, 912, 913, 914, 915, 916, 917, 918, 919, 920, 921, 922, 923, 924, 925, 926, 927, 928, 929, 930, 931, 932, 933, 934, 935, 936, 937, 938, 939, 940, 941, 942, 943, 944, 945, 946, 947, 948, 949, 950, 951, 952, 953, 954, 955, 956, 957, 958, 959, 960, 961, 962, 963, 964, 965, 966, 967, 968, 969, 970, 971, 972, 973, 974, 975, 976, 977, 978, 979, 980, 981, 982, 983, 984, 985, 986, 987, 988, 989, 990, 991, 992, 993, 994, 995, 996, 997, 998, 999, 1000.