

NOTES & SPECIFICATIONS

1. ALL DIMENSIONS ARE IN METERS UNLESS OTHERWISE SPECIFIED.
2. ALL WALLS ARE 200 MM THICK UNLESS OTHERWISE SPECIFIED.
3. ALL FLOORS ARE TO BE FINISHED WITH 100 MM CONCRETE SLAB ON BEAMS.
4. ROOF IS TO BE FINISHED WITH 100 MM CONCRETE SLAB ON BEAMS.
5. CEILING IS TO BE FINISHED WITH 100 MM CONCRETE SLAB ON BEAMS.
6. DOORS ARE TO BE FINISHED WITH 100 MM CONCRETE SLAB ON BEAMS.
7. WINDOWS ARE TO BE FINISHED WITH 100 MM CONCRETE SLAB ON BEAMS.
8. ALL WORK IS TO BE DONE IN ACCORDANCE WITH THE SPECIFICATIONS.
9. ALL WORK IS TO BE DONE IN ACCORDANCE WITH THE SPECIFICATIONS.
10. ALL WORK IS TO BE DONE IN ACCORDANCE WITH THE SPECIFICATIONS.

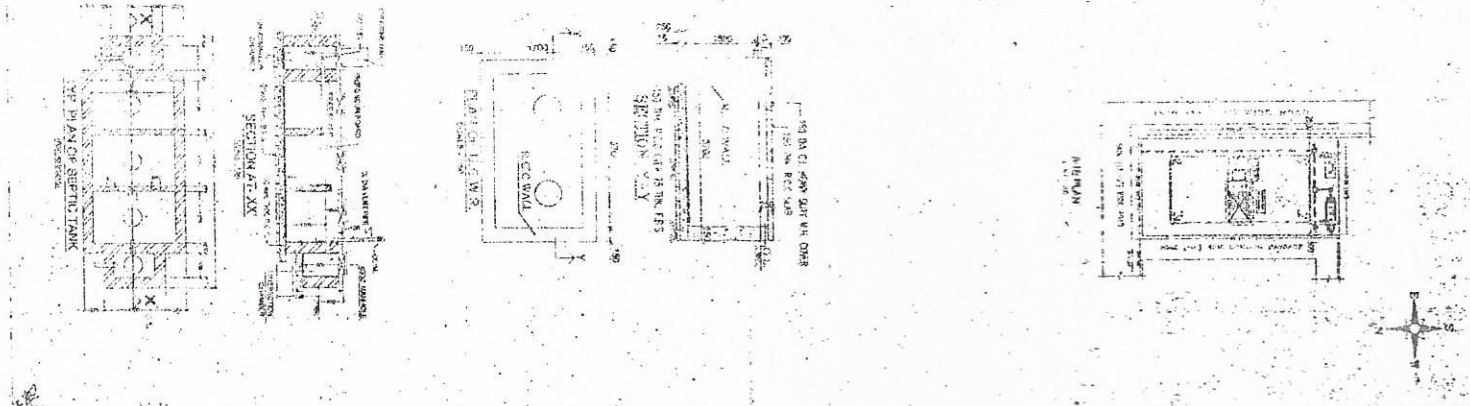

<p>PROPOSED UNIT NO. 101 RESIDENTIAL BUILDING PLAN AT MOUZA: GHUNI, T.L. NO. 23, S.S. NO. 232, TOUZI NO. 1250, IN C.S. DAG NO. 1347, 1318, C.S. KHATTAN NO. 016, R.S. DAG NO. 1369, 1370 R.S. KHATTAN NO. 1044, 659, L.R. KHATTAN NO. 4964, 3173, 3174, P.S. - NEWTOWN, DIST. 24 PARGANAS (N), UNDER JYANGRA HATARA 2NC, GRAM PANCHAYET,</p>	
<p>NAME OF OWNER PULIN HALDER SIMUVA HALDER SANJIT SIKDER</p>	<p>AREA OF LAND AS PER SURVEYAL PERmissible GROUND COVERAGE: 18.36% (6.94%) PERmissible FLOOR COVERAGE: 1.94% (1.94%) PROPOSED FLOOR COVERAGE: 1.94% (1.94%) PROPOSED FLOOR COVERAGE: 1.94% (1.94%) PROPOSED FLOOR COVERAGE: 1.94% (1.94%)</p>
<p>DESIGNER: CIVIL ARCHITECT Signature: Anupama Halder Stamp: Anupama Halder</p>	<p>DATE OF PREPARATION: 2024 SCALE: 1:100 PROJECT NO. 101</p>