

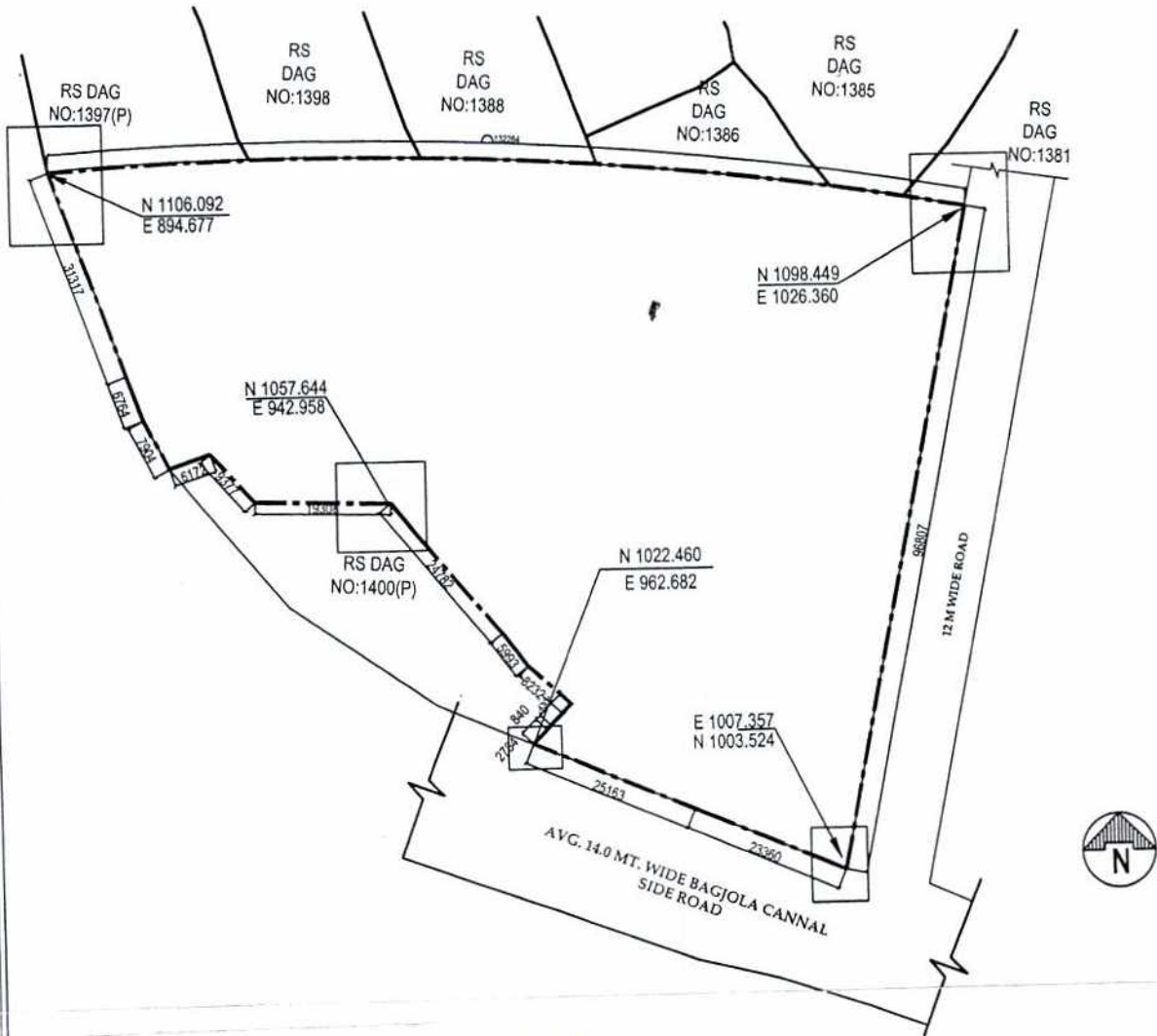

**SITE PLAN AT BOOTH NO.-62 ,63, R.S. DAG NO. -
1405(P),1404,1403(P),1402,1401,1400(P),1399,1398(P),1397(P).
1388(P),1386(P),1381(P),1385(P). MOUZA- SATULI, J.L. NO.-49, L.R. KHATIAN NO.-2129, 2166, 2175, 2181
& 2191 PS kashipur(formerly Bhangar), PO Pithapurkur. UNDER "BHAGWANPUR GRAM PANCHAYAT"
DIST-24 PARAGANAS(S).**

LAND AREA=1.989 ACRES = 8050.662 SQ.MT.= 86657.33 SQ.FT.



SG Computech Ltd
Dipjyoti Ghose
Authorised Signatory

ALL DIMENSIONS ARE IN MM

.....
(Signature of the Owner/Attorney)