



SCHEDULE OF DOORS & WINDOWS

NO	SILL	LINTEL	SIZE
SD1			750x2450
W1	150	2450	2400x2300
W2	150	2450	2100x 2300
W3	150	2150	1000x 2150
W4	150	2450	1800x 2300
W5	150	2450	1500x 2300
W6	150	2450	1200x 2300
W7	150	2450	850x 2300
W8	150	2450	850x 1100
W9	150	2450	1000x300
W10	1350/1668	2450/2768	600x1100
W11	1250	2150	600x900
SW1	150	2450	1200x2300
SW2	150	2450	1800x2300
SW3	150	2170	1200x2020
SW4	850	2170	1200x2070
D		2450	600x2300
D1		2450	2000x2450
D1a		2450	1200x2450
D2		2450	1500x2450
D3	250	2300	900x2050
D4		2150	1200 x 2150
D5		2150	900 x 2150
D6		2150	750 x 2150
D6a		2450	750 x 2450
D7		2150	600 x 2150
D8	250	2450	850x 2250
F.C.D. 1		2450	1200 x 2450
F.C.D. 2		2150	1200 x 2150
DW1		2450	6750 x 2450
DW2		2750	3450 x 2750
DW3		2750	2400 x 2750
DW4		2450	2400 x 2450
DW5		2450	2100 x 2450
SFD		2450	3825 x 2450
SFD1		2450	2400 x 2450
SFD2		2450	2100 x 2450
SFD3		2450	1800 x 2450
V	1900	2300	2400x550
V1	1900	2300	1900x550
V2	1900	2300	1200x550
V3	1900	2300	900x550
V4	1900	2300	750x550
F.C.	150	2450	2400x2300
F.C.1	150	2450	2100x2300
F.C.2	150	2450	1800x2300
C.G.			AS PER ELEVATION
*			FOR ARTIFICIAL LIGHTING & MECHANICAL VENTILATION

TIVOLI PARK APARTMENTS (P) LTD.
[Signature]
Director

SIGNATURE OF OWNER

CERTIFICATE OF STRUCTURAL ENGINEER

THIS IS TO CERTIFY THAT THE STRUCTURAL DESIGN AND DRAWING OF BOTH FOUNDATION AND SUPER STRUCTURE OF THE BUILDING HAS BEEN MADE BY ME, CONSIDERING ALL POSSIBLE LOADS INCLUDING THE SEISMIC LOAD AS PER THE NATIONAL BUILDING CODE OF INDIA AND CERTIFIED THAT IT IS SAFE AND STABLE IN ALL RESPECTS.

[Signature]
M. K. ROY
M. K. ROY
B.E. (Structural), M.Sc. (Res.), (Mechanical), I.R.
A.M.C.E.T.C. (P.R.), M.I. STRUCT. E. (London)
Member of I.A.E. (1982)
M.A.C. (Enrolled) Structural Reviewer

SIGNATURE OF STRUCTURAL ENGINEER

SIGNATURE OF STRUCTURAL REVIEWER

CERTIFICATE OF GEOTECHNICAL ENGINEER

IT IS CERTIFIED THAT THE COMPREHENSIVE GEO-TECHNICAL REPORT ON SOIL INVESTIGATION HAS BEEN PREPARED BY ME FOR DESIGN AND CALCULATION OF THE FOUNDATION BY ANALYZING THE SOIL SAMPLE FOR ESTIMATING THE BEARING CAPACITY OF THE SOIL ON WHICH FOUNDATION IS EXTENDED UP TO APPROPRIATE DEPTH THAT HAS BEEN PROPOSED IN THE GEO-TECHNICAL REPORT.

[Signature]
Dr. M. Nayal, M.D.
(S.O.B.), Ph.D. (Geotech)

SIGNATURE OF GEO-TECHNICAL ENGINEER

CERTIFICATE OF ARCHITECT

I DO HEREBY CERTIFY WITH FULL RESPONSIBILITY THAT THE BUILDING PLAN HAS BEEN DRAWN UP AS PER K.M.C. BUILDING RULE - 2009 AS AMENDED FROM TIME TO TIME THAT THE WIDTH OF THE ABUTTING ROAD CONFORM WITH THE PLAN AND IT IS A BUILDABLE SITE NOT A TANK OR A FILLED UP TANK. THE SITE PLAN, LOCATION PLAN AGREES WITH THE SITE. THE PLOT IS DEMARCATED BY BOUNDARY WALLS & MEASUREMENTS TALLY WITH THE REGD. DEED PLAN.

[Signature]
JAYPRAKASH BHARAT KUMAR AGRAWAL
B. Arch., A.I.T.A.
Reg. No. SA 7881 (1982)
ARCHITECT (SL. NO. - 321A)

SIGNATURE OF ARCHITECT

TITLE:
TENTH FLOOR, ELEVENTH FLOOR, TWELFTH FLOOR AND THIRTEENTH FLOOR PLAN. PART-1A

PROJECT:
PLAN SHOWING CHANGES U/R-26 (B&W) OF K.M.C. BLDG. RULE 2009 FROM THE SANCTIONED PLAN VIDE B.P. NO. - 2015080122 DATED - 31.03.16 FOR PARTLY (G+XXIX) & PARTLY (G+XXXI) STORED RESIDENTIAL BUILDING AT PREMISES NO. 225B, A.J.C. BOSE ROAD, KOLKATA - 700 020.

WARD NO. - 59 BOROUGH - VIII & FURTHER REGULARISED U/R-26 (2a)&(2b) & U/R 69A(1)(a) OF K.M.C. BLDG. RULE 2009 APPROVED BY M.B.C. DATED - 10.01.17.

ARCHITECTS

AGRAWAL & AGRAWAL			
BARODA		KOLKATA	
SCALE: 1:100	DATE	DEALT	CHECKED
SHEET NO. 8	15.02.18	SAYANTANI	SUBHASHISH

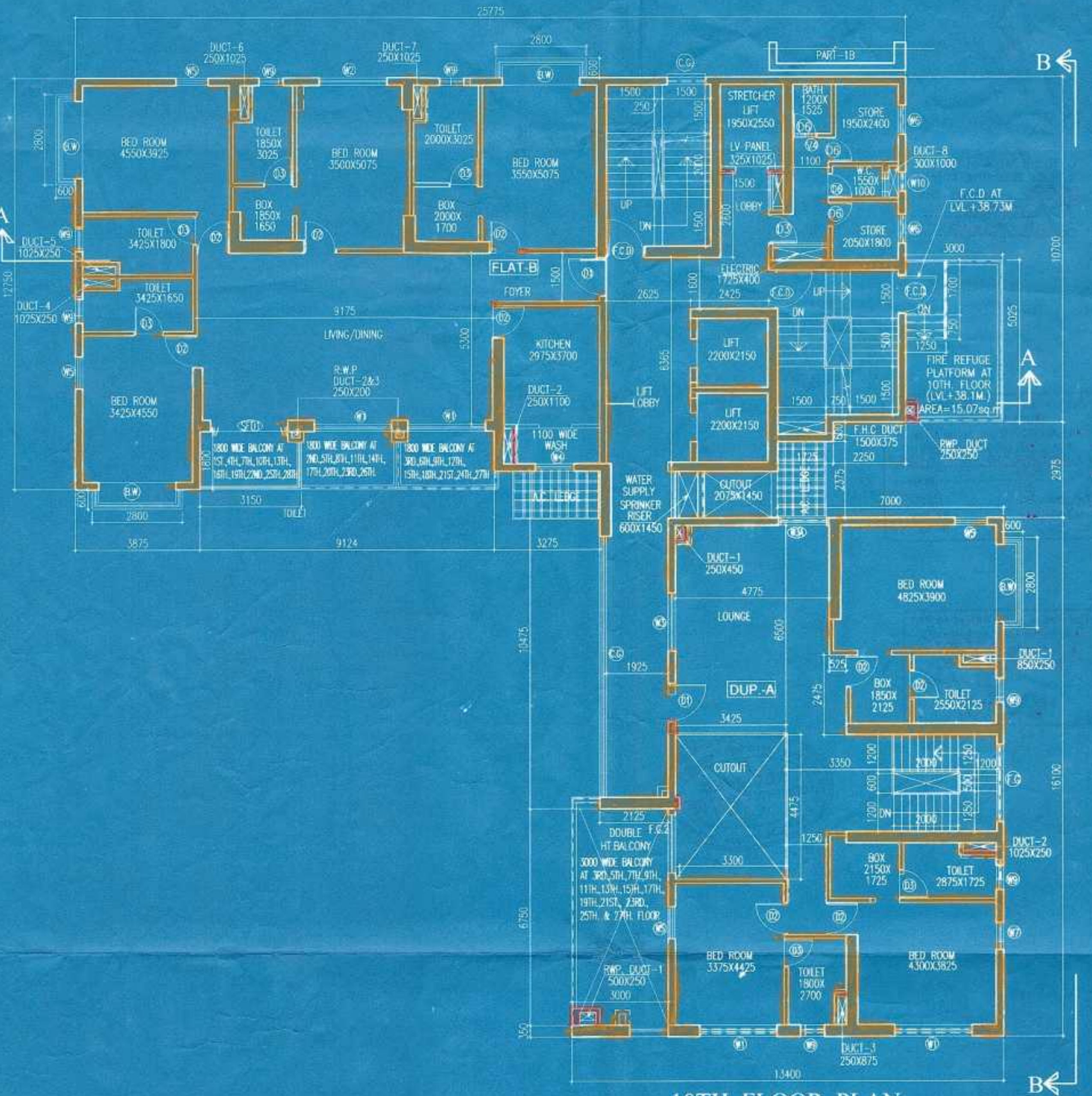

10TH. FLOOR PLAN

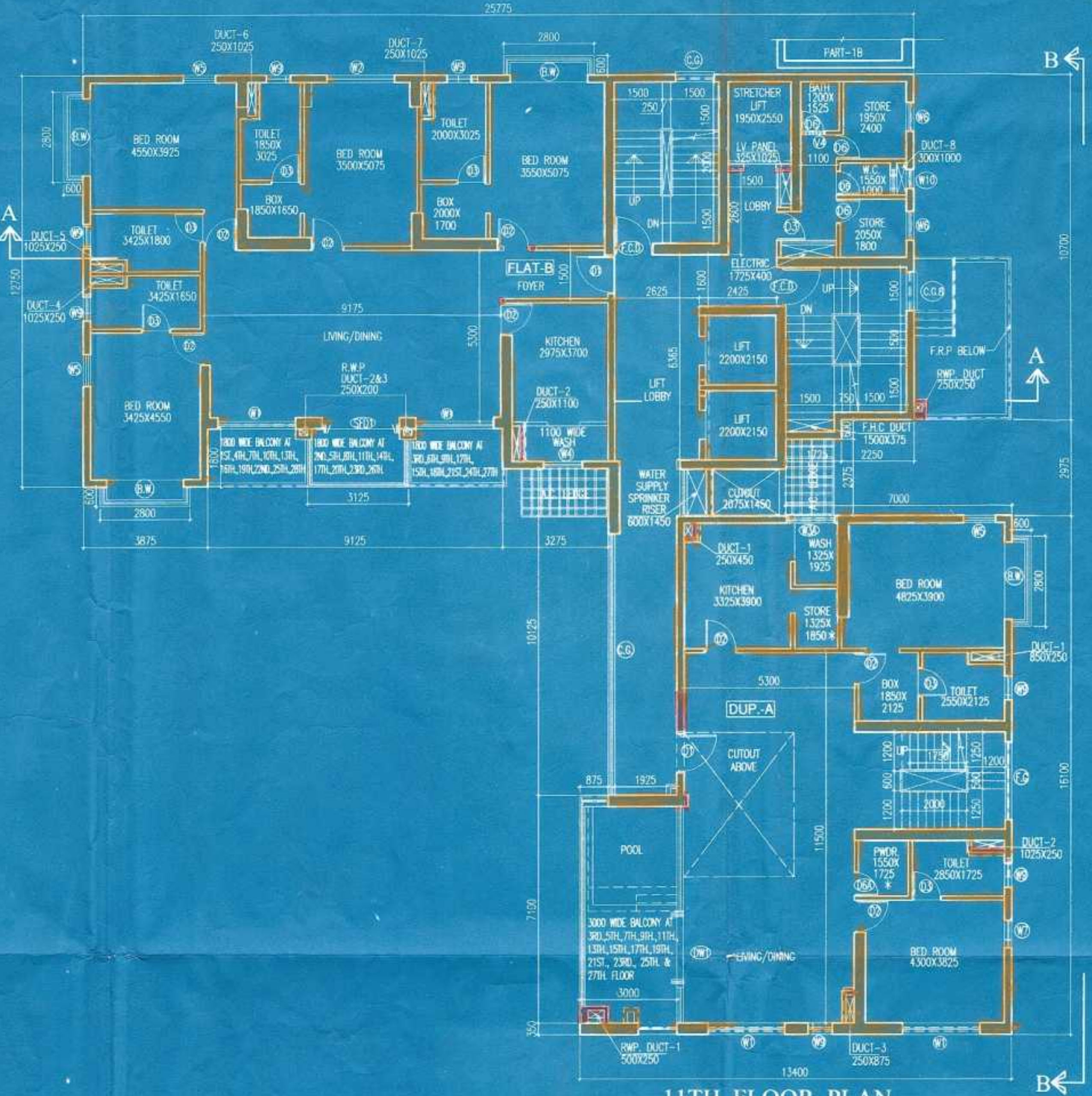

11TH. FLOOR PLAN

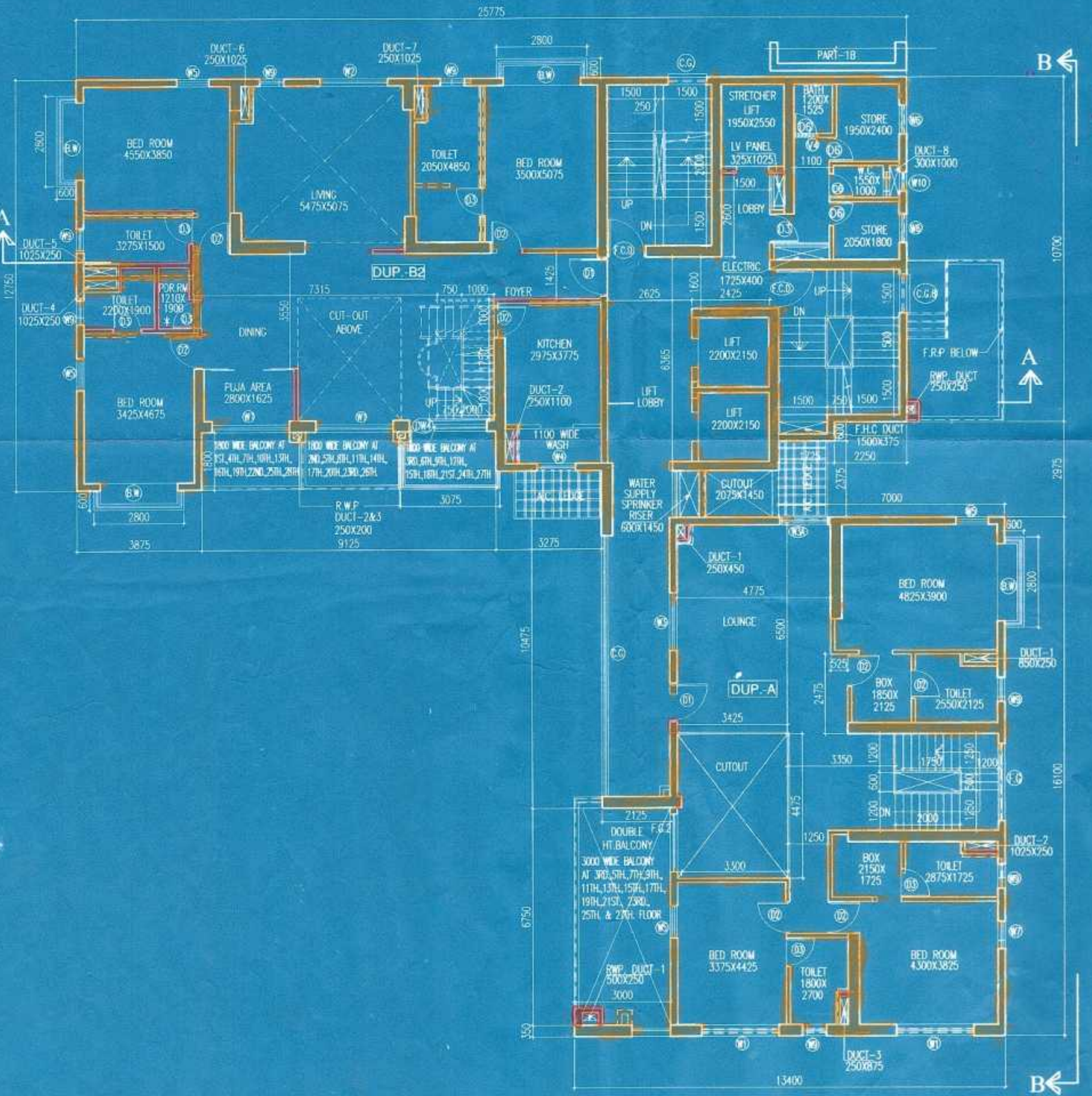

12TH. FLOOR PLAN

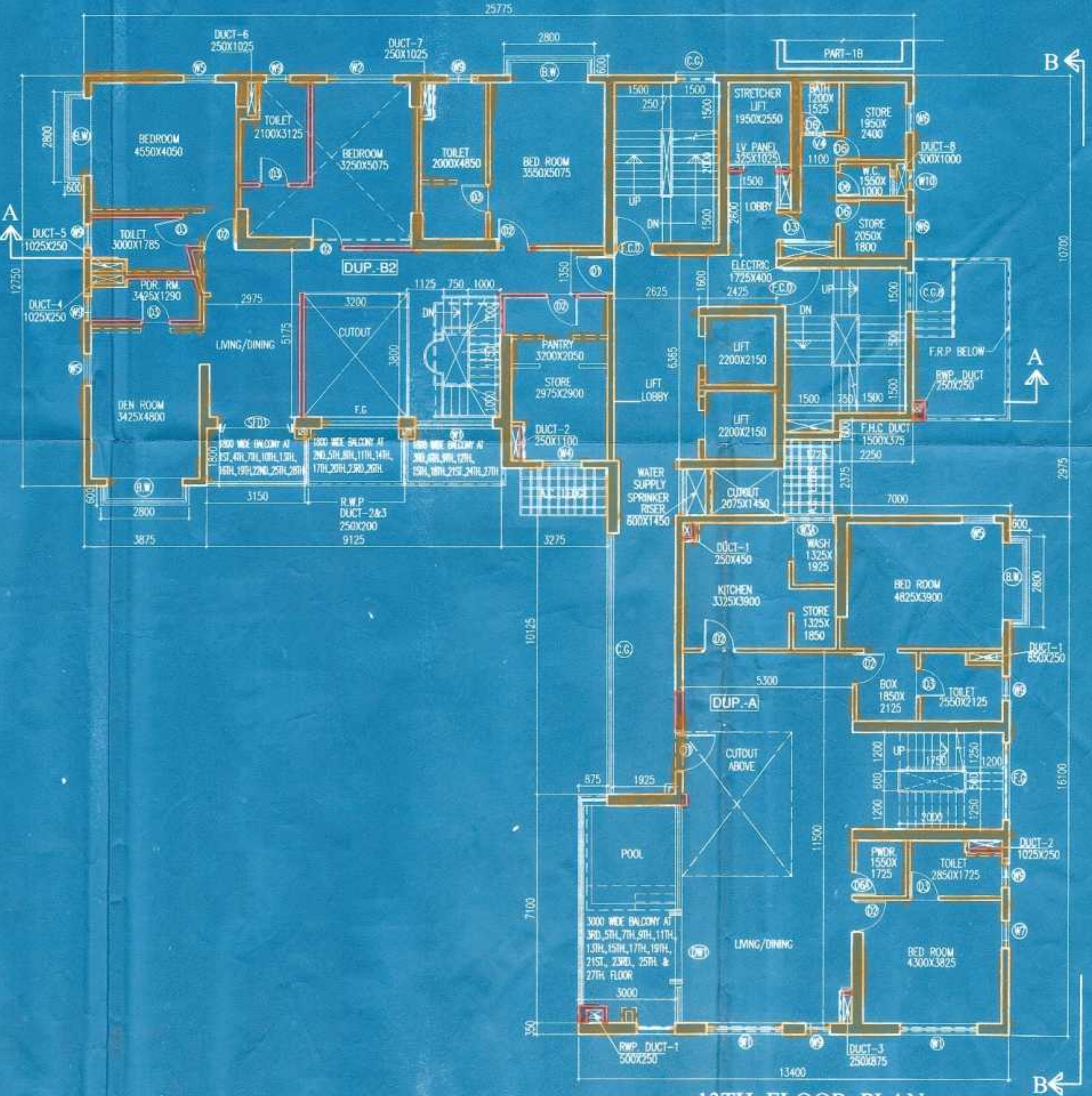

13TH. FLOOR PLAN

U/R-26(2a) & (2b) of
K.M.C. Building rules
approved by
D. G. (P. & S.)
Dt. 16.02.2018

KOLKATA MUNICIPAL CORPORATION
BUILDING DEPTT.
PLANS APPROVED U/R 26(2a) & (2b) of
K.M.C. BUILDING RULES 2008
B.P. No. 8018020102.D.2.11.0.8.2018
BR. NO. VIII
Assistant Engineer Ex. Eng.
Br. No. VIII Br. No. VIII

This Plan is to be Treated As Part
And Parcel And Contiguous To
S. S. Plan No. 8018020102
Dated: 16.02.2018
Ex. Engineer (B)
Ser. No. - VIII



100 PERCENTAGE COPY SENT
100%