



SCHEDULE OF DOORS & WINDOWS

NO	SILL	LINTEL	SIZE
S01	2450	2450	2450x2450
W1	150	2450	2450x2300
W2	150	2450	2100x 2300
W3	150	2150	1000x 2150
W4	150	2450	1800x 2300
W5	150	2450	1500x 2300
W6	150	2450	1200x 2300
W7	150	2450	900x 2300
W8	150	2450	600x 2300
W9	150	2450	300x 2300
W10	1350/1668	2450/2768	600x1100
W11	1250	2150	800x900
SW1	150	2450	1500x2300
SW2	150	2450	1000x2300
SW3	150	2170	1200x2020
SW4	830	2170	1200x2070
SW5	150	2450	2800x2300
D	-	2450	1800x2450
Dc	-	2450	2000x2450
D1	-	2450	1200x2450
D1a	-	2450	1500x2450
D2	-	2450	1000x2450
D2a	250	2300	900x2350
D3	-	2450	900x2450
D4	-	2150	1000 X 2150
D5	-	2150	800 X 2150
D6	-	2150	750 X 2150
D6a	-	2450	750 X 2450
D7	-	2150	600 X 2150
D8	250	2450	850X 2750
F.C.D.	-	2450	1200 X 2450
F.C.D. 1	-	2150	1000 X 2150
F.C.D. 2	-	2150	1200 X 2150
DM	-	2450	6750 X 2450
DW1	-	2750	3450 X 2750
DW2	-	2750	2400 X 2750
DW3	-	2450	2400 X 2450
DW4	-	2450	2400 X 2450
DW5	-	2450	2100 X 2450
SFD	-	2450	3825 X 2450
SFD1	-	2450	2400 X 2450
SFD2	-	2450	2100 X 2450
SFD3	-	2450	1800 X 2450
V	1900	2300	2400x350
V1	1900	2300	1800x350
V2	1900	2300	1200x350
V3	1900	2300	900x350
V4	1900	2300	750x350
F.6	150	2150	2400x2300
F.6.1	150	2450	2100x2300
F.6.2	150	2450	1800x2300

C.G. AS PER ELEVATION
+ FOR ARTIFICIAL LIGHTING & MECHANICAL VENTILATION

TWOOTI PARK APARTMENTS (P) LTD.

 Director
 SIGNATURE OF OWNER

CERTIFICATE OF STRUCTURAL ENGINEER
 THIS IS TO CERTIFY THAT THE STRUCTURAL DESIGN AND DRAWING OF BOTH FOUNDATION AND SUPER STRUCTURE OF THE BUILDING HAS BEEN MADE BY ME, CONSIDERING ALL POSSIBLE LOADS INCLUDING THE SEISMIC LOAD AS PER THE NATIONAL BUILDING CODE OF INDIA AND CERTIFIED THAT IT IS SAFE AND STABLE IN ALL RESPECTS.

Utpal Sankar
 UTPAL SANKAR
 CIVIL ENGINEER
 REG. NO. 12345
 SIGNATURE OF STRUCTURAL ENGR.
 Utpal Sankar
 UTPAL SANKAR
 CIVIL ENGINEER
 REG. NO. 12345
 SIGNATURE OF STRUCTURAL REVIEWER

CERTIFICATE OF GEOTECHNICAL ENGINEER
 IT IS CERTIFIED THAT THE COMPREHENSIVE GEO-TECHNICAL REPORT ON SOIL INVESTIGATION HAS BEEN PREPARED BY ME FOR DESIGN AND CALCULATION OF THE FOUNDATION BY ANALYZING THE SOIL SAMPLE FOR ESTIMATING THE BEARING CAPACITY OF THE SOIL ON WHICH FOUNDATION IS EXTENDED UP TO APPROPRIATE DEPTH THAT HAS BEEN PROPOSED IN THE GEO-TECHNICAL REPORT.

Dr. M. Nayak, MD
 BB (Civil), Ph. D. (Geotech)
 SIGNATURE OF GEOTECHNICAL ENGR.

CERTIFICATE OF ARCHITECT
 I DO HEREBY CERTIFY WITH FULL RESPONSIBILITY THAT THE BUILDING PLAN HAS BEEN DRAWN UP AS PER K.M.C. BUILDING RULE - 2009 AS AMENDED FROM TIME TO TIME THAT THE WIDTH OF THE ABUTTING ROAD CONFORM WITH THE PLAN AND IT IS A BUILDABLE SITE NOT A TANK OR A FILLED UP TANK. THE SITE PLAN, LOCATION PLAN AGREES WITH THE SITE. THE PLOT IS DEMARCATED BY BOUNDARY WALLS & MEASUREMENTS TALLY WITH THE REGD. DEED PLAN.

JAY PRAKASH BHARAT KUMAR AGRAWAL
 ARCHITECT
 REG. NO. 12345
 SIGNATURE OF ARCHITECT

TITLE:
 EIGHTEENTH FLOOR, NINETEENTH FLOOR, TWENTIETH FLOOR AND TWENTY FIRST FLOOR PLAN. PART-1A
 PROJECT:
 PLAN SHOWING CHANGES U/P-26 (23A)(26) OF K.M.C. BLDG. RULE 2009 FROM THE SANCTIONED PLAN VIDE B.P. NO. 2016890122 DATED - 31.03.15 FOR PARTLY (G+XXX) & PARTLY (G+XXXII) & PARTLY (G+XXXIII) STORED RESIDENTIAL BUILDING AT PREMISES NO. 225B, A.J.C. BOSE ROAD, KOLKATA - 700 090.
 WARD NO. - 08 BIDDULOH - VII & FURTHER REGLARISED U/P-26 (23A)(26) & U/P-69A (1A) OF K.M.C. BLDG. RULE 2009 APPROVED BY M.B.C. DATED - 10.01.17

ARCHITECTS		AGRAWAL & AGRAWAL	
BARODA		KOLKATA	
SCALE - 1:100	DATE	DEALT	CHECKED
SHEET NO - 10	15.02.18	SAVANTANI	SUBHASHISH

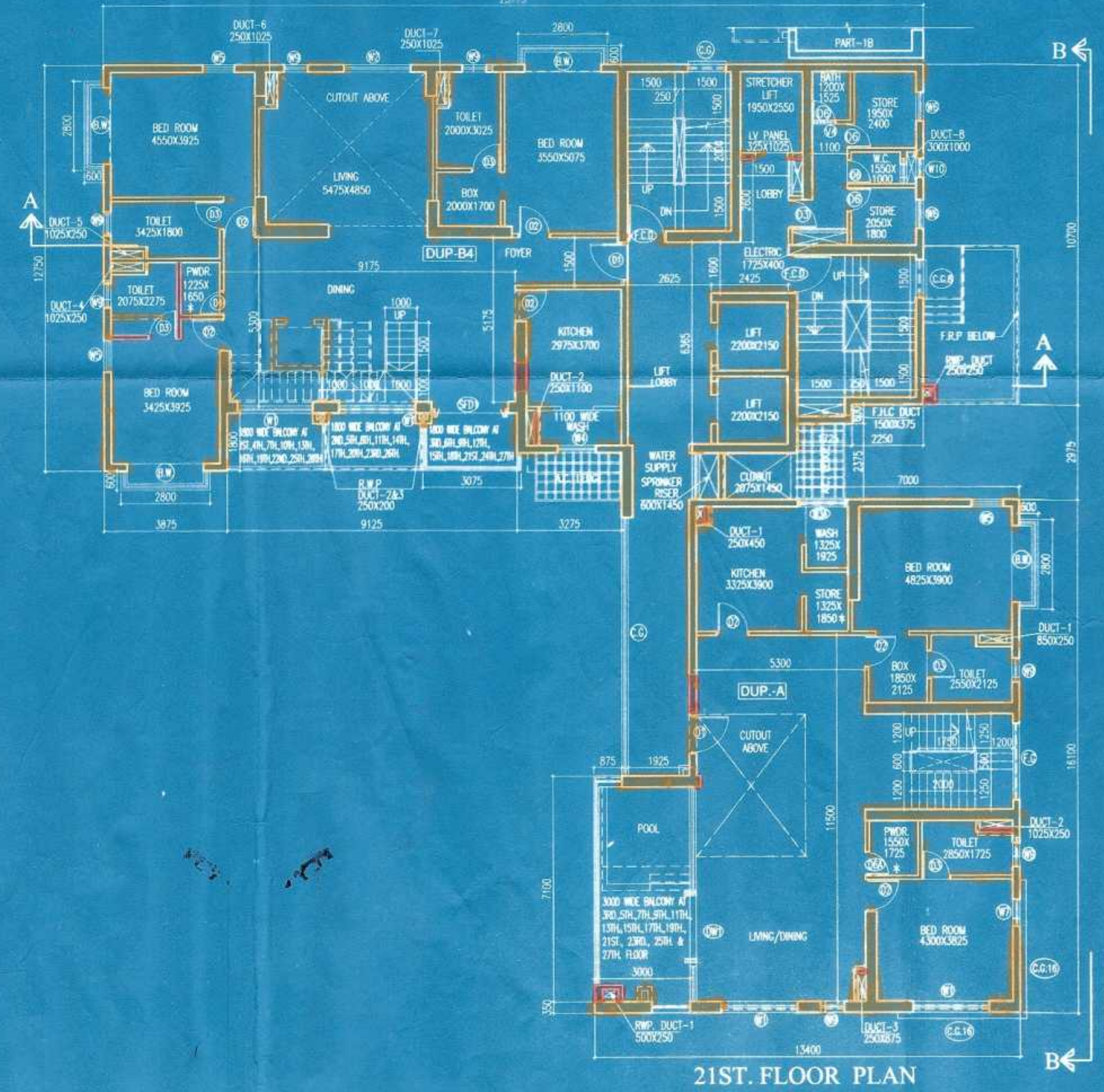
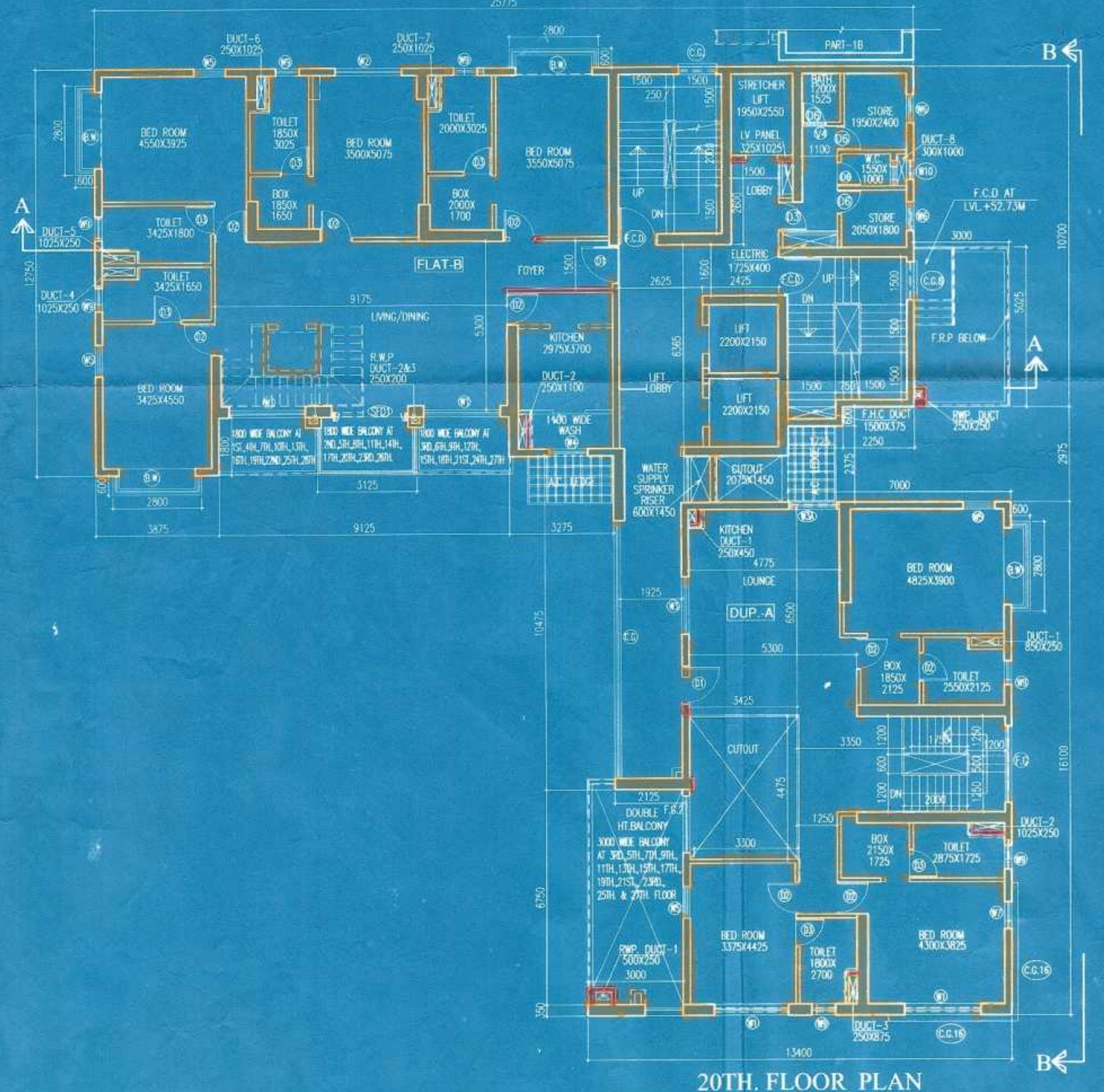
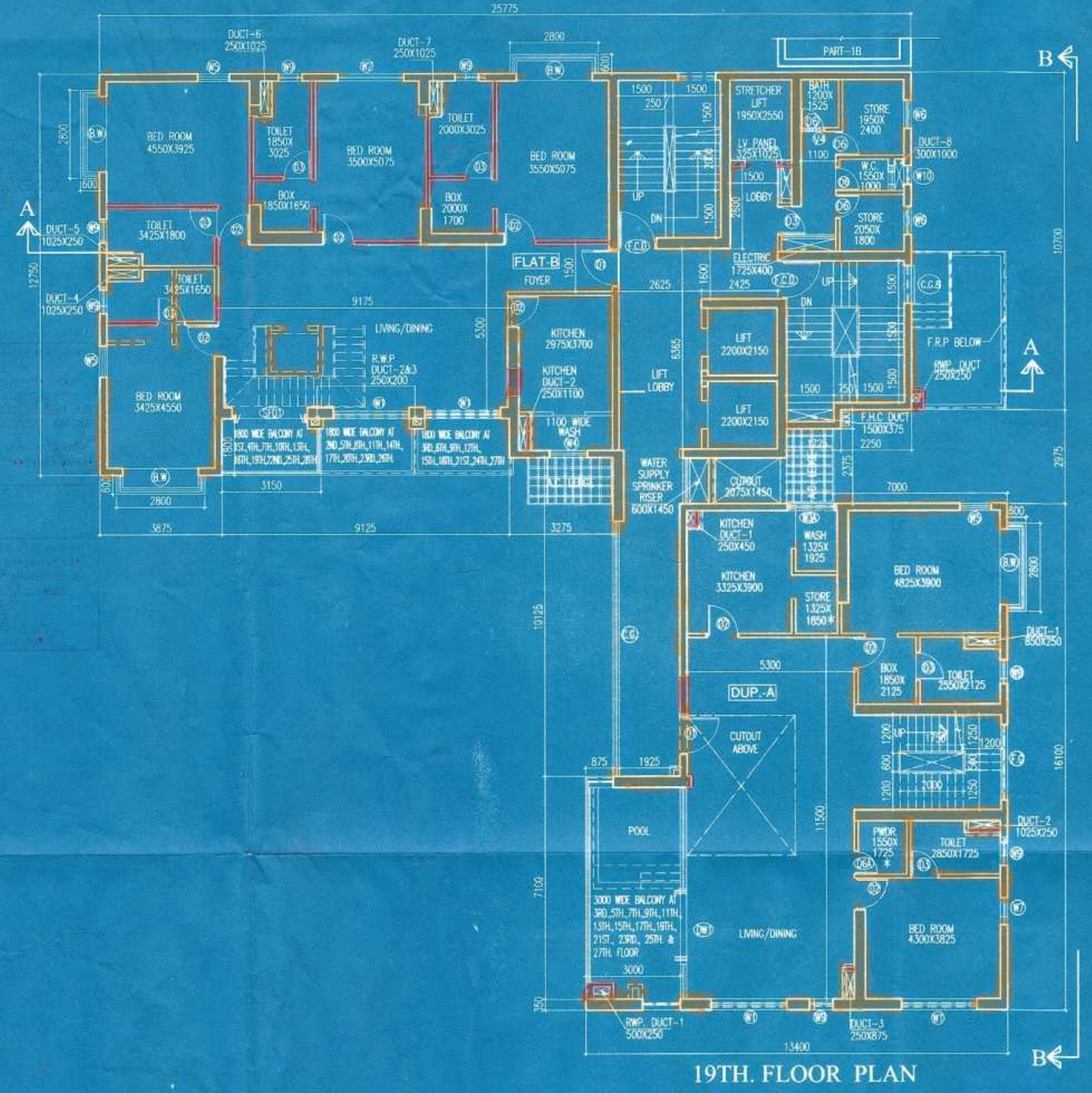
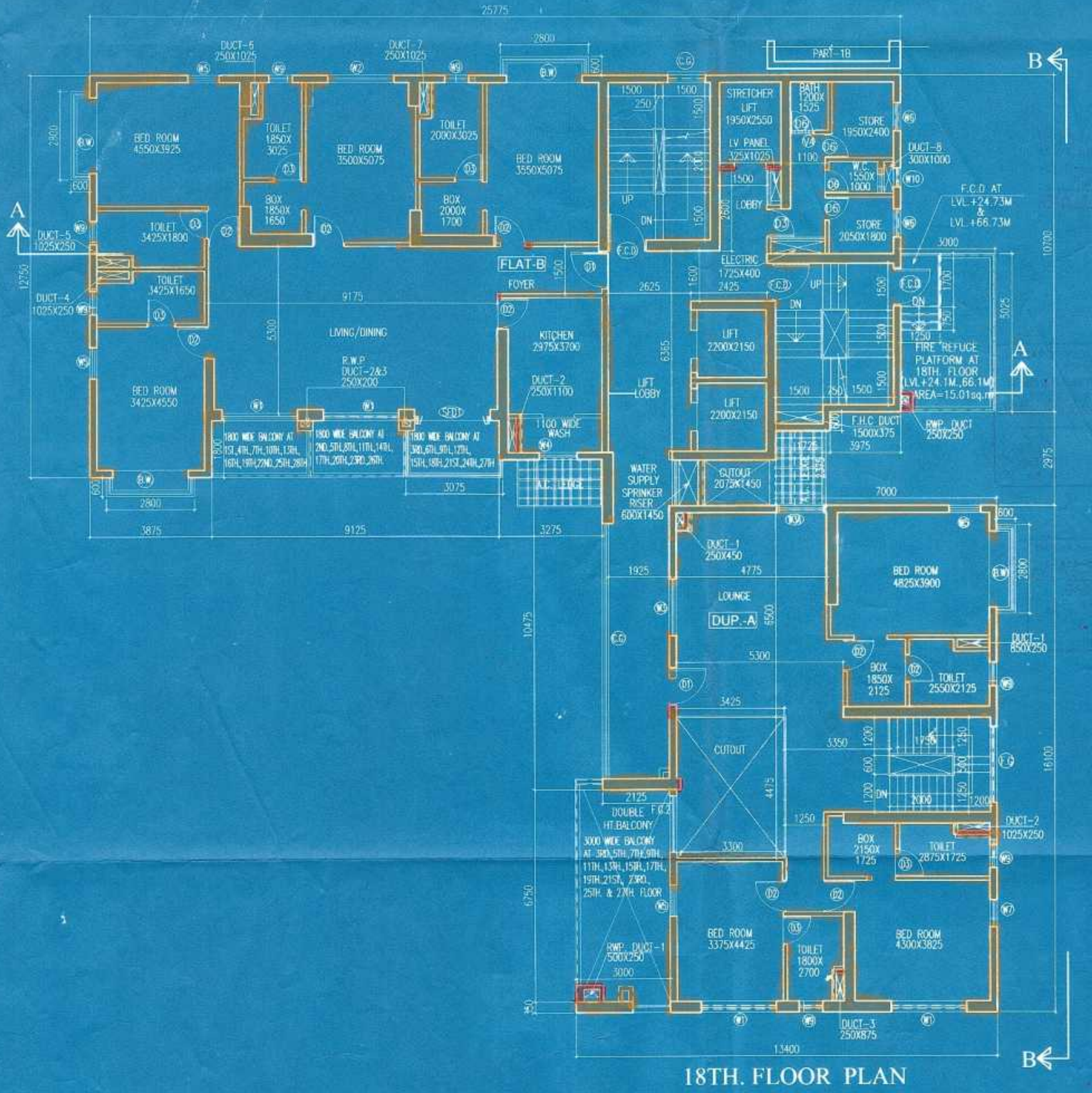

U/R-26(2a) & (2b) of
K.M.C. Building rules
approved by
Dt. 15/01/2015.

KOLKATA MUNICIPAL CORPORATION
BUILDING DEPTT.
PLANS APPROVED U/R 26(2a) & (2b) of
K.M.C. BUILDING RULES 2009
B.P. No. 245/2010 Dt. 15/01/2015
BR. No. 1510
Assistant Engineer
Br. No. VIII

This Plan is To Be Treated As Part
And Parcel And Conduces To
B. S. Plan No. 245/2010
Dt. 15/01/2015.
Ex. Engineer (S)
Br. No. 1- VIII



M